

# P.D.PITCHFORD ANIMAL COMPANION VILLAGE

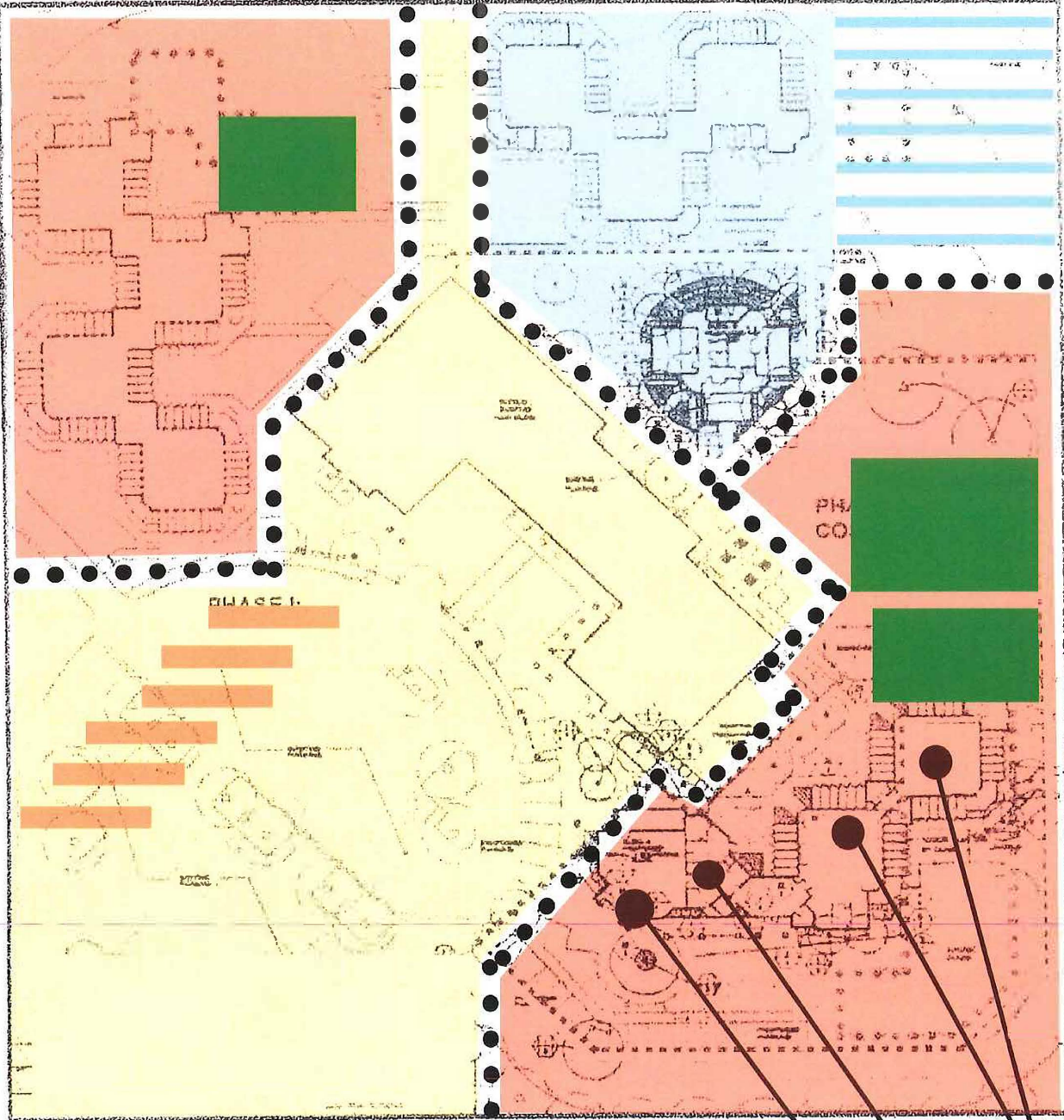

SPCALA NON-SHELTER BUSINESS VENTURES

- Common Area**  
50/50 Maintenance and Repair Costs
- Long Beach Animal Care Services, & fleet parking**  
84 Kennels + 10 added at later date
- SPCALA**  
138 Kennels\*, fleet parking in Common Area
- SPCALA Restricted Use Dog Parks**

PET HOTEL  
42 PREMIUM  
KENNELS

GROOMING

MARKET

\*SPCALA kennel size is approximately 16" wider than LBACS kennel size.

# Planning & Zoning

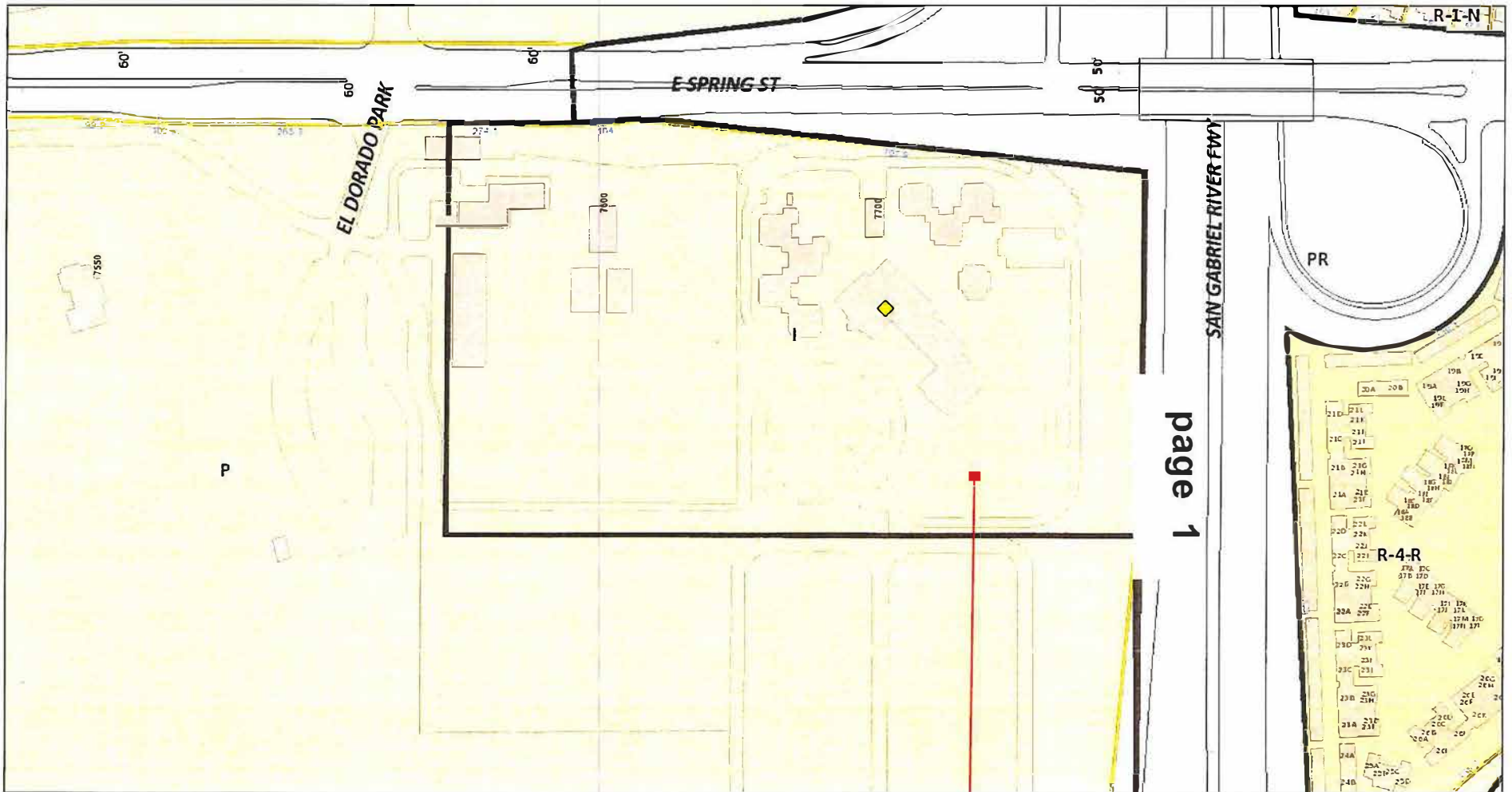

February 25, 2019

ZONED

I

**SPCALA STUCTURES DO NOT  
SHOW ON ZONING MAPS**

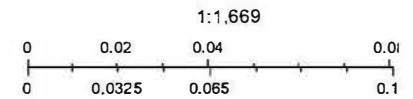

page 2

DISCLAIMER: The services provided on this City of Long Beach (City) web site are intended for informational purposes only and the GIS data used is compiled from various sources and is subject to change. While reasonable effort has been made to ensure the accuracy of the data, the information provided herein may be inaccurate or out of date. City authorized documents are owned solely by the City. The City retains a nonexclusive, royalty free license to publish or reproduce these documents, or allow others to do so for City purposes. Documents may be protected under U.S. and Foreign Copyright Laws.



2/25/2019 11:54

# Adoption Activity License

"Social Services without Food Distribution"

NOT for retail sales, grooming,  
dog training, or pet hotel

## INFORMATION - LICENSE # BU20214000

*License Type* BU  
*Application Type* Main Business License  
*Description*  
*Primary Applicant*  
*Primary Applicant Last Name* SOCIETY FOR THE PREVENTION OF  
*Address* 7700 E SPRING ST LONG BEACH CA 90815  
*Location*  
 License is Active.  
 Current milestone is Renewed.  
 Current unpaid amount of \$0.00.  
 Account: BU20214000

## License Description

### Status Dates

*Processed Date* 3/27/2002 00:00  
*by* Data Conversion  
*Start Date* 3/27/2002 00:00  
*by*  
*Inactive Date*  
*by*  
*Last Renewal*  
*by*  
*Next Renewal* 8/1/2019 00:00  
*Expires* 8/1/2019 00:00  
*Grace Exp* 8/31/2019  
*End Date*  
*by* WSRTL  
*Last Modified* 7/31/2018 17:17

### License Description

*Property Type* COM  
*License Category* 204014  
*Business Name* SOCIETY FOR THE PREVENTION OF  
*DBA Name* SPCA LA  
 Detailed Description of Business Activities  
 Pet Adoption/Social Service  
*Application Reason* NEWLICENSE  
*Description* Social Service without Food Distribution  
*HH/MH: Total #* 0  
*Units*  
*Census Tract* 0  
*Council District* 5

## License Details

(Tab Not Loaded)

## Endorsements

(Tab Not Loaded)

## Reviews

(Tab Not Loaded)

## Inspections



2/25/2019 11:55

# Shelter Activity License

"Veterinary with Boarding"

NOT for retail sales, grooming,  
dog training, or pet hotel

## INFORMATION - LICENSE # BU20213990

*License Type* BU  
*Application Type* Main Business License  
*Description*  
*Primary Applicant*  
*Primary Applicant*  
*Last Name* SOCIETY FOR THE PREVENTION OF  
*Address* 7700 E SPRING ST LONG BEACH CA 90815  
*Location*

License is Active.  
Current milestone is Renewed.  
Current unpaid amount of \$0.00.  
Account: BU20213990

## License Description

### Status Dates

*Processed Date* 3/27/2002 00:00  
*by* Data Conversion  
*Start Date* 3/27/2002 00:00  
*by*  
*Inactive Date*  
*by*  
*Last Renewal*  
*by*  
*Next Renewal* 8/1/2019 00:00  
*Expires* 8/1/2019 00:00  
*Grace Exp* 8/31/2019  
*End Date*  
*by* WSRTL  
*Last Modified* 7/31/2018 17:17

### License Description

*Property Type* COM  
*License Category* 202523  
*Business Name* SOCIETY FOR THE PREVENTION OF  
*DBA Name* SPCA LA  
*Detailed Description of Business Activities*  
Animal Shelter  
*Application Reason* NEWLICENSE  
*Description* Veterinary Clinic with Boarding  
*HH/MH: Total #* 0  
*Units*  
*Census Tract* 0  
*Council District* 5

## License Details

(Tab Not Loaded)

## Endorsements

(Tab Not Loaded)

## Reviews

(Tab Not Loaded)

## Inspections

## **LBACS Dogs are Not allowed to use Dog Parks at P.D. Pitchford Animal Companion Village**



This is one of three dog parks located at P.D. Pitchford Animal Companion Village which according to Lease Lease-Back is watered at taxpayer expense. SPCALA uses this property to provide services for which it collects revenue. LBACS shelter dogs are not allowed to use the dog parks at any time, even though we know dogs thrive when they can play.

## SPCALA Marketing Observation

***"A Model Program of Private and Public Collaboration"***

*SPCALA uses the City Government seal to create a false narrative that P.D. Pitchford Companion Animal Village is a model program. But the model does is not working well for both parties.*

**Overheard "There is no municipal shelter director anywhere who would want to use our model."**

## SPCALA

- operates on prime park land, freeway access, for net \$5 a month, City pays bond debt service
- collects robust adoption, market, grooming, boarding and training revenues
- first pick of municipal cutest shelter dogs, animals with fastest turnover, lowest cost per animal
- maintains "humane" moniker when LBACS kills animals the if inventory of rises
- leverages adoption transactions for soliciting more donations
- leverages City logo to position itself as holding a municipal contract though none exist

## LBACS

- operations meet minimum shelter standards
- unable to capture the revenue stream easy to adopt animals and relieve burden on taxpayer by generating fee based revenue.
- dogs are prohibited from playing at village dog parks even though City waters all three lawns
- lacks space to expand, or room to add low cost spay neuter clinic which directly support city-wide goal of lowering reproduction rates.
- 58% of LBACS employees are dissatisfied with their jobs
- kills adoptable animals citing it does not have room

*Question: Is the City of Long Beach currently authorizing use of City seal even after audit City audit does not support that we are operating as a model for other municipal shelters?*

