

ORD-34

ORDINANCE NO.

1
2
3 AN ORDINANCE OF THE CITY COUNCIL OF THE
4 CITY OF LONG BEACH SETTING ASIDE AND DEDICATING
5 IN PERPETUITY CERTAIN LANDS OWNED BY THE CITY OF
6 LONG BEACH FOR PUBLIC PARK PURPOSES AND USES
7

8 WHEREAS, on June 20, 2019, the Parks and Recreation Commission
9 recommended the designation or dedication of 28 existing City-owned parks, of which
10 eleven (11) parks are the subject of this resolution;

11 WHEREAS, the Planning Commission, at its hearing on July 15, 2021,
12 recommended to the City Council the approval of dedications in perpetuity and
13 associated land use actions for a batch of 12 parks which is now 11 parks because one
14 has been removed. The 11 parks are Craftsman Village Park, C. David Molina Park,
15 Donald Douglas Plaza, Grace Park, Jenni Rivera Memorial Park, Locust Tot Lot, Mary
16 Molina Community Garden, Miracle on 4th Street Park, Orizaba Park, Pacific & 6th
17 Community Garden, and Pacific Electric Railway Greenbelt;

18 WHEREAS, the City Council hereby finds that the proposed dedication in
19 perpetuity of 11 parks will not adversely affect the character, livability or appropriate
20 development of the surrounding properties and that the proposed amendments are
21 consistent with the goals, objectives and provisions of the General Plan, including the
22 Land Use Element, and the Open Space and Recreation Element thereof;

23 NOW, THEREFORE, The City Council of the City of Long Beach ordains as
24 follows:

25 Section 1. Park Dedication.

26 In accordance with the goals, objectives, policies and programs of the Land
27 Use Element, and the Open Space and Recreation Element of the General Plan of the
28 City of Long Beach, the following areas of the City are hereby set aside and dedicated in

1 perpetuity for public park purposes:

- 2 Park Name
- 3 Craftsman Village Park
- 4 C. David Molina Park
- 5 Donald Douglas Plaza
- 6 Grace Park
- 7 Jenni Rivera Memorial Park
- 8 Locust Tot Lot
- 9 Mary Molina Community Garden
- 10 Miracle on 4th Street Park
- 11 Orizaba Park
- 12 Pacific & 6th Community Garden
- 13 Pacific Electric Railway Greenbelt.

14
15 Section 2. The boundaries of said parks are outlined on the maps
16 attached hereto and incorporated herein as Exhibit "A".

17 Section 3. The City Clerk shall certify to the passage of this ordinance by
18 the City Council and cause it to be posted in three conspicuous places in the City of Long
19 Beach, and it shall take effect on the thirty-first day after it is approved by the Mayor.

20 //
21 //

22
23
24
25
26
27
28

OFFICE OF THE CITY ATTORNEY
CHARLES PARKIN, City Attorney
411 West Ocean Boulevard, 9th Floor
Lona Beach, CA 90802-4664

1
2
3
4
5
6
7
8
9
10
11
12
13
14
15
16
17
18
19
20
21
22
23
24
25
26
27
28

I hereby certify that the foregoing ordinance was adopted by the City Council of the City of Long Beach at its meeting of _____, 2022, by the following vote:

Ayes: Councilmembers: _____

Noes: Councilmembers: _____

Absent: Councilmembers: _____

Recusal(s): Councilmembers: _____

City Clerk

Approved: _____

Mayor

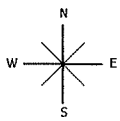
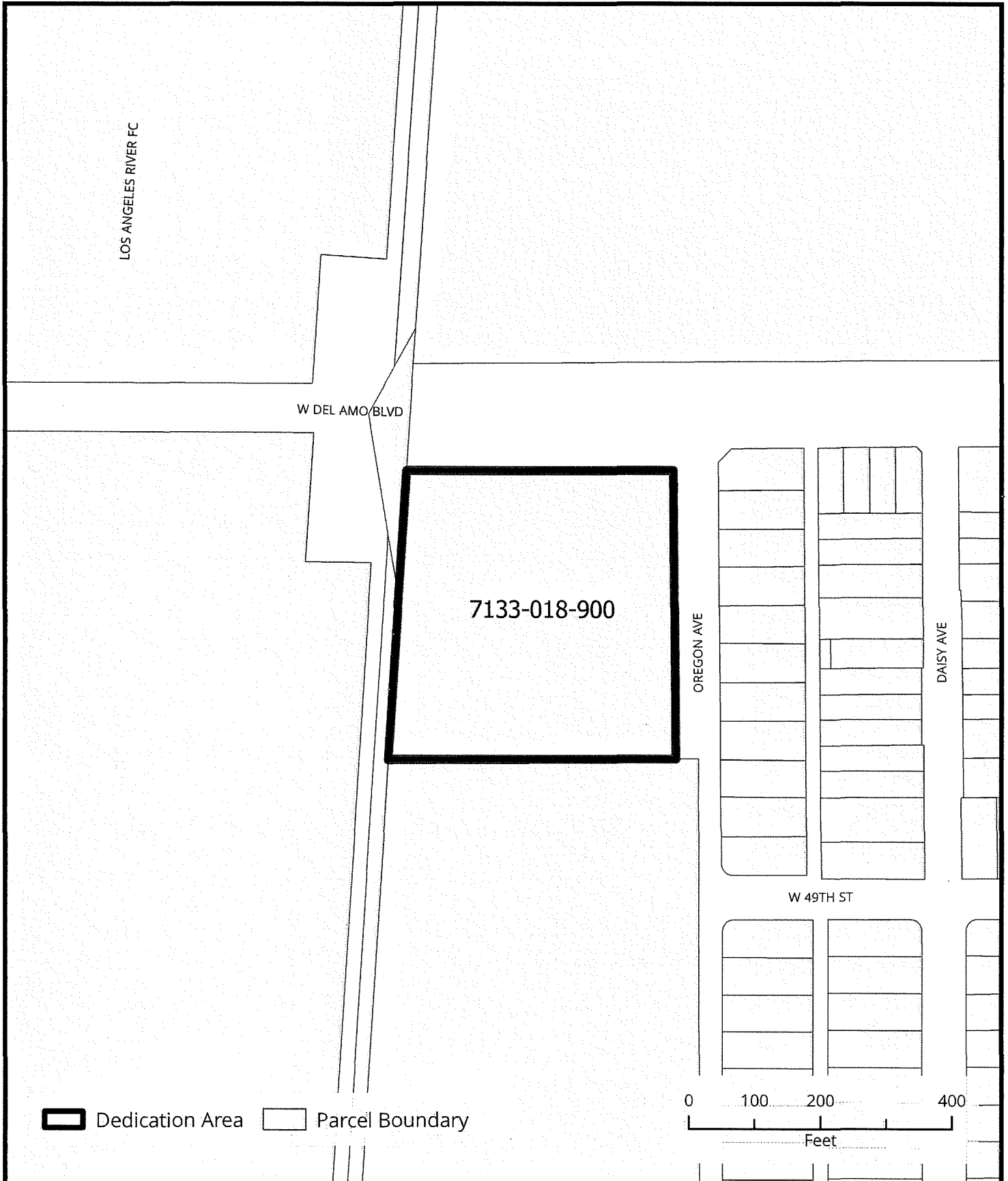

PARK DEDICATION
C. David Molina Park

App No. 2011-21
(GPA20-002, ZCA20-016)





7267-023-900

CEPPITOS AVE

HELLMAN ST

ORANGE AVE

E 9TH ST

E 8TH ST

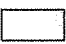
 Dedication Area  Parcel Boundary

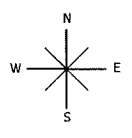
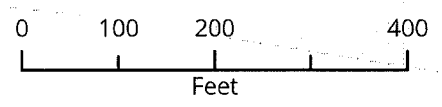

PARK DEDICATION
 Craftsman Village Park

App No. 2011-21
 (GPA20-002, ZCA20-016)



**LONG BEACH
 DEVELOPMENT
 SERVICES**

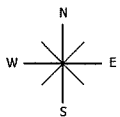
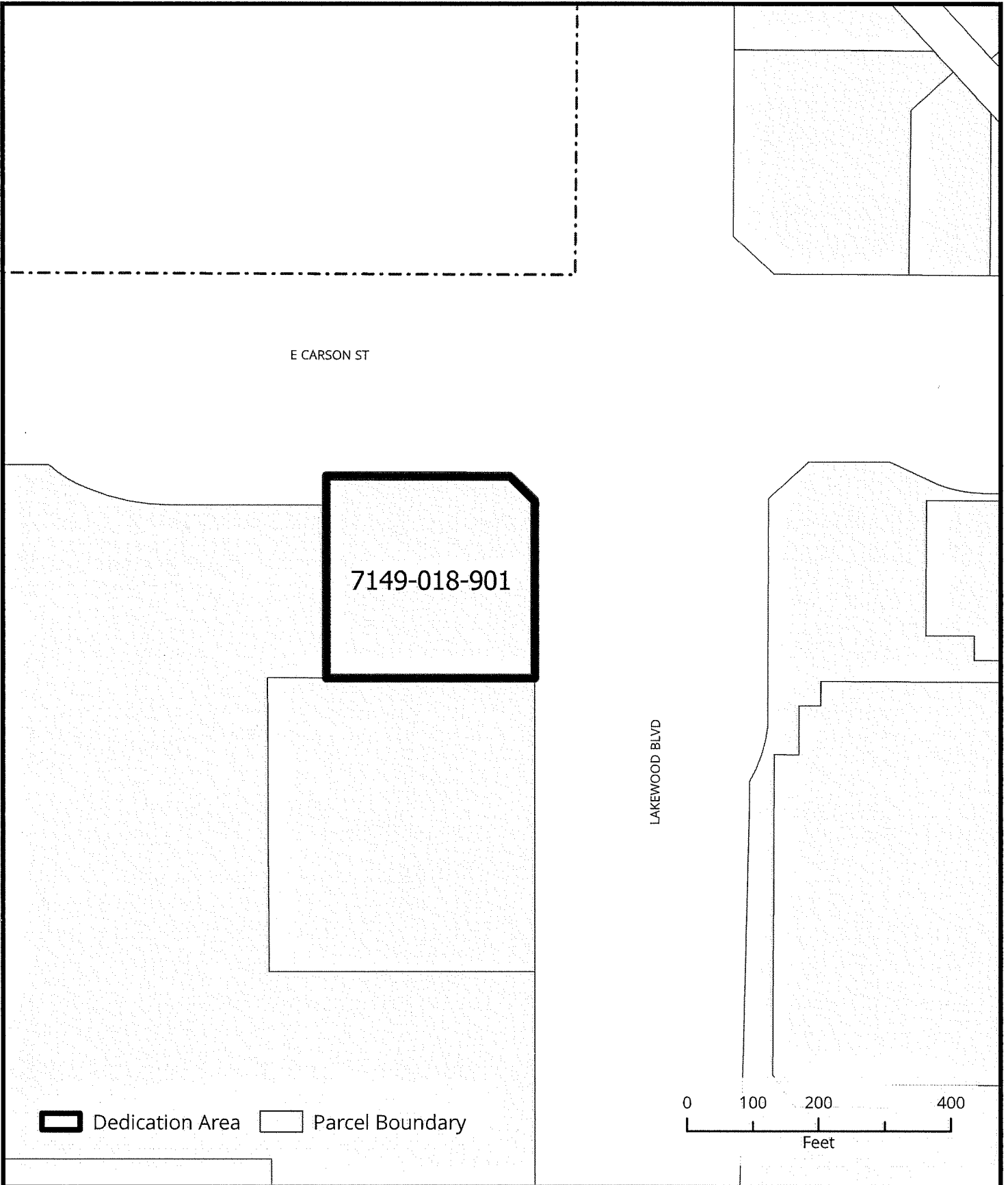

PARK DEDICATION

Donald Douglas Park

App No. 2011-21
(GPA20-002, ZCA20-016)



LONG BEACH
DEVELOPMENT
SERVICES

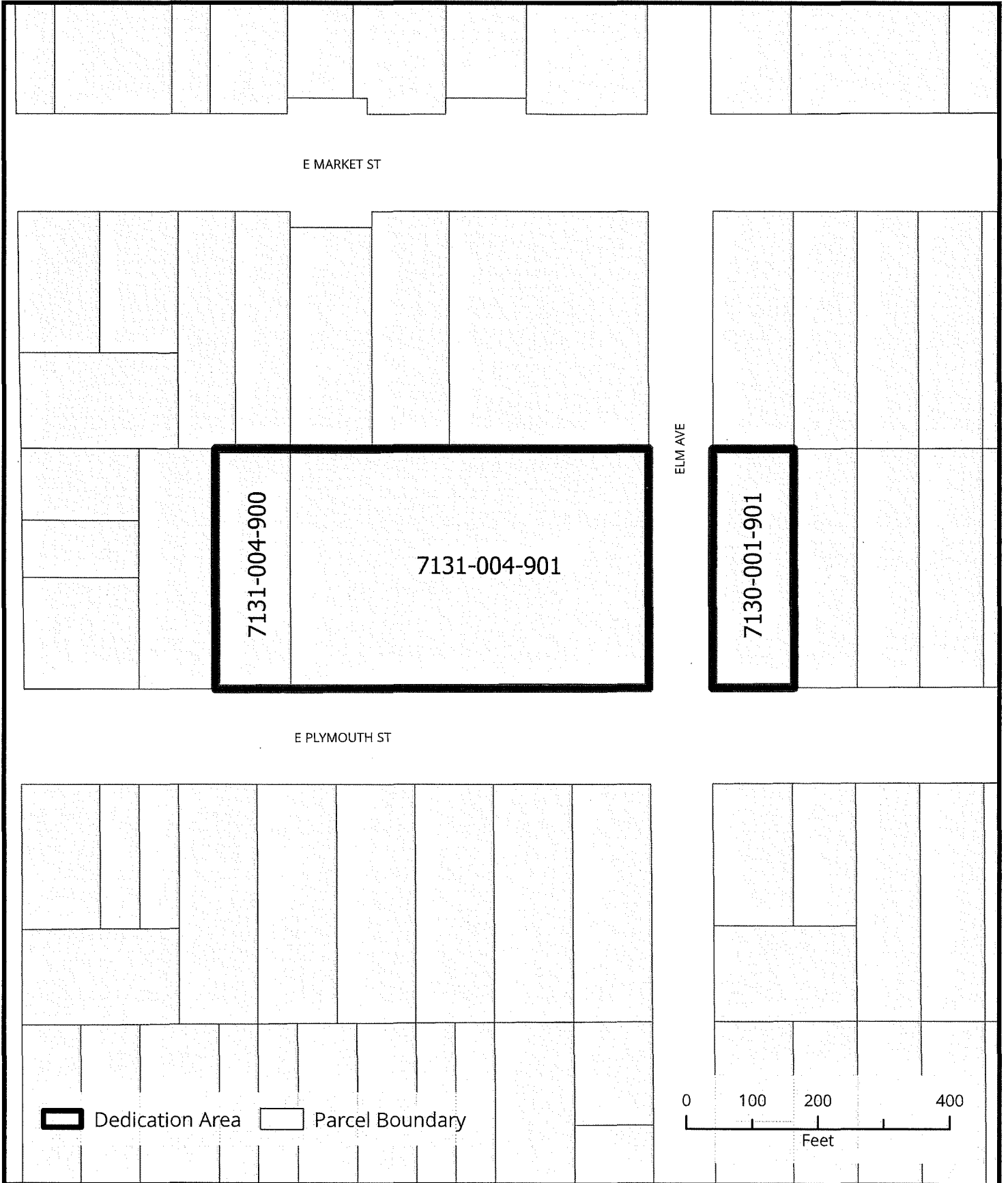

E MARKET ST

ELM AVE

7131-004-900

7131-004-901

7130-001-901

E PLYMOUTH ST

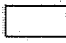
 Dedication Area  Parcel Boundary

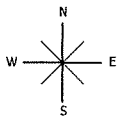
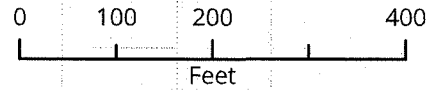

PARK DEDICATION

Grace Park

App No. 2011-21
(GPA20-002, ZCA20-016)



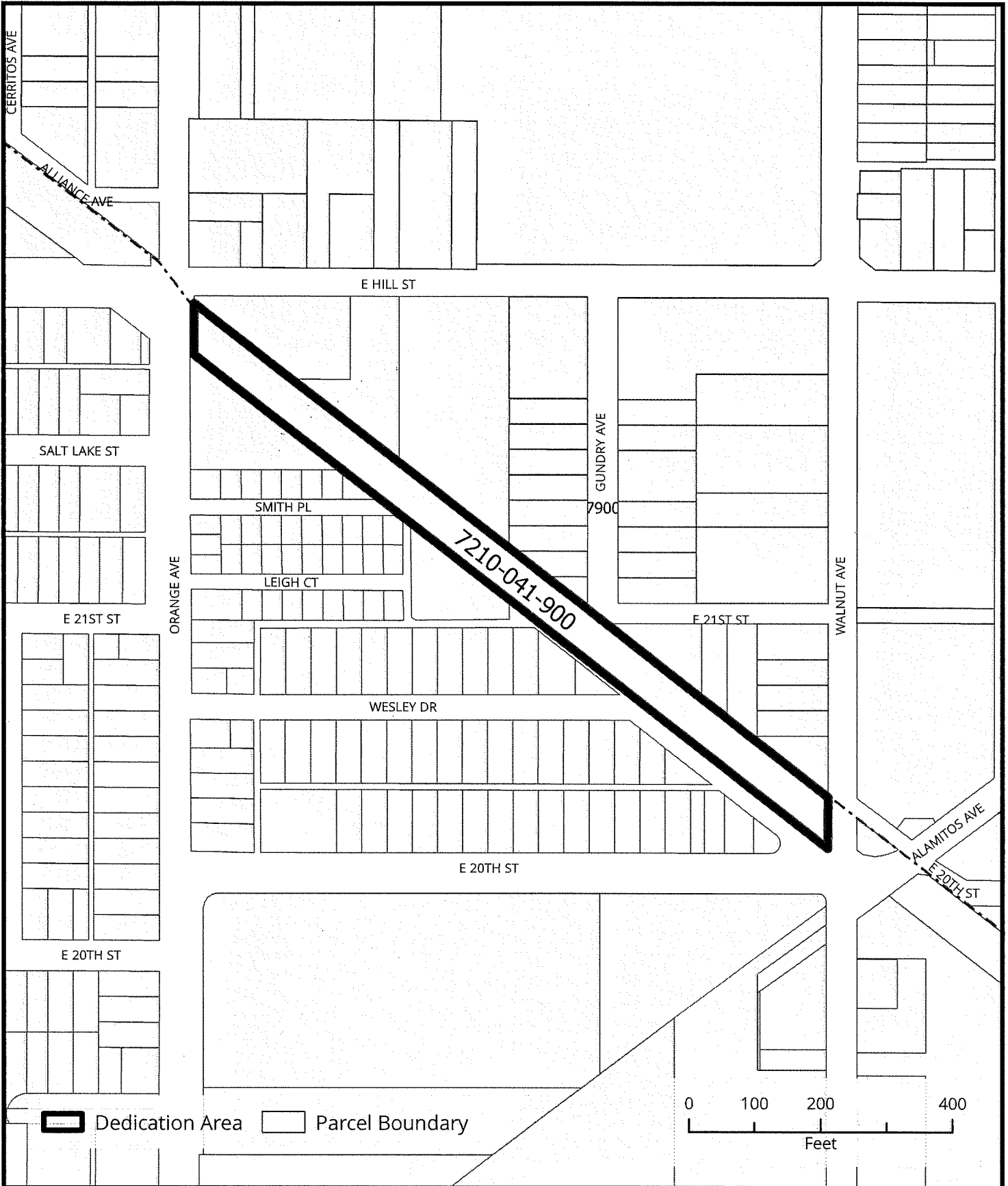

PARK DEDICATION

Jenni Rivera Memorial Park

App No. 2011-21
(GPA20-002, ZCA20-016)

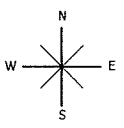

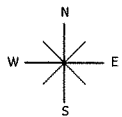
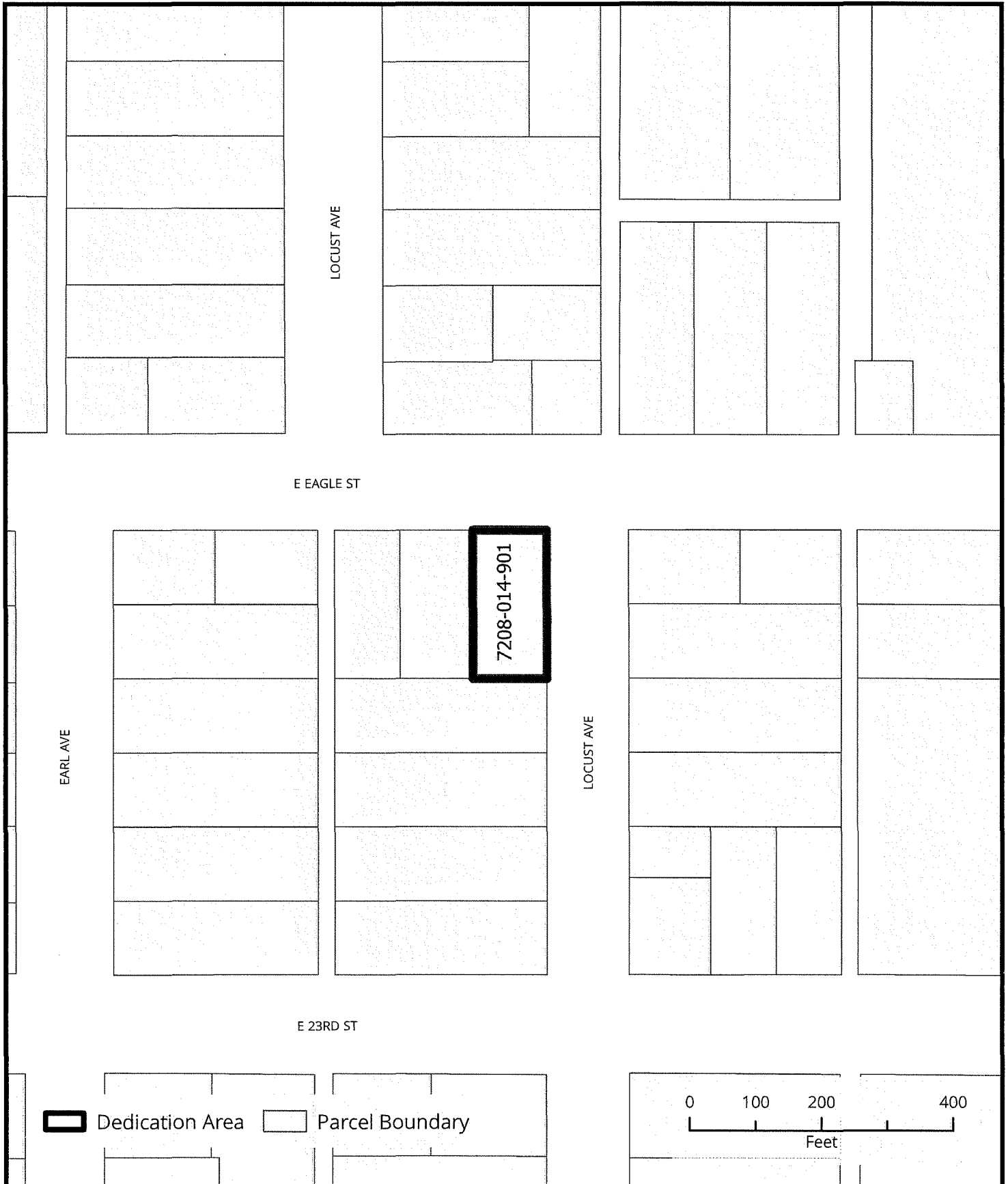

PARK DEDICATION

Locust Tot Lot

App No. 2011-21
(GPA20-002, ZCA20-016)



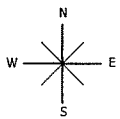
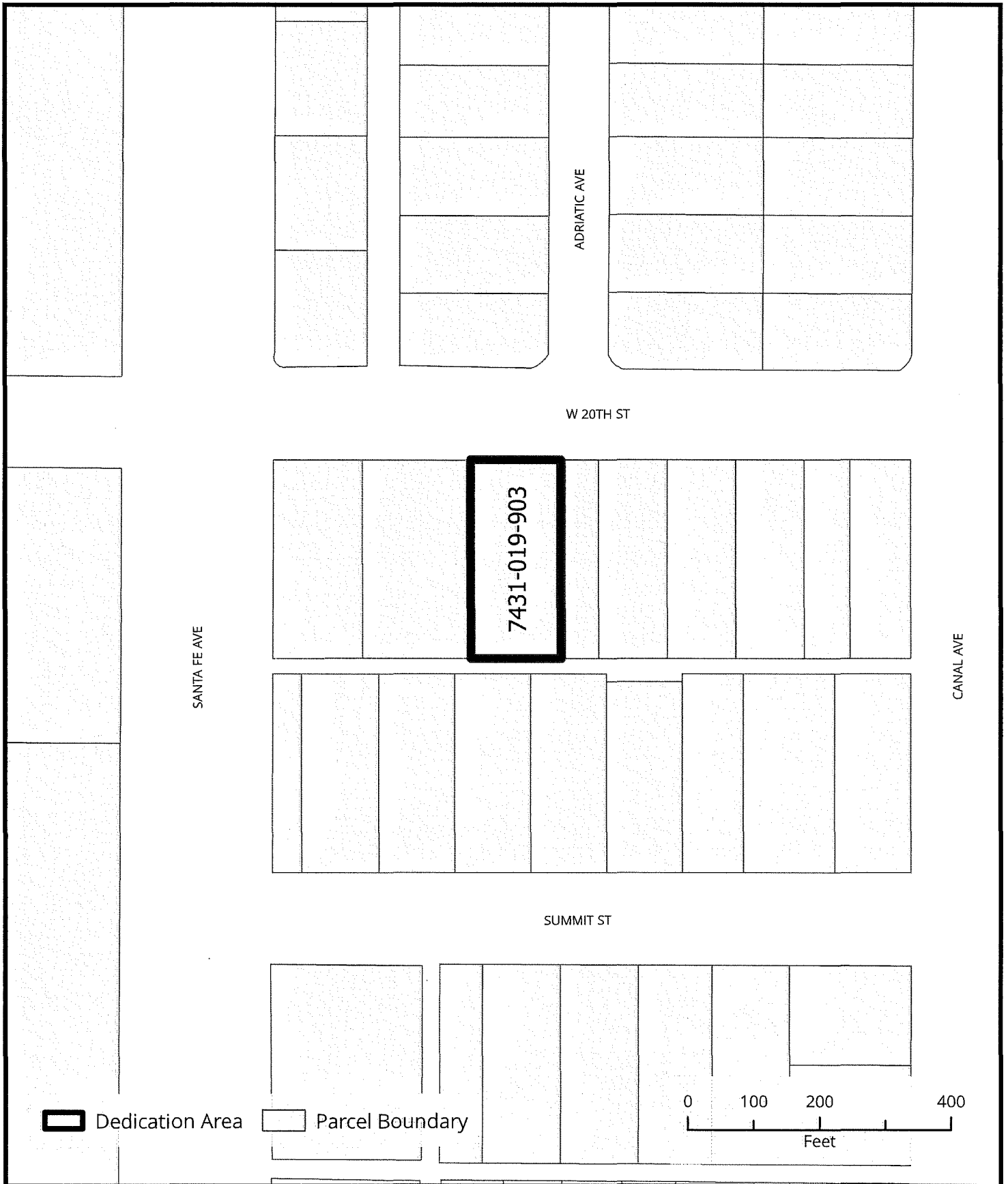

PARK DEDICATION
 Mary Molina Community Garden

App No. 2011-21
 (GPA20-002, ZCA20-016)



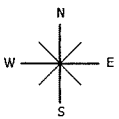
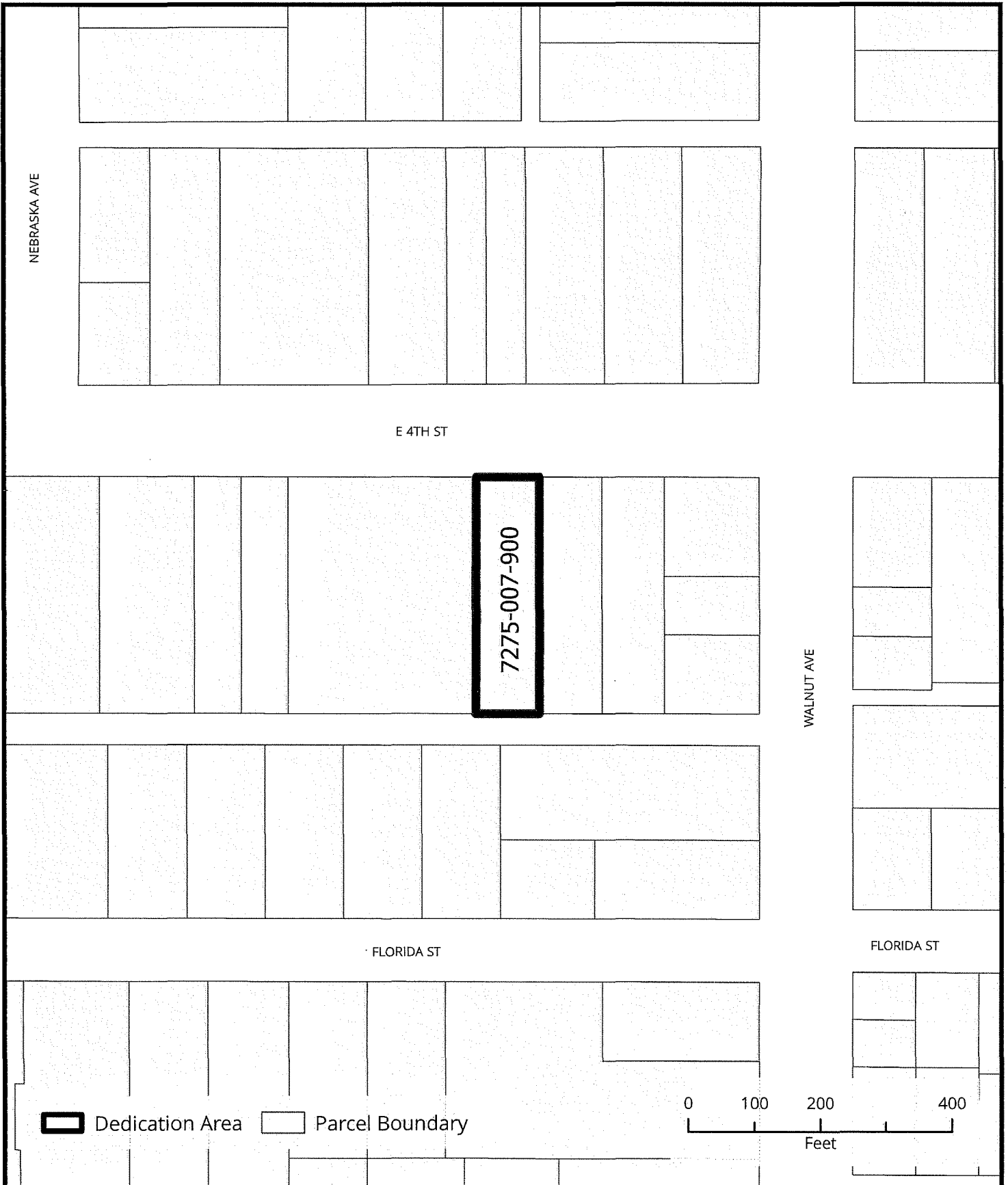

PARK DEDICATION

Miracle on 4th Street

App No. 2011-21
(GPA20-002, ZCA20-016)



E 15TH ST

E 15TH ST





SPAULDING ST

E 14TH ST

TEMPLE AVE

ORIZABA AVE

GLADYS AVE

-  Existing Dedication
-  Proposed Dedication
-  Remove Dedication
-  Parcel Boundary

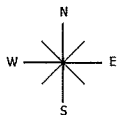
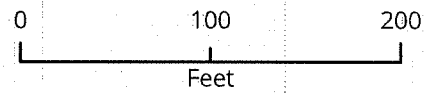

PARK DEDICATION

Orizaba Park

App No. 2011-21
(GPA20-002, ZCA20-016)

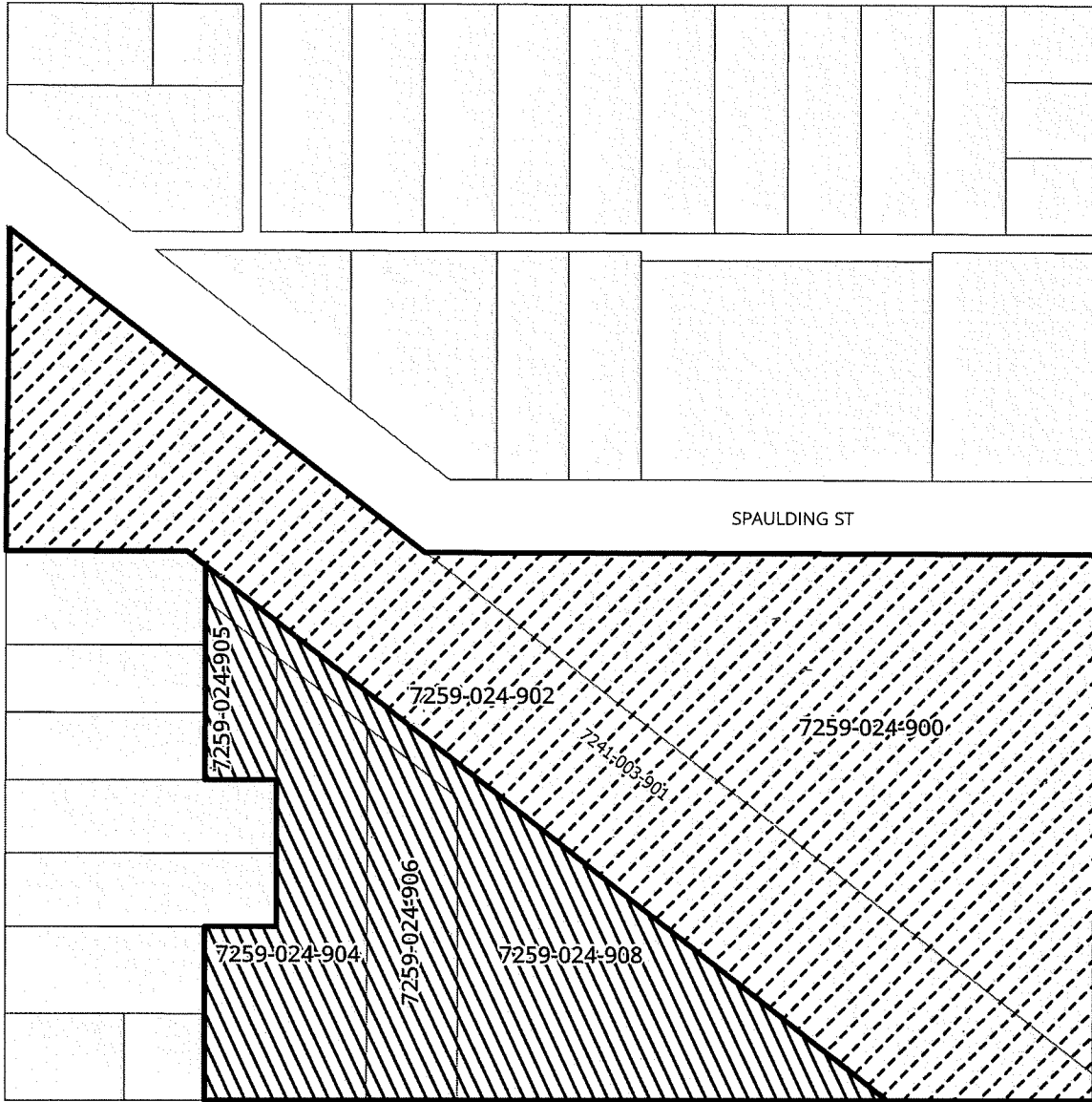

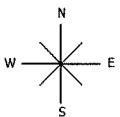
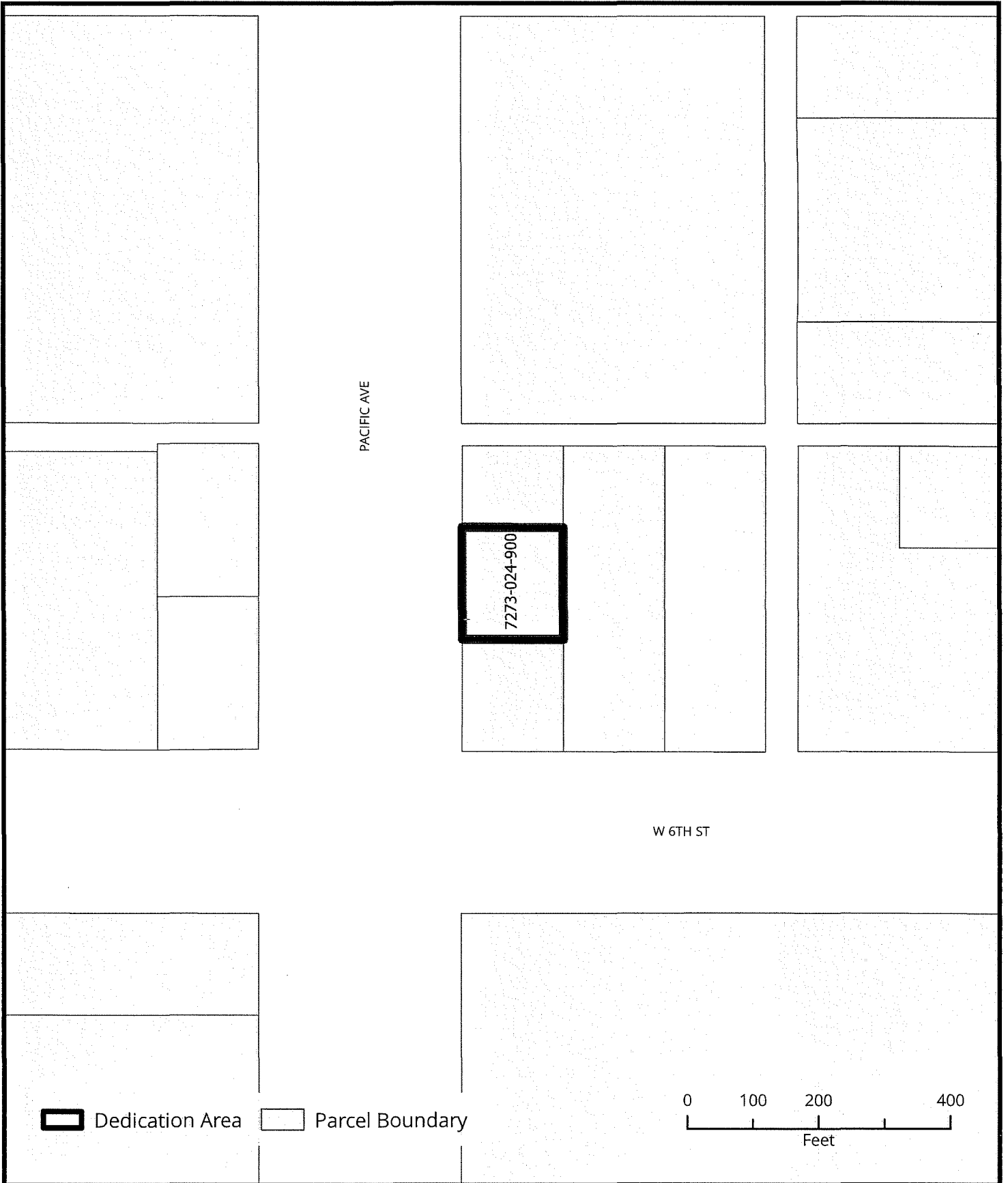

PARK DEDICATION
Pacific and 6th Community Garden

App No. 2011-21
(GPA20-002, ZCA20-016)
LONG BEACH DEVELOPMENT SERVICES

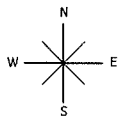
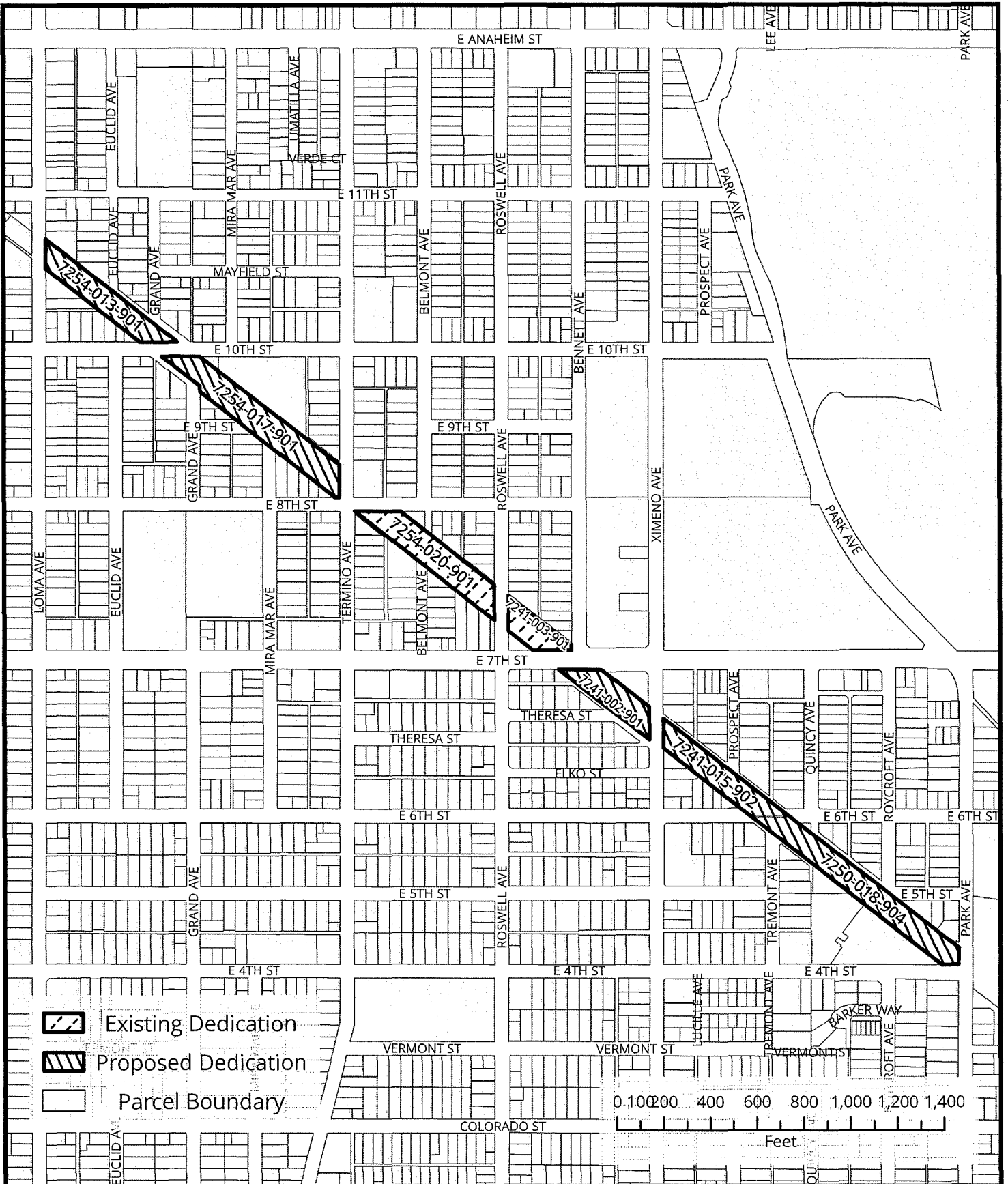

PARK DEDICATION

PACIFIC ELECTRIC RAILWAY GREENBELT

App No. 2011-21
(GPA20-002, ZCA20-016)

