



# LONG BEACH REDEVELOPMENT AGENCY

333 WEST OCEAN BOULEVARD, THIRD FLOOR • LONG BEACH, CA 90802 • (562) 570-6615 • FAX (562) 570-6215

April 16, 2007

## REDEVELOPMENT AGENCY BOARD MEMBERS

City of Long Beach  
California

### RECOMMENDATION:

Recommendation to approve the Promenade Open Space Master Plan.  
(Downtown – Districts 1, 2)

### DISCUSSION

The Promenade Open Space Master Plan incorporates the design of more than three blocks and includes elements such as public art, seating, outdoor dining, lighting, landscaping, and water features. The project will be built over a three-year timeframe, phased for completion along with the adjacent developments.

A major component of the plan is the public art, funded by the percent for public art contribution from the developers. On December 4, 2006, the Redevelopment Agency (Agency) approved the contracts for the three artists that will be developing art for each of the blocks.

Jon David Cicchetti Landscape Architects is designing The Promenade Master Plan and working with the selected artists and Arts Council for Long Beach (ACLB) on the design and implementation of the public art components. The Master Plan was presented to the Agency at the meeting of March 5, 2007.

With Agency approval, the Master Plan will be presented to the Planning Commission on April 19, 2007. We are hoping to break ground on the middle block (1<sup>st</sup> Street to Broadway) during the summer and complete the improvements by the end of the year.

### SUGGESTED ACTION:

Approve recommendation.

REDEVELOPMENT AGENCY BOARD MEMBERS

April 16, 2007

Page 2

Respectfully submitted,

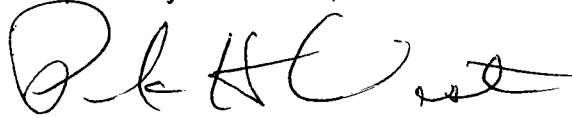

PATRICK H. WEST  
EXECUTIVE DIRECTOR

PHW:CAB:bec

APPROVED:

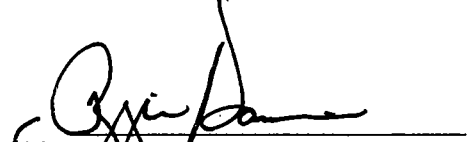
  
GERALD R. MILLER  
CITY MANAGER

Attachment: Exhibit A – Promenade Design Plan

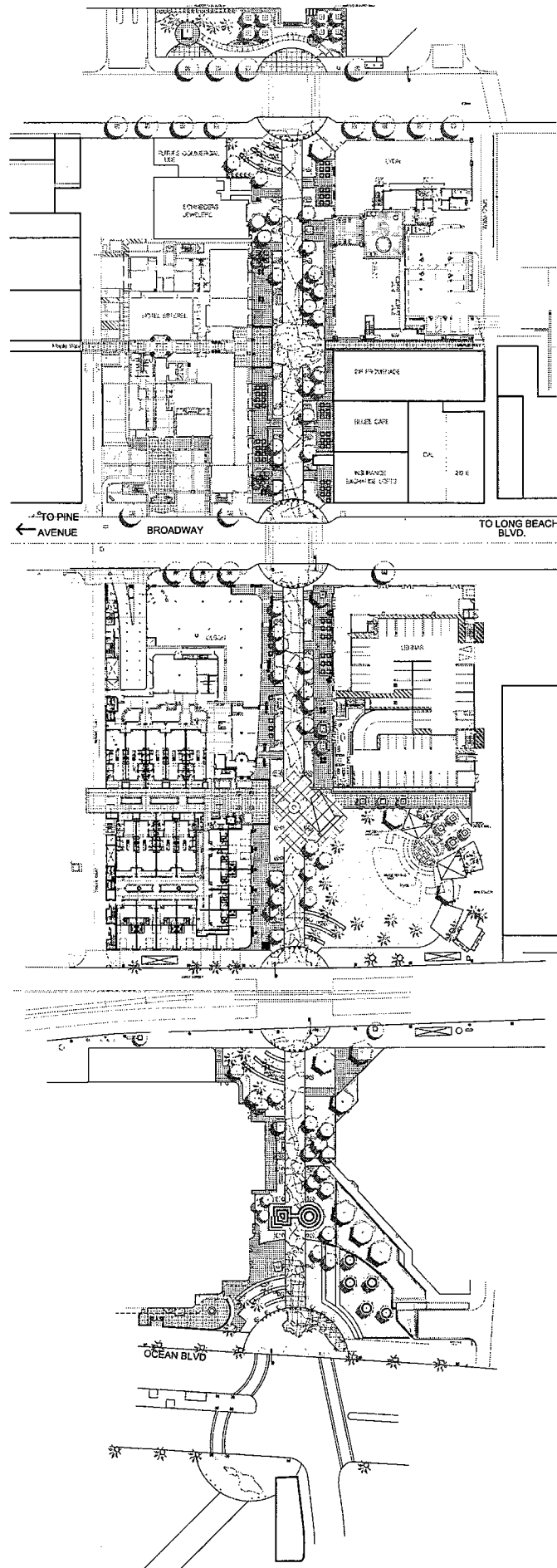

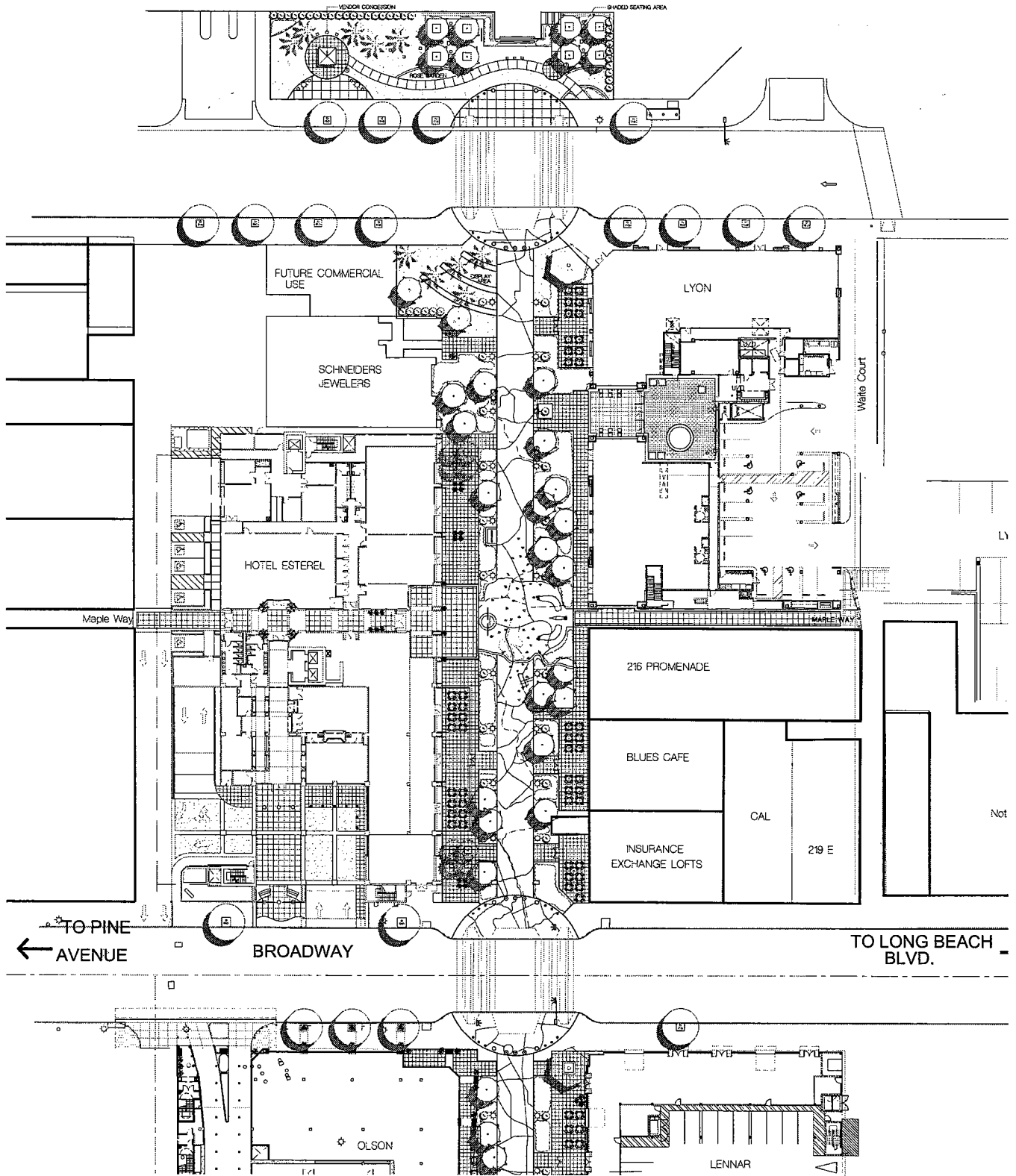

LEGEND

- |  |                      |  |   |
|--|----------------------|--|---|
|  | GOLDEN TRUMPET TREE  |  | TURF                                      |
|  | GOLDEN RAIN TREE     |  | GROUNDCOVER AND SHRUB AREAS               |
|  | GINKGO BILOBA        |  | CONCRETE PAVING WITH 2' X 2' SCORING GRID |
|  | MEXICAN FAN PALM     |  | CONCRETE PAVING WITH 3' X 3' SCORING GRID |
|  | MAGNOLIA 'ST. MARYS' |  | NEW 12' HIGH PEDESTRIAN LIGHT STANDARD    |
|  | ITALIAN CYPRESS      |  | GATEWAY / SIGNAGE ELEMENT                 |
|  | PLANTER POTS         |  | REMOVABLE BOLLARD                         |
|  |                      |  | DECORATIVE LIGHT TOWER                    |
|  |                      |  | TRASH CAN                                 |
|  |                      |  | BENCH WITH INDIVIDUAL SEATS               |
|  |                      |  | CHESS TABLE WITH CHAIRS                   |
|  |                      |  | OUTDOOR CAFE TABLE                        |
|  |                      |  | 18" SEAT CUBE                             |
|  |                      |  | BIKE RACKS                                |

# DESIGN PLAN - NORTH BLOCK

## THE PROMENADE, LONG BEACH, CALIFORNIA

NORTH  
 SCALE: 1" = 20'  
**JON DAVID CICCHETTI**  
 LANDSCAPE ARCHITECTS  
 C.N. 2191  
 2760 E. SPRING ST., SUITE 110  
 LONG BEACH, CA 90806  
 (562) 688-1850  
 (562) 688-1870 FAX

DWG DATE 03/02/07

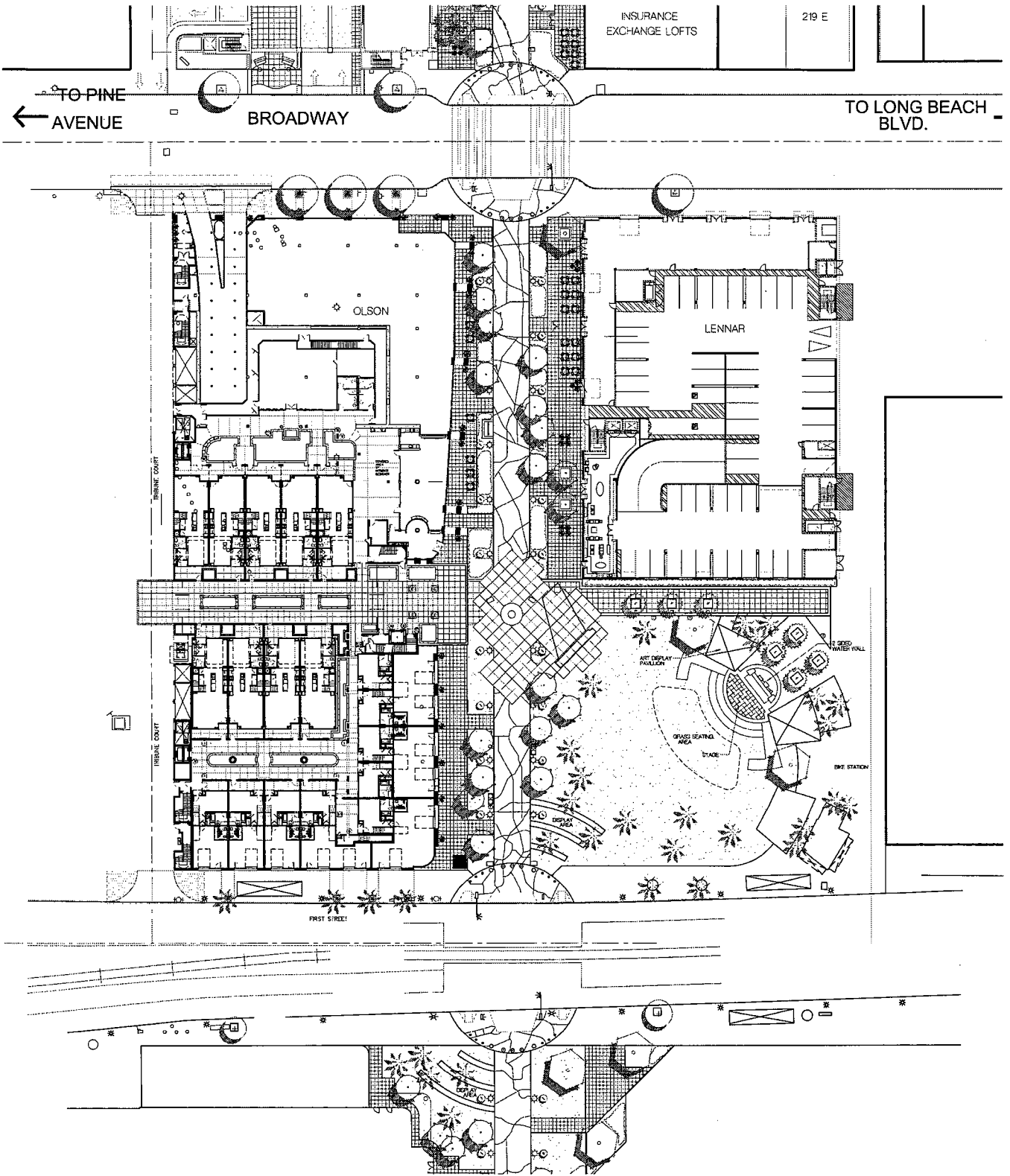

LEGEND

- |  |                      |  |   |
|--|----------------------|--|---|
|  | GOLDEN TRUMPET TREE  |  | TURF                                      |
|  | GOLDEN RAIN TREE     |  | GROUNDCOVER AND SHRUB AREAS               |
|  | GINKGO BILOBA        |  | CONCRETE PAVING WITH 2' X 2' SCORING GRID |
|  | MEXICAN FAN PALM     |  | CONCRETE PAVING WITH 3' X 3' SCORING GRID |
|  | MAGNOLIA 'ST. MARYS' |  | NEW 12' HIGH PEDESTRIAN LIGHT STANDARD    |
|  | ITALIAN CYPRESS      |  | GATEWAY / SIGNAGE ELEMENT                 |
|  | PLANTER POTS         |  | REMOVABLE BOLLARD                         |
|  |                      |  | DECORATIVE LIGHT TOWER                    |
|  |                      |  | TRASH CAN                                 |
|  |                      |  | BENCH WITH INDIVIDUAL SEATS               |
|  |                      |  | CHESS TABLE WITH CHAIRS                   |
|  |                      |  | OUTDOOR CAFE TABLE                        |
|  |                      |  | 18' SEAT CUBE                             |
|  |                      |  | BIKE RACKS                                |

# DESIGN PLAN - MIDDLE BLOCK

## THE PROMENADE, LONG BEACH, CALIFORNIA

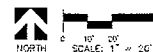

**JON DAVID CICCETTI**  
 LANDSCAPE ARCHITECTS  
 C.N. 2191

DATE 03/02/07

2780 E. SPRING ST., SUITE 110  
 LONG BEACH, CA 90808  
 (562) 889-1830  
 (562) 889-1870 FAX

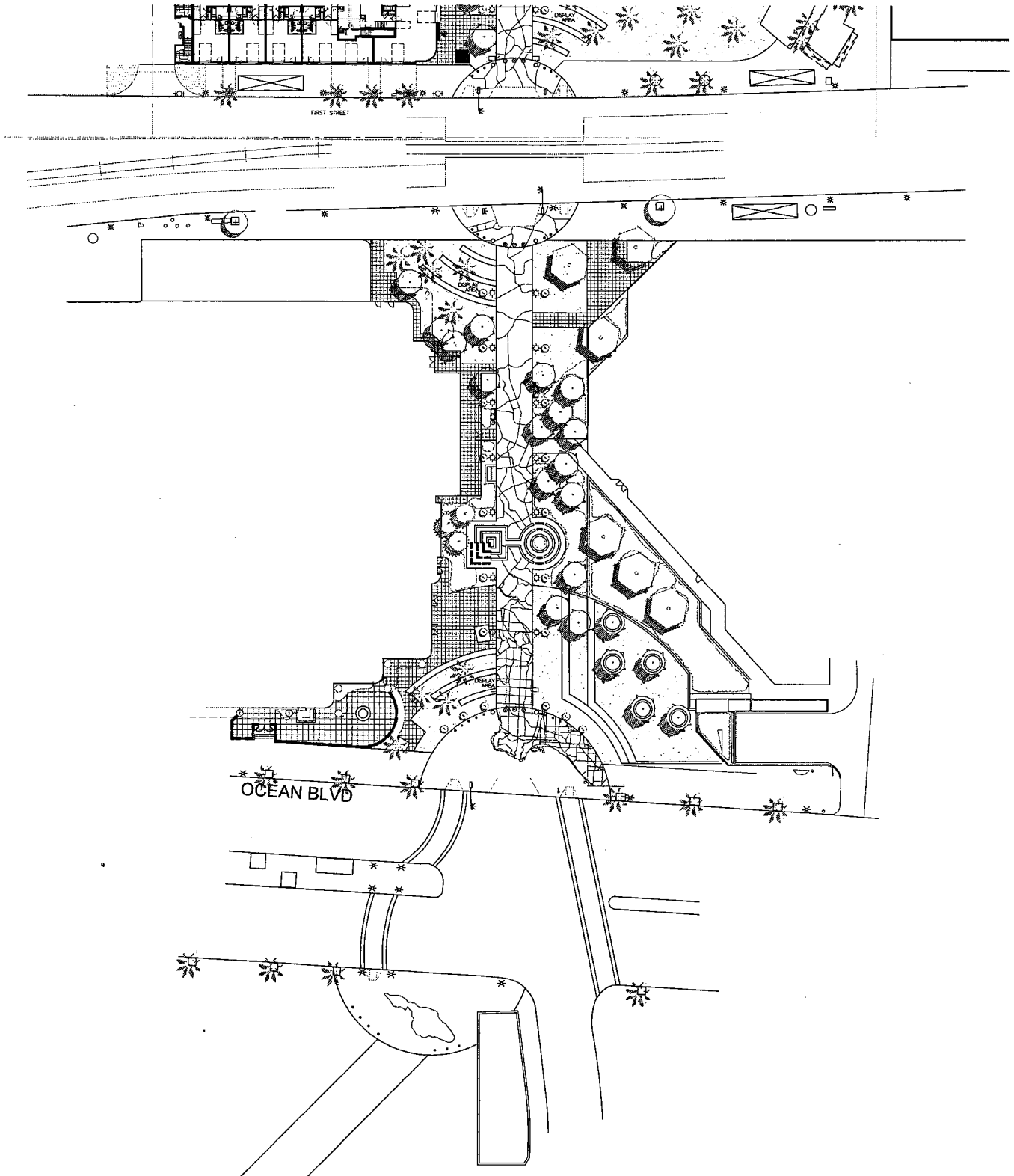

**LEGEND**

- |  |                      |  |   |
|--|----------------------|--|---|
|  | GOLDEN TRUMPET TREE  |  | TURF                                      |
|  | GOLDEN RAIN TREE     |  | GROUNDCOVER AND SHRUB AREAS               |
|  | GINKGO BILOBA        |  | CONCRETE PAVING WITH 2' X 2' SCORING GRID |
|  | MEXICAN FAN PALM     |  | CONCRETE PAVING WITH 3' X 3' SCORING GRID |
|  | MAGNOLIA 'ST. MARYS' |  | NEW 12' HIGH PEDESTRIAN LIGHT STANDARD    |
|  | ITALIAN CYPRESS      |  | GATEWAY / SIGNAGE ELEMENT                 |
|  | PLANTER POTS         |  | REMOVABLE BOLLARD                         |
|  |                      |  | DECORATIVE LIGHT TOWER                    |
|  |                      |  | TRASH CAN                                 |
|  |                      |  | BENCH WITH INDIVIDUAL SEATS               |
|  |                      |  | CH-ESS TABLE WITH CHAIRS                  |
|  |                      |  | OUTDOOR CAFE TABLE                        |
|  |                      |  | 18" SEAT CUBE                             |
|  |                      |  | BIKE RACKS                                |

**DESIGN PLAN - SOUTH BLOCK**

THE PROMENADE, LONG BEACH, CALIFORNIA

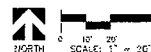

DWG DATE: 03/02/07

**JON DAVID CICCETTI**  
LANDSCAPE ARCHITECTS  
CA. 2191

2780 E. SPRING ST., SUITE 110  
LONG BEACH, CA 90806  
(562) 989-1850  
(562) 989-1870 FAX