

CITY OF LONG BEACH

DEPARTMENT OF PUBLIC WORKS

333 WEST OCEAN BOULEVARD, 9th Floor LONG BEACH, CA 90802 562.570.6383 FAX 562.570.6012

December 2, 2014

HONORABLE MAYOR AND CITY COUNCIL
City of Long Beach
California

RECOMMENDATION:

Authorize the City Manager to execute a Public Walkways Occupancy Permit for sidewalk dining at Sushi Ai Restaurant located at 5260 East Second Street.
(District 3)

DISCUSSION

IJ LEE, Inc., the operator of Sushi Ai restaurant, requests a permit to temporarily occupy part of the adjoining sidewalk at 5260 East Second Street, for the purpose of sidewalk dining. The proposed permit area sketch and a list of furnishings and accessories to be placed in the permit area, are shown on the attachment. Approval of this permit is based on the conditions and standards of Chapter 14.14 of the Long Beach Municipal Code, which describes temporary uses of public right-of-way. The width of the sidewalk is 13½ feet. A minimum clearance of 5 feet will be maintained between the sidewalk dining area and existing sidewalk fixtures. Usage of the sidewalk dining area is restricted to the hours between 10:00 a.m. and 10:00 p.m.

This matter was reviewed by the Long Beach Fire Department on August 21, 2014, by Deputy City Attorney Linda Vu on October 1, 2014, and by Budget Management Officer Victoria Bell on November 7, 2014.

TIMING CONSIDERATIONS

City Council action on this matter is not time critical.

FISCAL IMPACT

A permit processing fee in the amount of \$616 was deposited into the General Fund (GF) in the Public Works Department (PW) and a security deposit of \$580 was provided to assure sidewalk repairs upon permit termination. Approval of this recommendation will provide continued support to the local economy.

HONORABLE MAYOR AND CITY COUNCIL

December 2, 2014

Page 2

SUGGESTED ACTION:

Approve recommendation.

Respectfully submitted,



ARA MALOYAN, PE
DIRECTOR OF PUBLIC WORKS

APPROVED:



PATRICK H. WEST
CITY MANAGER

P\C\LPWOP- Sushi Ai Restaurant CL.doc
AM:GMM:SDJ:st

Attachment: Sketch and List of Furnishings

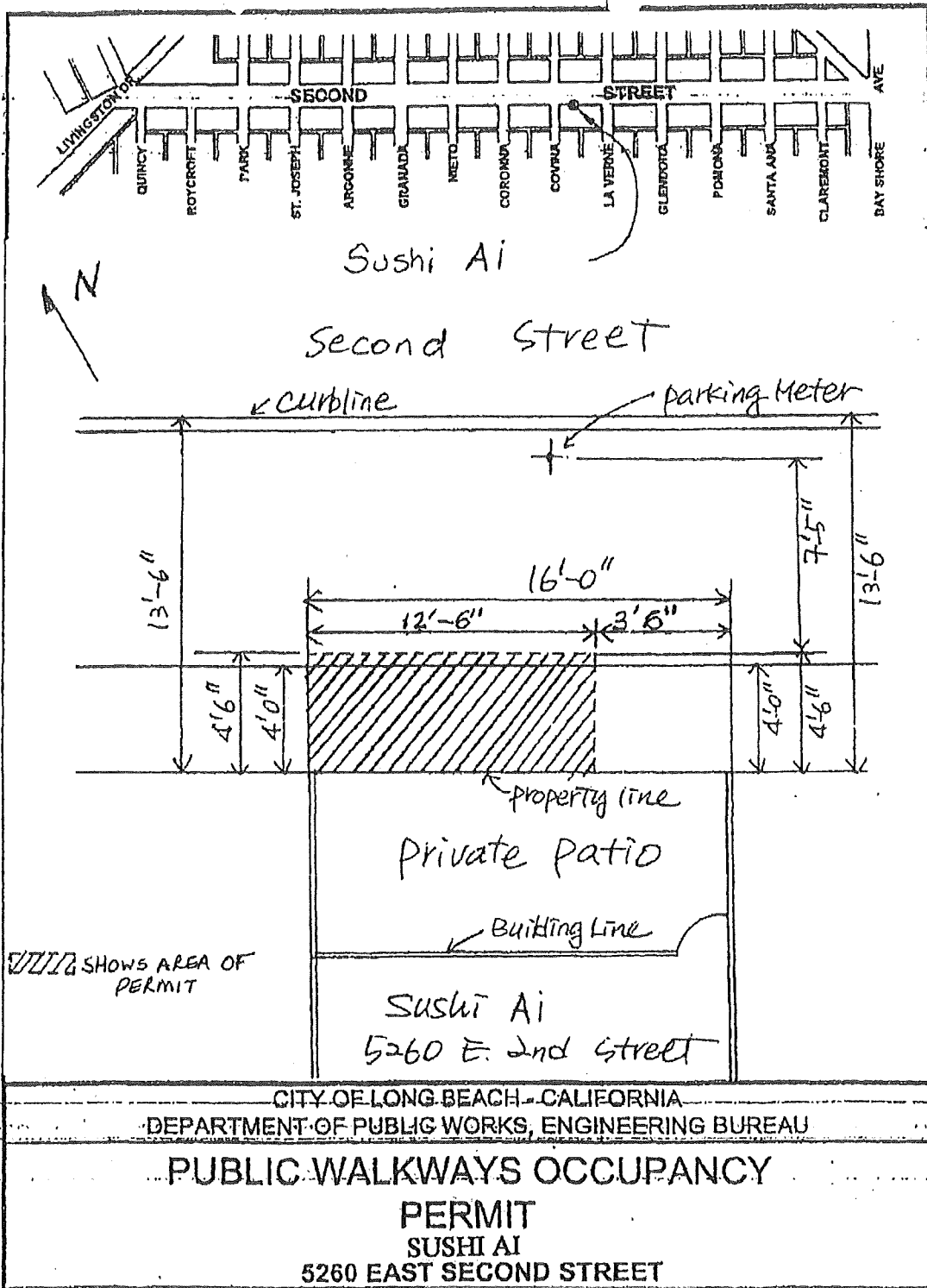

List of Approved Furnishings and Accessories
(Attachment to Public Walkways Occupancy Permit for Sidewalk Dining Purposes)

Restaurant: Sushi Ai Permittee: IT LEE, Inc.

Address: 5160 E. 2nd Street Telephone: (949) 677-2503
Long Beach, CA 90803

Tables
number: 2

Chairs
number: 3

Umbrella(s)
height & number: N/A

Heater(s)
height & number: _____

Menu board
note: maximum height of 5 ft 6 in, maximum width of 2 ft
& none permitted in the coastal zone

Water station
size: _____

Planters for trees or other greenscaping
describe: _____

Other: _____

We intend to make occasional use of the permit area for live or recorded entertainment
(Note: A separate entertainment permit is required).

- The following are prohibited:
- canopies (ground supported)
 - television monitors

Permittee signature:  Date: 7/22/14

Print name here: SANG JI LEE

This list of furnishings and accessories is effective only when attached to a completed Public Walkways Occupancy Permit.