

RESOLUTION NO. C-

A RESOLUTION OF THE CITY COUNCIL OF THE CITY OF LONG BEACH AUTHORIZING THE DIRECTOR OF PLANNING AND BUILDING TO SUBMIT TO THE CALIFORNIA COASTAL COMMISSION FOR ITS REVIEW AND CONSIDERATION AN ORDINANCE DESIGNATING AND DEDICATING IN PERPETUITY CERTAIN AREAS OF THE CITY FOR PARK PURPOSES

WHEREAS, on December 23, 2003, the City Council of the City of Long Beach adopted Ordinance No. C-7894 designating and dedicating in perpetuity certain areas of the City for park purposes; and

WHEREAS, in order to certify the designation and dedication of parks in perpetuity, the California Coastal Commission has requested certain boundary changes to the maps of Marina Green Park, Rainbow Harbor Esplanade, and Long Beach Aquarium of the Pacific; and

WHEREAS, on \_\_\_\_\_, 2004, the City Council of the City of Long Beach adopted Ordinance No. \_\_\_\_\_ amending and restating the designation and dedication in perpetuity of certain areas of the City for park purposes in accordance with the California Coastal Commission modifications; and

WHEREAS, it is the desire of the City Council to submit the amended and restated Ordinance to the California Coastal Commission for its review as an implementing Ordinance of the Long Beach Local Coastal Program (LCP); and

WHEREAS, the City Council gave full consideration to all facts and the proposals respecting the Ordinance at properly noticed and advertised public hearings; and

WHEREAS, the City Council approved the proposed changes to the LCP

Robert E. Shannon  
City Attorney of Long Beach  
333 West Ocean Boulevard  
Long Beach, California 90802-4664  
Telephone (562) 570-2200

1  
2  
3  
4  
5  
6  
7  
8  
9  
10  
11  
12  
13  
14  
15  
16  
17  
18  
19  
20  
21  
22  
23  
24  
25  
26  
27  
28

Robert E. Shannon  
City Attorney of Long Beach  
333 West Ocean Boulevard  
Long Beach, California 90802-4664  
Telephone (562) 570-2200

1 by adopting the Amended and Restated Parks in Perpetuity Ordinance. The proposed  
2 Parks in Perpetuity Ordinance is to be carried out in a manner fully consistent with the  
3 Coastal Act and become effective in the Coastal Zone immediately upon Coastal  
4 Commission review and certification; and

5 NOW, THEREFORE, the City Council of the City of Long Beach resolves  
6 as follows:

7 Section 1. The Amended and Restated Ordinance dedicating and  
8 designating certain areas of the City in perpetuity for park purposes as adopted by  
9 Ordinance No. C-\_\_\_\_\_ of the Long Beach City Council on \_\_\_\_\_, 2004, a  
10 copy of which is attached to and incorporated in this resolution as Exhibit "A", is hereby  
11 submitted to the California Coastal Commission for its earliest review as to those parts  
12 of the Ordinance that directly affect land use matters in that portion of the California  
13 Coastal Zone within the City of Long Beach.

14 Sec. 2. The Director of Planning and Building of the City of Long Beach is  
15 hereby authorized to and shall submit a certified copy of this resolution, together with  
16 appropriate supporting materials, to the California Coastal Commission with a request  
17 for its earliest action, as an amendment to the Local Coastal Program that will take  
18 effect automatically upon Commission approval pursuant to the Public Resources Code  
19 or as an amendment that will require formal City Council adoption after Coastal  
20 Commission approval.

21 Sec. 3. This resolution shall take effect immediately upon its adoption by  
22 the City Council, and the City Clerk shall certify the vote adopting this resolution.

23 //

24 //

25  
26  
27  
28

Robert E. Shannon  
City Attorney of Long Beach  
333 West Ocean Boulevard  
Long Beach, California 90802-4664  
Telephone (562) 570-2200

1  
2  
3  
4  
5  
6  
7  
8  
9  
10  
11  
12  
13  
14  
15  
16  
17  
18  
19  
20  
21  
22  
23  
24  
25  
26  
27  
28

I certify that this resolution was adopted by the City Council of the City of Long Beach at its meeting of \_\_\_\_\_, 2004, by the following vote:

Ayes: Councilmembers: \_\_\_\_\_  
\_\_\_\_\_

Noes: Councilmembers: \_\_\_\_\_  
\_\_\_\_\_

Absent: Councilmembers: \_\_\_\_\_  
\_\_\_\_\_

\_\_\_\_\_  
City Clerk



1 Open Space and Recreation Element of the General Plan of the City of Long Beach,  
2 the following areas of the City are hereby set aside and dedicated in perpetuity for  
3 public park purposes. Exhibit "A" attached hereto and incorporated herein by reference  
4 generally outlines the boundaries of said areas.

5 Park Name

6 Admiral Kidd

7 Atlantic Plaza

8 Birdcage

9 Bixby Knolls

10 Bluff Park

11 Bouton Creek

12 California Recreation Center

13 Carroll

14 Cesar E. Chavez

15 Channel View

16 Cherry

17 College Estates

18 Coolidge

19 Daisy Ave

20 Deforest

21 Douglas

22 Drake

23 East Village Arts

24 El Dorado Park West

25 El Dorado Park Golf Course

26 El Dorado Regional Park

27 El Dorado - Nature/Comm Grdns

28 Fourteenth Street

Heartwell

Heartwell (Campfire)

Heartwell Park Golf Course

Robert E. Shannon  
City Attorney of Long Beach  
333 West Ocean Boulevard  
Long Beach, California 90802-4664  
Telephone (562) 570-2200

- 1 Houghton
- 2 Hudson
- 3 Jack Dunster Marine Reserve
- 4 Jack Nichol
- 5 Jackson Street
- 6 La Bella Fontana di Napoli
- 7 Lilly
- 8 Lincoln
- 9 Livingston Drive
- 10 Lookout
- 11 Los Altos
- 12 Los Altos Plaza
- 13 Los Cerritos
- 14 MacArthur
- 15 Martin Luther King Jr.
- 16 Orizaba
- 17 Pacific Electric Right-of-Way
- 18 Pan American
- 19 Plaza Zaferia
- 20 Ramona
- 21 Recreation
- 22 Recreation Park Golf Course
- 23 Recreation - 9 Hole (North of 6th St)
- 24 Rose
- 25 Scherer
- 26 Silverado
- 27 Skylinks
- 28 Sleepy Hollow
- 29 Somerset
- 30 South Street Parkway
- 31 Stearns Champions
- 32 Treasure Island

1 Veterans  
2 Wardlow  
3 Whaley.

4

5 Sec. 2. Tidelands Trust Designation.

6 In accordance with the goals, objectives, policies and programs of the  
7 Local Coastal Program of the City of Long Beach, the following areas within the  
8 Tidelands Trust boundaries are hereby designated in perpetuity for public park uses.  
9 Exhibit "B" attached hereto and incorporated herein by reference generally outlines the  
10 boundaries of said areas.

11

Park Name

12

Alamitos at 72nd

13

Belmont Pier & Plaza

14

Belmont Pool Complex

15

Colorado Lagoon

16

Davies Launch Ramp

17

Downtown Marina Mole

18

Golden Shore Marine Reserve

19

Golden Shore RV

20

LB Aquarium of the Pacific

21

Marina Green

22

Marina Vista

23

Marine Park (Mother's Beach)

24

Marine Stadium

25

Maurice "Mossy" Kent

26

Queen Mary Events

27

Rainbow Harbor Esplanade

28

Rainbow Lagoon

Recreation - 9 Hole (South of 6<sup>th</sup> St)

Shoreline Aquatic

Robert E. Shannon  
City Attorney of Long Beach  
333 West Ocean Boulevard  
Long Beach, California 90802-4664  
Telephone (562) 570-2200

1  
2  
3  
4  
5  
6  
7  
8  
9  
10  
11  
12  
13  
14  
15  
16  
17  
18  
19  
20  
21  
22  
23  
24  
25  
26  
27  
28

South Shore Launch Ramp  
Will Rogers.

Sec. 3. The City Clerk shall certify to the passage of this ordinance by the City Council and cause it to be posted in three conspicuous places in the City of Long Beach, and it shall take effect on the thirty-first day after it is approved by the Mayor.

I hereby certify that the foregoing ordinance was adopted by the City Council of the City of Long Beach at its meeting of \_\_\_\_\_, 200\_\_, by the following vote:

Ayes: Councilmembers: \_\_\_\_\_

\_\_\_\_\_  
\_\_\_\_\_

Noes: Councilmembers: \_\_\_\_\_

\_\_\_\_\_  
\_\_\_\_\_

Absent: Councilmembers: \_\_\_\_\_

\_\_\_\_\_  
\_\_\_\_\_

\_\_\_\_\_  
City Clerk

Approved: \_\_\_\_\_

\_\_\_\_\_  
Mayor



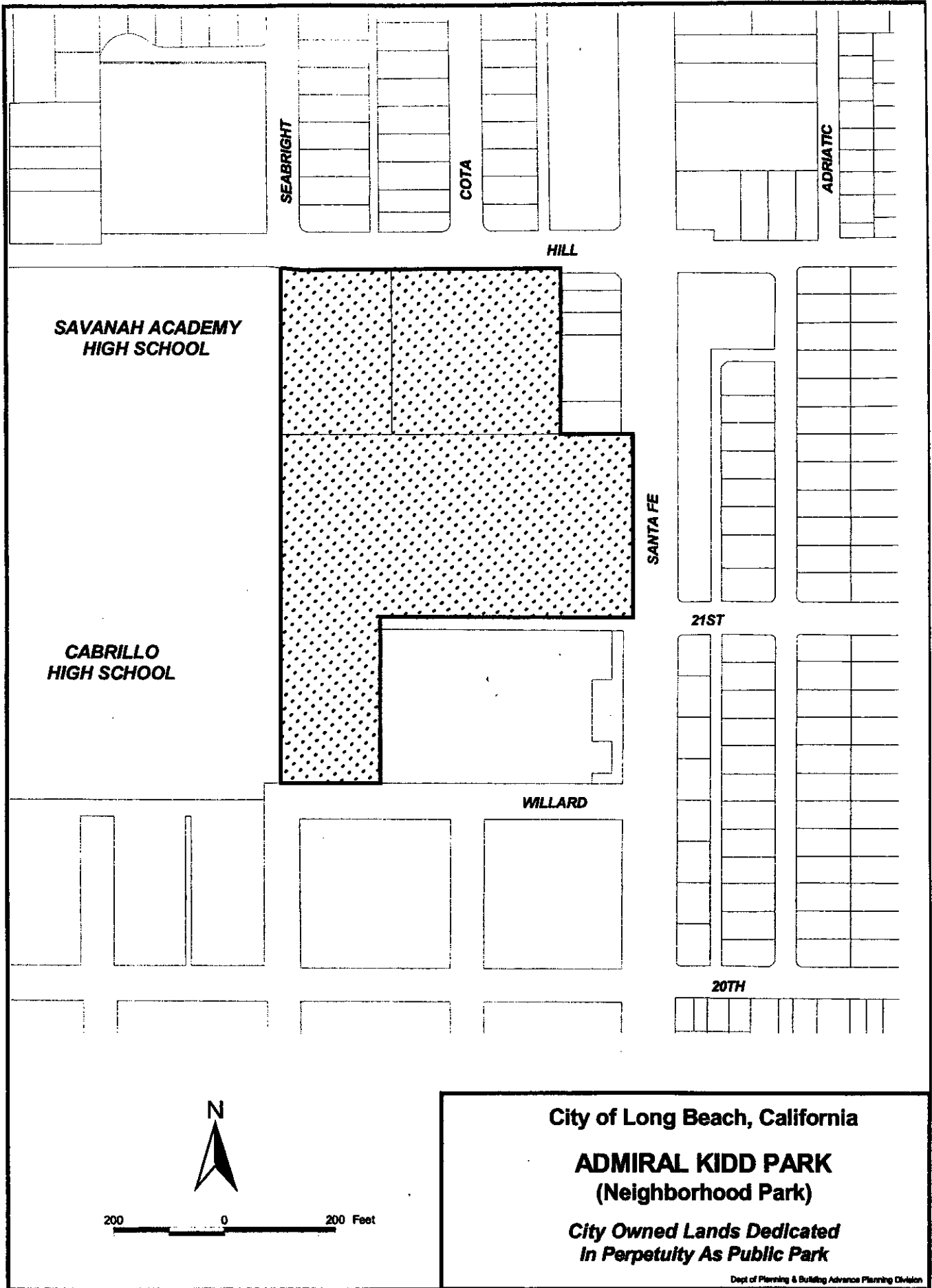

**SAVANAH ACADEMY  
HIGH SCHOOL**

**CABRILLO  
HIGH SCHOOL**

**SEABRIGHT**

**COTA**

**ADRIATIC**

**HILL**

**SANTA FE**

**21ST**

**WILLARD**

**20TH**



200 0 200 Feet

**City of Long Beach, California**  
**ADMIRAL KIDD PARK**  
**(Neighborhood Park)**  
**City Owned Lands Dedicated**  
**In Perpetuity As Public Park**  
Dept of Planning & Building Advance Planning Division

**Exhibit "A"**

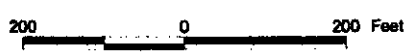
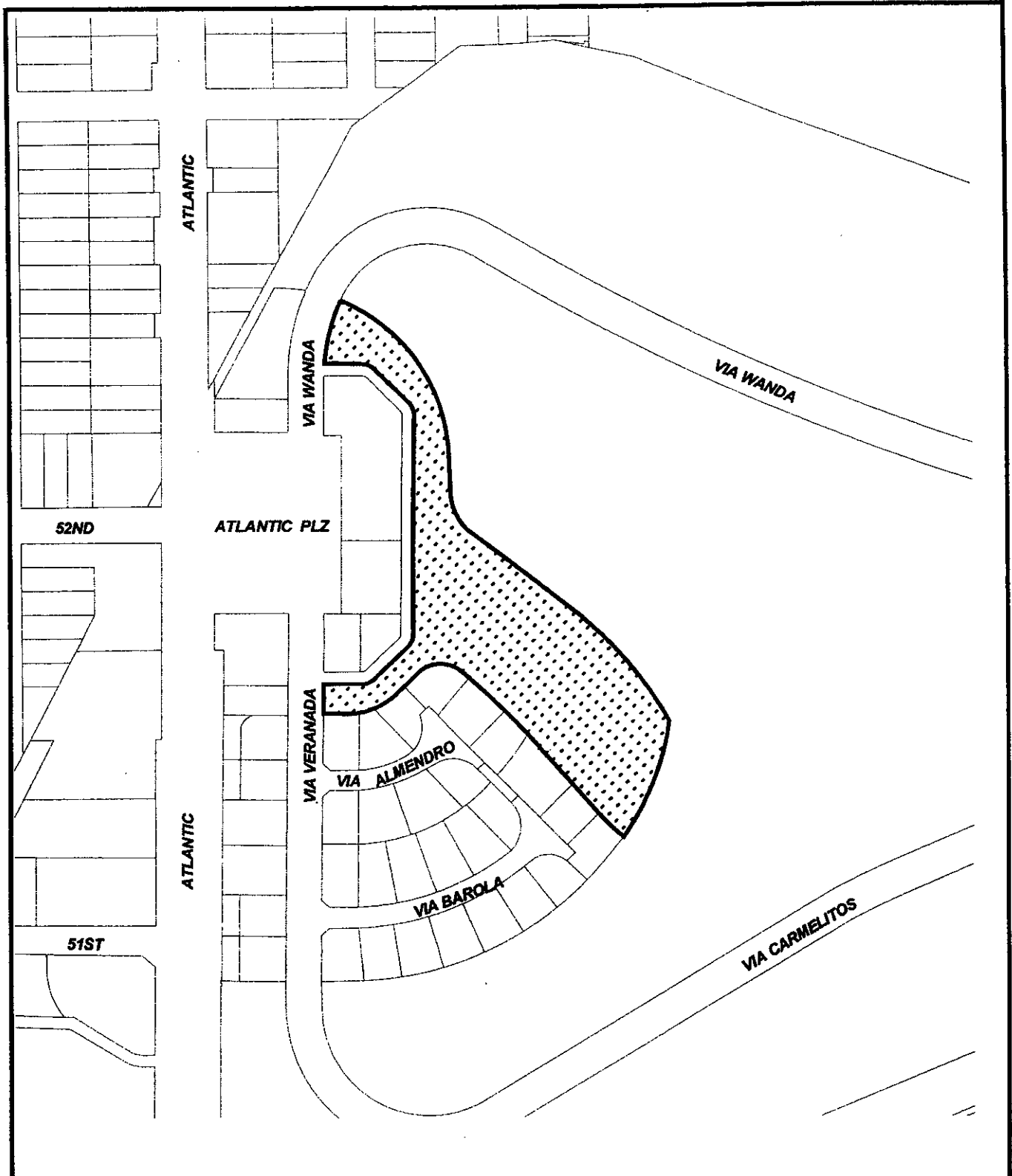

City of Long Beach, California  
**ATLANTIC PLAZA PARK**  
 (Neighborhood Park)  
*City Owned Lands Dedicated  
 In Perpetuity As Public Park*

Dept of Planning & Building Advance Planning Division

Exhibit "A"

CITY OF LAKEWOOD

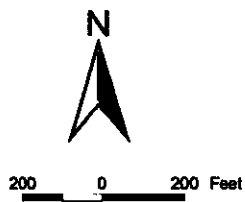
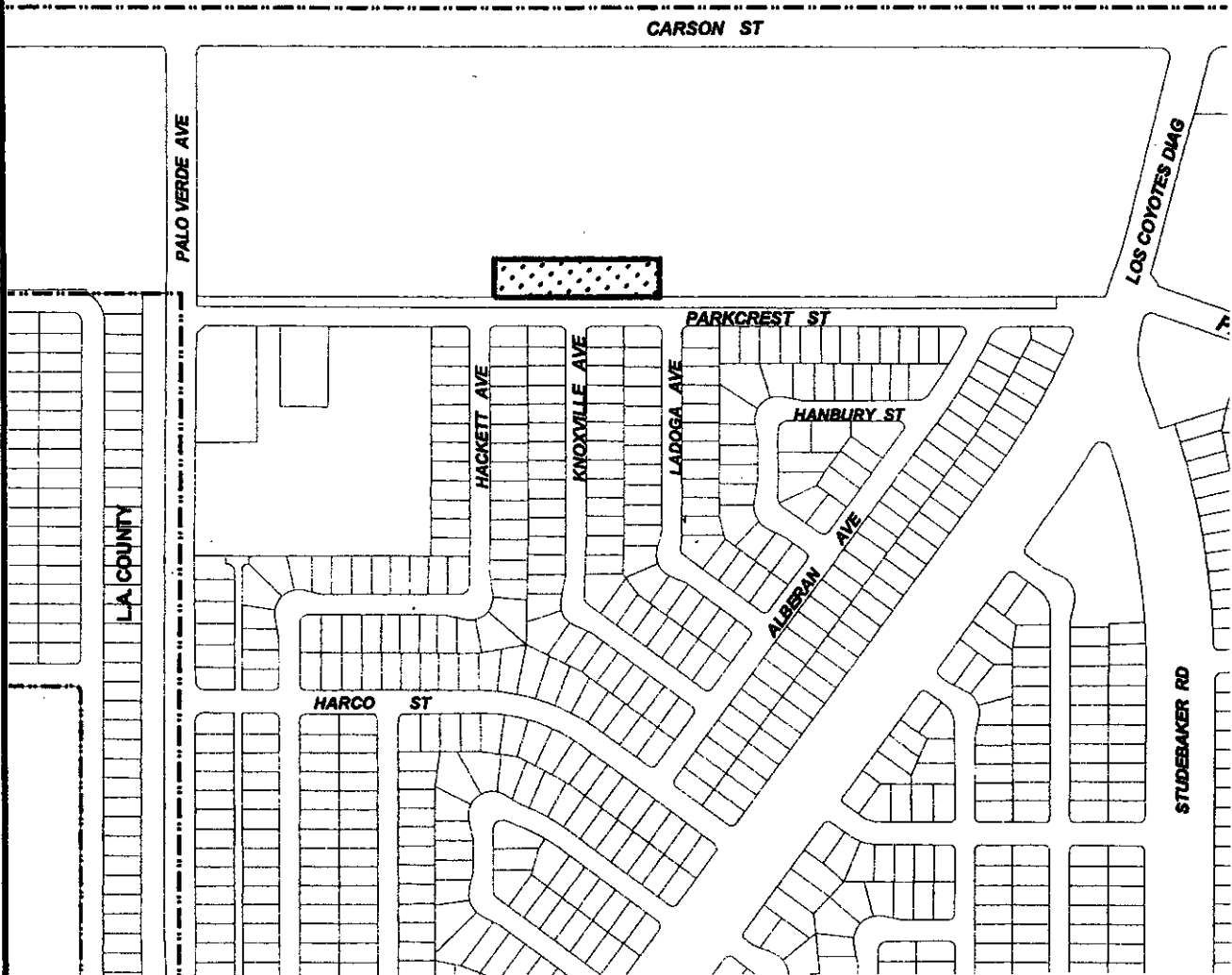

City of Long Beach, California

**BIRDCAGE PARK  
(Mini Park)**

*City Owned Lands Dedicated  
In Perpetuity As Public Park*

Dept of Planning & Building Advice Planning Division

**Exhibit "A"**

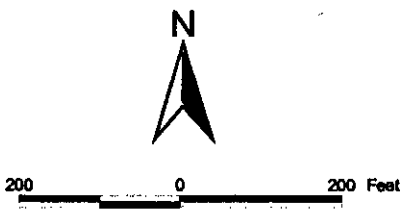
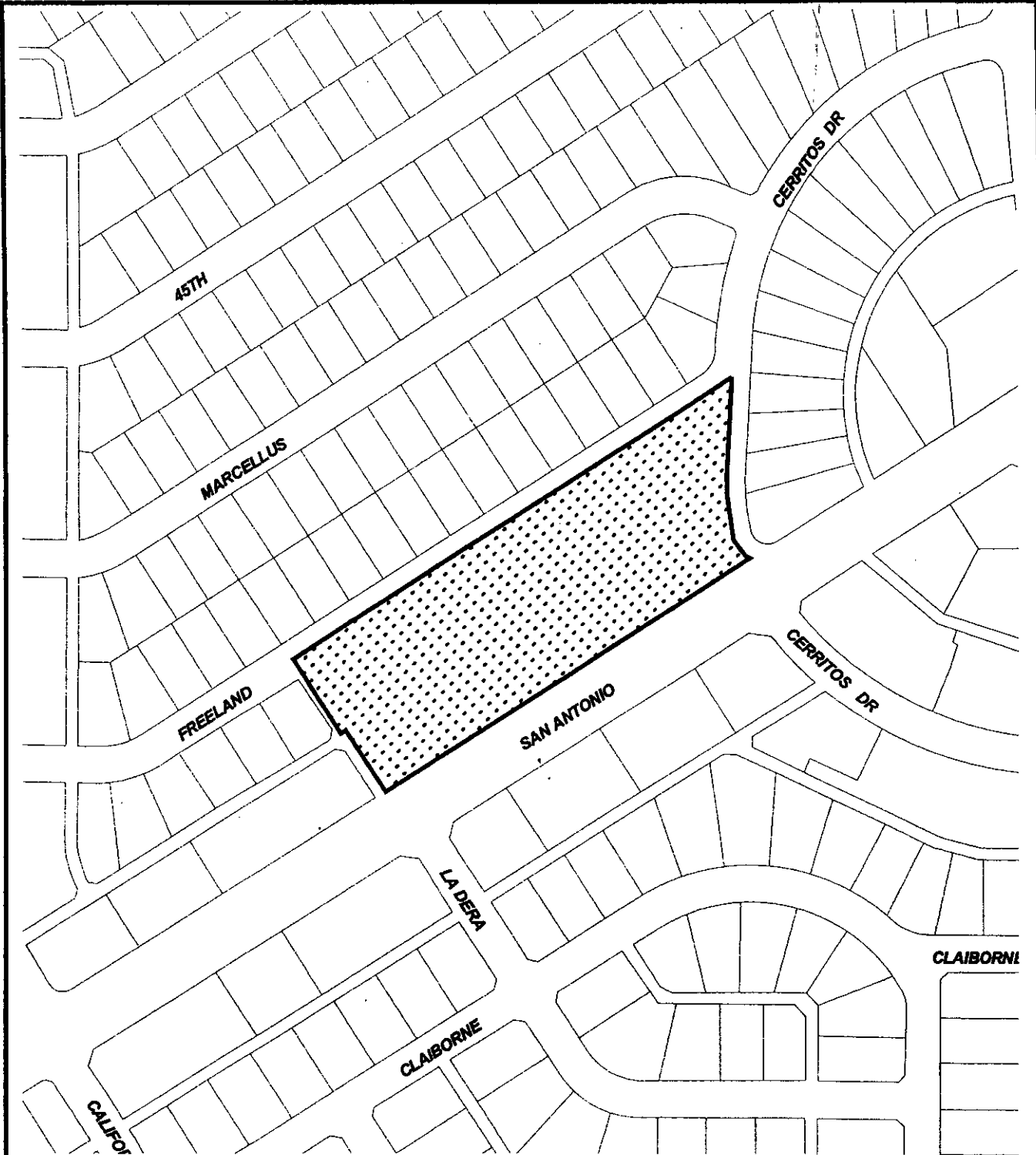

**City of Long Beach, California**  
**BIXBY KNOLLS PARK**  
**(Neighborhood Park)**  
*City Owned Lands Dedicated  
In Perpetuity As Public Park*

Dept of Planning & Building Advance Planning Division

**Exhibit "A"**

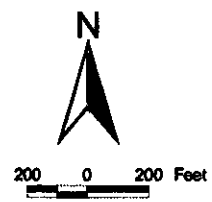
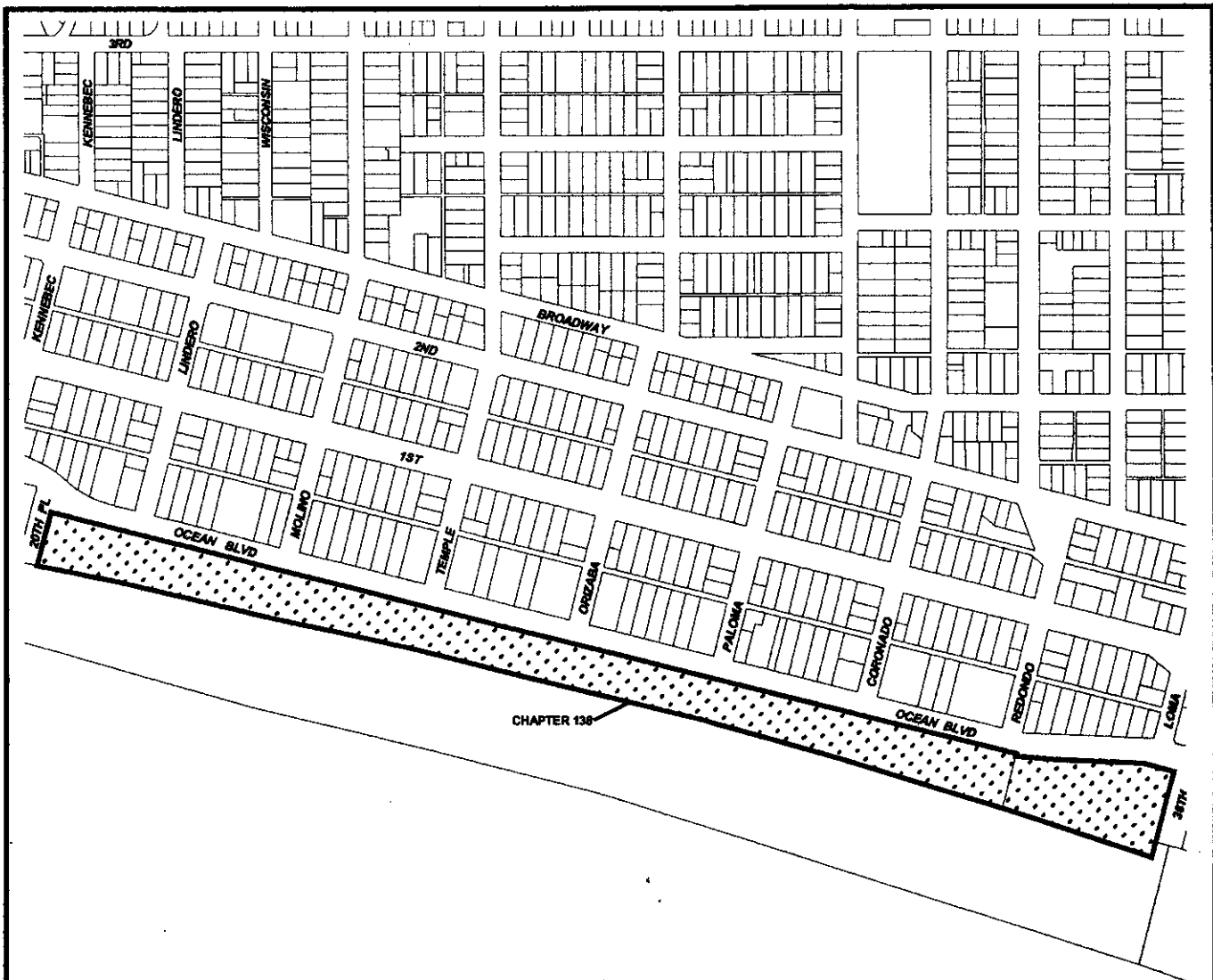

City of Long Beach, California

**BLUFF PARK**

**(Greenway Park)**

*City Owned Lands Dedicated  
In Perpetuity As Public Park*

**Exhibit "A"**

City Planning & Building Advance Planning Division



200 0 200 Feet

City of Long Beach, California

**BOUTON CREEK PARK  
(Mini Park)**

*City Owned Lands Dedicated  
In Perpetuity As Public Park*

Dept of Planning & Building Advance Planning Division

**Exhibit "A"**

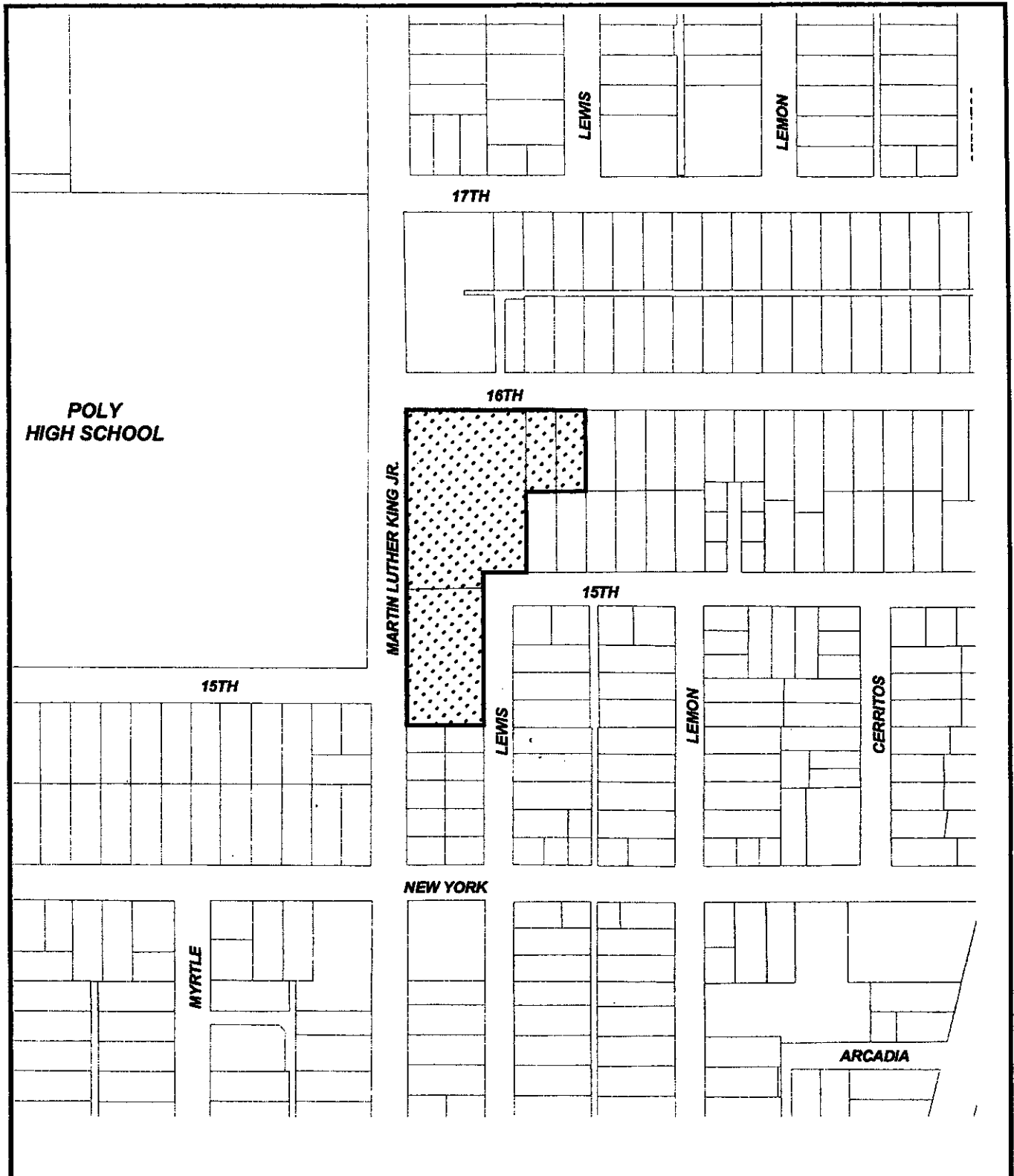

POLY  
HIGH SCHOOL

MARTIN LUTHER KING JR.

LEWIS

LEMON

17TH

16TH

15TH

15TH

LEWIS

LEMON

CERRITOS

NEW YORK

MYRTLE

ARCADIA



200 0 200 Feet

City of Long Beach, California  
**CALIFORNIA RECREATION CENTER**  
 (Neighborhood Park)  
*City Owned Lands Dedicated  
 In Perpetuity As Public Park*

Dept of Planning & Building Advance Planning Division

Exhibit "A"

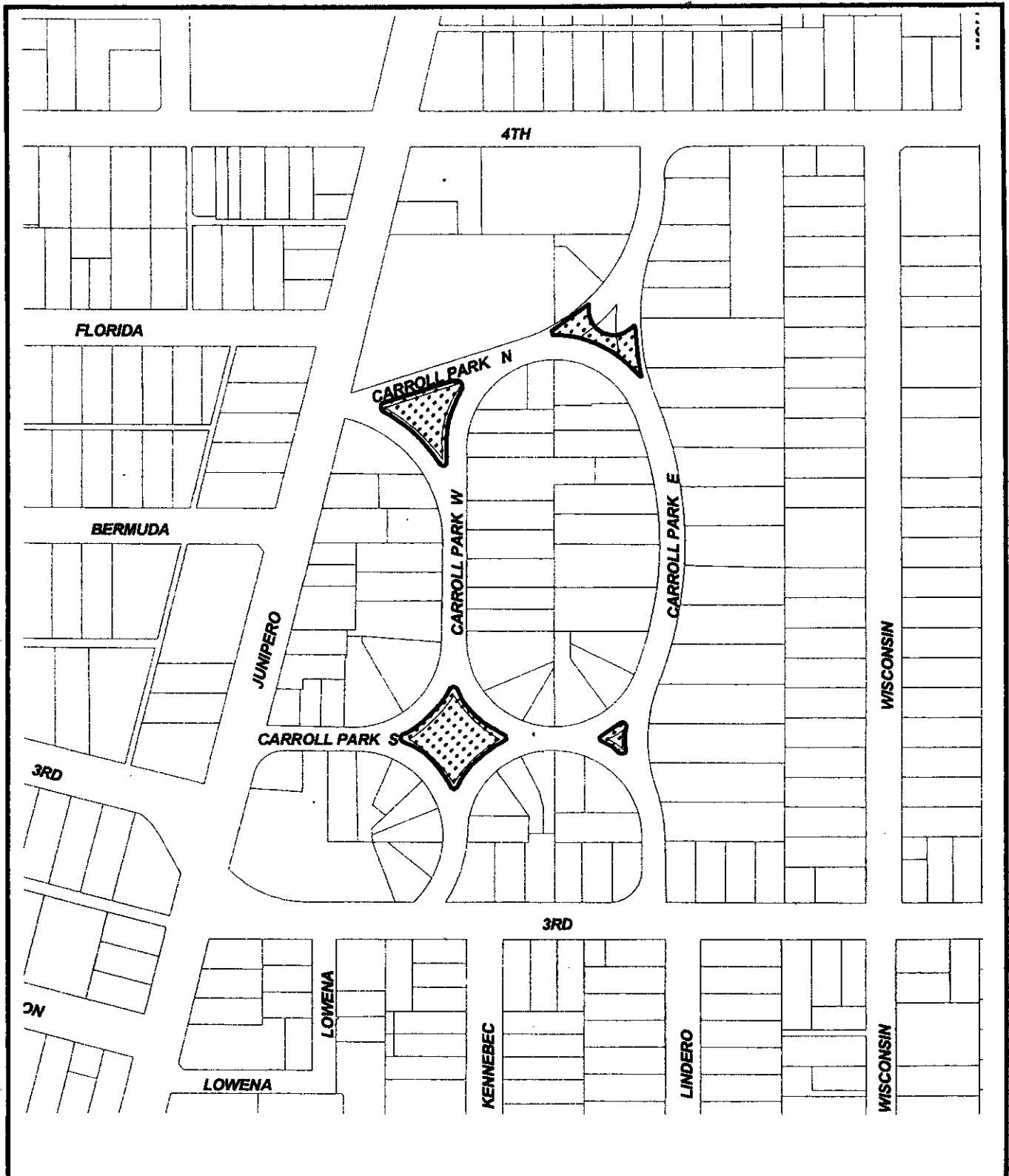

City of Long Beach, California

**CARROLL PARK**

(Mini Park)

*City Owned Lands Dedicated  
In Perpetuity As Public Park*

Dept of Planning & Building Advance Planning Division

**Fvhihit "A"**



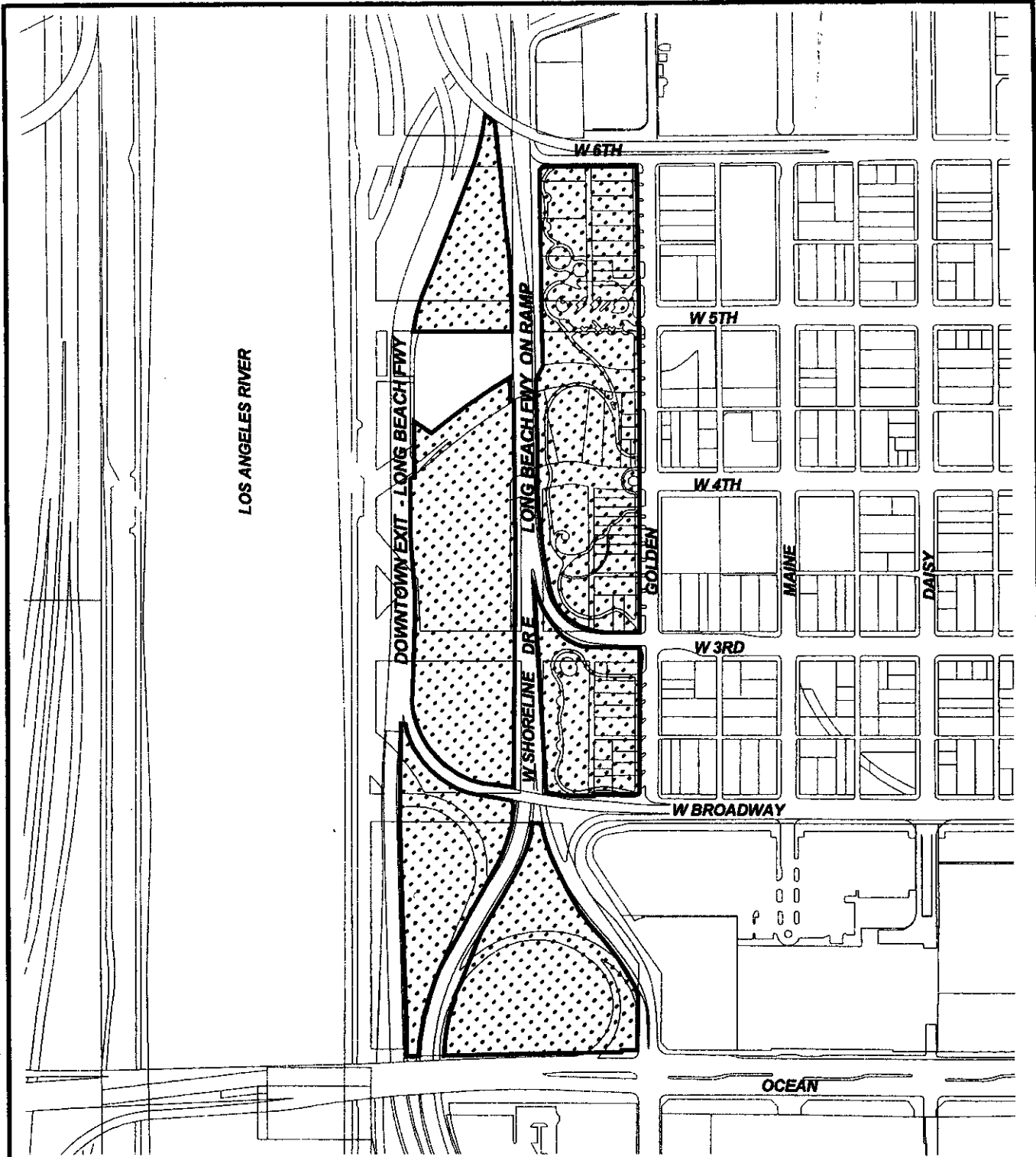

LOS ANGELES RIVER

DOWNTOWN EXIT - LONG BEACH FWY

W SHORELINE DR E LONG BEACH FWY ON RAMP

W 6TH

W 5TH

W 4TH

W 3RD

W BROADWAY

GOLDEN

MAINE

DAISY

OCEAN



200 0 200 Feet

City of Long Beach, California  
**CESAR CHAVEZ PARK**  
 (Community Park)  
*City Owned Lands Dedicated  
 In Perpetuity As Public Park*  
Dept of Planning & Building Advices Planning Division

Fyhihit "A"

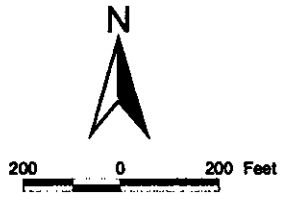
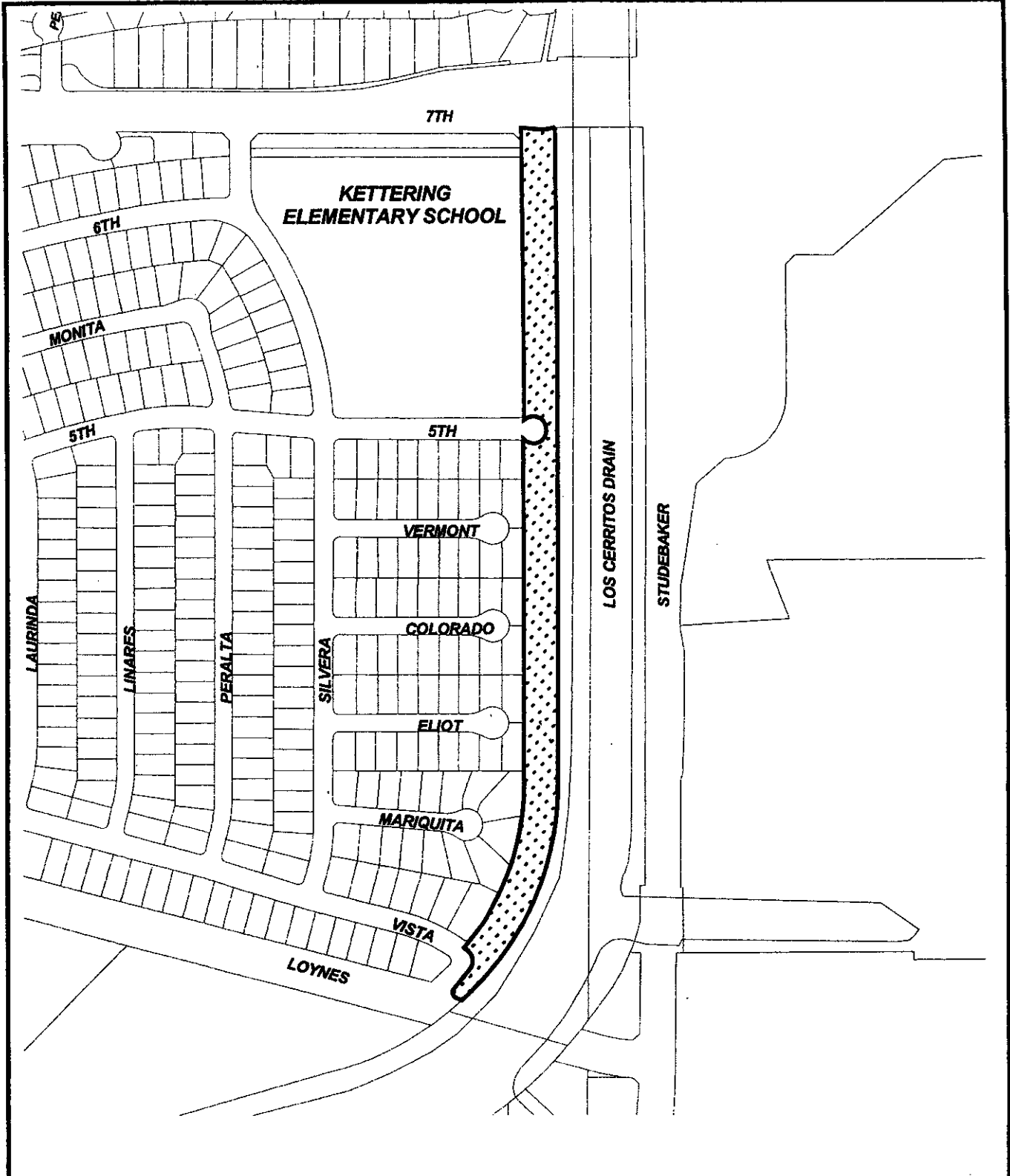

City of Long Beach, California

**CHANNEL VIEW PARK**

**(Greenway Park)**

*City Owned Lands Dedicated  
In Perpetuity As Public Park*

Dept of Planning & Building Advance Planning Division

**Exhibit "A"**

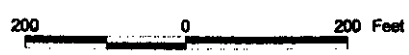
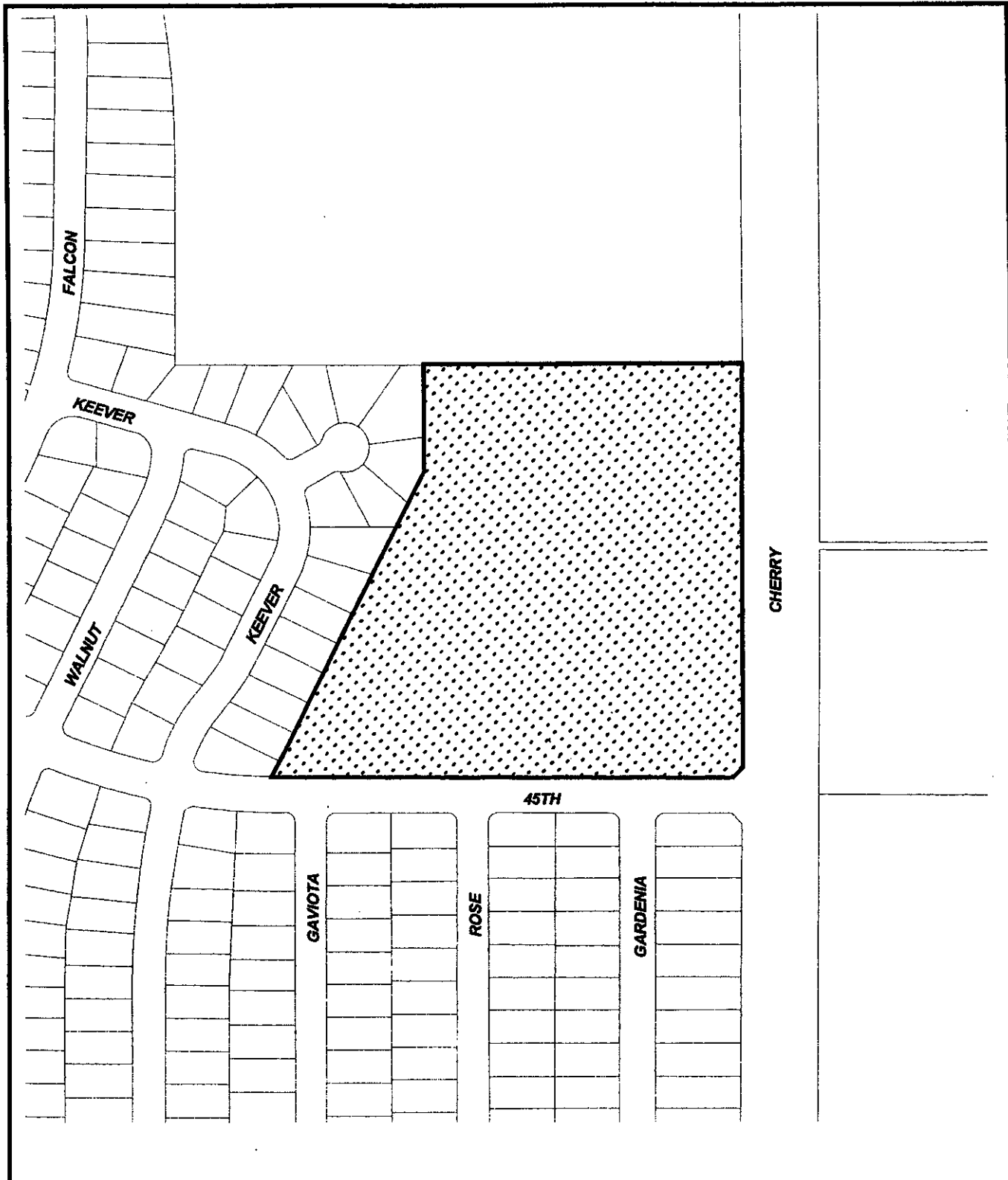

**City of Long Beach, California**  
**CHERRY PARK**  
**(Community Park)**  
*City Owned Lands Dedicated  
 In Perpetuity As Public Park*

Dept of Planning & Building Advance Planning Division

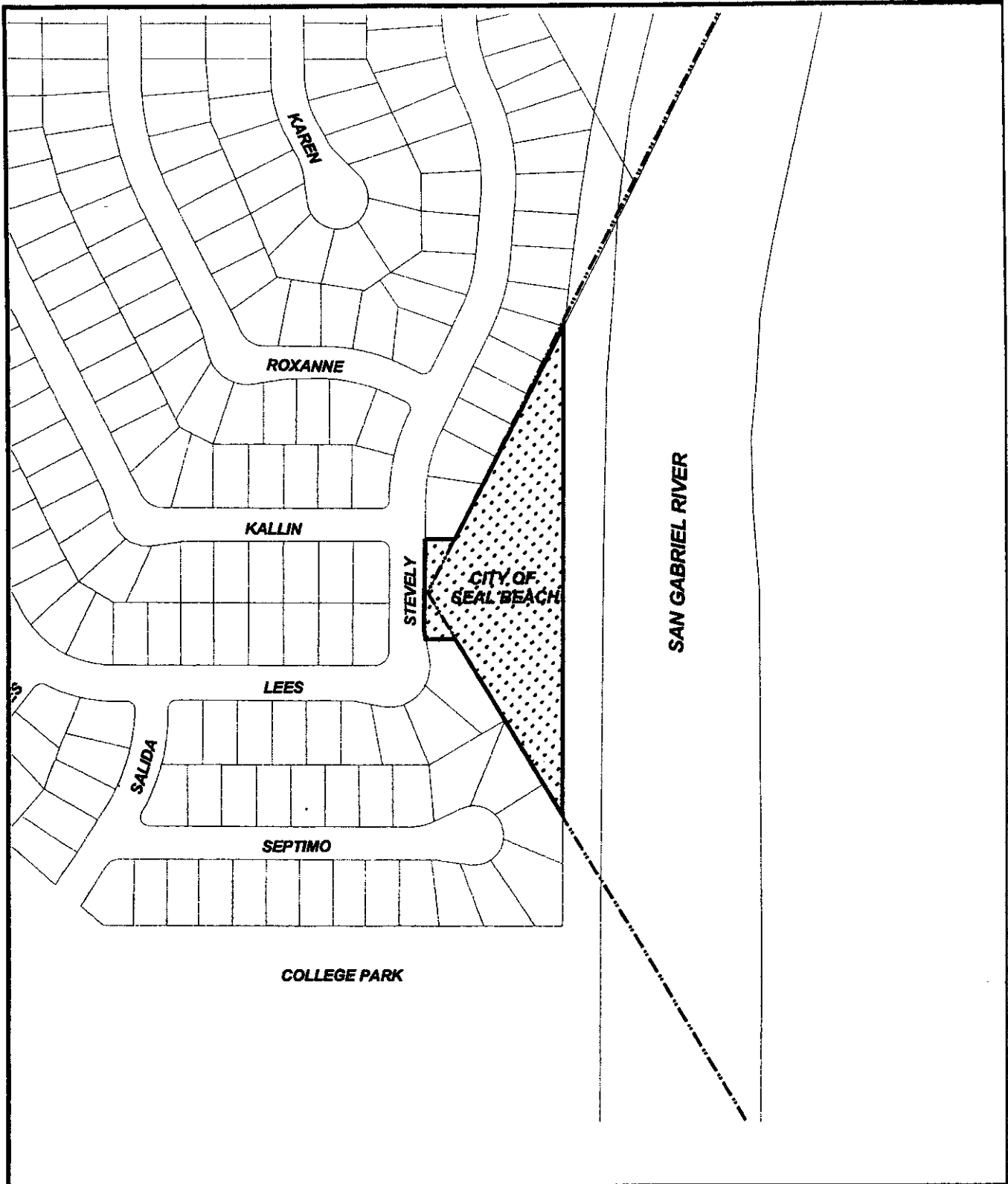

200 0 200 Feet

City of Long Beach, California  
**COLLEGE ESTATES PARK**  
 (Neighborhood Park)  
*City Owned Lands Dedicated  
 In Perpetuity As Public Park*  
Dept of Planning & Building Advice Planning Division

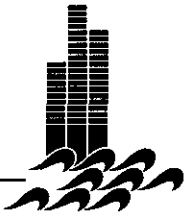

**December 7, 2004**

**FOR THE REMAINDER OF THE PAGES  
FOR THIS AGENDA ITEM,  
PLEASE CONTACT  
THE LONG BEACH CITY CLERK DEPARTMENT AT  
(562) 570-6101  
(562) 570-6789 (FAX)  
cityclerk@longbeach.gov**