

OFFICE OF THE CITY ATTORNEY  
ROBERT E. SHANNON, City Attorney  
333 West Ocean Boulevard, 11th Floor  
Long Beach, CA 90802-4664

**PUBLIC WALKWAYS OCCUPANCY PERMIT 31045**

1  
2  
3  
4  
5  
6  
7  
8  
9  
10  
11  
12  
13  
14  
15  
16  
17  
18  
19  
20  
21  
22  
23  
24  
25  
26  
27  
28

This Public Walkways Occupancy Permit ("Permit") is granted this 10<sup>th</sup> day of February, 2009, pursuant to minute order adopted by the City Council of the City of Long Beach at its meeting held on January 13, 2009, to **CARLOS NAJIB** ("Permittee"), whose address is 5205 East Second Street, Long Beach, California, as the operator of **BUONA GENTE RESTAURANT** and lessee of premises at 5205 East Second Street, Long Beach, California.

Permission is granted to Permittee to occupy the public right-of-way with the following obstruction: **low barrier, two (2) tables and five (5) chairs** at 5205 East Second Street, Long Beach, California. Dimensions and location of the area to be occupied are as shown on Exhibit "A", incorporated by reference and made a part of this Permit; provided that all obstructions are placed only within the permit area shown on Exhibit "A".

This Permit is granted with reference to the following facts:

1. Permittee proposes to occupy the public right-of-way as shown on Exhibit "A"; and
2. The proposed occupancy will not now or at any time interfere with continued public use of the public street right-of-way; and
3. That there is no present or foreseeable conflicting public need for the proposed use of the public street right-of-way area and its temporary withdrawal from public use will not be injurious or detrimental to the public; and
4. That this use of a portion of the public street right-of-way is consistent with proper and lawful street uses and the use is approved; and
5. The City Engineer has determined that this use is in compliance with Chapter 14.14 of the Long Beach Municipal Code, all related to temporary use of the public rights-of-way.

The use of the public street right-of-way is granted upon and subject to the following terms and conditions:

1. The minimum width of the public walkway shall be ten (10) feet, or as

1 otherwise approved by the City Council pursuant to Chapter 14.14 of the Long Beach  
2 Municipal Code, and any obstruction must permit at least five (5) feet of unobstructed area  
3 of public walkway.

4           2.     The obstruction shall abut the property and not be located in a manner  
5 which interferes with the flow of pedestrian or other traffic.

6           3.     The maximum height of any such obstruction shall be six (6) feet and  
7 all such obstructions shall be entirely portable, except as specifically authorized by the City  
8 Engineer.

9           4.     This Permit may be immediately suspended for a designated time  
10 period at any time in the event that, in the discretion of the City Council or City Manager,  
11 such obstruction would interfere with street improvement activities, construction activities,  
12 cleaning efforts or other similar activities.

13           5.     The obstruction shall be kept in a good state of repair and in a safe,  
14 sanitary, and attractive condition.

15           1.     Such obstruction may not be located within twenty (20) feet from an  
16 intersection (measured to the prolongation of the near curb of the intersecting street) or  
17 within ten (10) feet from a driveway or alley (measured to the near end of the fully  
18 depressed portion of an apron-type driveway or to the prolongation of the near curb of the  
19 driveway) unless otherwise approved by the City Council pursuant to the considerations  
20 specified in Chapter 14.14 of the Municipal Code.

21           6.     The public street right-of-way shall be used by Permittee only for the  
22 obstruction described above and in the area shown on Exhibit "A".

23           7.     The area in front of the entrance to the business shall not be  
24 obstructed by barricades, chairs, tables or other furniture.

25           8.     The Permittee shall place all obstructions, and any accessories or  
26 equipment located within a dining or entertainment area, in strict accordance with Fire  
27 Department and Health and Human Services Department standards and contained within  
28 Chapter 14.14 of the City of Long Beach Municipal Code.

1           9.     No surface improvements, included but not limited to special paving  
2 surfaces, may be removed or altered by the Permittee unless approved in advance in  
3 writing by the City Engineer.

4           10.    The Permittee shall not allow cleaning chemicals, or other foreign  
5 matter to flow into the parkway tree well, and shall otherwise protect the health of adjacent  
6 street trees, and shall likewise prevent the discharge of litter, cleaning chemicals and all  
7 other foreign matter to the storm drain system.

8           11.    The Permittee shall protect any parkway trees in the immediate vicinity  
9 of the permit area from damage due to the Permittee's cleaning or other activities on the  
10 public walkway. The Permittee shall not interfere with City's access to parkway trees for  
11 maintenance purposes. Any special maintenance of the parkway trees is the responsibility  
12 of the Permittee and must be performed by a qualified landscape contractor acting under a  
13 permit from City's Street Landscaping Division. City shall not be held financially  
14 responsible for damage to Permittee's sidewalk furniture or awnings occurring in the  
15 course of regular street tree maintenance.

16          12.    Upon any termination of this Permit, whether by revocation or  
17 otherwise, Permittee shall remove the obstructions authorized by this Permit at the sole  
18 discretion of the City Engineer and shall otherwise restore the public street right-of-way to  
19 a condition substantially the same as existed immediately prior to the occupancy provided  
20 for by this Permit. Should Permittee fail or refuse to remove the obstructions, City may do  
21 so and, in such event, the security deposit paid by Permittee shall be applied to City's  
22 costs. Permittee shall reimburse City for any costs in excess of the security deposit. In the  
23 event of removal by City of all or any portion of the obstructions, City shall not be liable for  
24 any damage to or loss of any property of Permittee.

25          13.    The following additional conditions shall apply to public walkway  
26 occupancy permits for dining or entertainment areas:

27                A.     Any dining or entertainment area shall be defined by placement  
28 of sturdy fencing or other suitable barriers, not to exceed forty-eight (48) inches in height,

1 as approved by the City Engineer. Such barriers may only be affixed to public property  
2 with the prior approval of the City Engineer.

3 B. All accessories to dining or entertainment uses such as plants  
4 or planter boxes, umbrellas, podiums, menu boards, musical equipment and heaters may  
5 not exceed those enumerated on Exhibit "A", and must be located inside the barrier, as  
6 shown on Exhibit "A".

7 C. All dining and entertainment which takes place on the public  
8 right-of-way shall conform to the requirements of Chapter 8.80 of the municipal code  
9 regarding noise. Complaints regarding noise shall be logged by city staff and may be the  
10 basis for suspension, cancellation, or non-renewal of a permit.

11 D. The Permittee shall be responsible for cleaning the public  
12 walkway occupied by a dining or entertainment area.

13 15. Any permit issued within the downtown area as defined on Exhibit "B"  
14 and made a part of this Permit shall comply with all of the foregoing requirements and the  
15 following additional requirements:

16 A. No tents or windbreaks may be used in, over, or around dining  
17 or entertainment areas.

18 B. Temporary banners, not exceeding the height of the barrier and  
19 attached to the barrier are permitted for a two (2) week period no more than four (4) times  
20 per year.

21 C. Menu boards must be portable, located within the dining area,  
22 and must not exceed five (5) feet, six (6) inches tall. Menu boards may be either a single  
23 pole pedestal of painted metal or a board attached to the inside of the barrier, parallel to  
24 the barrier.

25 D. The following are prohibited on the public walkway in the  
26 downtown area: television monitors, canopies and A-frame signs.

27 Upon expiration, a new permit must be obtained on the basis of a new  
28 application and payment of a new fee and any security deposit amount due. Renewal of

1 the permit is not automatic and there is no right or entitlement to any use of the public right-  
2 of-way. Security deposits may be adjusted from year to year based on permit compliance  
3 and enforcement cost history. This Permit shall never be construed as the grant by City of  
4 any right to permanently use or occupy all or any portion of the public right-of-way; nor  
5 shall it ever be construed as a waiver on the part of City, or as an estoppel against it, which  
6 would in any manner whatsoever bar or limit, or otherwise prejudice, its right to at any time  
7 whatsoever require a discontinuance of the use or occupancy of all or any part of the public  
8 street right-of-way, the removal therefrom of all or any obstructions erected or maintained  
9 under this Permit and the restoration of such public street right-of-way to a clean condition,  
10 all at the sole cost and expense of Permittee.

11 Notices of violation of any of the terms and conditions of this permit may be  
12 issued by the City of Long Beach. Within the downtown area as defined on Exhibit "B",  
13 preliminary informal notices may be issued by Downtown Long Beach Associates. The  
14 enforcement process is set forth on Exhibit "C", attached hereto, and made a part of this  
15 permit. Notwithstanding the above, City may revoke this Permit at any time by giving thirty  
16 (30) days written notice to Permittee or cancel the permit for noncompliance with its terms.  
17 Such notice shall be signed by the City Manager, postage pre-paid, and addressed to  
18 Permittee at its address provided above.

19 Permittee accepts this public right-of-way in its present condition and agrees  
20 to maintain the same in a safe, clean, and orderly condition. Any and all uses made of the  
21 public right-of-way shall be at the sole risk, cost, and expense of Permittee. Permittee, by  
22 its acceptance of this Permit, agrees to indemnify, defend, save and keep City, its officers,  
23 agents, and employees free and harmless from and against any and all liability as well as  
24 from and against any and all loss, claims, demands, damages, expenses and costs of  
25 whatsoever nature arising out of or in any manner resulting, directly or indirectly, from  
26 Permittee's operations on or the condition, use or misuse of the public street right-of-way,  
27 including liability, claims or damages to or as a result of any structures or fixtures on the  
28 public street right-of-way or appurtenances to it.

1           In partial performance of this obligation, Permittee shall obtain and keep in  
2 full force and effect such public liability insurance and property damage insurance as  
3 required by the Long Beach Municipal Code.

4           Nothing in this Permit shall be construed to excuse compliance by Permittee  
5 with any and all of the laws and ordinances of City and State; neither shall this Permit be  
6 deemed to obviate the necessity of Permittee's obtaining such other permits or licenses as  
7 are required to conduct specific activities within the area, including but not limited to  
8 entertainment or the sale, service or consumption of alcoholic beverages.

9           16.    The terms of this permit shall be enforced by the procedure set forth  
10 on Exhibit "C", attached and made a part of this permit.

11           In case suit shall be brought for the recovery of possession of all or any  
12 portion of the public right-of-way or because of the breach of any covenant contained in  
13 this Permit to be kept and performed on the part of Permittee, Permittee shall pay to City  
14 reasonable attorneys' fees which shall be fixed by the court.

15           Permittee shall not assign this Permit, or any interest in it, nor shall this  
16 Permit, or any interest in it, be subject to transfer or assignment by order of any court. Any  
17 such transfer or assignment shall not create any right whatsoever in the transferee or  
18 assignees and shall entitle the City Manager, at his discretion, to terminate this Permit.

19 ///

20 ///

21 ///

22 ///

23 ///

24 ///

25 ///

26 ///

27 ///

28 ///

OFFICE OF THE CITY ATTORNEY  
ROBERT E. SHANNON, City Attorney  
333 West Ocean Boulevard, 11th Floor  
Long Beach, CA 90802-4664

1  
2  
3  
4  
5  
6  
7  
8  
9  
10  
11  
12  
13  
14  
15  
16  
17  
18  
19  
20  
21  
22  
23  
24  
25  
26  
27  
28

The acceptance of this Permit by Permittee shall be endorsed on this Permit and shall be an acceptance by Permittee of all of the terms and conditions of this Permit and an agreement to abide and comply with it. Permittee further acknowledges that Permittee is aware of the requirements of Long Beach Municipal Code Chapter 14.14, and that Permittee shall conduct all activities hereunder in compliance with such chapter.

CARLOS NAJIB

12/4/, 2008

By 

CARLOS NAJIB  
Type or Print Name

"PERMITTEE"

CITY OF LONG BEACH, a municipal corporation

2.10., 2009

By  Assistant City Manager

City Manager

"CITY"

EXECUTED PURSUANT  
TO SECTION 301 OF  
THE CITY CHARTER.

Approved as to form this 27<sup>th</sup> day of January, 2009.

ROBERT E. SHANNON, City Attorney

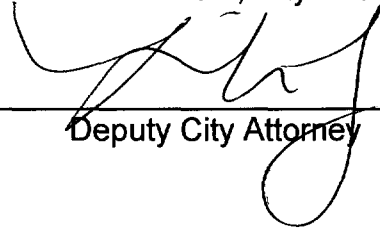
By 

Deputy City Attorney

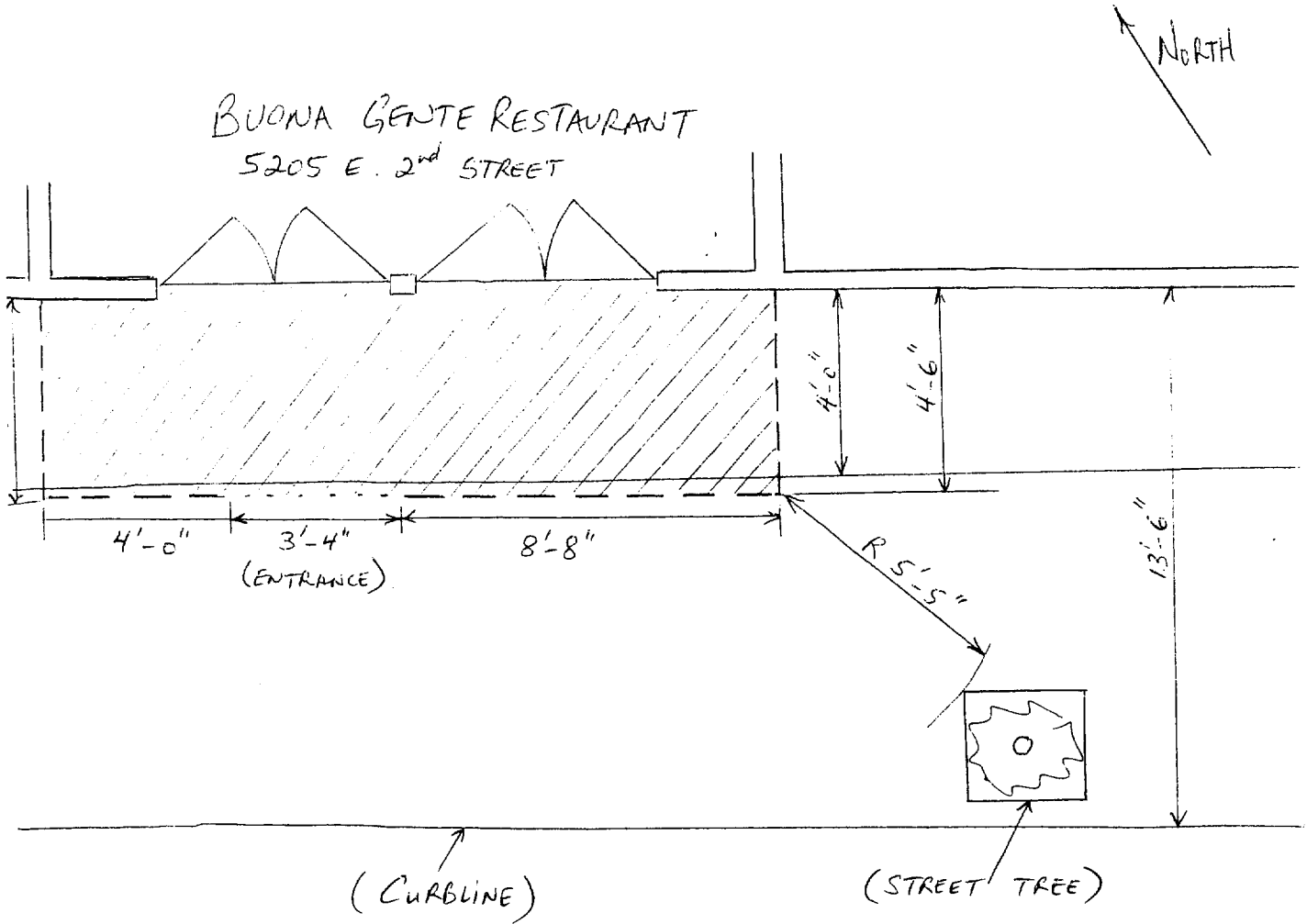
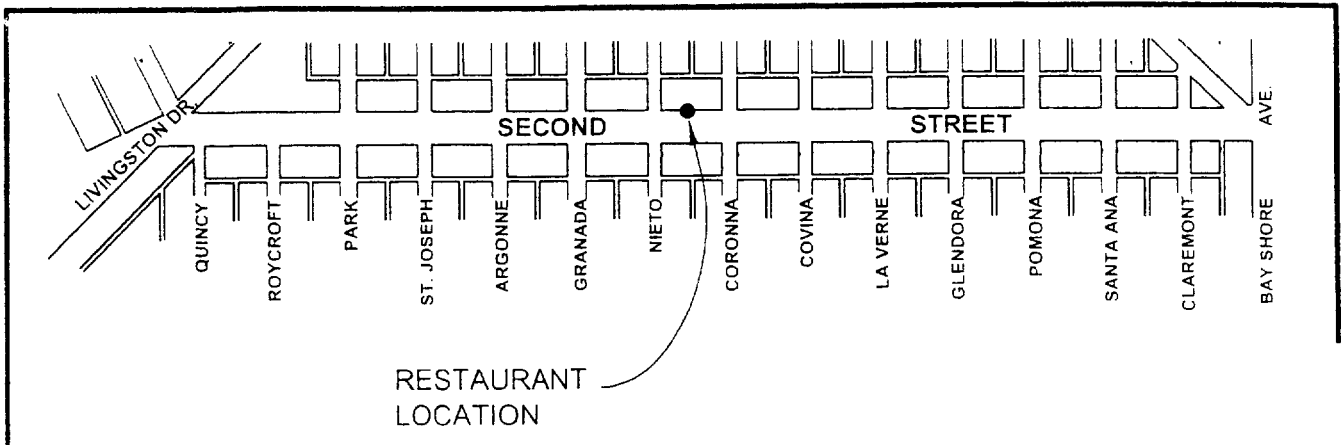

\*  SHOWS AREA OF PERMIT

PUBLIC WALKWAYS OCCUPANCY PERMIT  
BUONA GENTE RESTAURANT  
5205 E SECOND STREET



**List of Approved Furnishings and Accessories**  
(Attachment to Public Walkways Occupancy Permit for Sidewalk Dining Purposes)

Restaurant: BUONA GENTE Permittee: CARLOS NAJIB

Address: 5205 E. 2<sup>nd</sup> St. LB. Telephone: (562) 438-8763

Tables number: 2

Chairs number: 5

Umbrella(s) height & number: \_\_\_\_\_

Heater(s) height & number: \_\_\_\_\_

Menu board  
note: maximum height of 5 ft 6 in, maximum width of 2 ft & none permitted in the coastal zone

Waiter station size: \_\_\_\_\_

Planters for trees or other greenscaping describe: \_\_\_\_\_

Other: \_\_\_\_\_

We intend to make occasional use of the permit area for live or recorded entertainment (Note: A separate entertainment permit is required).

**The following are prohibited:**

- canopies (ground supported)
- television monitors

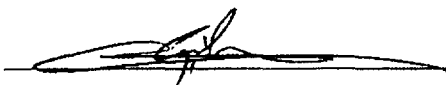
Permittee signature: 

Date: 9/30/08

Print name here: CARLOS NAJIB

This list of furnishings and accessories is effective only when attached to a completed Public Walkways Occupancy Permit.

OFFICE OF THE CITY ATTORNEY  
ROBERT E. SHANNON, City Attorney  
333 West Ocean Boulevard, 11th Floor  
Long Beach, CA 90802-4664

**EXHIBIT "B"**

1  
2  
3  
4  
5  
6  
7  
8  
9  
10  
11  
12  
13  
14  
15  
16  
17  
18  
19  
20  
21  
22  
23  
24  
25  
26  
27  
28

"Downtown area" means the area bounded northerly by the centerline of Tenth Street; westerly by the centerline of Maine Avenue north of First Street, and the centerline of Golden Avenue south of First Street and the centerline of Golden Shore and its southerly prolongation; easterly by the centerline of Lime Avenue north of First Street and the centerline of Alamitos Avenue and its southerly prolongation south of First Street; southerly by the mean high tide line of the Pacific Ocean and its prolongation across the entrance to Pacific Terrace Harbor and Queen's Way Landing Boat Basin.

**EXHIBIT "C"**

**PUBLIC WALKWAYS OCCUPANCY PERMITS  
ENFORCEMENT PROCESS**

1  
2  
3  
4  
5  
6  
7  
8  
9  
10  
11  
12  
13  
14  
15  
16  
17  
18  
19  
20  
21  
22  
23  
24  
25  
26  
27  
28

1. Letter of information sent to permittee regarding Municipal Code requirements and requested to correct an observed violation of permit conditions.
  - If not remedied in ten (10) working days, send official Notice of Violation.
2. Notice of Violation
  - Indicates that permittee can be found in default for failure to comply with permit conditions per Municipal Code Section 14.14.090.
  - Notes that uncorrected violations will be reported to the City Council at the next permit application.
  - Alerts permittee that the Alcoholic Beverage Control (ABC) will be notified of all permits declared in default.
  - If violation of permit conditions is not corrected within ten (10) working days, send Second Notice of Violation by certified mail.
  - Copies of Notice of Violation to be sent to the City Manager, Downtown Long Beach Associates (DLBA) and the Redevelopment Agency.
3. Second Notice of Violation
  - Inform permittee that "On (date 10 working days hence) you will receive a Notice of Default if permit violations not corrected."
  - If permit violations not corrected within ten (10) working days, send Notice of Default by certified mail.
  - Copies of Second Notice of Violation to be sent to the City Manager, DLBA and the Redevelopment Agency.
4. Notice of Default by Department of Public Work
  - Provides permittee ten (10) working days to remedy violation.
  - "If permittee fails or refuses to remedy the default within the time specified, the right of the permittee to use the public walkway shall cease and City shall have the right to remove the public walkway obstruction at permittee's expense" (LBMC 14.14.090).
  - If a Notice of Default is issued, the security deposit that was paid with the permit application will be forfeited.
  - Second ABC notice of permit status upon actual default.
  - City Manager, DLBA and Redevelopment Agency informed when final default occurs.
5. City pick-up of obstructions at permittee's expense and/or possible legal action to restrain use of sidewalk by the City Prosecutor.
6. Prior to New Permit Issuance
  - Payment of new permit processing fee and security deposit.
  - Payment of any fees, damages, or City costs assessed for prior code enforcement actions.