



## New Passenger Concourse

### Project Overview

The new passenger concourse will be modern, comfortable and inviting, offering a variety of new shopping destinations to entertain you before your flight. The concourse will be comprised of 35,000 square feet of new construction housing north and south holdrooms with a peaceful garden core. Long Beach Airport is currently designing this project, which includes over 26,000 square feet of new holdrooms with improved restrooms, more than 8,000 square feet of new concession space and a consolidated passenger-screening checkpoint utilizing 6,500 square feet of existing space. The garden will be home to a variety of vibrant, native plant life as well as an extensive array of exhibits highlighting LGB's history and impact on the aviation industry. This project will bring the overall terminal area to 74,000 square feet, while accentuating the historic terminal building. Groundbreaking will occur in December 2010.

Design completion and final approval for the project is expected in fall 2010, with construction beginning by the end of the year and concluding in 2013. The Concourse project will support 340 jobs and provide modern waiting areas and concessions to exceed customer expectations. The estimated budget is \$45 million. It will be funded through Passenger Facility Charges (PFC) and General Airport Revenue Bond (GARF) funds.

Noteworthy Concourse components include:

- Consolidated Security Screening
- Spacious New Holdrooms
- New Enhanced Concessions
- Garden and Palm Court
- Historic Exhibits



## New Passenger Concourse

### Consolidated Security Screening

Currently passengers enter holdrooms via two separate (north and south) screening areas. The Concourse will consolidate all Transportation Security Administration (TSA) screening into the existing permanent southern screening building.



### Spacious Holdrooms

The Concourse will boast modern and comfortable holdrooms to accommodate passengers awaiting departure. Passengers will encounter a bright and airy space with expansive views of the airfield to the west.



### Enhanced Concessions

The Concourse will house a variety of healthy, interesting concessions with a distinct Long Beach flavor. New retail locations will provide reading material, postcards, and sundries.



## New Passenger Concourse

### Garden and Palm Court

Passengers will exit the screening area into a peaceful and inviting garden with protective canopies and bench seating to allow for the reorganizing of belongings. A garden and palm court separate the main waiting rooms. This garden is designed to be a signature amenity for the Airport, showcasing native plant life and creating an identity in line with Long Beach's temperate climate.



### Historic Exhibits

The garden and palm court will offer travelers a variety of display cases that tell the story of the Long Beach Airport's unique instrumental role in developing aviation throughout North America and eventually the world. Barbara London, a female pilot during World War II and winner of the Congressional Medal of Honor, will have a special exhibit commemorating her contributions to the war effort. This addition will compliment the artifacts, news clippings, photos and correspondence from famous Long Beach aviators housed on the second floor of the historic terminal building.



## **Traveler Benefits**

The combination of ample seating, an assortment of concessions and free Wi-Fi will ensure a higher level of customer service.

## **Traveler Impacts**

Though the project will be planned to avoid service interruptions, various areas of the existing boarding areas will be rearranged during construction. Passengers should contact the airlines, or check our website, [www.lgb.org](http://www.lgb.org), for specific construction related updates.

## **Construction Plan**

Design completion and Planning Department approval are anticipated for fall 2010. Advertising for construction is anticipated for late 2010, with a construction start in early 2011. Construction is anticipated to last 28 months. Please visit our website, [www.lgb.org](http://www.lgb.org), for periodic updates.

## **Green Components**

LGB is applying for the U.S. Green Building Council's Leadership in Energy and Environmental Design (LEED) certification for the new passenger concourse. The building is being designed to include a rooftop solar array that will offset 13 percent of its power demand.

## **Economic Impact**

Concourse construction will support 340 jobs in addition to providing modern concessions and waiting areas to exceed customer expectations.

## **Project Cost**

The estimated budget for Phase I is \$45 million. It will be funded through Passenger Facility Charges (PFC) and General Airport Revenue Bond (GARB) funds.

## **Contractors**

Following approval of the Long Beach Planning Commission and City Council the Airport will issue a bid to secure a project contractor.

---

### **About Long Beach Airport**

Long Beach Airport (LGB), located in Long Beach, CA, was founded in 1923, making it the oldest municipally owned airport in California. Throughout its 85-year history, LGB has been a source of substantial economic activity and business opportunities, as well as a leader in maintaining a sustainable environment. LGB, its tenants and users are committed to operating in an environmentally responsible manner by minimizing the impact of business on the environment and surrounding community with methods that are socially responsible, scientifically based and economically sound. Currently, LGB hosts four airlines, serves nearly three million commercial airline passengers annually, offering non-stop service to 14 US cities and is among the top five busiest general aviation airports in the world, with more than 300,000 annual operations. Frontier Airlines and Allegiant Air will begin providing service to an additional two destinations in May and August 2010 respectively. As a center for air cargo carriers, more than 41,000 tons of cargo are transported via LGB annually. For more information please visit [www.lgb.org](http://www.lgb.org).

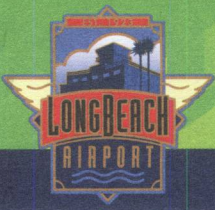

## New Parking Structure

### Project Overview

Construction of the Long Beach Airport Parking Structure includes a new 1,989-space parking structure, a 247-space surface parking lot, as well as utility and roadway improvements which will be built on the existing surface of parking Lot B and a portion of Lot C. This project is critical to the Long Beach Airport. Currently, nearly 50 percent of the Airport's vehicle parking is on leased land off Airport property. This structure will benefit customers by bringing all parking on-site and within walking distance of the terminal.

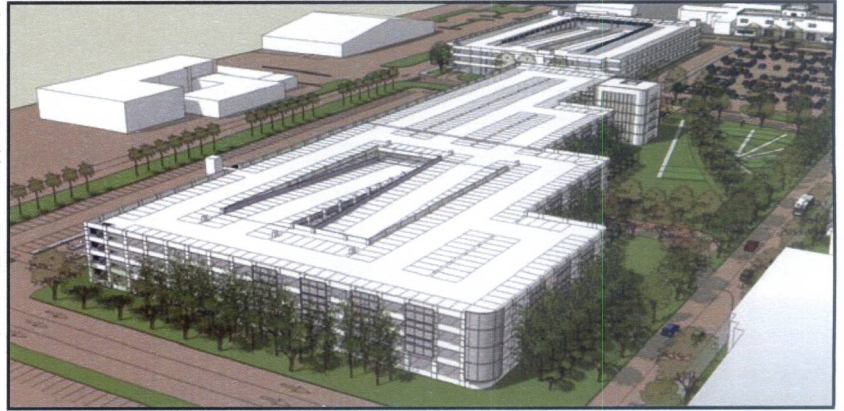

Project site-work began in December 2009 and includes improvements to various utilities and rehabilitation of the terminal access roadway. The far right lane of Lakewood Boulevard between Donald Douglas Drive and Spring Street will be closed to traffic from April through summer 2010 to allow for the lengthening of the terminal access roadway. This work will result in an Airport access loop beginning and ending at Lakewood Boulevard immediately north of the Long Beach Fire Department Headquarters. The extended road will improve traffic circulation around the terminal and parking facilities. The Barbara London Drive return loop is anticipated to remain in operation throughout construction.

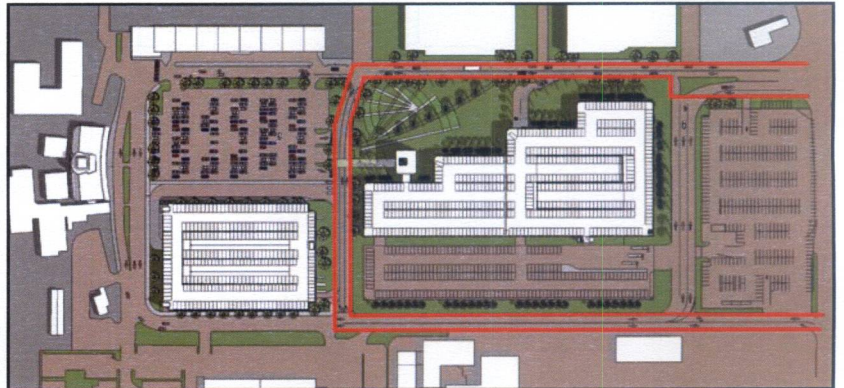

In order to accommodate Airport Complex staff, permitted employee parking was moved to Lot D in March 2010. Though Lot A will remain in operation for the duration of construction, Lot C was closed to the public March 1. Lot B will be available until early summer. Remote Lot D is lighted, gated and patrolled 24 hours a day. Free shuttle service will continue to ferry passengers between the terminal and Lot D every 15 minutes.

The parking structure project was awarded to ARB, Inc. as a design/build contract. The parking structure, designed by Watry Design, complements the historic terminal building, with curved corners and graduated frontage that maintain a line of sight to the historic terminal. The new structure also features glazed stairwells, decorative glass panels, and a stand-alone glass elevator intended to reduce the horizontal impact on the street. A peaceful, tree-lined outdoor courtyard with drought resistant landscaping are key features of the design. The structural system consists of cast-in-place post-tensioned beams and columns with a moment resistant frame lateral system to maintain an open facade.

The parking structure is budgeted at \$56 million. The project is funded through a federal stimulus bill Build America Bond, General Airport Revenue Bond (GARB), and Passenger Facility Charges (PFC). Approximately \$4 million of the project cost is eligible for PFC Funds.

## Construction Plan

Improvements entail a new parking structure with 1,989 vehicle spaces, a new surface parking lot with 247 vehicle parking spaces, necessary modifications to the roadways serving the Airport as well as the structure, and improvements to the terminal area utilities.

The site-work portion of the project began in December 2009 and includes improvements to various utilities and rehabilitation of the terminal access roadway. The far right lane of Lakewood Boulevard between Donald Douglas Drive and Spring Street will be closed to traffic from April through summer 2010 to allow for the lengthening of the terminal access roadway. This work will result in an Airport access loop beginning and ending at Lakewood Boulevard immediately north of Long Beach Fire Department Headquarters. The Barbara London Drive return loop is anticipated to remain in operation throughout construction.

In order to accommodate Airport Complex staff, permitted employee parking was moved to Lot D in March 2010. Though Lot A will remain in operation for the duration of construction, Lot C was closed to the public March 1. Lot B will be available until early summer. Free shuttle service will continue to ferry passengers between the terminal and Lot D every 15 minutes.

At this time there are no anticipated Long Beach Transit service interruptions during construction. The project is scheduled to be substantially complete in August 2011.

## Green Components

The parking structure roof is designed to support solar panels. Additionally, the existing pavement will be reused as select fill for the project.

## Economic Impact

This project includes over 50 different construction trades. Airport engineering staff estimate the project will support approximately 450 jobs through both the design and construction phases. The contractor is required to comply with Section 3 of the Housing and Urban Development Act of 1968 and will work to provide job training and employment opportunities for low and very low-income Long Beach residents.

## Project Cost

The parking structure is budgeted at \$56 million. The project is funded through a federal Build America Bond, a General Airport Revenue Bond (GARB) and Passenger Facility Charges (PFC). Approximately \$4 million of the project cost is eligible for PFC Funds.

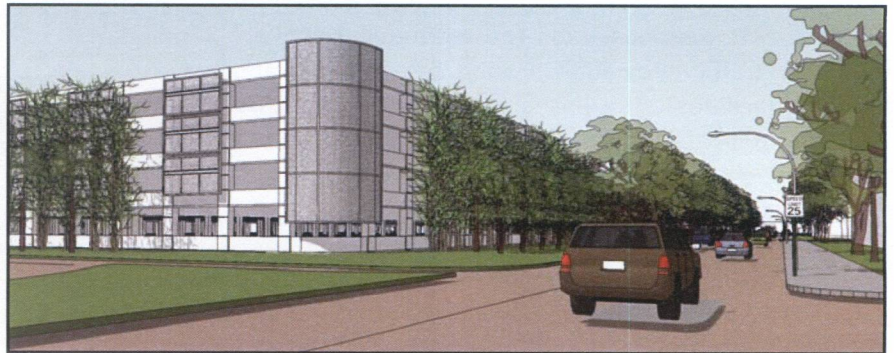

## Contractors

ARB, Inc. was selected as the design/build contractor for the project. ARB Inc. is a multinational construction company headquartered in Lake Forest, California with satellite offices throughout the United States, South America, and Latin America. Founded in 1946, ARB is a construction contractor that also provides engineering, fabrication and maintenance services to public and private entities.

---

## About Long Beach Airport

Long Beach Airport (LGB), located in Long Beach, CA, was founded in 1923, making it the oldest municipally owned airport in California. Throughout its 85-year history, LGB has been a source of substantial economic activity and business opportunities, as well as a leader in maintaining a sustainable environment. LGB, its tenants and users are committed to operating in an environmentally responsible manner by minimizing the impact of business on the environment and surrounding community with methods that are socially responsible, scientifically based and economically sound. Currently, LGB hosts four airlines, serves nearly three million commercial airline passengers annually, offering non-stop service to 14 US cities and is among the top five busiest general aviation airports in the world, with more than 300,000 annual operations. Frontier Airlines and Allegiant Air will begin providing service to an additional two destinations in May and August 2010 respectively. As a center for air cargo carriers, more than 41,000 tons of cargo are transported via LGB annually. For more information please visit [www.lgb.org](http://www.lgb.org).

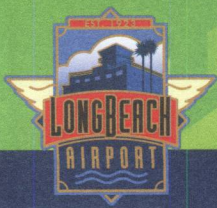

## Air Carrier Ramp



### Project Overview

The air carrier ramp (ramp) at the Long Beach Airport is used to park commercial aircraft for the loading and unloading of passengers and baggage. Improvements to the air carrier ramp include the replacement of deteriorated pavement with concrete that will extend the life of the surface. The current ramp is composed of asphalt, which lasts 15 to 20 years. The new concrete ramp will last for 50 years or more. Additional ramp work will entail drainage improvements as well as installing the electrical infrastructure for pre-conditioned air and power at each aircraft parking position. The installation of these utilities will allow boarding and servicing of aircraft without the need to run the aircraft auxiliary power units, thus reducing harmful air emissions and fuel consumption. Ramp improvements will be phased over a multi-year period based on the need to maintain the functionality of the existing airline ramp during construction.

The project will be constructed in four phases. Phase I includes the reconstruction of five of the existing 10 aircraft parking positions. Two parking positions were completed in April 2010 and the project is anticipated to take 12 months to complete. The budget for Phase I is \$6.9 million funded via Federal Aviation Administration (FAA) Airport Improvement Program (AIP) dollars, Passenger Facility Charges (PFC), and Airport revenue. Phases II through IV are budgeted at \$26 million and will be spread over multiple years to utilize the same funding sources as the first phase.

### Project Benefits

- Upgrading the air carrier ramp helps travelers and residents alike by improving air quality.
- Replacing the current asphalt ramp with concrete will increase its useful life by 50 years, which will allow LGB to maintain some of the lowest airfares in the nation.
- Improving ramp drainage removes standing water, which protects our passengers from trodding through puddles while boarding aircraft.

## Economic Impact

Improving the Airport's air carrier ramp will support approximately 100 to 120 jobs per phase.

## Construction Plan

The project will be constructed in four phases. Phase I includes the reconstruction of five of the existing ten aircraft parking positions. Phase I construction began in 2009 and two parking positions were finished in April 2010. The first phase is anticipated to take 12 months to complete. Phase II design is underway and will be under construction in fall 2010. Phase II is also anticipated to last 12 months. Phases II through IV will be spread over multiple years to utilize the same funding sources as the first phase.

## Green Components

Improvements to the air carrier ramp consist of the installation of preconditioned air and electrical power at each aircraft parking position. These additions will allow pilots to shut off auxiliary power units while waiting at the gate, which will reduce aircraft emissions. Additionally, a substantial amount of existing pavement will be reused.

## Project Cost

The budget for Phase I is \$6.9 million funded via FAA Airport Improvement Program dollars, PFC, and Airport revenue. Phases II through IV are budgeted at \$26 million and will be spread over multiple years to utilize the same funding sources as the first phase.

## Contractor

Excel Paving was selected as the contractor for the first phase. Phase II will be advertised for bid in May of 2010.



---

### About Long Beach Airport

Long Beach Airport (LGB), located in Long Beach, CA, was founded in 1923, making it the oldest municipally owned airport in California. Throughout its 85-year history, LGB has been a source of substantial economic activity and business opportunities, as well as a leader in maintaining a sustainable environment. LGB, its tenants and users are committed to operating in an environmentally responsible manner by minimizing the impact of business on the environment and surrounding community with methods that are socially responsible, scientifically based and economically sound. Currently, LGB hosts four airlines, serves nearly three million commercial airline passengers annually, offering non-stop service to 14 US cities and is among the top five busiest general aviation airports in the world, with more than 300,000 annual operations. Frontier Airlines and Allegiant Air will begin providing service to an additional two destinations in May and August 2010 respectively. As a center for air cargo carriers, more than 41,000 tons of cargo are transported via LGB annually. For more information please visit [www.lgb.org](http://www.lgb.org).





## Historic Terminal Modernization

### Project Overview

The Historic Terminal Modernization project will consist of improvements to the historical elements and infrastructure of the Airport's 1941 terminal building, a registered City historic landmark. The improvements will enhance modern functionality while remaining true to the buildings Streamline Moderne architecture.

This investment is essential to ensure the Long Beach Airport (LGB) continues to provide the best customer experience and exceed customer expectations every visit. Terminal modernization began in summer 2009 and many components are ongoing. Modernizing the historic terminal building will support approximately 80 jobs.

The project budget is \$2 million, and will be completed by fall 2013.

Key modernization elements include:

- Refurbished Historic Exhibit
- Upgraded Infrastructure and Lighting
- Upgraded Signage
- Interior and Exterior Paint
- New Interior Furnishings
- Expanded Wi-Fi Coverage

### Traveler Benefits

This investment is essential to ensure the Airport continues to provide the best customer experience and exceed customer expectations every visit. Terminal modernization will result in a more comfortable and attractive building frontage, lobby, and ticketing area for our customers. Terminal modernization also includes upgrades to LGB's signage to ensure passengers can quickly and easily navigate the terminal.

### Construction Plan

This project is currently in the planning stage and is expected to be in design by mid-2010. Please visit our website, [www.lgb.org](http://www.lgb.org), for periodic updates.

### Green Components

Modernization of the historic terminal entails equipping all bathrooms with low-flow toilets and waterless urinals to reduce the Airport's water consumption, installing energy-efficient lighting, and installing new roofing that will provide for better climate control, thereby lowering energy consumption.

### Economic Impact

Rehabilitating the Airport's historic terminal building will support approximately 80 jobs.

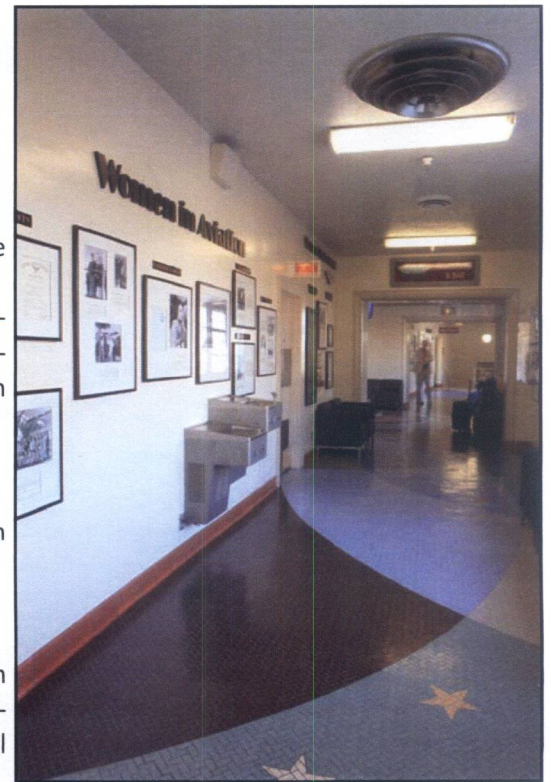

## Project Details

- **Refurbished Aviation Historical Exhibit**

Located throughout the terminal the exhibits include artifacts, news clippings, photos and correspondence from famous Long Beach aviators, which highlight Long Beach's important role in American aviation history.

- **Upgraded Infrastructure and Lighting**

All interior lighting at Baggage Claim 1 will be converted to LEDs, which will last 10 to 12 years compared to incandescent bulbs that must be changed every few months. The transition will be completed in summer 2010.

All plumbing, sewer, water, and electrical infrastructure will be upgraded. This portion of the project is currently in the planning stages and is expected to be in design in mid-2010. Construction is anticipated to begin in late 2011. Historically appropriate window replacement will occur once a funding source is identified.

- **Upgraded Signage**

Airline ticketing counter signage upgrades are underway and will be complete in spring 2010. The new signs will be easier to read, yet remain historically appropriate.

- **Interior and Exterior Paint**

The building interior was freshly painted in fall 2009. The terminal exterior will be painted in spring 2010.

- **New Interior Furnishings**

All interior furnishings will be replaced in spring 2010.

- **Expanded Wi-Fi Coverage**

The Airport began offering free Wi-Fi for passengers in 2008. Modernization entails expanding the signal strength and coverage areas to reach the entire terminal and baggage claim areas. This component will be realized in spring 2010.

- **Terminal Concessions**

The existing terminal concessions, which includes Legend's of Aviation Restaurant, the snack kiosks and the gift and news shop have been completely remodeled.

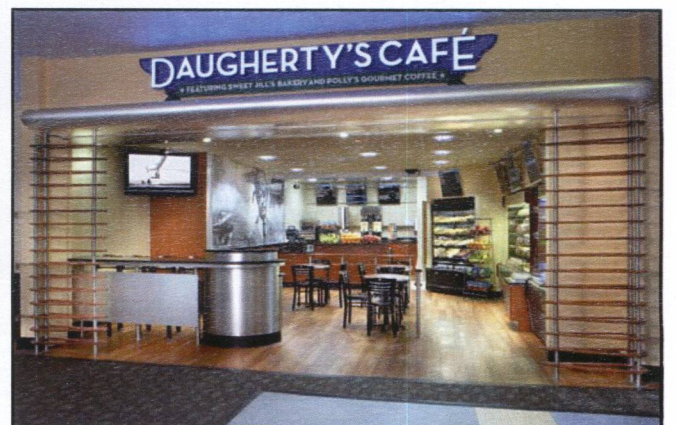



## Airport Modernization Plan Summary

Projects	Description	Timeline & Details
<b>New Passenger Concourse</b>	A new concourse to accommodate the Airport's existing three million passengers. Includes a new state-of-the-art consolidated security screening area, a 34,750 sq. ft. boarding lounge with improved seating, concessions and restrooms. Enhanced features include an atrium and a garden walkway, as well as Long Beach specific displays. Solar and green technology will be integrated throughout the project	<p>Approved by Planning Commission &amp; Cultural Heritage Commission, April 2010</p> <p>City Council Review, June 2010 Groundbreaking in December 2010</p> <p>Construction: December 2010—2013 Jobs: Support 340 jobs. Cost and Funding: \$45 million, GARB &amp; PFC</p>
<b>New Parking Structure</b>	A new 1,989-space structure and 247 space surface parking, as well as utility and roadway improvements. Includes a new exit to Lakewood Blvd. Infrastructure for solar technology will be integrated throughout the project.	<p>Construction: December 2009 – Fall 2011</p> <p>Jobs: Support 450 jobs, over 50 different construction trades. Cost and Funding: \$56 million, GARB, Federal BAB, and PFC</p>
<b>Air Carrier Ramp</b>	Consists of aircraft parking pad redesign and upgrade from asphalt to concrete, electrification of all pads, new 'high-mast' lighting and realignment of parking pads to accommodate all aircraft.	<p>Ongoing through fall 2012, 3 to 4 phases</p> <p>Jobs: Support 100 – 120 jobs per phase Cost and Funding: \$33 million, AIP &amp; PFC</p>
<b>Historic Terminal Modernization</b>	General rehabilitation of the historic terminal, new interior and exterior paint, new furnishings, enhanced lighting, restoration of historic exhibit, modernizing infrastructure and upgrading architectural features. Also includes repainting the existing parking structure.	<p>Ongoing</p> <p>Jobs: Support 80 jobs Cost and Funding: \$2 million</p>