



# CITY OF LONG BEACH

# C-17

## DEPARTMENT OF PUBLIC WORKS

333 WEST OCEAN BOULEVARD • LONG BEACH, CA 90802 • (562) 570-6383 • FAX (562) 570-6012

September 16, 2008

HONORABLE MAYOR AND CITY COUNCIL  
City of Long Beach  
California

### RECOMMENDATION:

Request the City Manager or designee to accept an easement deed for alley widening at 1476 Long Beach Boulevard. (District 1)

### DISCUSSION

It is the goal of the Department of Public Works to widen alleys to the standards established in the City's General Plan. When significant new development is proposed, the public rights-of-way adjacent to the site are reviewed for sufficiency to accommodate the new development. For the construction of a new preschool at 1476 Long Beach Boulevard, the dedication of additional alley width is recommended. In particular, the existing 16-foot wide alley should be widened on the west side by 2.0 feet, to a total width of 18 feet. The standard alley width of 20 feet will be achieved when property on the east side of the alley is improved and an additional public alley dedication of 2.0 feet is recorded. Please see the attached Exhibit A.

The developer of the subject property agreed to development conditions that include the above-described dedications and improvements thereto. In conformance with the California Environmental Quality Act, Categorical Exemption No. CEP 07-189 was issued for this project.

This matter was reviewed by Deputy City Attorney Linda Trang on July 31, 2008 and by Budget Management Officer Victoria Bell on August 26, 2008.

### TIMING CONSIDERATIONS

City Council action on this matter is not time critical.

**DIRECTOR'S OFFICE  
BUDGET & PERSONNEL**  
333 W. Ocean Blvd., 9<sup>th</sup> Floor  
Long Beach, CA 90802  
Ph. (562) 570-6383  
Fax (562) 570-6012

**ENGINEERING**  
333 W. Ocean Blvd., 9<sup>th</sup> Floor  
Long Beach, CA 90802  
Ph. (562) 570-6634  
Fax (562) 570-6012

**ENVIRONMENTAL  
SERVICES**  
2929 E. Willow Street  
Long Beach, CA 90806  
Ph. (562) 570-2850  
Fax (562) 570-2861

**FLEET SERVICES**  
2600 Temple Avenue  
Long Beach, CA 90806  
Ph. (562) 570-5400  
Fax (562) 570-5414

**PUBLIC SERVICE**  
1601 San Francisco Avenue  
Long Beach, CA 90813  
Ph. (562) 570-2782  
Fax (562) 570-2729

HONORABLE MAYOR AND CITY COUNCIL

September 16, 2008

Page 2

FISCAL IMPACT

A document processing fee of \$490.00 was paid by the developer and deposited in the General Fund (GP 100) in the Department of Public Works (PW).

SUGGESTED ACTION:

Adopt recommendation.

Respectfully submitted,

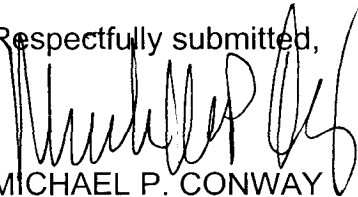

MICHAEL P. CONWAY  
DIRECTOR OF PUBLIC WORKS

P:\CL\ROW ded 1476 Long Beach Blvd.doc  
GMM:SC:db

Exhibit A

APPROVED:

  
PATRICK H. WEST  
CITY MANAGER

**SKETCH NO. 2048**

**SKETCH SHOWING A PORTION OF LOT 6, TRACT NO. 1480, AND LOT 2, BLOCK 1, ENO AND VARNEY TRACT DEDICATED TO THE CITY OF LONG BEACH FOR ALLEY PURPOSES.**

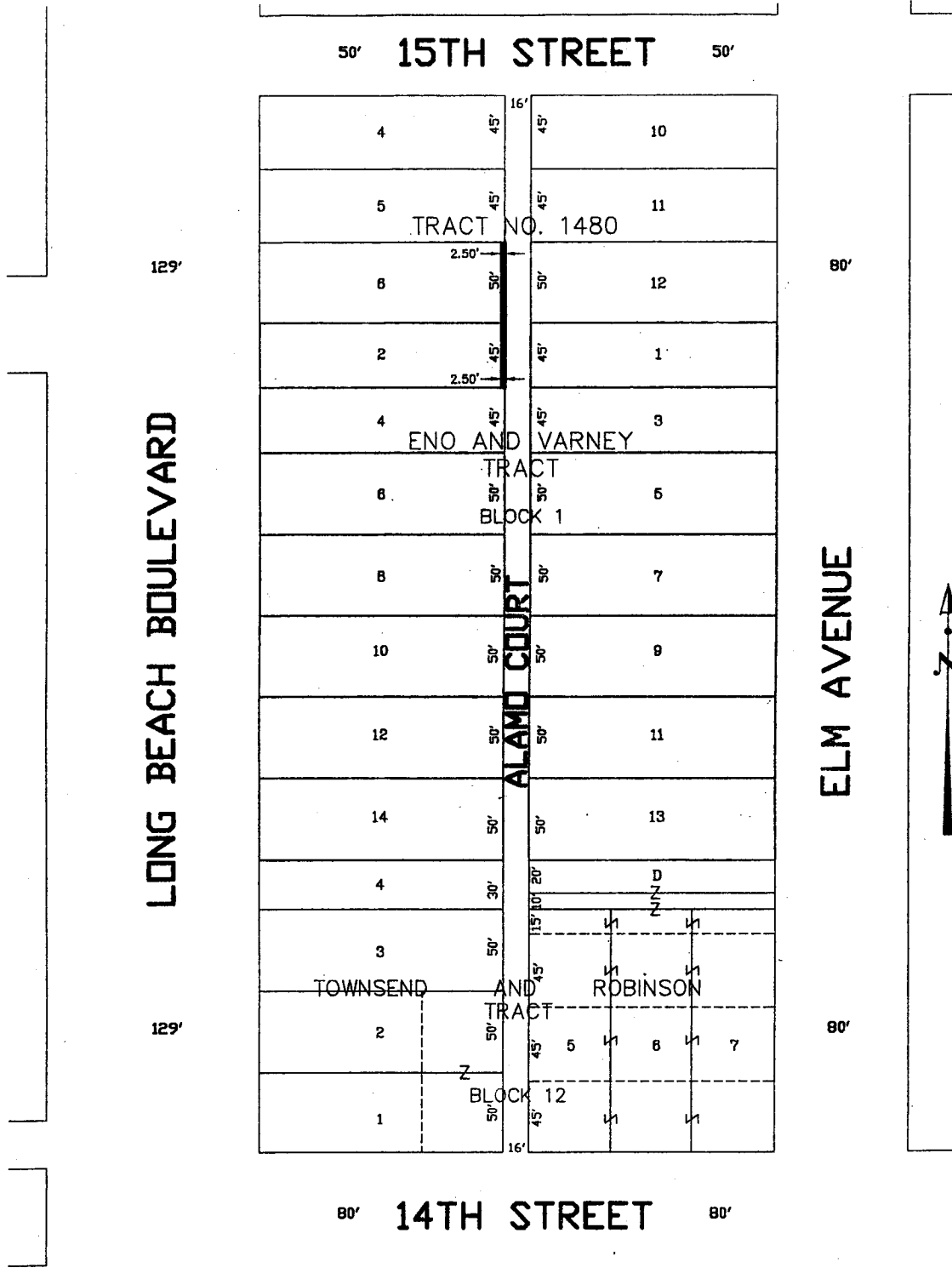

■ SHOWS PORTIONS DEDICATED

**EXHIBIT A**