

OFFICE OF THE CITY ATTORNEY
CHARLES PARKIN, City Attorney
333 West Ocean Boulevard, 11th Floor
Lona Beach, CA 90802-4664

RESOLUTION NO. RES-16-0113

1
2
3 A RESOLUTION OF INTENTION TO VACATE THE
4 BELMONT DRIVE ALLEY LOCATED ADJACENT TO 4100
5 EAST OCEAN BOULEVARD, BETWEEN OCEAN
6 BOULEVARD AND OLYMPIC PLAZA DRIVE, IN THE CITY
7 OF LONG BEACH, COUNTY OF LOS ANGELES, STATE OF
8 CALIFORNIA, PURSUANT TO THE PUBLIC STREET,
9 HIGHWAYS AND SERVICE EASEMENTS LAW (DIVISION
10 9, PART 3, CALIFORNIA STREETS AND HIGHWAYS
11 CODE); FIXING A TIME AND PLACE FOR HEARING ALL
12 PERSONS INTERESTED IN OR OBJECTING TO THE
13 PROPOSED VACATION
14

15 The City Council of the City of Long Beach resolves as follows:

16 Section 1. The City Council of the City of Long Beach hereby elects to
17 proceed under Division 9, Part 3, Chapter 3, of the California Streets and Highways Code
18 (Section 8320 *et seq.*), as amended, generally known and referred as the "Public Street,
19 Highways and Service Easements Law", and hereby declares its intention to vacate the
20 Belmont Drive Alley located adjacent to 4100 East Ocean Boulevard, between Ocean
21 Boulevard and Olympic Plaza Drive, in the City of Long Beach, County of Los Angeles,
22 State of California, described more particularly as follows:
23

24 THAT CERTAIN 15 FEET WIDE ALLEY IN BLOCK 37 OF THE
25 RESUBDIVISION OF PART OF THE ALAMITOS BAY TOWNSITE, IN
26 THE CITY OF LONG BEACH, COUNTY OF LOS ANGELES, STATE OF
27 CALIFORNIA, AS PER MAP RECORDED IN BOOK 4, PAGES 75 AND
28 76 OF MAPS, IN THE OFFICE OF THE COUNTY RECORDER OF SAID

1
2
3
4
5
6
7
8
9
10
11
12
13
14
15
16
17
18
19
20
21
22
23
24
25
26
27
28

COUNTY, BOUNDED AS FOLLOW:

ON THE NORTHEAST BY SOUTHWESTERLY LINE OF OCEAN BOULEVARD, FORMERLY BAY LANE; ON THE SOUTH BY THE NORTH LINE OF OLYMPIC PLAZA, FORMERLY ALLIN STREET; AND ABUTTING LOTS 4, 5, 6, 7 AND 8 IN SAID BLOCK 37 OF THE RESUBDIVISION OF PART OF THE ALAMITOS BAY TOWNSITE, AS PER MAP RECORDED IN BOOK 4, PAGES 75 AND 76 OF MAPS, AND ALSO ABUTTING LOT 2 OF TRACT NO. 10268, RECORDED IN BOOK 176, PAGES 28 AND 29 OF MAPS, BOTH IN THE OFFICE OF THE COUNTY RECORDER OF SAID COUNTY.

CONTAINING AN AREA OF 1920 SQUARE FEET, MORE OR LESS.

RESERVING UNTO THE CITY OF LONG BEACH, ITS SUCCESSORS AND ASSIGNS A PERPETUAL EASEMENT AND RIGHT-OF-WAY FOR EMERGENCY ACCESS, AND A PERPETUAL EASEMENT AND RIGHT OF WAY, AT ANY TIME OR FROM TIME TO TIME, TO LAY, CONSTRUCT, MAINTAIN, OPERATE, REPAIR, RENEW, REPLACE, CHANGE THE SIZE OF AND REMOVE THE EXISTING UTILITY LINES, INCLUDING, BUT NOT LIMITED TO, SANITARY, SEWERS, STORM DRAINS AND APPURTENANT STRUCTURES, TOGETHER WITH ALL NECESSARY GATES, VALVES, FITTINGS, HYDRANTS AND APPURTENANCES FOR THE TRANSPORTATION OF WATER AND GAS, WITH THE RIGHT OF INGRESS TO AND EGRESS FROM THE SAME, OVER, THROUGH, UNDER, ALONG AND ACROSS THAT CERTAIN PROPERTY VACATED HEREWITH; AND PURSUANT TO ANY EXISTING FRANCHISES OR RENEWALS THEREOF, OR OTHERWISE, TO CONSTRUCT, MAINTAIN, OPERATE, REPLACE, REMOVE, RENEW AND ENLARGE LINES OF CONDUITS, CABLES,

1 WIRES, POLES AND OTHER CONVENIENT STRUCTURES,
2 EQUIPMENT AND FIXTURES FOR THE OPERATION OF TELEPHONE
3 LINES AND OTHER COMMUNICATION LINES, AND FOR THE
4 TRANSPORTATION OR DISTRIBUTION OF ELECTRIC ENERGY, AND
5 INCIDENTAL PURPOSES INCLUDING ACCESS AND THE RIGHT TO
6 KEEP THE PROPERTY FREE FROM INFLAMMABLE MATERIALS, AND
7 WOOD GROWTH, AND OTHERWISE PROTECT THE SAME FROM ALL
8 HAZARDS IN, UPON AND OVER THE PART VACATED. ACCESS FOR
9 MAINTENANCE OF THE ABOVE-MENTIONED FACILITIES MUST BE
10 MAINTAINED AT ALL TIMES. NO IMPROVEMENTS SHALL BE
11 CONSTRUCTED WITHIN THE EASEMENT WHICH WOULD IMPEDE
12 THE OPERATION, MAINTENANCE OR REPAIR OF SAID FACILITIES.
13 CONSTRUCTION OF ANY IMPROVEMENTS, INCLUDING CHANGES
14 OF GRADE, SHALL BE SUBJECT TO THE PRIOR WRITTEN
15 APPROVAL OF ALL THE CITY DEPARTMENTS AND PUBLIC
16 UTILITIES RESPONSIBLE FOR THE ABOVE SAID FACILITIES.

17 Section 2. All of the foregoing real property is shown on the map or plan
18 thereof, attached hereto as Exhibit "A", and on file in the office of the City Clerk, which
19 map or plan is known and referred to as "City of Long Beach Department of Public Works
20 Vacation Sketch No. 1020V".

21 Section 3. The City Council hereby fixes the 13th day of
22 December, 2016 at the hour of 5:00 p.m., as the time and the City Council
23 Chamber, Plaza Level of the City Hall, 333 West Ocean Boulevard, in the City of Long
24 Beach, California, as the place for hearing all persons interested in or objecting to the
25 proposed vacation.

26 Section 4. The City Council hereby directs that notice of said hearing on
27 this proposed street vacation be published for at least two (2) successive weeks prior to
28 the hearing and in the manner provided by Section 8322 of the State Streets and

SK 1020V

SKETCH SHOWING NORTH/SOUTH
ALLEY SOUTH OF OCEAN
BOULEVARD, EAST OF TERMINO
BOULEVARD, TO BE VACATED BY THE
CITY OF LONG BEACH

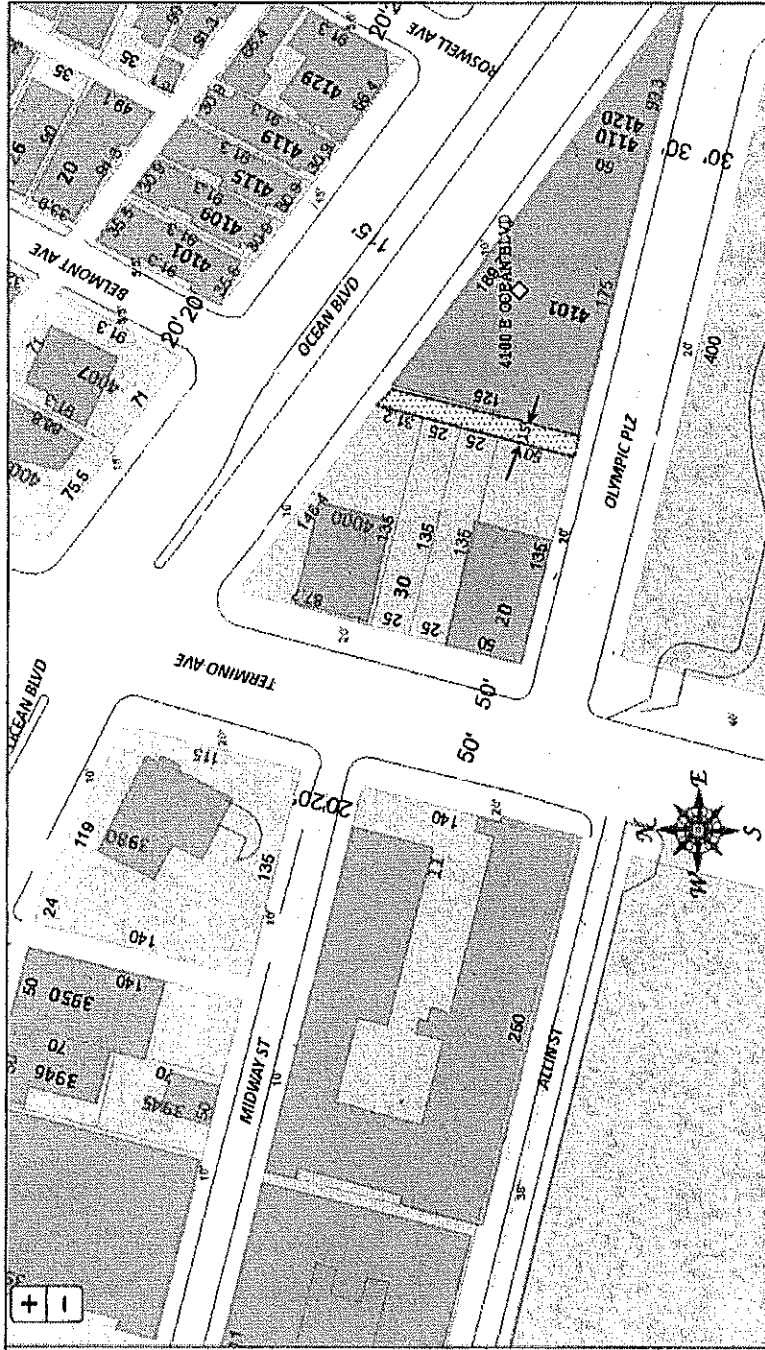

**ENGINEERING BUREAU
CITY OF LONG BEACH, CALIFORNIA**

SHOWS AREA OF PROPOSED
RIGHT-OF-WAY VACATION

EXHIBIT A

EXHIBIT A