



CITY OF LONG BEACH

POLICE DEPARTMENT
400 WEST BROADWAY LONG BEACH CALIFORNIA 90802

~~R-30~~
UB-23

Robert G. Luna
Chief of Police

July 21, 2015

HONORABLE MAYOR AND CITY COUNCIL
City of Long Beach
California

RECOMMENDATION:

Receive and file the application of Juan Ramon Patino, dba Truilero Mexican Grill, for an original application of an Alcoholic Beverage Control license, at 1631 West Pacific Coast Highway. (District 1)

DISCUSSION

It is City Council policy to review applications for Alcoholic Beverage Control licenses to determine if a basis for protest against the issuance of the license exists. The attached application lists the possible bases for protest.

TIMING CONSIDERATIONS

City Council response is due to the Department of Alcoholic Beverage Control by July 24, 2015. Accordingly, City Council action is required at the July 21, 2015 City Council meeting.

FISCAL IMPACT

None.

SUGGESTED ACTION:

Approve recommendation.

Respectfully submitted,

ROBERT G. LUNA
CHIEF OF POLICE

APPROVED:

PATRICK H. WEST
CITY MANAGER

RGL:LBB:ibb

ADMINISTRATION BUREAU
(562) 570-5830
FAX (562) 570-5833

FINANCIAL BUREAU
(562) 570-7447
FAX (562) 570-5833

INVESTIGATIONS BUREAU
(562) 570-7350
FAX (562) 570-5837

PATROL BUREAU
(562) 570-7214
FAX (562) 570-7058

SUPPORT BUREAU
(562) 570-7342
FAX (562) 570-6018

HONORABLE MAYOR AND CITY COUNCIL
July 21, 2015

Council District: 1

Applicant: Juan Ramon Patino
DBA: Truilero Mexican Grill
Address: 1631 W. Pacific Coast Highway

Type of Application: An original application of an On-Sale Beer and Wine license for a bonafide eating place license.

Bases for possible protest: Residences within 100 feet.
High crime.

PUBLIC CONVENIENCE DETERMINATION: A determination by the City of public convenience and necessity **is not** required for this application.

Census Tract: 5729.00

Boundaries: Hill Street/19th Street to the North
Pacific Coast Highway to the South
Los Angeles River to the East
Santa Fe Avenue/Cota Avenue to the West

Number of licenses allowed: 5
Number of licenses existing: 0

Police Reporting District: 052

Boundaries: 20th Street to the North
Pacific Coast Highway to the South
Los Angeles River to the East
Santa Fe Avenue to the West

Reported crimes in this district for ABC purposes are 153. Crime in a reporting district must be at least 147 to qualify for a high crime protest.

Type of business: A restaurant.
Last day to request conditions and protest: July 24, 2015



Date: July 21, 2015
To: File
From: Laurie Barajas, Detective, Vice Investigations Section
Subject: **TRUILERO MEXICAN GRILL – 1631 WEST PACIFIC COAST HIGHWAY**

CALLS FOR SERVICE/ARRESTS AND INVESTIGATIONS (6/26/14 to 6/26/15)

7 459A Audible Burglary Alarm

ABC INSPECTIONS (past three years)

Not Applicable

RESIDENCES WITHIN 100 FEET

1610 West Parade Street	Single Family Residence
1612 West Parade Street	Single Family Residence
1614 West Parade Street	Single Family Residence
1616 West Parade Street	Single Family Residence
1624 West Parade Street	Multi-Unit Complex
1630 West Parade Street	Single Family Residence
1630 West Parade Street #A	Single Family Residence
1638 West Parade Street	Single Family Residence
1644 West Parade Street	Single Family Residence
1646 West Parade Street	Single Family Residence
1648 West Parade Street	Single Family Residence
1635 West Pacific Coast Highway	Multi-Unit Complex

CHURCHES, SCHOOLS, PARKS, HOSPITALS AND PLAYGROUNDS WITHIN 600 FEET

None

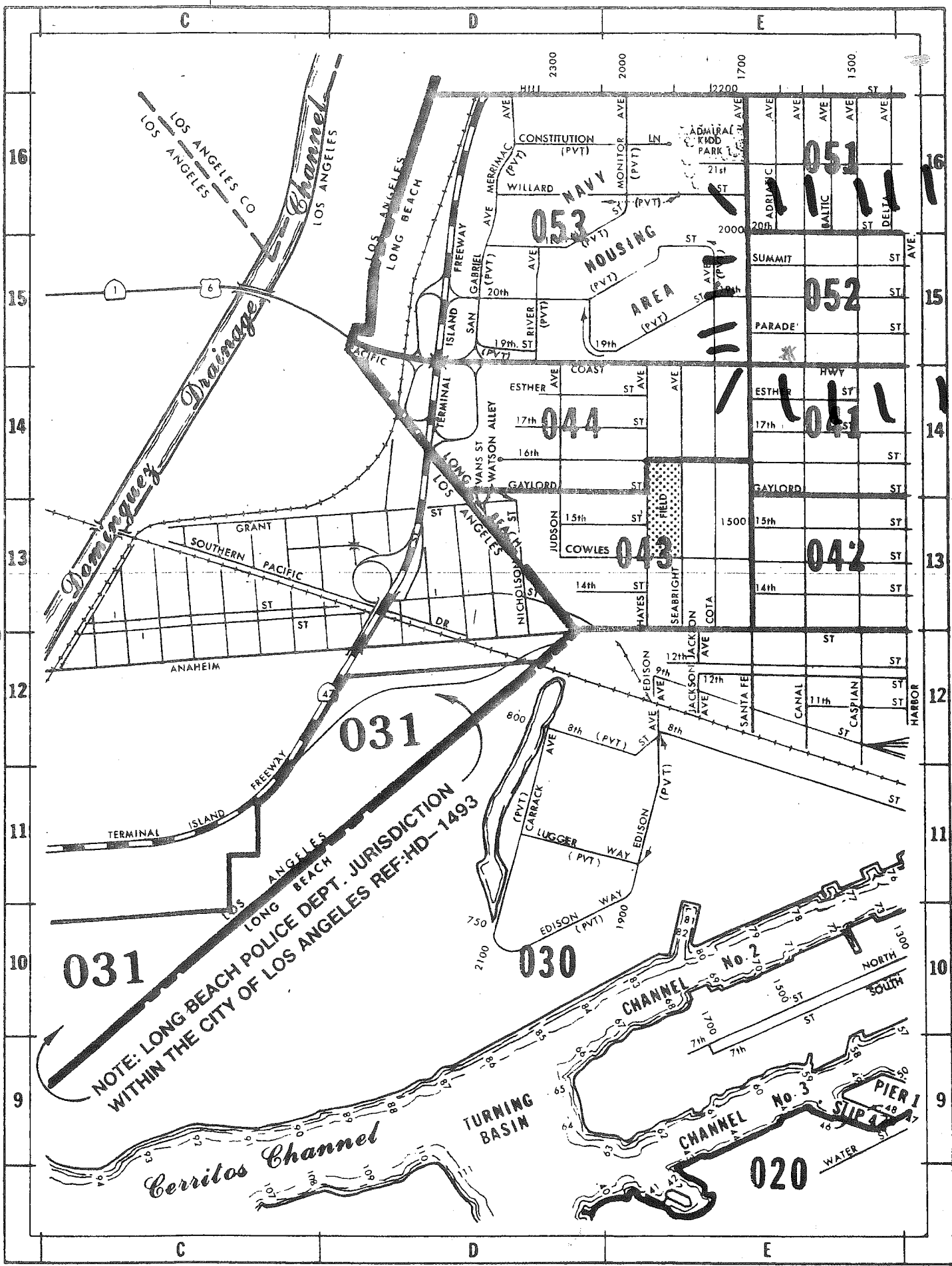

031

031

030

053
NAVY HOUSING AREA

052

051

044

041

043

042

NOTE: LONG BEACH POLICE DEPT. JURISDICTION
WITHIN THE CITY OF LOS ANGELES REF:HD-1493

Cerritos Channel

TURNING BASIN

CHANNEL No. 2

CHANNEL No. 3

020

PIER 1
SLIP A

9

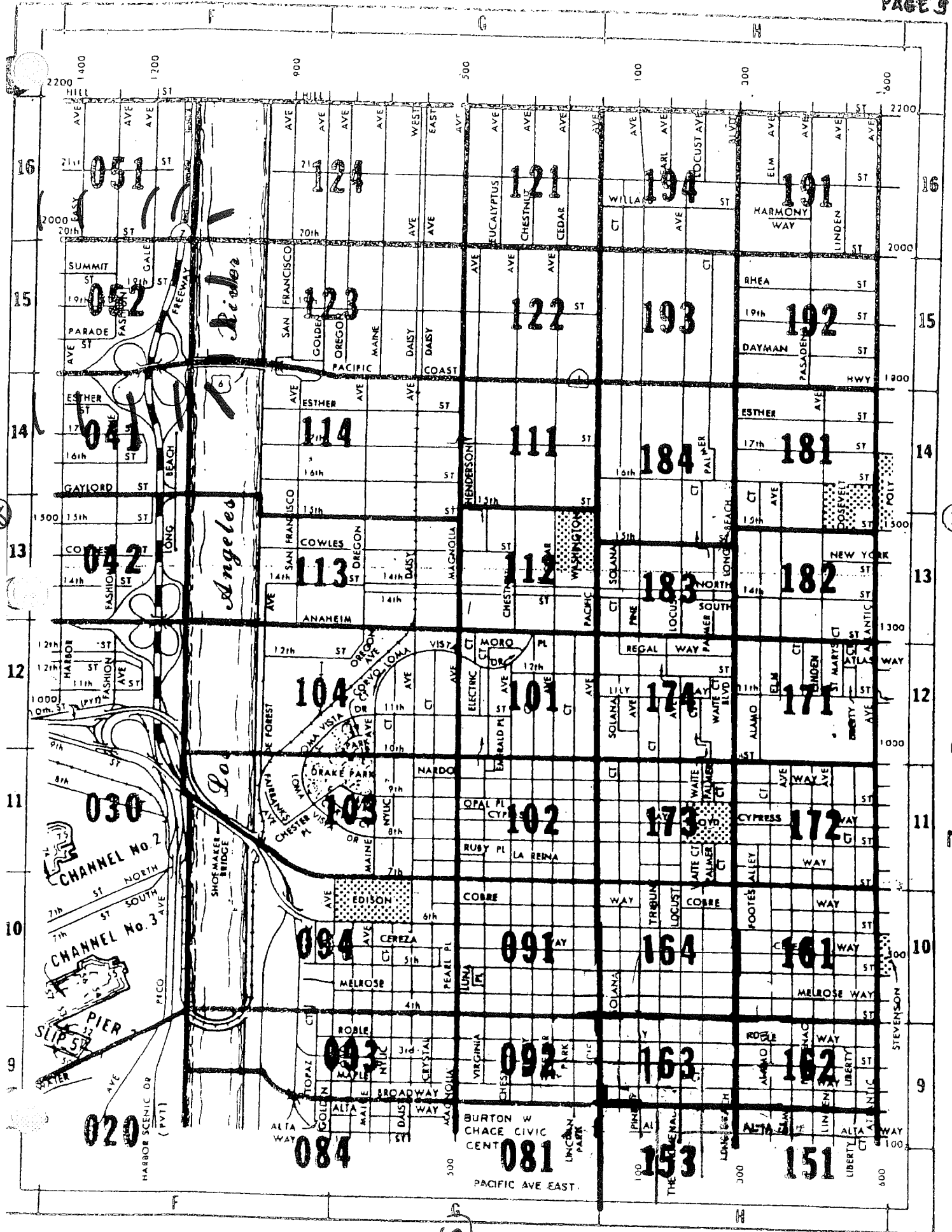

10

3