

CITY OF LONG BEACH

DEPARTMENT OF PUBLIC WORKS

333 WEST OCEAN BOULEVARD., 9th Floor LONG BEACH, CA 90802 562.570.6383 FAX 562.570.6012

December 2, 2014

HONORABLE MAYOR AND CITY COUNCIL
City of Long Beach
California

RECOMMENDATION:

Authorize the City Manager to execute a Public Walkways Occupancy Permit for sidewalk dining at Pot Holder restaurant located at 3700 East Broadway.
(District 3)

DISCUSSION

The operator of Pot Holder restaurant requests a permit to temporarily occupy part of the adjoining sidewalk at 3700 East Broadway, for the purpose of sidewalk dining. The proposed permit area sketch and a list of furnishings and accessories to be placed in the permit area are shown on the attachment. Approval of this permit is based on the conditions and standards of Chapter 14.14 of the Long Beach Municipal Code, which describes temporary uses of public right-of-way. The width of the sidewalk is 12 feet. A minimum width of 5 feet will be maintained between the sidewalk dining area and other sidewalk obstructions.

This matter was reviewed the Long Beach Fire Department on August 20, 2014, by Deputy City Attorney Linda Vu on September 24, 2014, and by Budget Management Officer Victoria Bell on November 7, 2014.

TIMING CONSIDERATIONS

City Council action on this matter is not time critical.

FISCAL IMPACT

A permit processing fee in the amount of \$616 was deposited into the General Fund (GF) in the Public Works Department (PW) and a security deposit of \$580 was provided to assure sidewalk repairs upon permit termination. Approval of this recommendation will provide continued support to the local economy.

HONORABLE MAYOR AND CITY COUNCIL

December 2, 2014

Page 2

SUGGESTED ACTION:

Approve recommendation.

Respectfully submitted,



ARA MALOYAN, PE
DIRECTOR OF PUBLIC WORKS

APPROVED:

PATRICK H. WEST
CITY MANAGER

PICLIPWOP- Pot Holder restaurant CL.doc
AM:GMM:SDJ:st

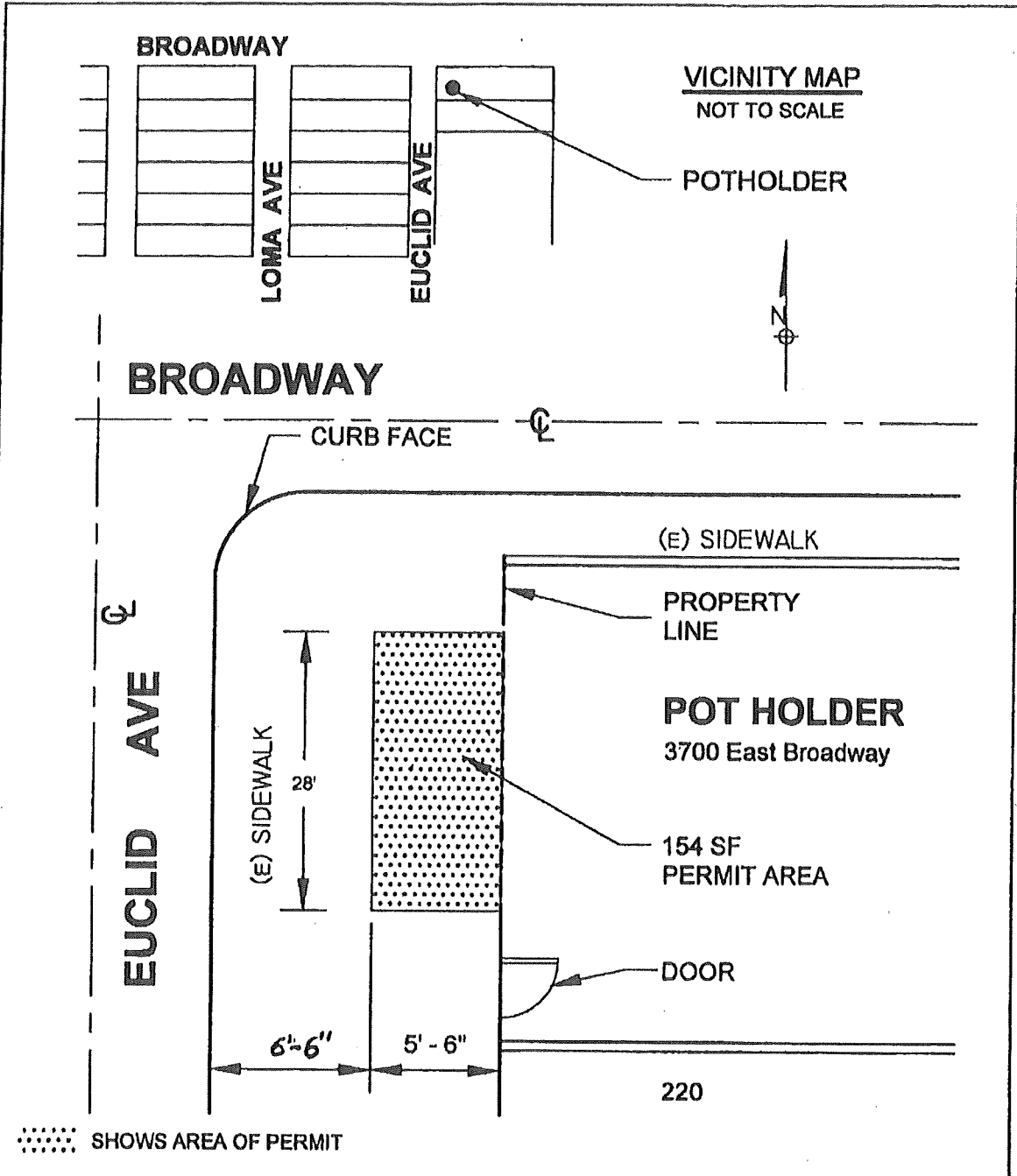
Attachment: Sketch and List of Furnishings



CITY OF LONG BEACH - CALIFORNIA
DEPARTMENT OF PUBLIC WORKS, ENGINEERING BUREAU

PUBLIC WALKWAYS OCCUPANCY

PERMIT
POT HOLDER
3700 E. Broadway

List of Approved Furnishings and Accessories
(Attachment to Public Walkways Occupancy Permit for Sidewalk Dining Purposes)

Restaurant: POTHOLDER Permittee: KEVIN PITTSEY
Address: 3700 EAST BROADWAY, LONG BEACH, 90803 Telephone: 310-582-5382

X Tables
number: 5

X Chairs
number: 10

X Umbrella(s)
height & number: 7'AFF, 5 UNITS

NA Heater(s)
height & number: NA

NA Menu board
note: maximum height of 5 ft 6 in, maximum width of 2 ft
& none permitted in the coastal zone

NA Waiter station
size: NA

X Planters for trees or other greenscaping
describe: PROPOSED BOX PLANTERS ABOVE REQUIRED 42" FENCE
WITH CLIMATE FRIENDLY SUCCULENTS

NA Other: NA

NA We intend to make occasional use of the permit area for live or recorded entertainment
(Note: A separate entertainment permit is required).

- The following are prohibited:
- canopies (ground supported)
 - television monitors

Permittee signature:  Date: 6-5-14
Print name here: KEVIN PITTSEY CEO

This list of furnishings and accessories is effective only when attached to a completed Public Walkways Occupancy Permit.