

FLYNN'S SIGNS &
GRAPHICS

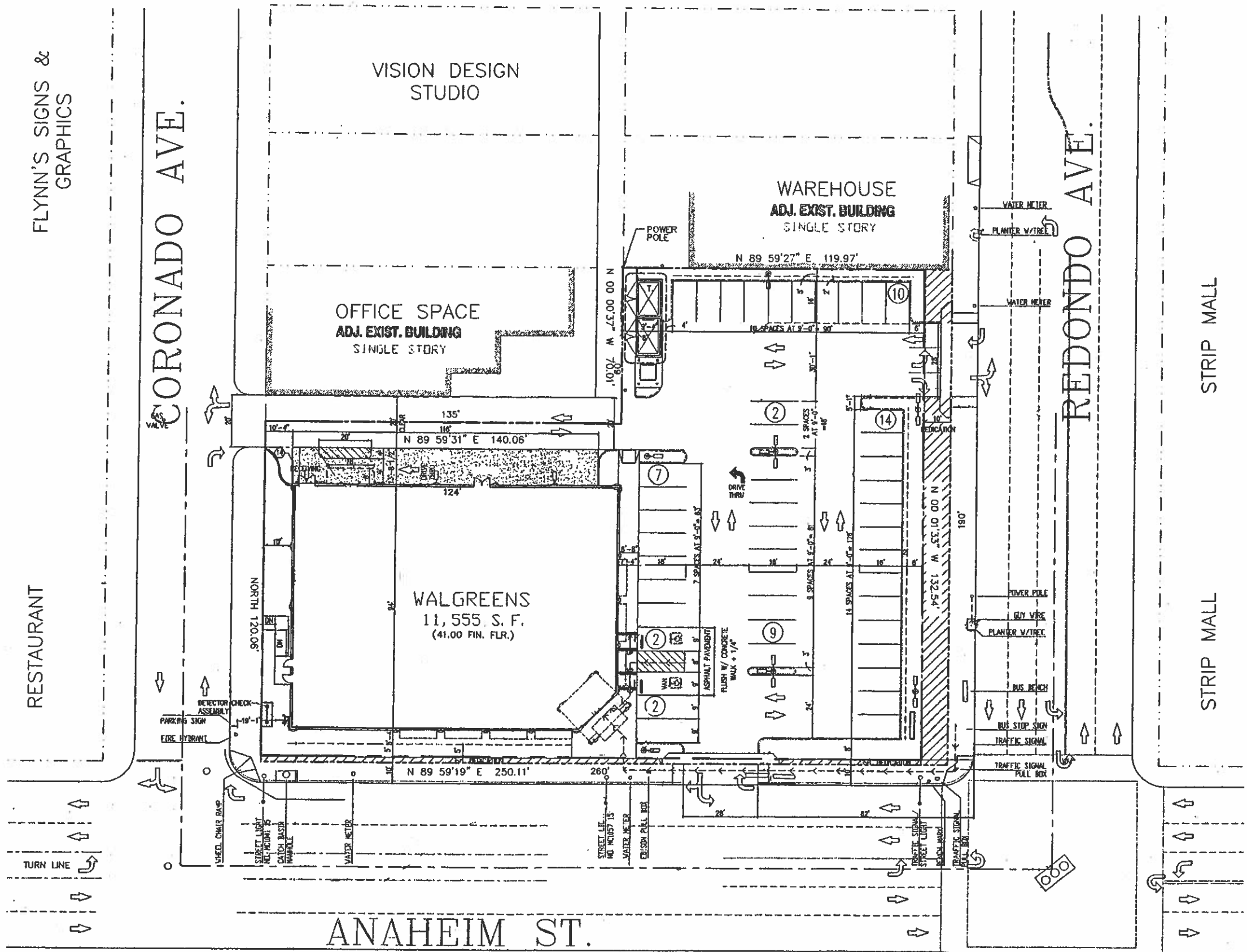

1 SITE PLAN
1" = 20'

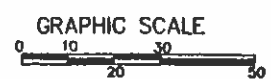

- PRJ
DRAWINGS/SPECIFICATIONS
 WALGREENS
 LANDLORD'S CONSULTA
ALL CONSTRUCTION WORK
 WALGREENS' CONTRACT
 LANDLORD'S CONTRACT
STORE

- NEW
REMODELING
RELOCATION
EXISTING
- GEN
1. ALL EXISTING CONDITIONS OF CONSTRUCTION ARE TO REMAIN UNLESS NOTED OTHERWISE.
2. ALL CONDITIONS, DIMENSIONS, MATERIALS OF CONSTRUCTION SHEET/DRAWING ARE "EXCEPT AS NOTED".
3. ALL EXISTING CONDITIONS REMAIN UNLESS NOTED OTHERWISE.
4. VERIFY ALL EXISTING CONDITIONS PRIOR TO ANY CONSTRUCTION.
5. LOCATION OF EXISTING SPRINKLER HEADS AS RECORDED IN THE FIELD.
6. NOTIFY WALGREENS OF ANY CHANGES.

TOTAL BUILDING AREA: _____
TOTAL PARCEL AREA: 41,000 S.F.
FAR: 27.97%
PARKING SPACES REQUIRE 100 PARKING SPACES PROVIDED
ZONING: CCA (ADJACENT)
LEGAL DESCRIPTION: LOT 11, BLOCK "A" IN THE ORION BEACH, COUNTY OF LOS ANGELES, AS PER MAP RECORDED MAPS IN THE OFFICE OF THE COUNTY CLERK, COUNTY OF LOS ANGELES, BOOK 1356, PAGE 11.

NO.	DATE	BY

CERTIFICATE
I HEREBY CERTIFY THAT THIS PLAN AND SPECIFICATION WAS PREPARED BY ME OR UNDER MY DIRECT SUPERVISION AND THAT I AM A DULY REGISTERED ARCHITECT OR ENGINEER UNDER THE LAWS OF THE STATE OF CALIFORNIA AS SIGNIFIED BY MY HAND AND SEAL.

STORE
WALGRN
3331
LON

CADD PLOT:	SCA
07832-001-01-200-009	DRA
VOID PLOT:	DAT
SUPERSEDES PLAN DATED:	REV

**NO LOITERING
IS ALLOWED ON
OR IN FRONT OF
THESE PREMISES**

**WARNING:
Drinking spirits, beer,
coolers, wine, and other
alcoholic beverages may
increase cancer risk
and, during pregnancy,
can cause birth defects.**

**NO OPEN
ALCOHOLIC BEVERAGE
CONTAINERS
ARE ALLOWED ON
THESE PREMISES**

**Walgreen Co. employees
may refuse to sell alcohol
to any person reasonably suspected to
be under the age of twenty-one (21)
years, who is unable to produce
adequate written evidence that they
are over the age of twenty-one (21)
years or who is obviously intoxicated.**

**Any minor who purchases or
attempts to purchase alcohol may
be subject
to penalties.**

NOTICE TO CUSTOMERS

Pursuant to Section 23008.4 Business and Professions Code
This store will not sell alcoholic beverages in violation of the
California Alcoholic Beverage Control Act.
We will refuse to sell an alcoholic beverage to any customer
if we reasonably suspect that: (1) The customer is under the age of 21
years; (2) The customer looks or acts intoxicated; (3) The request
to buy an alcoholic beverage is made between the hours of 2:00
a.m. and 6:00 a.m. on any day or in violation of legally required
shorter hours of sale; (4) The customer intends to drink the
alcoholic beverage in this store or on adjacent property immediately
outside this store; or (5) Any other violation of the California
Alcoholic Beverage Control Act will occur as a result of the sale.

**FINES AND PENALTIES
for the Sale or Furnishing of Alcoholic Beverages to,
or the Purchase of Alcoholic Beverages by,
Persons Under Age 21**

For the Person Under Age 21 Who Tries to Purchase Alcohol
Up to a \$100 fine and/or 24-32 hours of community service; second
offense, up to a \$250 fine and/or 36-48 hours of community service
(and a one-year suspension or delay of the person's driver's
license).

For the Person Under Age 21 Who Purchases Alcohol
A \$250 fine and/or 24-32 hours of community service; second
offense, up to a \$500 fine and/or 36-48 hours of community service
(and a one-year suspension or delay of the person's driver's
license).

**For the Person Who Furnishes Alcohol or Causes Alcohol to be
Furnished to a Person Under Age 21**
A \$1,000 fine and at least 24 hours of community service (and a
one-year suspension or delay of the furnisher's driver's license if
the furnisher is under age 21). If great bodily injury or death
occurs, the penalty is 6-12 months county jail and/or a \$1,000 fine.

For the Person Who Sells Alcohol to a Person Under Age 21
A \$250 fine and/or 24-32 hours of community service; second
offense, up to a \$500 fine and/or 36-48 hours of community service
(and a one-year suspension or delay of the seller's driver's license if
the seller is under age 21).

In addition, the Department of Alcoholic Beverage Control
(ABC) will file charges to suspend or revoke this store's
license to sell alcoholic beverages.

ABC-299 (11/03) --The Management

TYPE	GENE
NEW LOCATION	PHAR
EXIST'G BLDG	1 HOL
REMODEL	LIQU
SQUARE FO	
DEPARTMENT	SALES
GEN SALES	NEW 8899
	EXIST'G
FOOD MART	NEW 700
	EXIST'G
RX	NEW 833
	EXIST'G
RX WAITG	NEW 183
	EXIST'G
1 HOUR PHOTO	NEW 435
	EXIST'G
LIQUOR	NEW
	EXIST'G
BKMT	NEW
	EXIST'G
2ND FLOOR	NEW
	EXIST'G
TOTAL NEW	10,860
TOTAL EXST'G	
TOTAL AREA: FIRST FLOOR	
TOTAL AREA: OTHER LEVEL	
GROSS AREA INCLUDING ALL DEPARTMENTS & ALL LEVEL	
RX SHELVING LINEAL FEET:	
FIXTURE	
MECH/LEV	
MYERS	
4-26-05	SS
	KDC
	CEN
	RAC
	SHO
	DN
	BEA
	CNC
	ARE
	REV
	ELE
8-03-05	KT
	KDK
	PAC
	RAC

NO.	DATE	BY	R
			CERTIFIC
I HEREBY CERTIFY THAT THE PLAN AND SPECIFICATION WAS PREPARED BY ME OR UNDER MY DIRECT SUPERVISION AND THAT I AM A DULY REGISTERED ARCHITECT OR ENGINEER UNDER THE LAWS OF THE STATE OF CALIFORNIA AS SIGNIFIED BY MY HAND AND SEAL.			
STORE			
PR			
WALGR			
3339 E			
LON			
DR			
DRA			
SCA			
VOID PLOT:			
_F07832D106.DWG			
DRA			
_M			
VOID PLOT:			
_F07832D107.DWG			
DATI			
SUPERSEDES			
PLAN DATED:			
REVI			

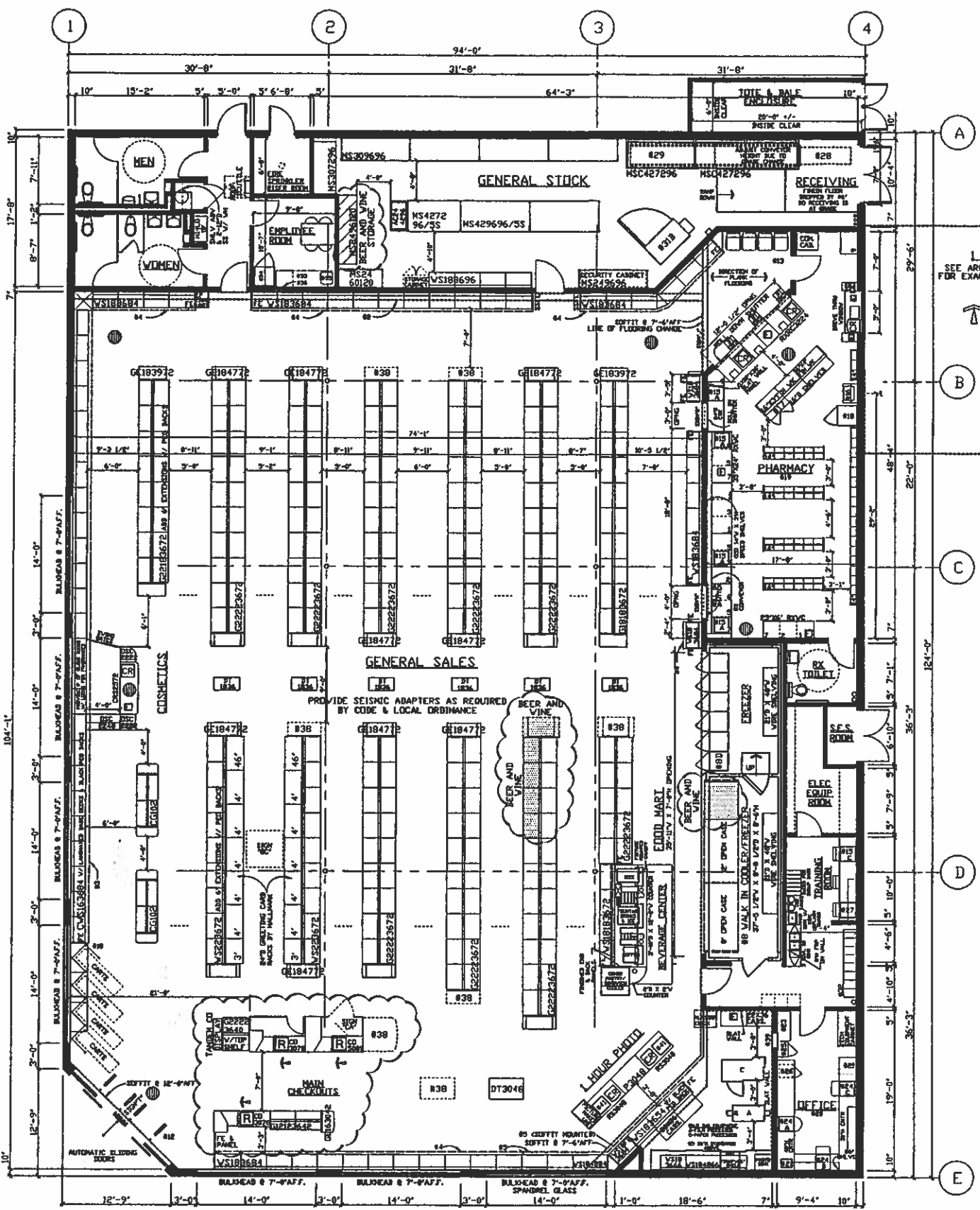

LEGEND

BEER AND WINE SALES (hatched pattern)

BEER AND WINE STORAGE (diagonal lines)

CEILING MOUNTED CCTV CAMERA (circle with 'C')

R MAIN CHECKOUT (circle with 'R')

BEER/WINE AREA

TOTAL STORAGE: 18 SQ. FT. TOTAL SALES: 28 SQ. FT.

SALES POLICIES

WALGREENS HAS TAKEN GREAT MEASURES TO ASSURE THAT ANY BEVERAGE CONTAINING ALCOHOL WILL BE SOLD IN A RESPONSIBLE AND APPROPRIATE MANNER. DETAILED POLICIES AND PROCEDURES ARE ALREADY IN PLACE, ENDORSED BY LEGAL COUNSEL, AS WELL AS SENIOR MANAGEMENT AND ARE STRICTLY ENFORCED WITHOUT EXCEPTION.

- EMPLOYEES FOR EACH ELIGIBLE STORE MUST UNDERGO EXTENSIVE TRAINING PRIOR TO BEER AND WINE AVAILABILITY AT AN INDIVIDUAL LOCATION.
- ONCE TRAINED, EACH REGISTER CLERK MUST SUBMIT A POLICY ACKNOWLEDGMENT AS PART OF THE DAILY LOG-ON PROCESS.
- WALGREENS ESTABLISHED POLICY STATES THAT EMPLOYEES MUST REQUEST IDENTIFICATION FOR ANY CUSTOMER ATTEMPTING TO PURCHASE ALCOHOL WHO APPEARS TO BE UNDER THE AGE OF 40. REGISTER PROMPTS ENSURE COMPLIANCE BEFORE PROCEEDING WITH THE TRANSACTION.
- UNDER AGE EMPLOYEES ARE REQUIRED TO SEEK THE ASSISTANCE OF A MANAGER.

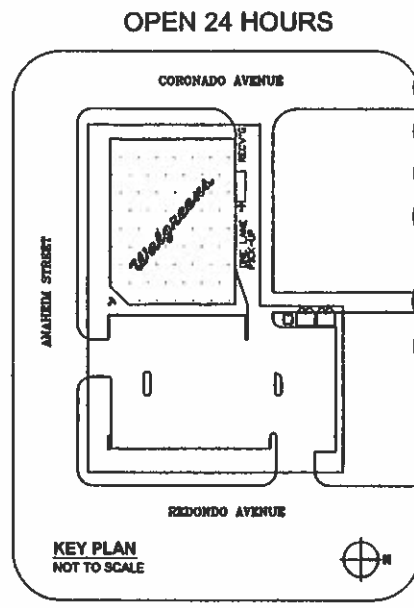

FOR REFERENCE ONLY: SEE CONTRACT DOCUMENTS FOR DETAILED SITE PLAN

EXECUTIVE APPROVAL		DATE	FIXTURE LEGEND	
SENIOR VICE PRESIDENT FACILITIES DEVELOPMENT	W. A. SHREL	08-09-03	0 18 18 36 80"	ALL OTHER FIXTURES ARE TYPICALLY CALLED OUT DEPTH BY WIDTH. EXAMPLE:
SENIOR VICE PRESIDENT STORE OPERATIONS	BRYANT	08-13-03	GE 18 30 66"	DT 30 48
VICE PRESIDENT STORE OPERATIONS	CHOTA	08-23-03	WS 18 30 84"	DISPLAY D. W. TABLE
REVIEWED BY:	K. K.	M. S.	*DOES NOT INCLUDE STANDARDS, WOOD GROUNDS OR FINISHED END PANELS	

