

RESOLUTION NO.

A RESOLUTION OF THE CITY COUNCIL OF THE
CITY OF LONG BEACH APPROVING SUBSTITUTION OF
FACILITIES IN COMMUNITY FACILITIES DISTRICT NO. 1
(BELMONT SHORE)

WHEREAS, the City Council of the City of Long Beach, has previously
established a community facilities district pursuant to the terms and provisions of the
"Mello-Roos Community Facilities Act of 1982", being Chapter 2.5, Part 1, Division 2,
Title 5 of the Government Code of the State of California (the "Act"); said Community
Facilities District is designated as Community Facilities District No. 1 (Belmont Shore)
(hereinafter referred to as the "District"); and

WHEREAS, the District was formed for the specific purpose of providing
the acquisition and improvement of public parking spaces, together with appurtenant
work as necessary, to make parking available to the commercial properties within the
Belmont Shore area and specifically within the boundaries of the District; and

WHEREAS, a this time, a public hearing has been held relating to the
proposed substitution of facilities, and a map has been presented showing the
substitution of certain properties that would provide parking for the commercial
properties within the boundaries of the District; and

WHEREAS, the Report of the Special Tax Consultant as previously
approved specifically authorized and provided for the substitution of facilities as long as
the facilities did provide a service and improvement substantially similar to those as
previously approved; and

WHEREAS, at this time, all testimony having been considered, the City
Council is now ready to proceed to approve the substitution of parcels and facilities
within the District;

Robert E. Shannon
City Attorney of Long Beach
333 West Ocean Boulevard
Long Beach, California 90802-4664
Telephone (562) 570-2200

Robert E. Shannon
City Attorney of Long Beach
333 West Ocean Boulevard
Long Beach, California 90802-4664
Telephone (562) 570-2200

1 NOW, THEREFORE, the City Council of the City of Long Beach resolves
2 as follows:

3 Section 1. That all protests of any kind have been heard and
4 considered and are deemed to be insufficient and are hereby overruled and denied.

5 Sec. 2. That the public interest and convenience requires, and this
6 legislative body does hereby approve a substitution of parking facilities, which said
7 substitution will still make parking available to the commercial properties within the
8 boundaries of the District.

9 A map of the parcels approved for substitution is attached as Exhibit "A"
10 hereto.

11 Sec. 3. That this approved substitution of facilities provides an
12 alternate parking plan providing a service and improvement similar to the approved plan
13 for the District and is not deemed to be a change and modification to the proceedings.

14 Sec. 4. That there will be no increase, modification or amendment in
15 the special taxes as previously authorized, approved and levied by reason of the
16 substitution of facilities.

17 Sec. 5. This resolution shall take effect immediately upon its
18 adoption by the City Council, and the City Clerk shall certify the vote adopting this
19 resolution.

20
21 I hereby certify that the foregoing resolution was adopted by the City
22 Council of the City of Long Beach at its meeting of _____, 2005, by

23 ////
24 ////
25 ////
26 ////
27 ////
28 ////

Robert E. Shannon
City Attorney of Long Beach
333 West Ocean Boulevard
Long Beach, California 90802-4664
Telephone (562) 570-2200

1
2
3
4
5
6
7
8
9
10
11
12
13
14
15
16
17
18
19
20
21
22
23
24
25
26
27
28

the following vote:

Ayes: Councilmembers: _____

Noes: Councilmembers: _____

Absent: Councilmembers: _____

City Clerk

HAM:R
7/13/05
L:\APPS\CtyLaw32\WPDOCS\ID013\IP004\00076804.WPD
#05-02835

MAP OF FACILITIES COMMUNITY FACILITIES DISTRICT NO. 1 CITY OF LONG BEACH (BELMONT SHORE) COUNTY OF LOS ANGELES STATE OF CALIFORNIA

- Belmont Shore Community Facilities District
- - - Belmont Shore Parking Meter Revenue Area

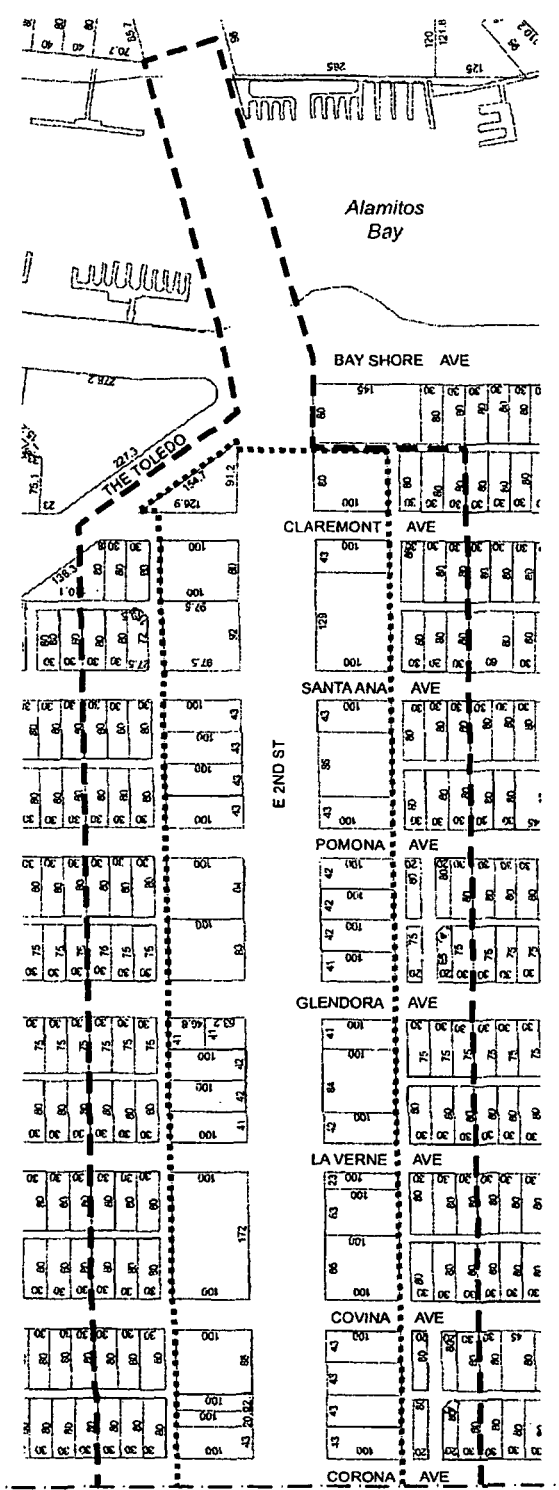
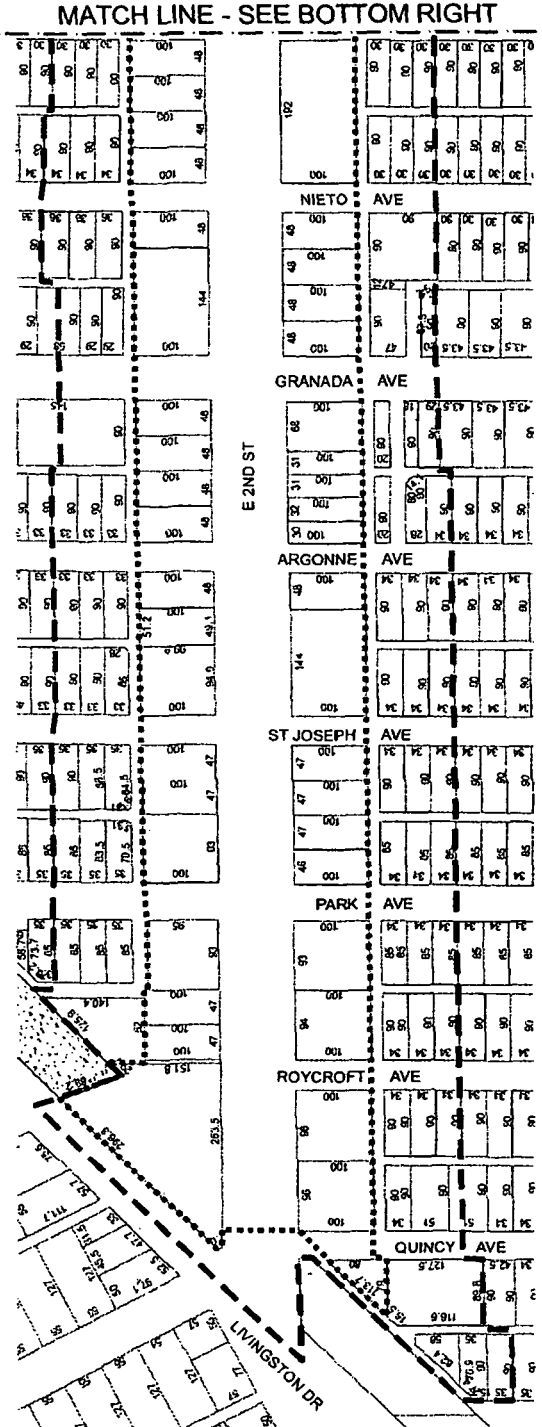

EXHIBIT A

Dept of Technology Services
GIS CMU - sbd 6/21/05