



# CITY OF LONG BEACH

DEPARTMENT OF COMMUNITY DEVELOPMENT

333 WEST OCEAN BOULEVARD • LONG BEACH, CALIFORNIA 90802

# C-4

August 18, 2009

HONORABLE MAYOR AND CITY COUNCIL  
City of Long Beach  
California

## RECOMMENDATION:

Authorize the City Manager to execute any and all documents necessary for a Revocable Facility Use Permit with the Antioch Church of Long Beach, for the use of the City-owned parking lot located at 1401 East Anaheim Street, also known as the Mark Twain Library, on a month-to-month basis at the initial monthly rental rate of \$250. (District 6)

## DISCUSSION

The Antioch Church of Long Beach (Antioch Church) was established in 1961 and is located at 1535 Gundry Avenue. Antioch Church currently has 1,200 members, who reside in Long Beach and throughout southern California. Four worship services are offered each Sunday, from 9:00 A.M. to 3:00 P.M. In addition, Antioch Church performs baptisms and conducts special group studies and staff meetings on Sunday afternoons.

Although Antioch Church already rents two other parking lots in the adjacent area for its members' use, the church is interested in further reducing its impact on neighborhood parking. To accommodate Antioch Church, the City has negotiated a parking agreement for use of the nearby Mark Twain Library parking lot on Sundays only, when the library facility is normally closed. The proposed Revocable Facility Use Permit contains the following major terms and conditions:

- Permittee: Antioch Church of Long Beach.
- Permit Area: The Permit area contains approximately 18,697 square feet of paved parking space at 1401 East Anaheim Street, also known as the Mark Twain Library. (Exhibit A)
- Use: The Permittee shall have exclusive use of 57 parking stalls in the Permit Area from 8:30 A.M to 4:00 P.M. on Sundays. Three additional parking stalls shall be reserved at all times for the City's use. Otherwise, the Permit Area shall be available to the community for public parking at all other times.
- Permit Fee: The initial Permit fee shall be \$250 per month or \$3,000 per year (\$1 x 57 stalls = \$57 x 52 weeks = \$2,964/12 months = \$250 rounded). The Permit fee shall be adjusted annually according to the Consumers Price Index.

HONORABLE MAYOR AND CITY COUNCIL

August 18, 2009

Page 2

- Term: The Permit shall become effective upon the date the Permit is fully executed and shall continue on a month-to-month basis until revoked by the City.
- City's Special Events/Business Operations: The City shall retain the right to use the Permit Area at any time for special events or change in business operations.
- Maintenance: The Permittee shall be responsible for maintaining the parking lot in a clean and safe condition during its hours of use.

This letter was reviewed by Deputy City Attorney Amy Burton on July 23, 2009 and Budget and Performance Management Bureau Manager David Wodynski on July 30, 2009.

TIMING CONSIDERATIONS

City Council action is requested on August 18, 2009 in order to formalize the Revocable Facility Use Permit with the Antioch Church of Long Beach.

FISCAL IMPACT

The proceeds of the annual Permit Fee of at least \$3,000 shall accrue to the General Fund (GP) in the Department of Library Services (LS).

SUGGESTED ACTION:

Approve recommendation.

Respectfully submitted,

  
DENNIS J. THYS  
DIRECTOR  
DEPARTMENT OF COMMUNITY DEVELOPMENT

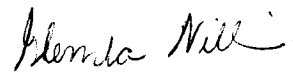
  
GLENDA WILLIAMS  
DIRECTOR  
DEPARTMENT OF  
LIBRARY SERVICES

DJT:MDL:mdl  
08-18-09 Antioch Church v3.doc

Attachment: Exhibit A – Site Map

APPROVED:

  
PATRICK H. WEST  
CITY MANAGER

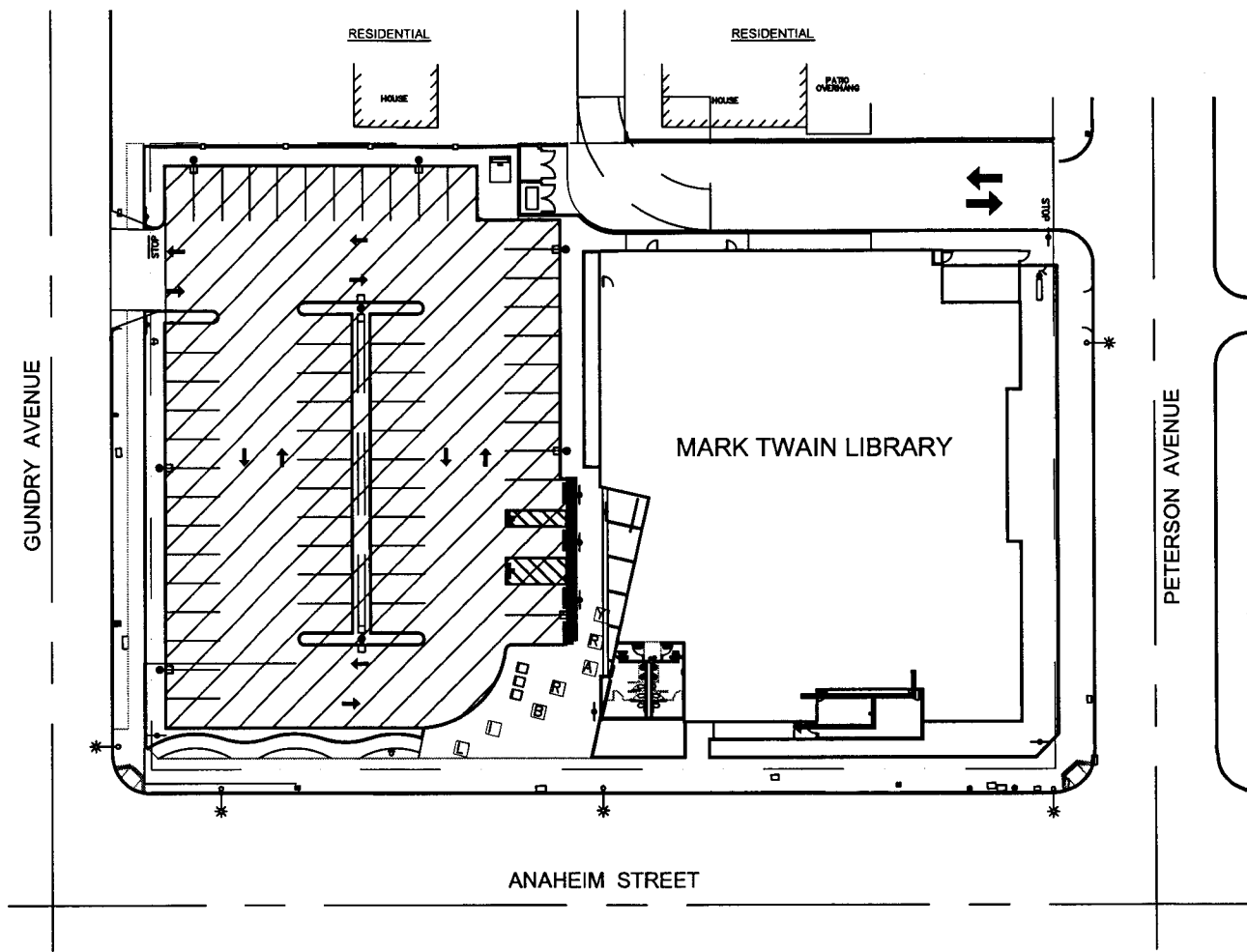

AREA OF PARKING LOT  
18,697 SQ FT or  
.429 OF AN ACRE



NTS

CITY OF LONG BEACH - CALIFORNIA  
COMMUNITY DEVELOPMENT DEPARTMENT

# SITE MAP MARK TWAIN LIBRARY

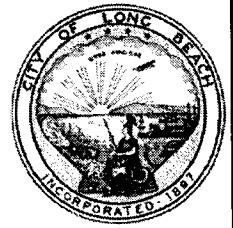

EXHIBIT "A"