



CITY OF LONG BEACH

C-15

DEPARTMENT OF PUBLIC WORKS

333 WEST OCEAN BOULEVARD • LONG BEACH, CA 90802 • (562) 570-6383 • FAX (562) 570-6012

April 21, 2009

HONORABLE MAYOR AND CITY COUNCIL
City of Long Beach
California

RECOMMENDATION:

Authorize the City Manager to execute a Public Walkways Occupancy Permit for sidewalk dining at Pasta Al Dente located at 5856 Naples Plaza. (District 3)

DISCUSSION

Jack A. Russo, the operator of Pasta Al Dente located at 5856 Naples Plaza, requests a permit to temporarily occupy part of the adjoining sidewalk for the purpose of sidewalk dining. This restaurant previously had a permit, but is applying for a new one because the permittee would like to occupy additional public right-of-way space. The proposed permit area and a list of furnishings and accessories to be placed in the permit area are shown on the attached Exhibit A. Approval of this permit is based on the conditions and standards of Chapter 14.14 of the Long Beach Municipal Code, which describes temporary uses of public right-of-way. The width of the sidewalk is 14 feet. A minimum clearance of 5 feet will be maintained between the permit area and sidewalk obstructions.

This permit request was reviewed and approved by the Long Beach Fire Department on December 12, 2008, and the subject permit was prepared by Deputy City Attorney Linda Trang on February 26, 2009.

This matter was reviewed by Deputy City Attorney Linda Trang on February 26, 2009, and by Budget and Performance Management Bureau Manager David Wodynski on April 2, 2009

TIMING CONSIDERATIONS

City Council action on this matter is not time critical.

**DIRECTOR'S OFFICE
BUDGET & PERSONNEL**
333 W. Ocean Blvd., 9th Floor
Long Beach, CA 90802
Ph. (562) 570-6383
Fax (562) 570-6012

ENGINEERING
333 W. Ocean Blvd., 9th Floor
Long Beach, CA 90802
Ph. (562) 570-6634
Fax (562) 570-6012

**ENVIRONMENTAL
SERVICES**
2929 E. Willow Street
Long Beach, CA 90806
Ph. (562) 570-2850
Fax (562) 570-2861

FLEET SERVICES
2600 Temple Avenue
Long Beach, CA 90806
Ph. (562) 570-5400
Fax (562) 570-5414

PUBLIC SERVICE
1601 San Francisco Avenue
Long Beach, CA 90813
Ph. (562) 570-2782
Fax (562) 570-2729

HONORABLE MAYOR AND CITY COUNCIL

April 21, 2009

Page 2

FISCAL IMPACT

A security deposit of \$750 and a permit-processing fee of \$795 were deposited into the General Fund (GP) in the Department of Public Works (PW).

SUGGESTED ACTION:

Approve recommendation.

Respectfully submitted,

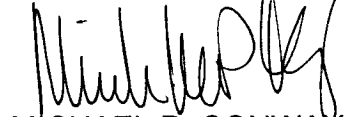

MICHAEL P. CONWAY
DIRECTOR OF PUBLIC WORKS

APPROVED:



PATRICK H. WEST
CITY MANAGER

MPC:MAC:GMM:SDJ
PICLIROW Pasta Al Dente.doc

Attachment

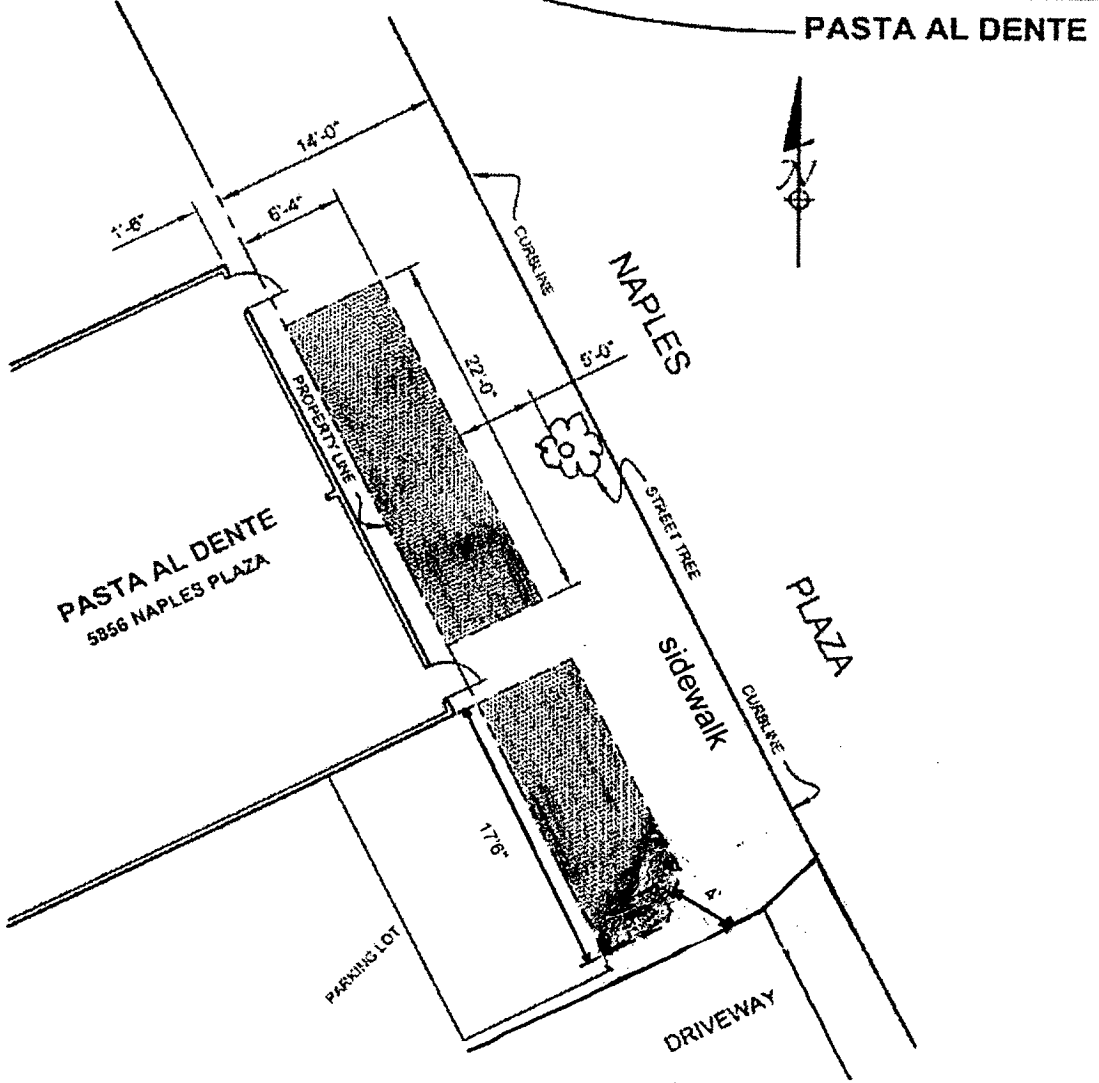
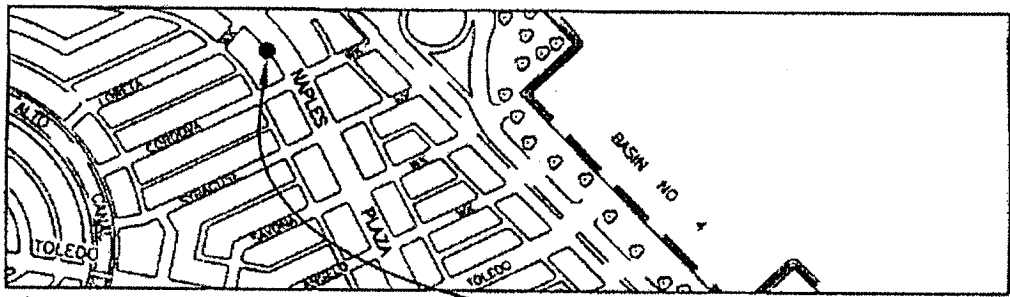

 SHOWS AREA OF PERMIT

237 square feet

CITY OF LONG BEACH - CALIFORNIA
 DEPARTMENT OF PUBLIC WORKS, ENGINEERING BUREAU

**PUBLIC WALKWAYS OCCUPANCY
 PERMIT
 PASTA AL DENTE RISTORANTE
 5856 NAPLES PLAZA**

List of Approved Furnishings and Accessories
(Attachment to Public Walkways Occupancy Permit for Sidewalk Dining Purposes)

Restaurant: PASTA AL DENTE Permittee: JACK A RUSSO

Address: 5856 NAPLES PLAZA Telephone: 562 433-1616

Tables number: 7

Chairs number: 75

Umbrella(s) height & number: _____

Heater(s) height & number: _____

Menu board
note: maximum height of 5 ft 6 in, maximum width of 2 ft & none permitted in the coastal zone

Waiter station size: _____

Planters for trees or other greenscaping describe: _____

Other: _____

We intend to make occasional use of the permit area for live or recorded entertainment (Note: A separate entertainment permit is required).

- The following are prohibited:**
- canopies (ground supported)
 - television monitors

Permittee signature: Jack A Russo

Date: 1/14/09

Print name here: JACK A RUSSO

This list of furnishings and accessories is effective only when attached to a completed Public Walkways Occupancy Permit.