



# CITY OF LONG BEACH

## POLICE DEPARTMENT

# R-20

400 WEST BROADWAY • LONG BEACH • CALIFORNIA 90802 • (562) 570-7260 • FAX (562) 570-7114

Jim McDonnell  
Chief of Police

January 17, 2012

HONORABLE MAYOR AND CITY COUNCIL  
City of Long Beach  
California

### RECOMMENDATION:

Receive and file the application of Austin Plong Physician Assistant Incorporated, dba Dragon Express, for an original Alcoholic Beverage Control license, at 1001 East Pacific Coast Highway, Suite 129. (District 6)

### DISCUSSION

It is City Council policy to review applications for Alcoholic Beverage Control licenses to determine if a basis for protest against the issuance of the license exists. The attached application lists the possible bases for protest.

### TIMING CONSIDERATIONS

City Council response is due to the Department of Alcoholic Beverage Control by January 18, 2012. Accordingly, City Council action is required at the January 17, 2012 City Council meeting.

### FISCAL IMPACT

None.

### SUGGESTED ACTION:

Approve recommendation.

Respectfully submitted

  
JIM McDONNELL  
CHIEF OF POLICE

JM:CNA:cna

APPROVED:

  
PATRICK H. WEST  
CITY MANAGER

ADMINISTRATION BUREAU  
(562) 570-5830  
FAX (562) 570-5833

INVESTIGATIONS BUREAU  
(562) 570-7350  
FAX (562) 570-7175

PATROL BUREAU  
(562) 570-7214  
FAX (562) 570-7058

SUPPORT BUREAU  
(562) 570-7342  
FAX (562) 570-6018

HONORABLE MAYOR AND CITY COUNCIL  
January 17, 2012

Council District: 6

Applicant: Austin Plong Physician Assistant, Incorporated  
DBA: Dragon Express  
Address: 1001 East Pacific Coast Highway, Suite 129

Type of Application: An original application for an On-Sale Beer and Wine for bonafide eating place license.

Bases for possible protest: High crime.  
Residence within 100 feet.  
School within 600 feet.  
Church within immediate vicinity.

**PUBLIC CONVENIENCE DETERMINATION:** A determination by the City of public convenience and necessity **is not** required for this application.

Census Tract: 5733.00

Boundaries: City Limits to the North  
Pacific Coast Highway to the South  
Cherry Avenue to the East  
Martin Luther King to the West

Number of licenses allowed: 4  
Number of licenses existing: 2

Police Reporting District: 313

Boundaries: 20th Street to the North  
Pacific Coast Highway to the South  
Orange Avenue to the East  
Martin Luther King to the West

Reported crimes in this district for ABC purposes are 346. Crime in a reporting district must be at least 177 to qualify for a high crime protest.

Type of business: A restaurant.

Last day to request

Conditions and protest: January 17, 2012

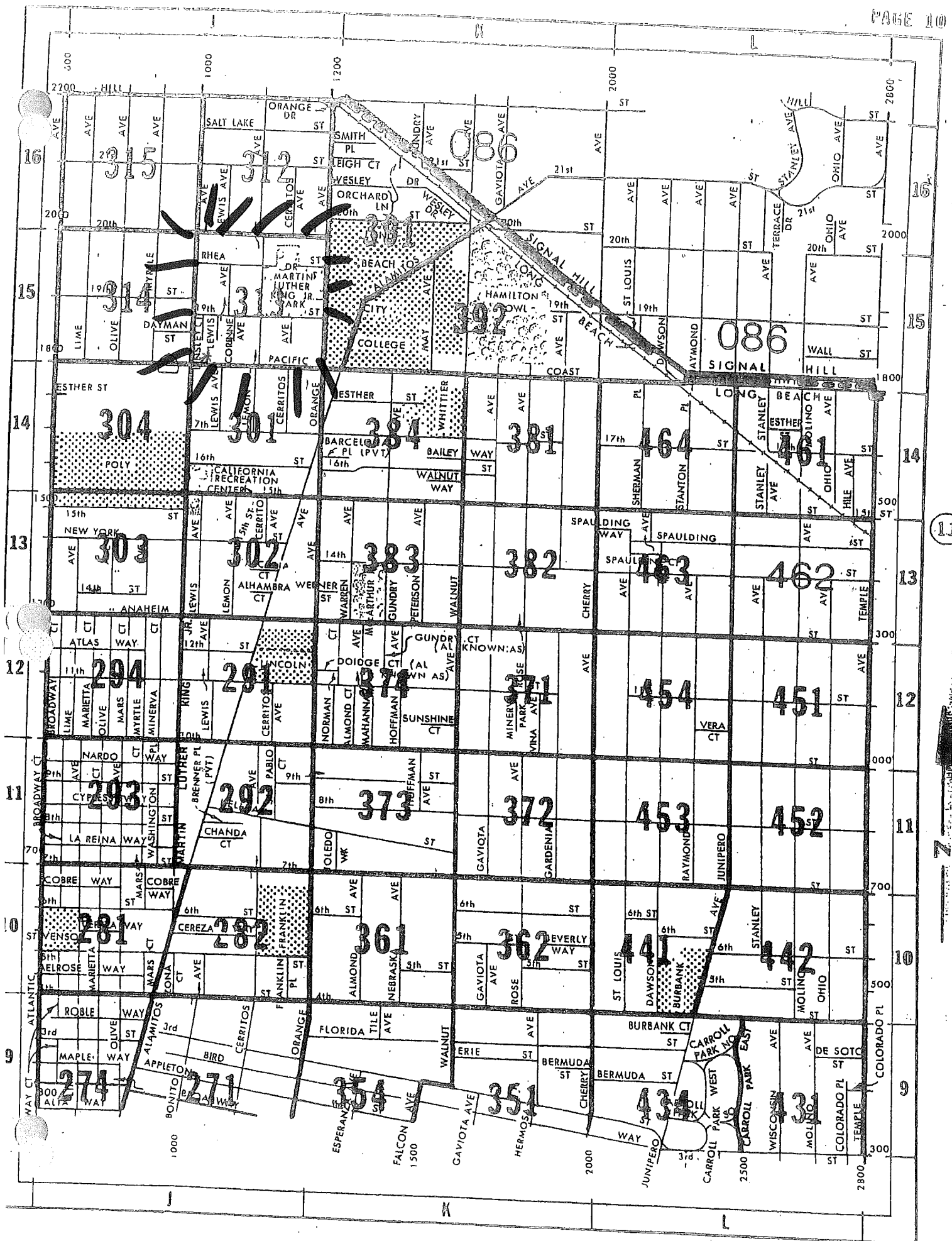

(11)

7

(A)



**Date:** January 17, 2012  
**To:** File  
**From:** Chris Anderson, Detective, Vice Investigations Section  
**Subject:** DRAGON EXPRESS, 1001 EAST PACIFIC COAST HIGHWAY, SUITE 129

---

**CALLS FOR SERVICE/ARRESTS AND INVESTIGATIONS (12/19/10-12/19/11)**

None

**ABC INSPECTIONS (past three years)**

None

**RESIDENCE WITHIN 100 FEET**

1846 Linsley Court	1850 Lewis
1847 Linsley Court	1855 Lewis
1848 Linsley Court	1860 Lewis
1849 Linsley Court	1865 Lewis
1850 Linsley Court	1870 Lewis
1851 Linsley Court	1875 Lewis
1852 Linsley Court	

**CHURCHES, SCHOOLS, PARKS, HOSPITALS AND PLAYGROUNDS WITHIN 600 FEET**

Grace Memorial Baptist Church – 1021 E. 19<sup>th</sup> Street  
Poly High School – 1600 Atlantic Avenue

CNA:cna  
cfs.memo