



# CITY OF LONG BEACH

DEPARTMENT OF PUBLIC WORKS

# C-10

333 WEST OCEAN BOULEVARD • LONG BEACH, CA 90802 • (562) 570-6383 • FAX (562) 570-6012

December 18, 2018

HONORABLE MAYOR AND CITY COUNCIL  
City of Long Beach  
California

## RECOMMENDATION:

Authorize the City Manager, or designee, to grant an easement deed to Southern California Edison Company, to provide electrical service for the development at 495 The Promenade North. (District 1)

## DISCUSSION

Southern California Edison Company (SCE) has requested to be granted an easement to install electrical distribution facilities within the City-owned parking lot adjacent to 495 The Promenade North, shown on Attachment A. To furnish electrical service to the proposed four-story mixed-use development and other facilities in the area, an easement is necessary to allow for the relocation of the existing electrical conduit from the proposed building's footprint to be installed within the adjacent City-owned parking lot.

City staff conducted a review of affected agencies and there were no objections to the proposed easement.

This matter was reviewed by Deputy City Attorney Linda T. Vu on November 19, 2018 and by Budget Analysis Officer Julissa José-Murray on November 29, 2018.

## TIMING CONSIDERATIONS

City Council action is requested on December 18, 2018, to allow the developer to begin construction in a timely manner.

## FISCAL IMPACT

A grant of easement processing fee of \$3,195 was deposited in the General Fund (GF) in the Public Works Department (PW). There is no local job impact associated with this recommendation.

SUGGESTED ACTION:

Approve recommendation.

Respectfully submitted,

Handwritten signature of Craig A. Beck in black ink.

CRAIG A. BECK,  
DIRECTOR OF PUBLIC WORKS

APPROVED:

Handwritten signature of Patrick H. West in black ink, written over a horizontal line.

PATRICK H. WEST  
CITY MANAGER

CB:AP:El:JH:bp:JC

ATTACHMENT: EASEMENT LOCATION SKETCH

SKETCH NO. 209 EG

SKETCH SHOWING PORTIONS OF LOT 11, TRACT NO. 53306, GRANT OF EASEMENT DEEDED TO SOUTHERN CALIFORNIA EDISON BY THE CITY OF LONG BEACH FOR ELECTRICAL DISTRIBUTION PURPOSES.

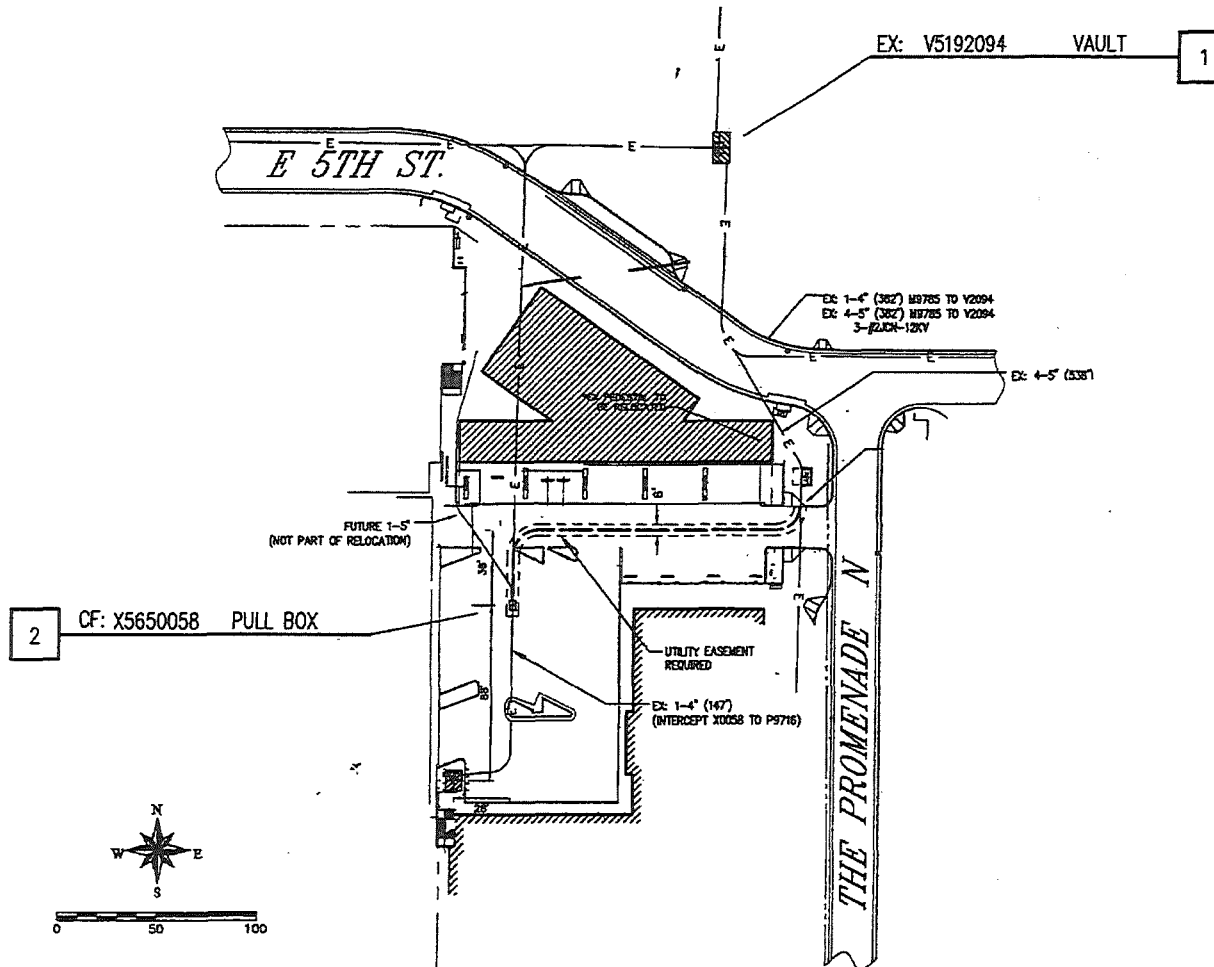

ENGINEERING BUREAU  
CITY OF LONG BEACH, CALIFORNIA  
ATTACHMENT A