



OFFICE OF THE CITY ATTORNEY  
CHARLES PARKIN, City Attorney  
333 West Ocean Boulevard, 11th Floor  
Lona Beach, CA 90802-4664

1 84.3 Conditions. To the extent applicable, any and all terms and conditions  
2 relating to the Street Lighting System in Lighting Contract No. 24289, including all exhibits,  
3 shall apply to removing existing street lights and adding decorative post top street lights on  
4 Paloma Avenue."

5 2. Except as expressly amended herein, all of the terms and conditions  
6 contained in Lighting Contract No. 24289, as previously amended, are ratified and  
7 confirmed and shall remain in full force and effect.

8 IN WITNESS WHEREOF, the parties have caused this document to be duly  
9 executed with all formalities required by law as of the date first stated above.

10 WS LIGHT & POWER, INC., a California  
11 corporation  
12 January 9th, 2019 By [Signature]  
13 Name Thomas P. Simmons  
14 Title President

15 January 9th, 2019 By [Signature]  
16 Name William J. Simmons  
17 Title President

18 **Tom Modica**  
19 **Assistant City Manager "WS"**

20 EXECUTED PURSUANT  
21 TO SECTION 301 OF  
22 THE CITY CHARTER

23 CITY OF LONG BEACH, a municipal  
24 corporation  
25 By [Signature]  
26 **City Manager**

27 1/29, 2019

28 "City"

29 This Fifty-Fourth Amendment to Lighting Contract No. 24289 is approved as  
30 to form on 1/16, 2019.

31 CHARLES PARKIN, City Attorney  
32 By [Signature]  
33 **Deputy**

# EXHIBIT “FFF”



City Light & Power, Inc.  
6312 S. Fiddlers Green Cir.  
Suite 200E  
Greenwood Village, CO 80111  
Tel 720 305 0400

November 15, 2018

Bluff Park Neighborhood Association (BPNA)

**RE: Bluff Park Historic Lamppost Project – Paloma Ave. Phase 1 (with Post Top Kits)**

To Whom It May Concern,

City Light & Power, Inc. (CLP) is pleased to submit a proposal to remove existing street lights and add decorative post top street lights on Paloma Ave. A detailed description is listed below.

CLP will install a total of 10 new, customer-provided decorative post top (PT) poles and LED post top kits in customer-provided globes on Paloma Ave. between Ocean Blvd. and 2<sup>nd</sup> Street. There are currently eight (8) existing, concrete street lights in these two blocks. Four (4) of the street lights will not be replaced and the other four (4) will be replaced with new PT poles in the same location as some of the street lights that were removed. CLP will install new concrete bases for these four (4) as the bolt patterns of the new poles will not match the existing bolt patterns. The other six (6) new PT poles will be installed in areas designated on the drawing (enclosed) and will also require new bases and conduit. CLP will utilize the existing wire for the new street lights that are installed in the existing locations and will pull in new wire for the new locations. Additional pull boxes will be installed for conduit crossings, new PT poles and to cover the removed street light bases.

Once the lights are installed, CLP will energize the circuit(s) to ensure all the lights are operating properly.

Pricing for this project is **Sixty-Two Thousand One Hundred Twenty-Five Dollars (\$62,125)**.

Notes:

1. Customer to provide new pole, fixture and anchor bolts.
2. City of Long Beach Public Works will need to approve the removal of existing street lights and the addition of the new, decorative street lights.
3. City of Long Beach Public Works will need to approve the street light pole, fixture, wattage specification as well as the location of the new street lights.
4. Pricing based on Job Walk conducted on 9/7/18 and the enclosed drawing.

If you have any questions, please call me at (720) 305-0399.

Sincerely,  
CITY LIGHT & POWER, INC.

A handwritten signature in black ink, appearing to read "Brad M. Weber".

Brad M. Weber  
Chief Estimator



CITY LIGHT & POWER

Long Beach, CA

Bluff Park Neighborhood Association

- BPMA Project Section
- LIGHT SYMBOLS
  - CLP Proposed FT (02/2019)
  - CLP Existing Cables/Hand
  - CLP Existing Post Top
  - CLP Light outside BPMA

- FEEDPOINTS
  - CLP Feedpoint

- CONDUITS
  - CLP Pullbox
  - CLP Pullbox - Proposed
  - CLP Cable
  - CLP Cable - Proposed
  - CLP Conduit - Proposed
  - Conduit Location Unclassified
  - Conduit Unmarked or Removed

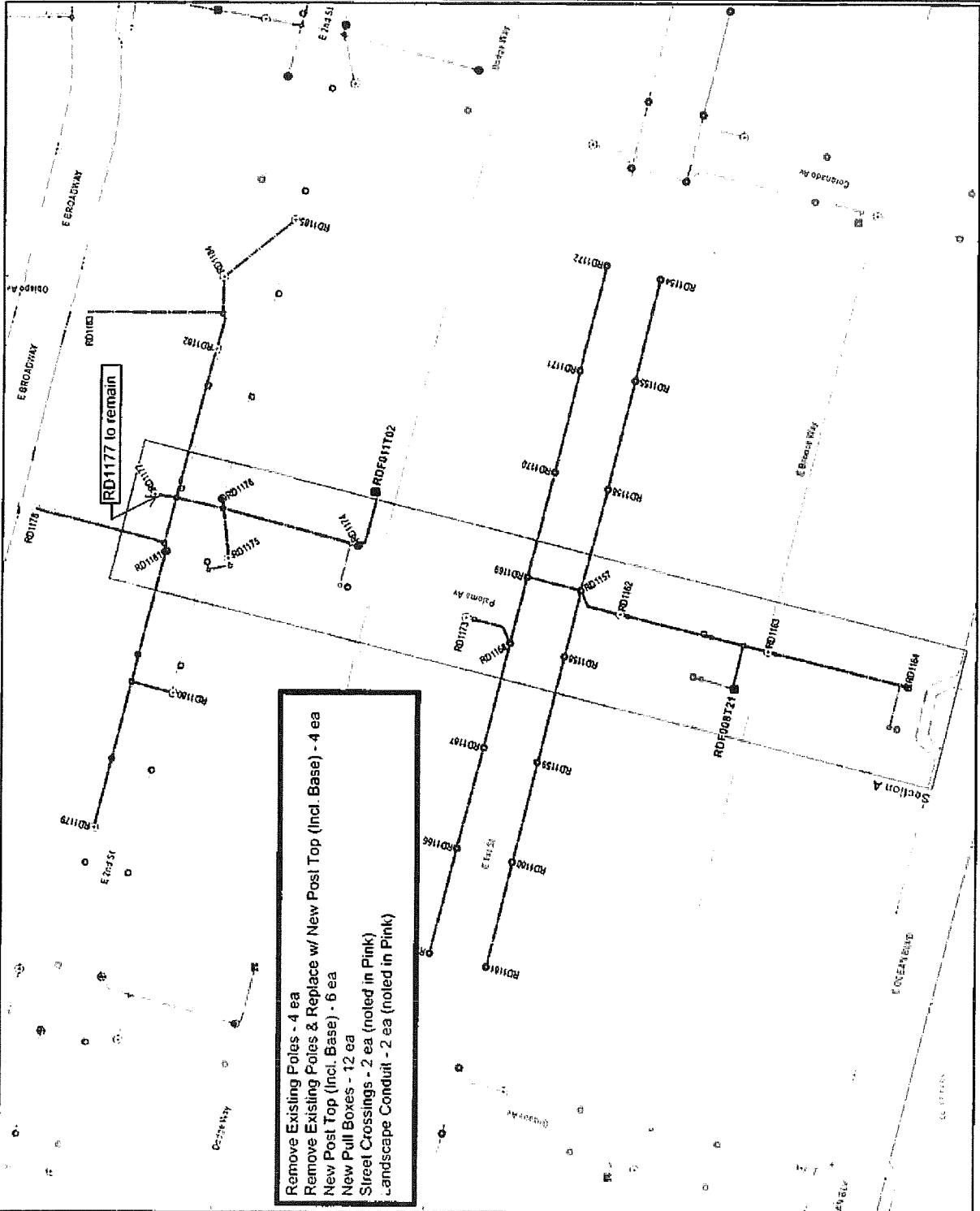
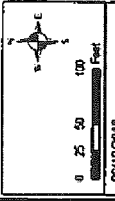

Remove Existing Poles - 4 ea  
 Remove Existing Poles & Replace w/ New Post Top (Incl. Base) - 4 ea  
 New Post Top (Incl. Base) - 6 ea  
 New Pull Boxes - 12 ea  
 Street Crossings - 2 ea (noted in Pink)  
 Landscape Conduit - 2 ea (noted in Pink)