



# CITY OF LONG BEACH C-13

DEPARTMENT OF PUBLIC WORKS

333 West Ocean Boulevard 9<sup>th</sup> Floor • Long Beach, CA 90802 • (562) 570-6383 • Fax (562) 570-6012

January 12, 2010

HONORABLE MAYOR AND CITY COUNCIL  
City of Long Beach  
California

## RECOMMENDATION:

Authorize the City Manager or designee to accept a permanent grant of easement and a temporary easement agreement for storm drain purposes at 5950 Long Beach Boulevard. (District 9)

## DISCUSSION

The City of Long Beach is preparing to improve Pump Station No. 11 at 114 Gordon Street with a storm drain pollution trap, or vortex separation system (VSS), approved by City Council on December 15, 2009 and funded through American Recovery and Reinvestment Act (ARRA) grants. This pump station is sited within a motel property known as the Luxury Inn and addressed as 5950 Long Beach Boulevard. The City of Long Beach holds an existing easement for the pump station, appurtenant structures and access thereto, but requires additional permanent easement area in order to accommodate the VSS, as shown in Exhibit A. A larger, temporary easement area is needed within which to carry out project construction, shown in Exhibit B. The additional easement areas are both currently utilized as the motel parking lot.

H.B., LLC, the owner of the Luxury Inn, has agreed to grant both the permanent and temporary easements as this project will benefit the motel property by reducing the amount of trash entering the storm drain reservoir and associated odors. Following the excavation and installation of the VSS, the motel parking lot will be resurfaced, as provided for in the temporary easement conditions and covered under the ARRA grant. The additional permanent easement area is already burdened by an access easement (to the storm drain), and no other compensation for the easements is to be provided by the City.

In conformance with the California Environmental Quality Act, Categorical Exemption No. CE-593-06 was issued for this project.

This matter was reviewed by Deputy City Attorney Linda Trang on December 8, 2009 and Budget and Performance Management Bureau Manager David Wodynski on December 23, 2009.

TIMING CONSIDERATIONS

City Council action on this matter should be taken on January 12, 2010, in order that the storm drain improvement may proceed on schedule.

FISCAL IMPACT

There is no fiscal impact associated with the requested easement agreement. All pump station and resurfacing costs will be covered by existing ARRA grants.

SUGGESTED ACTION:

Approve recommendation.

Respectfully submitted,

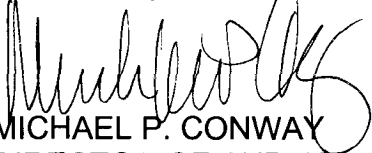

MICHAEL P. CONWAY  
DIRECTOR OF PUBLIC WORKS

APPROVED:

  
PATRICK H. WEST  
CITY MANAGER

MPC:MAC:GMM:SC:db  
P:ROW Long Beach Blvd 5950 SD11.doc

Exhibit A – Permanent Easement Area  
Exhibit B -- Temporary Easement Area

**EXHIBIT A**  
**Page 1 of 2**

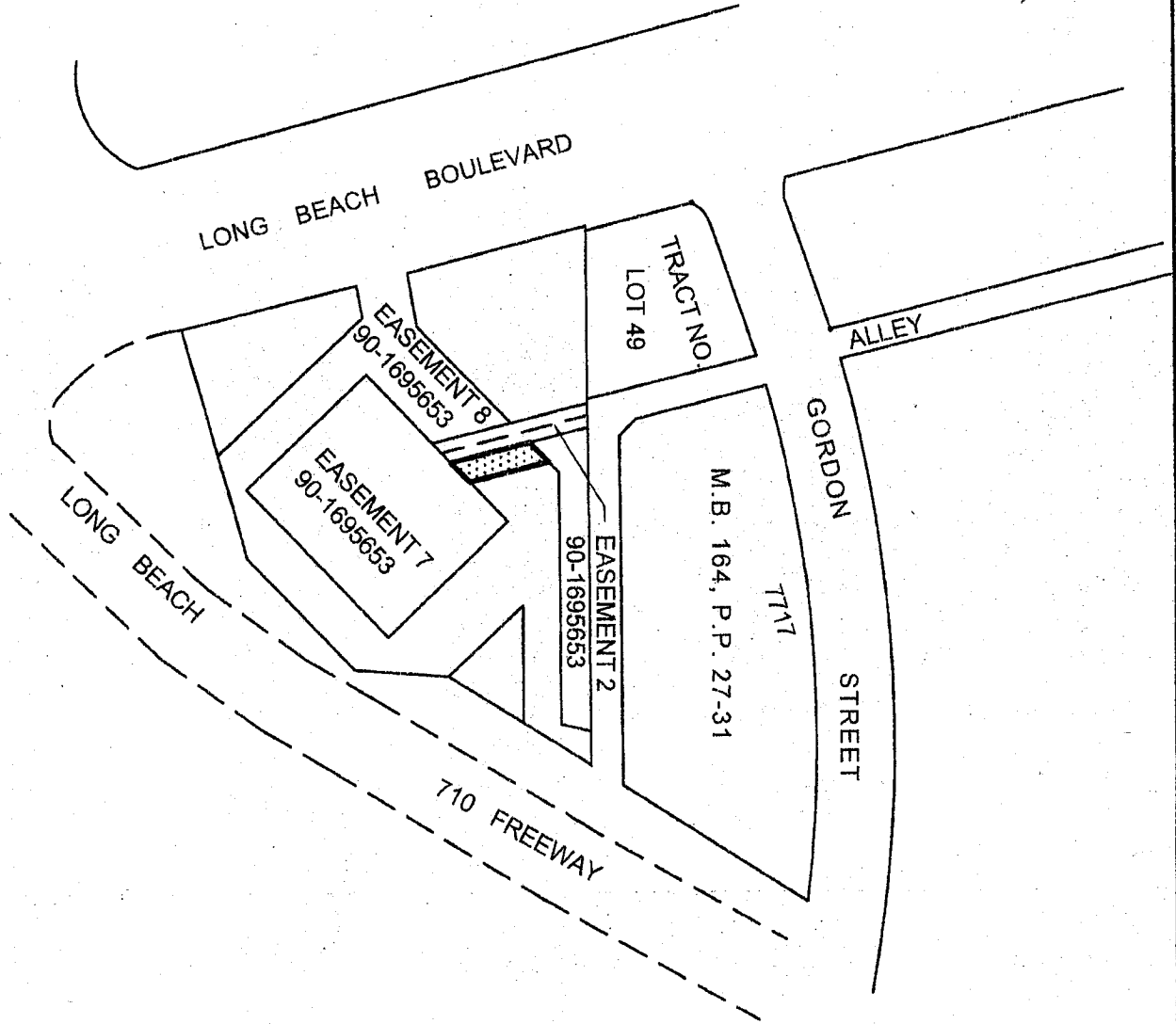

SCALE: NOT TO SCALE  
SHEET 1 OF 2



STORM DRAIN MAINTENANCE EASEMENT

STORM DRAIN MAINTENANCE EASEMENT  
VORTEX SEPARATION SYSTEM  
AT PUMP STATION SD11  
ENGINEERING BUREAU  
CITY OF LONG BEACH, CALIFORNIA

**EXHIBIT A**  
**Page 2 of 2**

COURSE	BEARING	LENGTH
1	S 89° 40' 40" E	118.22'
2	S 14° 05' 09" E	95.52'
3	N 46° 23' 00" E	8.62'
4	N 46° 23' 00" E	17.24'
5	N 14° 05' 09" W	51.72'
6	S 46° 23' 00" W	17.24'
7	S 14° 05' 09" E	51.72'
8	S 14° 05' 09" E	121.00'

LONG BEACH BOULEVARD

P.O.B.  
SW CORNER OF  
LOT 49 OF  
TRACT NO. 7717

LOT 49 TRACT NO. 7717  
M.B. 164, P.P. 27-31

 SHOWS STORM DRAIN  
MAINTENANCE EASEMENT  
P.O.B. - POINT OF BEGINNING  
T.P.O.B. - TRUE POINT OF BEGINNING

EASEMENT 8  
90 -1695653  
(EMERGENCY ACCESS)

EASEMENT 2  
90 -1695653  
(STORM DRAIN EASEMENT)

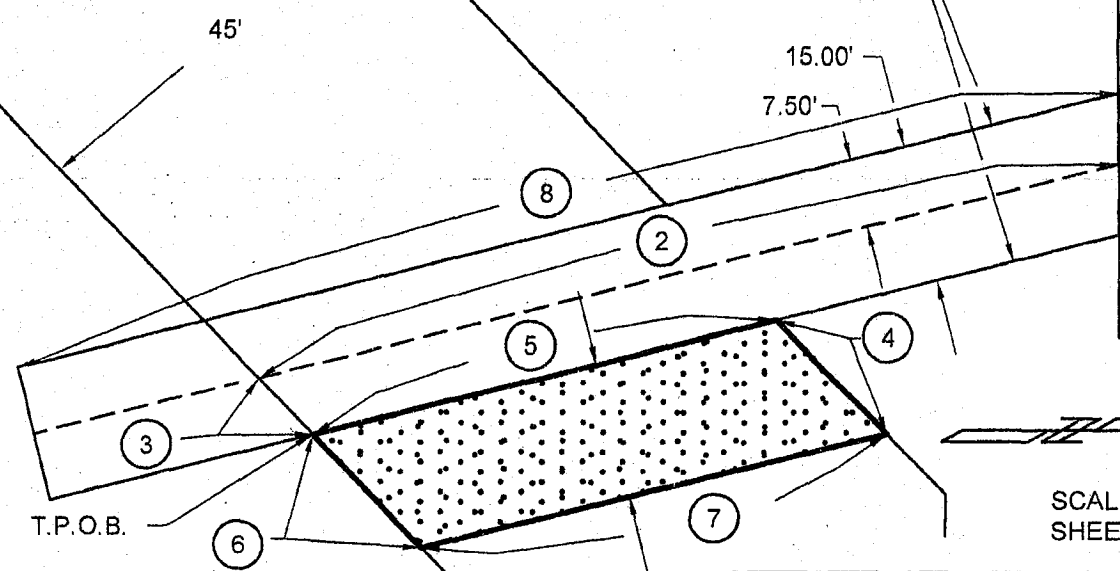

EASEMENT 7  
90 -1695653  
(STORM DRAIN CATCH  
BASIN EASEMENT)

SCALE 1" = 20'  
SHEET 2 OF 2

STORM DRAIN MAINTENANCE EASEMENT  
VORTEX SEPARATION SYSTEM  
AT PUMP STATION SD11  
ENGINEERING BUREAU  
CITY OF LONG BEACH, CALIFORNIA

**EXHIBIT B**

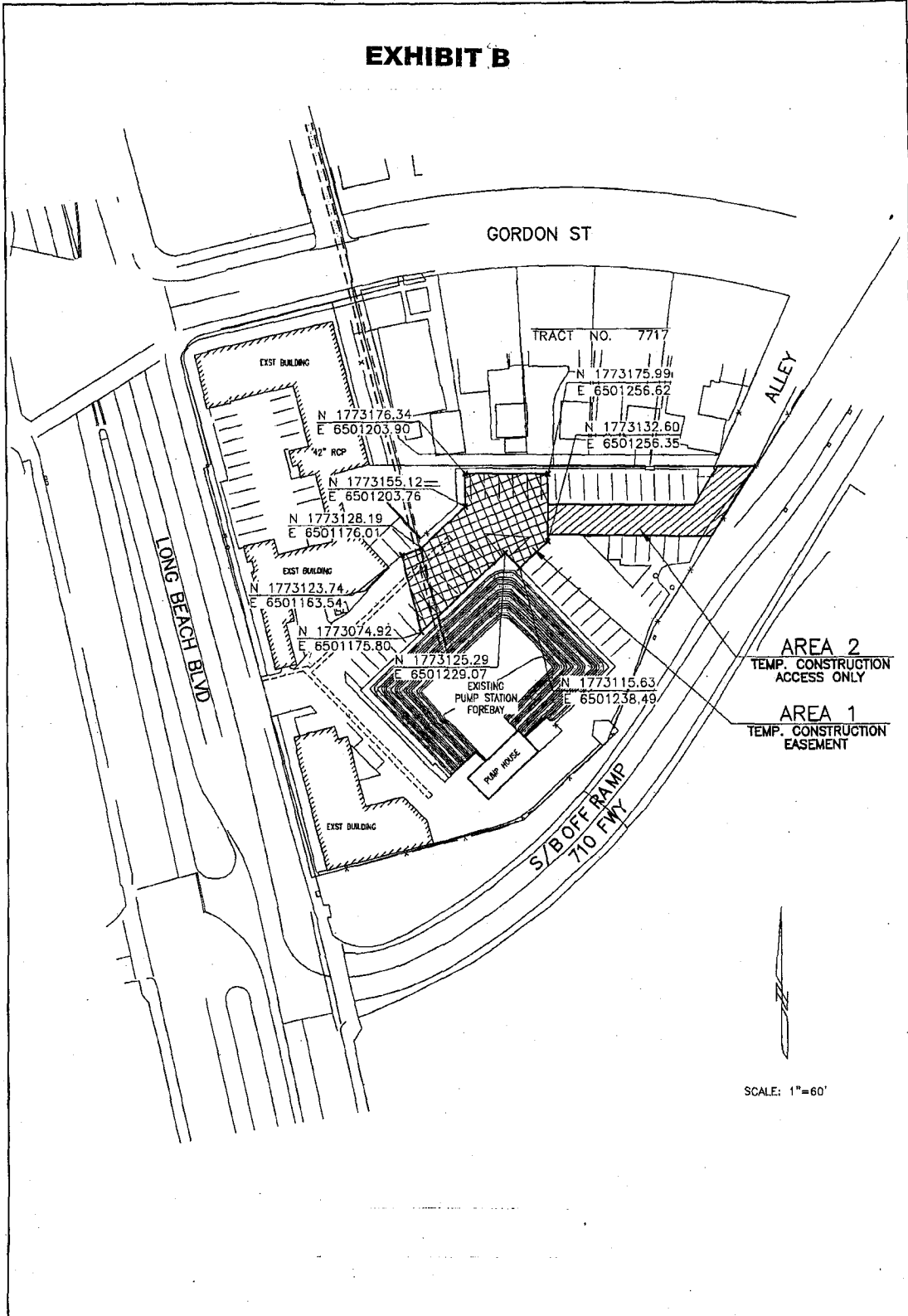

**VORTEX SEPARATION SYSTEM  
AT PUMP STATION SD11  
TEMPORARY EASEMENT**