

OFFICE OF THE CITY ATTORNEY
ROBERT E. SHANNON, City Attorney
333 West Ocean Boulevard, 11th Floor
Long Beach, CA 90802-4664

1
2
3
4
5
6
7
8
9
10
11
12
13
14
15
16
17
18
19
20
21
22
23
24
25
26
27
28

RESOLUTION NO. RES-09-0151

A RESOLUTION ORDERING THE VACATION OF A PORTION OF THE ALLEY WEST OF LONG BEACH BOULEVARD AND SOUTH OF ANAHEIM STREET IN THE CITY OF LONG BEACH, COUNTY OF LOS ANGELES, STATE OF CALIFORNIA

WHEREAS, the City Council of the City of Long Beach, did heretofore, on the 3rd of November, 2009, by Resolution No. RES-09-0130, declare its intention to order the vacation, pursuant to the provisions of the Public Streets, Highways, and Service Easements Law, a portion of the alley west of Long Beach Boulevard and south of Anaheim Street, in the City of Long Beach, County of Los Angeles, State of California, described more particularly as follows:

Parcel 1:

That portion of the Alley (20 feet wide), also known as Regal Way, abutting Lots 13, 14, 15, 16, and a portion of Lots 11, 12, 17 and the Reservoir Lot, as shown in Block B, Stanwood and Nash's Subdivision of Farm Lot 182 in the American Colony Tract, in the City of Long Beach, County of Los Angeles, State of California as per map recorded in Book 36, Page 76 of Miscellaneous Records, in the Office of the County Recorder of said County, more particularly described as follows:

Bounded on the West by the North prolongation of the East line of the West 25 feet of Lot 11 of said Tract and bounded on the East by the West line of the East 22 feet of said Alley

1
2
3
4
5
6
7
8
9
10
11
12
13
14
15
16
17
18
19
20
21
22
23
24
25
26
27
28

and said Block B.

Parcel 2:

That portion of the Alley (20 feet wide), also known as Regal Way, abutting a portion of Lots 11 and 12 as shown in Block B, Stanwood and Nash's Subdivision of Farm Lot 182 in the American Colony Tract, in the City of Long Beach, County of Los Angeles, State of California as per map recorded in Book 36, Page 76 of Miscellaneous Records, in the Office of the County Recorder of said County, more particularly described as follows:

Bounded on the West by the Northerly prolongation of the West line of said Lot 11 and bounded on the East by the Northerly prolongation of the East Line of the West 25 feet of said Lot 11, said land lying below a horizontal plane having an elevation of 36.50 feet (based on CLB BM 567, Elevation 38.029 feet).

Reference City of Long Beach Benchmark No.567, NE Corner of Long Beach Boulevard and Anaheim Street, brass disc flush with pavement, stamped "CLB BM 567, 1990", 20.5' east of curb and 1.1' north of curb. Elev. = 38.029 feet (NGVD29 MSL, CLB 1985 Adj.)

Reserving unto the City of Long Beach, its successors and assigns a perpetual easement and right-of-way, at any time or from time to time, to lay, construct, maintain, operate,

1 repair, renew, replace, change the size of and remove the
2 existing utility lines, including, but not limited to, sanitary
3 sewers, storm drains and appurtenant structures, together
4 with all necessary gates, valves, fittings, hydrants and
5 appurtenances for the transportation of water and gas, with
6 the right of ingress to and egress from the same, over,
7 through, under, along and across that certain property
8 vacated herewith; and pursuant to any existing franchises or
9 renewals thereof, or otherwise, to construct, maintain,
10 operate, replace, remove, renew and enlarge lines of
11 conduits, cables, wires, poles and other convenient
12 structures, equipment and fixtures for the operation of
13 telephone lines and other communication lines, and for the
14 transportation or distribution of electric energy, and
15 incidental purposes including access and the right to keep
16 the property free from inflammable materials, and wood
17 growth, and otherwise protect the same from all hazards in,
18 upon and over the part vacated. Access for maintenance of
19 the above-mentioned facilities must be maintained at all
20 times. No improvements shall be constructed within the
21 easement which would impede the operation, maintenance
22 or repair of said facilities. Construction of any improvements,
23 including changes of grade, shall be subject to the prior
24 written approval of all the City departments and public
25 utilities responsible for the above said facilities.

26
27 WHEREAS, the City Council did, at said time, fix Tuesday, the 1st
28 day of December, 2009, at the hour of 5:00 p.m., as the time and the

1 City Council Chamber, Plaza Level of the City Hall, 333 West Ocean Boulevard, in the
2 City of Long Beach, California, as the place for hearing for all persons interested in or
3 objecting to the proposed vacation to appear and be heard; and

4 WHEREAS, notice of the resolution of the intention to vacate, stating the
5 time and place of said hearing, was duly posted in the manner prescribed by law; and

6 WHEREAS, said hearing was called and held before the City Council at the
7 time and place so fixed and evidence taken and received on the matter of said proposed
8 vacation, and the City Council, upon said evidence, now makes those findings of fact set
9 forth in said Exhibit "B", attached hereto and by this reference made a part hereof;

10 NOW, THEREFORE, the City Council of the City of Long Beach resolves as
11 follows:

12 Section 1. Pursuant to the foregoing resolution of intention, the
13 proceedings had thereunder, Vacation Sketch No. 989V showing a portion of the alley
14 west of Long Beach Boulevard and south of Anaheim Street to be vacated by the City of
15 Long Beach attached hereto as Exhibit "A", and the City Council Findings attached hereto
16 as Exhibit "B", said City Council of the City of Long Beach hereby makes its resolution
17 vacating and closing a portion of the street hereinabove described.

18 Section 2. That this resolution shall take effect immediately upon its
19 adoption by the City Council, and the City Clerk is hereby instructed to certify to the
20 adoption thereof, and to cause a certified copy to be recorded in the Office of the County
21 Recorder of the County of Los Angeles, California.

22 ///

23 ///

24 ///

25 ///

26 ///

27 ///

28 ///

1
2
3
4
5
6
7
8
9
10
11
12
13
14
15
16
17
18
19
20
21
22
23
24
25
26
27
28

I hereby certify that the foregoing resolution was adopted by the City Council of the City of Long Beach at its meeting of December 1, 2009 by the following vote:

Ayes: Councilmembers: Garcia, Lowenthal, DeLong,
O'Donnell, Schipske, Andrews,
Reyes Uranga, Gabelich, Lerch.

Noes: Councilmembers: None.

Absent: Councilmembers: None.

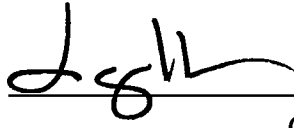



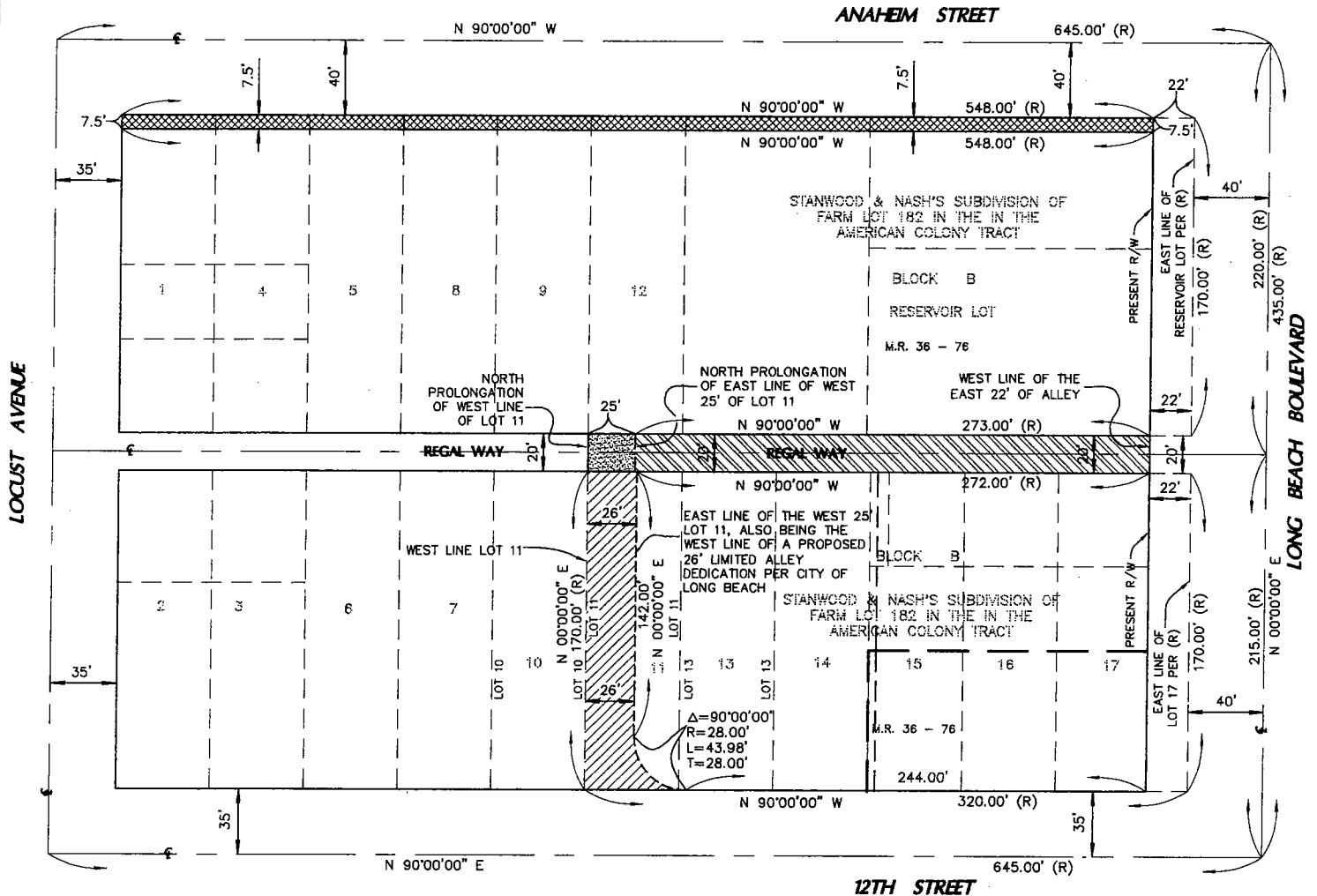

City Clerk

OFFICE OF THE CITY ATTORNEY
ROBERT E. SHANNON, City Attorney
333 West Ocean Boulevard, 11th Floor
Long Beach, CA 90802-4664

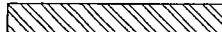
CITY OF LONG BEACH, CALIFORNIA
LONG BEACH & ANAHEIM PROJECT

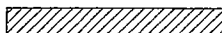

-  REGAL WAY VACATION
-  LIMITED DEDICATION AREA BELOW ELEVATION 53.00'
-  LIMITED DEDICATION AREA ABOVE ELEVATION 36.50'
-  LIMITED VACATION AREA BELOW ELEVATION 36.50'

LEGEND:
R = BLOCK B, STANWOOD & NASH SUBDIVISION M.R. BK. 36 PG. 76



NOT TO SCALE



707 WILSHIRE BOULEVARD, 40TH FLOOR,
LOS ANGELES, CA 90017
213 624 2661 TEL
213 614 1863 FAX

CIVIL ENGINEERING
SURVEYING+MAPPING
LAND DEVELOPMENT

VICINITY MAP FOR STREET VACATION AND DEDICATION
BLOCK B, STANWOOD AND NASH SUBDIVISION
LONG BEACH, CA

CITY OF LONG BEACH, CALIFORNIA





LONG BEACH & ANAHEIM PROJECT

AIRSPACE EXHIBIT

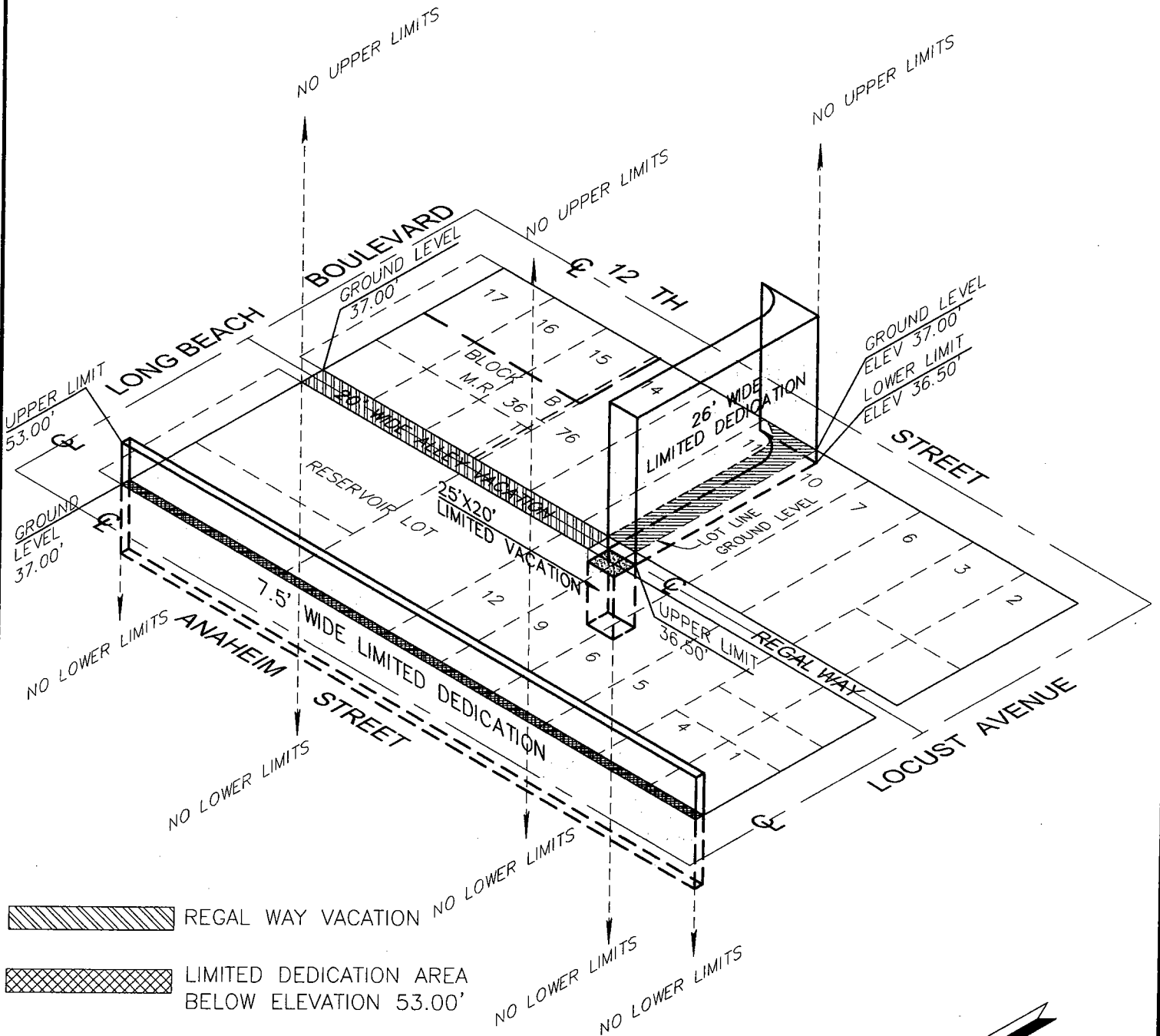
EXHIBIT A

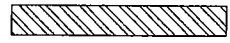
Page 2 of 2



-  REGAL WAY VACATION
-  LIMITED DEDICATION AREA BELOW ELEVATION 53.00'
-  LIMITED DEDICATION AREA ABOVE ELEVATION 36.50'
-  LIMITED VACATION AREA BELOW ELEVATION 36.50'

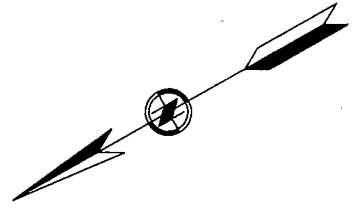

NOT TO SCALE



707 WILSHIRE BOULEVARD, 40TH FLOOR,
LOS ANGELES, CA 90017
213 624 2661 TEL
213 614 1863 FAX

CIVIL ENGINEERING
SURVEYING+MAPPING
LAND DEVELOPMENT

**VICINITY MAP FOR STREET VACATION AND DEDICATION
BLOCK B, STANWOOD AND NASH SUBDIVISION
LONG BEACH, CA**

CITY COUNCIL FINDINGS

VACATION OF A PORTION OF THE ALLEY WEST OF LONG BEACH BOULEVARD AND SOUTH OF ANAHEIM STREET Reference Sketch No. 989V

1. The subject right-of-way is unnecessary for present or prospective public use.

This finding is based upon the following:

- a) Those findings listed in the City Council letter dated November 3, 2009, agenda item 16.
 - b) The rights-of-way would not be useful for exclusive bikeway purposes.
2. The vacation of said rights-of-way will not have a significantly adverse environmental effect.

This finding is based upon the following subfindings:

- a) The right-of-way is not and will not be needed for public use.
- c) In conformance with the California Environmental Quality Act, an addendum to the City of Long Beach Central Redevelopment Environmental Impact Report was prepared for this project.