

We Create Community



Parks, Recreation & Marine Staff Handle COVID-19 Challenges



Recreation staff assigned to the Food Unit for the Incident Management and Emergency Operations Centers coordinate 2,000 meals at nine sites, four times each day for COVID response personnel including Police, Fire and National Guard.

Parks, Recreation and Marine (PRM) employees have risen to the challenges of helping to ensure safety and stability for residents during the COVID-19 pandemic.

With recreation facilities and programs closed, Community Recreation Services employees have staffed Call Centers, Rapid Assessment Clinics, and Shelters, distributed meals to seniors, and stepped into other support roles as needed.

Maintenance staff modified recreation amenities to keep the public safe, supported

shelter operations and handled facility maintenance. Marine staff are keeping Tidelands areas clean and safe and monitoring the conditions of beaches and waterways.

Animal Care Services has done an incredible job promoting their animal foster program to the community and have greatly reduced the population of cats and dogs in the Long Beach Shelter.

Park Planning and Partnership staff is working with lessees and partners on issues related to closures and gradual reopenings.

Business Operations staff is assisting telecommuting employees, handling finances, and communicating information to residents and staff.

Together PRM is showing the community how to “flatten the curve” so that they will be able to once again safely enjoy parks and beaches and benefit from recreational programs and services.

For more information about the City’s response activities, visit longbeach.gov/health/diseases-and-conditions/information-on/coronavirus.

PRM Modifies Sites and Notifies Public About Staying Safe During COVID-19



and facilities, parking lots and beach areas. Physical distancing signs were also prominently placed to remind visitors to stay at least 6 feet away from others.

For the safety of residents during the COVID-19 pandemic, many PRM facilities, beaches, and park amenities were closed over the past two to three months. To secure these areas, staff fanned out across the city to install locks and closure signs around park equipment



Resourceful Maintenance Operations staff filled the El Dorado Skate Park with mulch to deter skaters from congregating.

PRM Stays Connected to the Community During Pandemic

Community Recreation Services is finding creative, fun ways to stay connected to the community during Covid-19.



Eileen Ludlam, and Sokry Sao from Long Beach Senior Center, and Mr. Hong from WRAP showed seniors the LOVE with a beautiful sign for the front of the building! Eileen also designed

"thinking of you" cards and Elyse Garcia and Terri Eggers mailed them to their seniors.

Angela Paredes is one of our resident artists at WRAP and recently made a new WRAP Garfield Banner with her airbrush paint, complete with face mask!



Kids see these signs and know that staff misses them: Silverado Park sign made by Maria Mujica, Coolidge sign by Araceli Oviedo and staff, and McBride sign made by Lisa Heng and held by Hector Osorio.

PRM staff is reaching out to residents during the pandemic with the Rec It! virtual recreation page with ideas for staying fit, keeping entertained and exploring the world while safely at home. Visit <https://bit.ly/371Nbxs>.



Herrera WRAP staff stole the show at their school's "Trolls" and "Up" car parade! Kids were overjoyed to see their teachers and WRAP staff. Great job Vanessa Leos, Melissa Cabrera, Jenny Chuong, Anna Garcia, Esmeralda Juarez, Alma Meza, and Karla Ocegueda.

Kharla Ibanez, Vanessa Flores, Ben Antonio, Irving Flores, Melissa Castro, Alexis Gonzalez, Johan Rangel and Charrany Thiem created grab-n-go activity packets for Hudson WRAP families. Staff danced/sang their way to cars to deliver packets with educational and recreational activities.



PRM's WRAP staff are remotely engaging kids via Zoom or Google Meets. King WRAP Sharp

Thurman led a Mother's Day craft, and Natalie Kvale and Quisheene Starks from Lafayette WRAP did a meet and greet, leading a child to cry "FINALLY!" when he saw his WRAP buddies and staff.

Don't be bored at home...

Rec It!

The staff at Long Beach Parks, Recreation and Marine misses everyone and continues to feel passionate about our programs and services. While you can't come in person at this time to participate, staff has started this page with ways you and your family can "Rec It" at home.

Fitness

Seniors

Arts & Crafts

Reading & On-line Fun

Nature Studies

PRM News

Family Activities

Visit this page <https://bit.ly/371Nbxs> regularly for ideas, inspirations, news, and tips on active and enriching ways to keep learning and thriving in your own backyard.

PRM Serves the Community in Uncertain Times

Parks, Recreation and Marine staff have willingly transitioned to alternate duties to assist the community during the COVID-19 pandemic.



Chavez Park staff joined Library Services and Homeless Services staff to operate a food donation center for community members in need.



Staff from throughout PRM and the City are staffing a shelter at Silverado Park to provide additional temporary housing to persons experiencing homelessness in the City during the pandemic. The 24-7 shelter houses approximately 50 people with appropriate physical distancing between cots, and seven additional people as needed in an isolation room. Triage assessments, meals, snacks, recreation activities and social serve resources are provided.



During the pandemic, staff has served the needs of our senior citizens with “grab and go” meals at six locations. Patricia Dawson, Khalei Gentle and Chansocheata “Lisa” Heng from McBride Park are part of the team.



Between other assignments, Community Recreation Services staff created face masks for staff with their own sewing machines and skills. Thanks to sewers Melissa Castro and Benjamin Antonio, and cutter/pinner: Kharla Santos.



With all pools closed, Aquatics staff are assisting other Departments such as Health by answering calls about COVID-19 testing protocols, and Economic Development by answering calls from businesses about financial assistance and business support services. They are also assisting Work Long Beach by screening individuals who are interested in providing childcare needs to families or businesses.

The public eagerly embraced the reopening of the grounds and trails at El Dorado East Regional Park and Nature Center in May. On the first weekend of the reopening, both sites hosted a high volume of visitors with the Nature Center recording nearly 2,000 walkers each day and the Regional Park seeing over 3,500 patrons each day. Staff was busy informing and interacting with all visitors, selling day and annual passes, monitoring social distancing and keeping the trails and park safe.

To support the American Red Cross and help the local community during the COVID-19 pandemic, El Dorado Nature Center organized a blood drive on May 5. The 16 pints of that were collected can save up to 48 people, giving hope to many families.

Marine and Park Maintenance Teams Keep Parks and Beaches Safe

Marine and Park Maintenance staff work hard to keep park and beach landscaping and fixtures looking their best and in good working order.

Marina Beautification Projects



Mother's Beach Before and After

Parks Maintenance Supervisor Jeff King and Gardner II Alex Perez implemented a landscape revitalization plan throughout Alamitos Bay and the Downtown Marinas. The work included sprucing up the Mother's Beach parking lot perimeter near to Appian Way by removing old landscape, and installing purple and bronze Flax and Pink Lady Raphiolepis plants and mulch to fill bare spots and give the area an appealing look.



In the Downtown Marina Pier J area, what was once a barren dirt slope with a row of trees blighted by disease now has a modern design teeming with plant life. Staff remediated the soil and added a retaining wall and a water-saving irrigation system to foster the growth of new Podocarpus trees and Myoporum ground cover.



Orizaba Park

When an electrical panel was damaged beyond repair during a vehicular accident, Omar Barboza and Antonio Guerrero responded and within 24 hours had temporary power to the buildings.

Los Cerritos Park

Plumber Tom Metzger and MOB staff replaced a damaged drinking fountain at Los Cerritos Park.



Jackson Park

Maintenance Assistant Oscar Alaniz coordinated an iron fence install to improve safe conditions at Jackson Park.

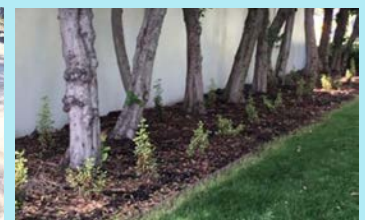
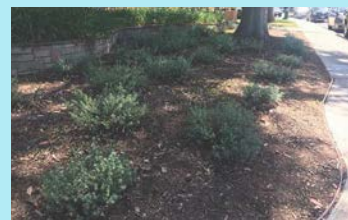

Citywide Planting Projects

PRM Gardeners Clemente Cerrillos and Emanuel Zaragoza, and their team of Roberto Quinonez, Juan Rodriguez, and Eduardo Magallon, completed planting projects at MacArthur, Veterans, Cherry, Pan American, Whaley, College Estates, DeForest, Drake, Jack Nichols, Recreation, Peace, Admiral Kidd, and Los Altos Plaza Parks; and K-9 Corner Dog Park, the Willow Street approaches, and El Dorado Senior Center.

Davenport Park

While playgrounds are currently closed, staff handled several maintenance projects. Maintenance Assistant Supervisor Raul Romero and MAs Pedro Sosa and Luis Olviedo replaced damaged parts in the play equipment at Davenport Park.



Long Beach Parks, Recreation and Marine

2760 Studebaker Road, Long Beach, CA 90815

Phone: 562.570.3100 Fax: 562.570.3109

CITY OF
**LONG
BEACH**



Follow Parks, Recreation and Marine on Facebook, Twitter and Instagram

email: LBParks@longbeach.gov

website: www.LBParks.org