

dimension  
wall  
doors  
milwork  
hatchfill  
border  
detail  
paper

Mark Grisdale, AIA expressly reserves his common law copyright for these plans. These plans are not to be changed or copied in any form or manner, nor are they to be assigned to a third party, without first obtaining the written permission and consent of Mark Grisdale, AIA

THESE DRAWINGS DO NOT CONTAIN THE NECESSARY COMPONENTS FOR CONSTRUCTION SAFETY

Exhibit C

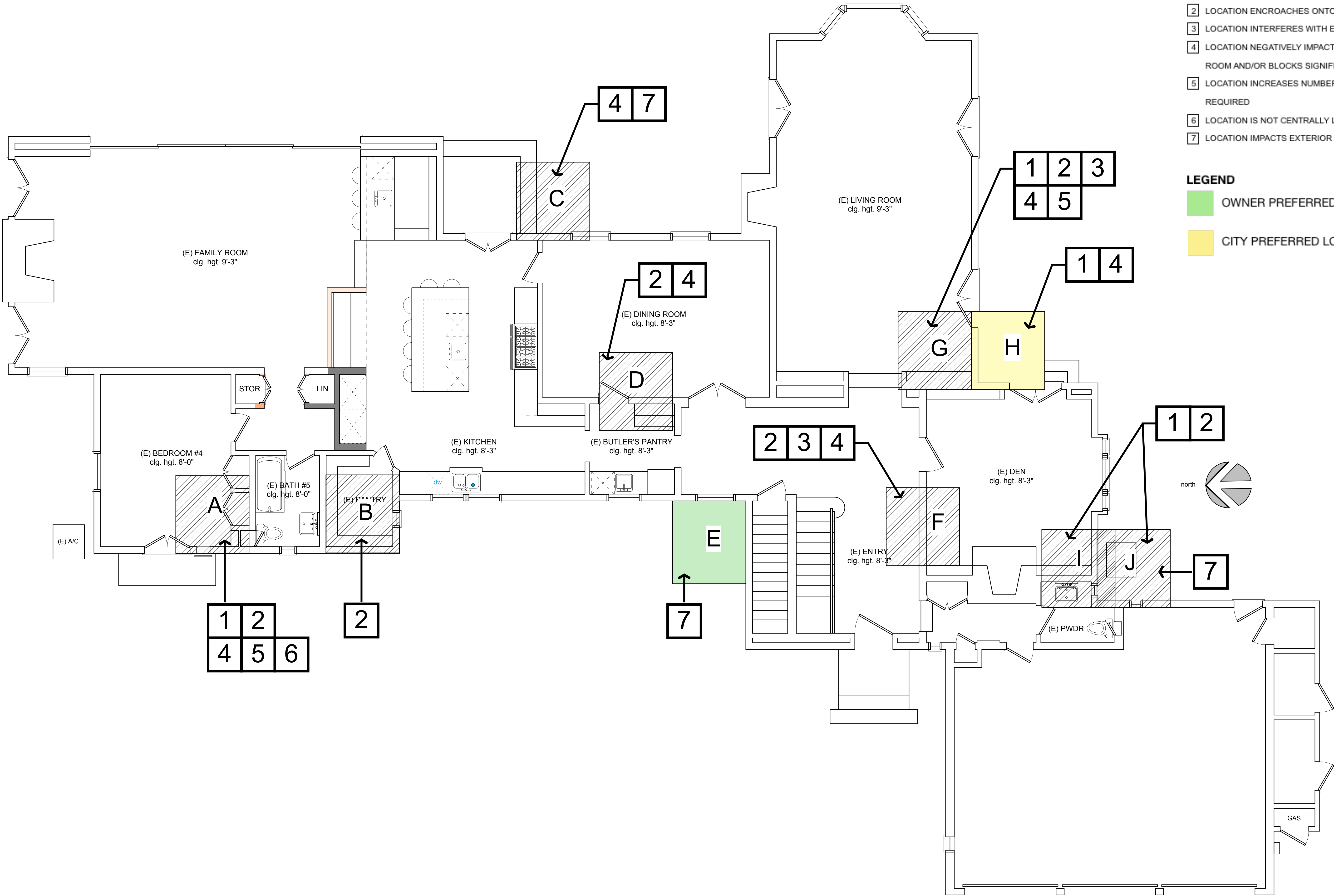

- REASON FOR DISQUALIFICATION OF ELEVATOR LOCATION
- 1 ENTRANCE OCCURS THROUGH NON-PUBLIC SPACE
  - 2 LOCATION ENCROACHES ONTO EXISTING SPACE
  - 3 LOCATION INTERFERES WITH EXITING CIRCULATION
  - 4 LOCATION NEGATIVELY IMPACTS CHARACTER OF (E) ROOM AND/OR BLOCKS SIGNIFICANT VIEW
  - 5 LOCATION INCREASES NUMBER OF VERTICAL STOPS REQUIRED
  - 6 LOCATION IS NOT CENTRALLY LOCATED
  - 7 LOCATION IMPACTS EXTERIOR ELEVATION

- LEGEND
- OWNER PREFERRED LOCATION
  - CITY PREFERRED LOCATION

REVISION

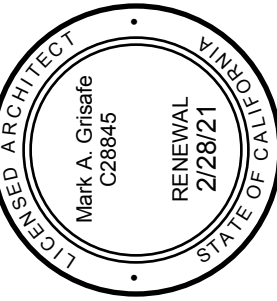

**mg** *orrisa* *safe* *architect*

3750 Schauffele Ave. Ste. 150  
Long Beach, Ca 90808  
(562) 420-1035

Van Horik & Fielder Residence  
4242 Pine Ave.  
Long Beach, CA 90807

Elevator Location Study

date: 6/28/19
plot date:
job no.
scale:

sheet no.  
**A-2**

1st Floor

dimension  
wall  
doors  
milwork  
hatchfill  
border  
detail  
paper

Mark Grisafe, AIA expressly reserves his common law copyright for these plans. These plans are not to be changed or copied in any form or manner, nor are they to be assigned to a third party, without first obtaining the written permission and consent of Mark Grisafe, AIA

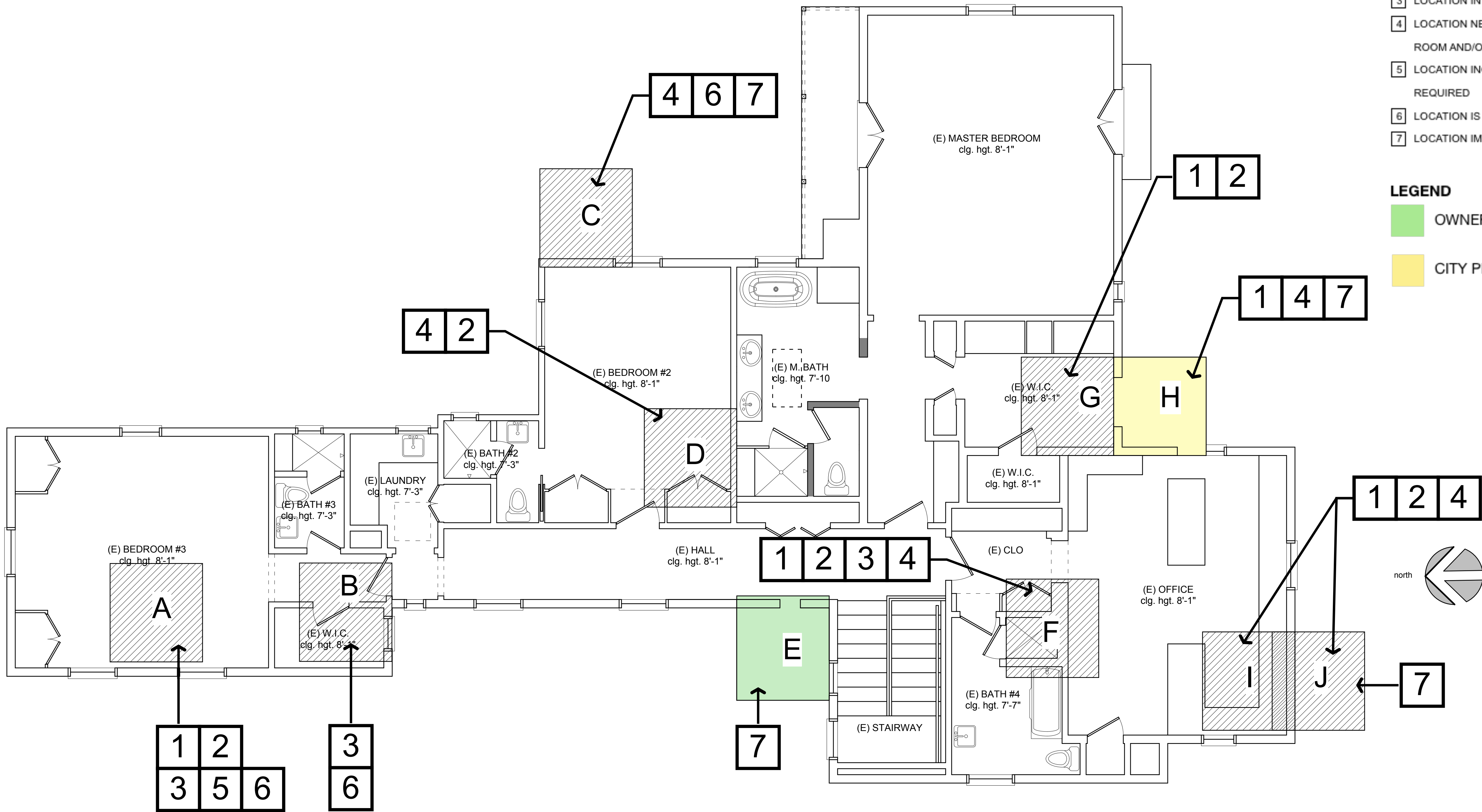

2nd Floor

REASON FOR DISQUALIFICATION OF ELEVATOR LOCATION

- 1 ENTRANCE OCCURS THROUGH NON-PUBLIC SPACE
- 2 LOCATION ENCROACHES ONTO EXISTING SPACE
- 3 LOCATION INTERFERES WITH EXITING CIRCULATION
- 4 LOCATION NEGATIVELY IMPACTS CHARACTER OF (E) ROOM AND/OR BLOCKS SIGNIFICANT VIEW
- 5 LOCATION INCREASES NUMBER OF VERTICAL STOPS REQUIRED
- 6 LOCATION IS NOT CENTRALLY LOCATED
- 7 LOCATION IMPACTS EXTERIOR ELEVATION

LEGEND

- OWNER PREFERRED LOCATION
- CITY PREFERRED LOCATION

REVISION



**mg** *Grisafe* **architect**  
3750 Schauffele Ave. Ste. 150  
Long Beach, Ca 90808  
(562) 420-1035

Van Horik & Fielder Residence  
4242 Pine Ave.  
Long Beach, CA 90807

Elevator Location Study

date: 6/28/19
plot date:
job no.
scale:

sheet no.  
**A-2**

THESE DRAWINGS DO NOT CONTAIN THE NECESSARY COMPONENTS FOR CONSTRUCTION SAFETY