



# **Midtown Specific Plan**

**June 2017**

**One Year Later**





# Midtown Specific Plan

Final Council Action June 14, 2016





# Specific Plan Boundary

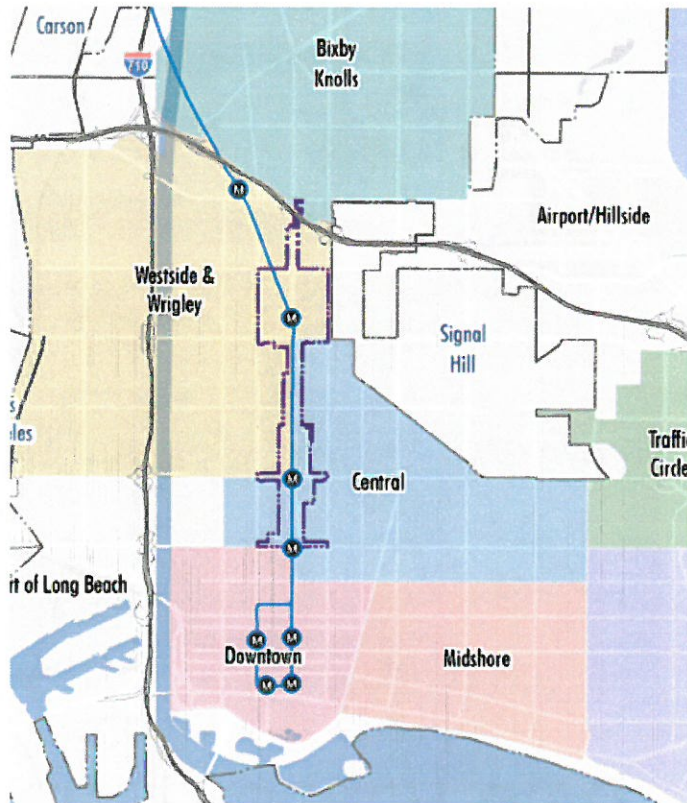

- 2.5 miles
- 369 acres
- North: Wardlow Road
- South: Anaheim Street
- Anaheim, PCH and Willow Metro stops
- Council Districts 1, 6 and 7



# Long Beach Blvd



- Five Projects in the Entitlement Process
- Three Projects in the Pre-Application State
- One Tactical Urbanism Project Complete
- Additional Projects Expected in 2018



## Midtown Specific Plan

# Vista Del Puerto | 1836 Locust Ave



- 60 affordable units
- LBCIC Property
- Alley and Sidewalk Improvements
- Four Stories on Locust, Steps-Up to Five Stories toward Long Beach Boulevard
- Council District 6





## Midtown Specific Plan

# Amcal Apartment | 1795 Long Beach Blvd



- 100 affordable units
- 1 market-rate manager unit
- LBCIC Property
- Alley and Sidewalk Improvements
- Four Stories
- Council District 1



## Midtown Specific Plan

# Long Beach Square Partners | 1400 Long Beach Blvd



- 64 market-rate apartments
- 2,100 sq. ft. retail
- Five Stories
- Streetlet on 14<sup>th</sup>
- Council District 1





## Midtown Specific Plan

# Linc Housing | 1900 Long Beach Blvd



- 95 affordable units
- LBCIC Property
- Commercial kitchen, YMCA satellite campus
- Six Stories
- Streetlet on Rhea
- Council District 6







## Pre-Application Phase Projects

---



## Midtown Specific Plan

### 540 E. Willow St



- 23 apartments
- Successor Agency parcel
- Now in Redesign
- Three Stories over Parking
- Council District 6





## Midtown Specific Plan

# Skid Row Housing Trust | 1401 Long Beach Blvd



- 71 total units
- 35 affordable family units
- 1 manager unit
- 35 units for homeless individuals
- Council District 1



## Midtown Specific Plan

# 1814 Pine Ave



- Future Mixed-Use Project
- Staff rejected initial strip-mall design
- Successor Agency parcel
- Specific Plan Worked, Applicant now redesigning for larger mixed-use project
- Council District 6







## Testing the "Streetlet" Idea at 14<sup>th</sup> Street





# Streetlet

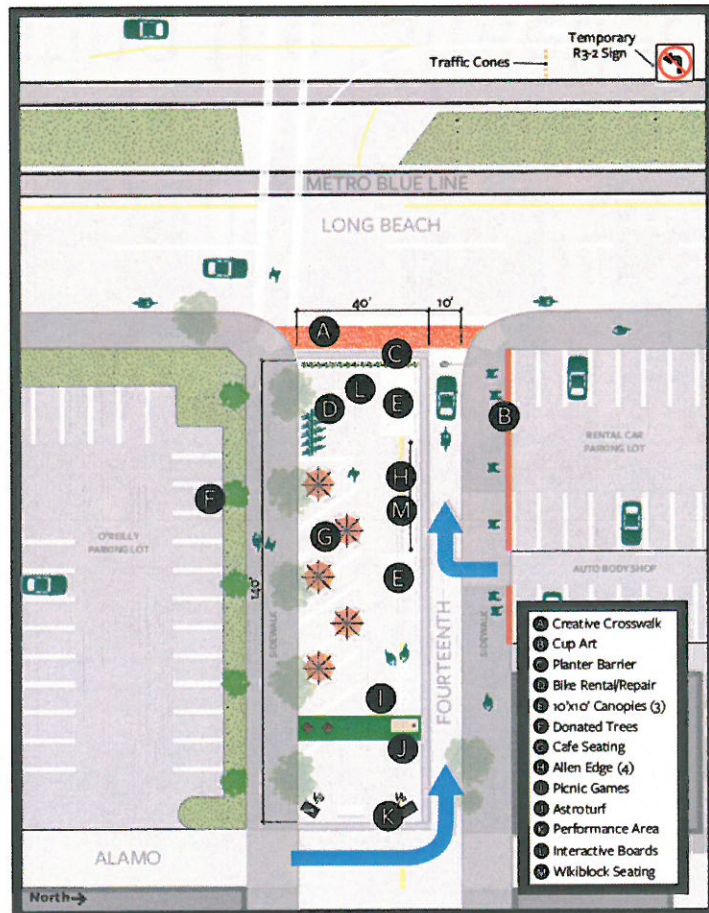

(Concept Map created by City Fabrick)





# Streetlet



# Midtown Data

---





## Business Licenses

62

Active Licenses



## Proposed New Units

290

Affordable

35

For Homeless

02

Manager  
Unit

64

Market  
Rate

23

Apartments

414

Units





# Building Permits

81

## Building Permits

27 Remodel Permits

18 Sign Permits

2 Cell Permits

1 Sandblast Permit

1 Window Permit

1 Demolition Permit

1 Foundation Permit

12 Electrical Permits

6 Mechanical Permits

5 Plumbing Permits

7 Roof Permits



## Permits By Zone

04

SP-1-M

37

SP-1-CDR

81

**Building Permits**

40

SP-1-TN





# Total Permit Valuation

**\$4.5**

**Million**



