

QUEEN MARY LAND DEVELOPMENT TASK FORCE

PRELIMINARY SITE PLANNING CONCEPT

JUNE 1, 2016

TOPICS COVERED IN PREVIOUS MEETINGS

- Arrival Sequence
- Parking
- Promenade & Causeway
- Grading in the Park
- Service Routes
- The Spruce Goose Dome
- Event Space
- Queen Mary
- Uses
- Design
- Connectivity
- Views
- Emphasis on waterfront
- Iconic district

TOPICS TO BE DISCUSSED - JUNE 1ST, 2016

- Multi-Use Hall
- Hotel(s)
- Entertainment Zone
- Mixed-Use Adjacent to Parking Structure
- Marina(s) & Water Taxis
- Floating Pool & Cafe
- Density, Height, Viewsheds

OVERVIEW FROM NORTH

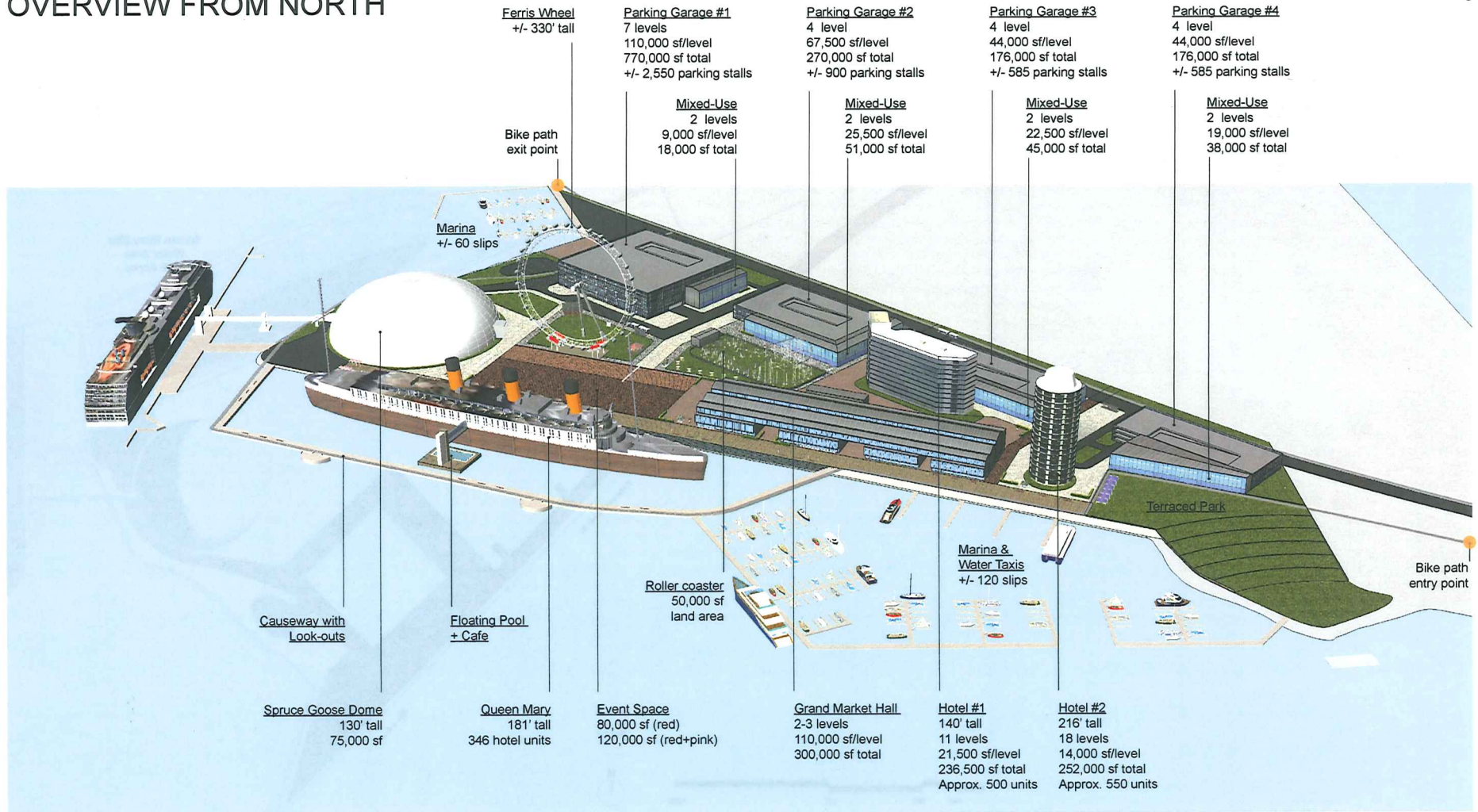

CIRCULATION

- Condensed drive aisle
- 2 lanes in, 2 lanes out
- Traffic kept to the perimeter (south) side of the property
- Bus, cars, taxis use same entrance

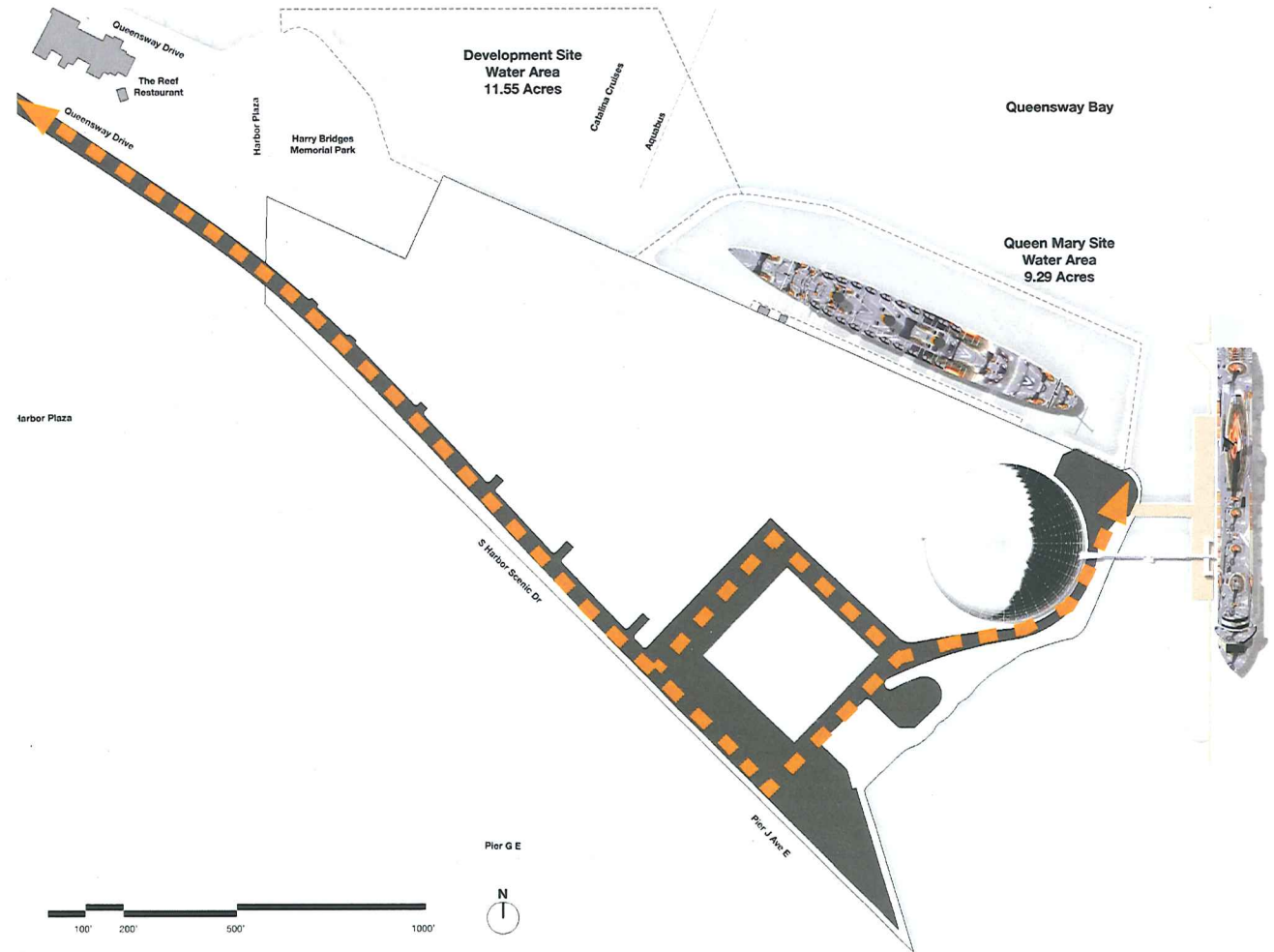

Queen Mary Land Development Task Force

PRELIMINARY SITE PLANNING CONCEPT

CIRCULATION - REFERENCE



PARKING

- “Aha” moments at arrival
- Efficient system of entry/exit
- Splitting into multiple points of arrival to control traffic
- 4 structures relate to 4 programmed zones
- Payment integral to entry/exit sequence
- Approx. 4,600 parking stalls

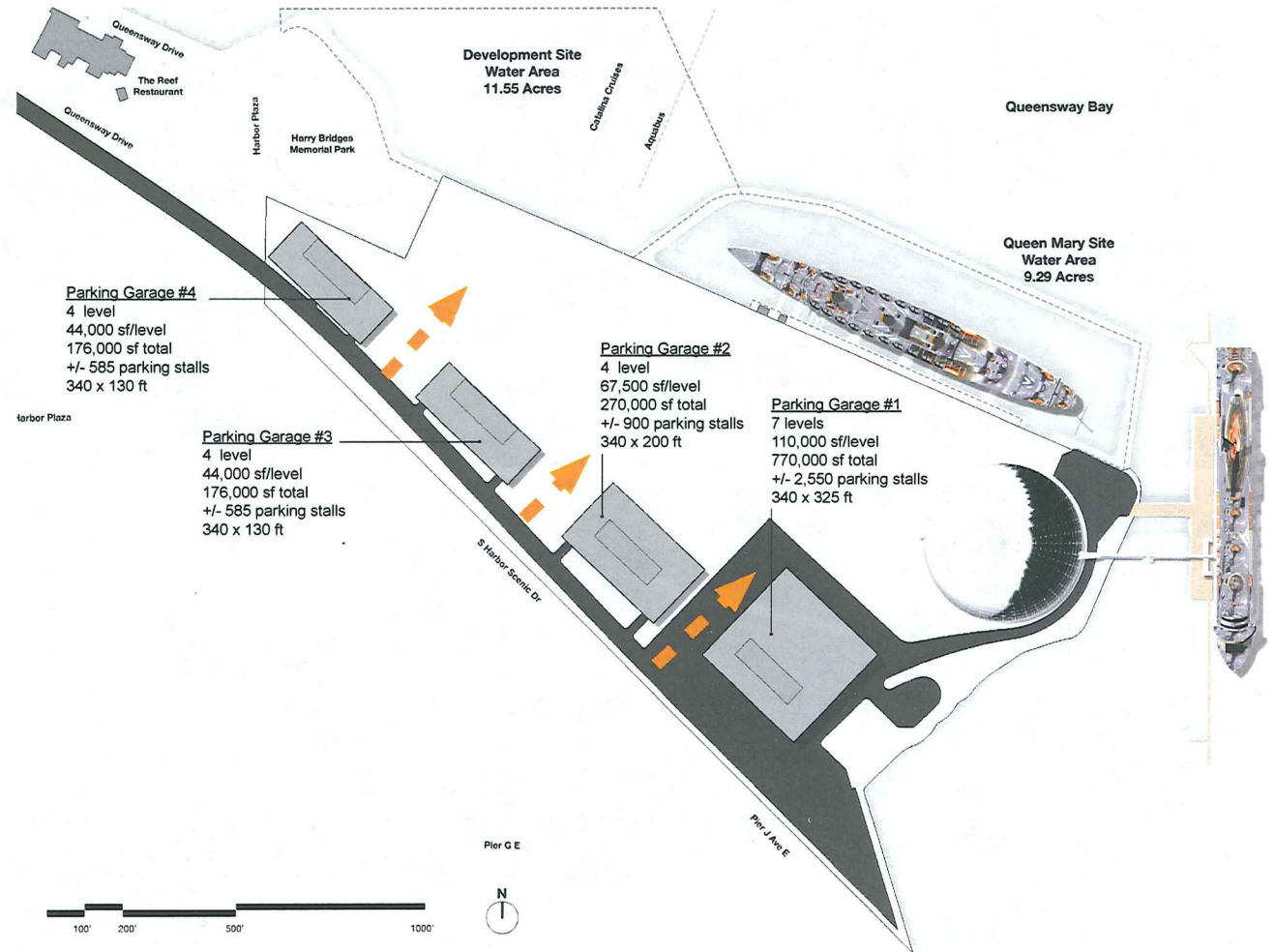

PARKING - REFERENCE

7



PROMENADE & CAUSEWAY

- Grand in width, but comfortable
- Various vantage points along length of promenade
- Seating, Standing, Strolling and Viewing areas integral to design

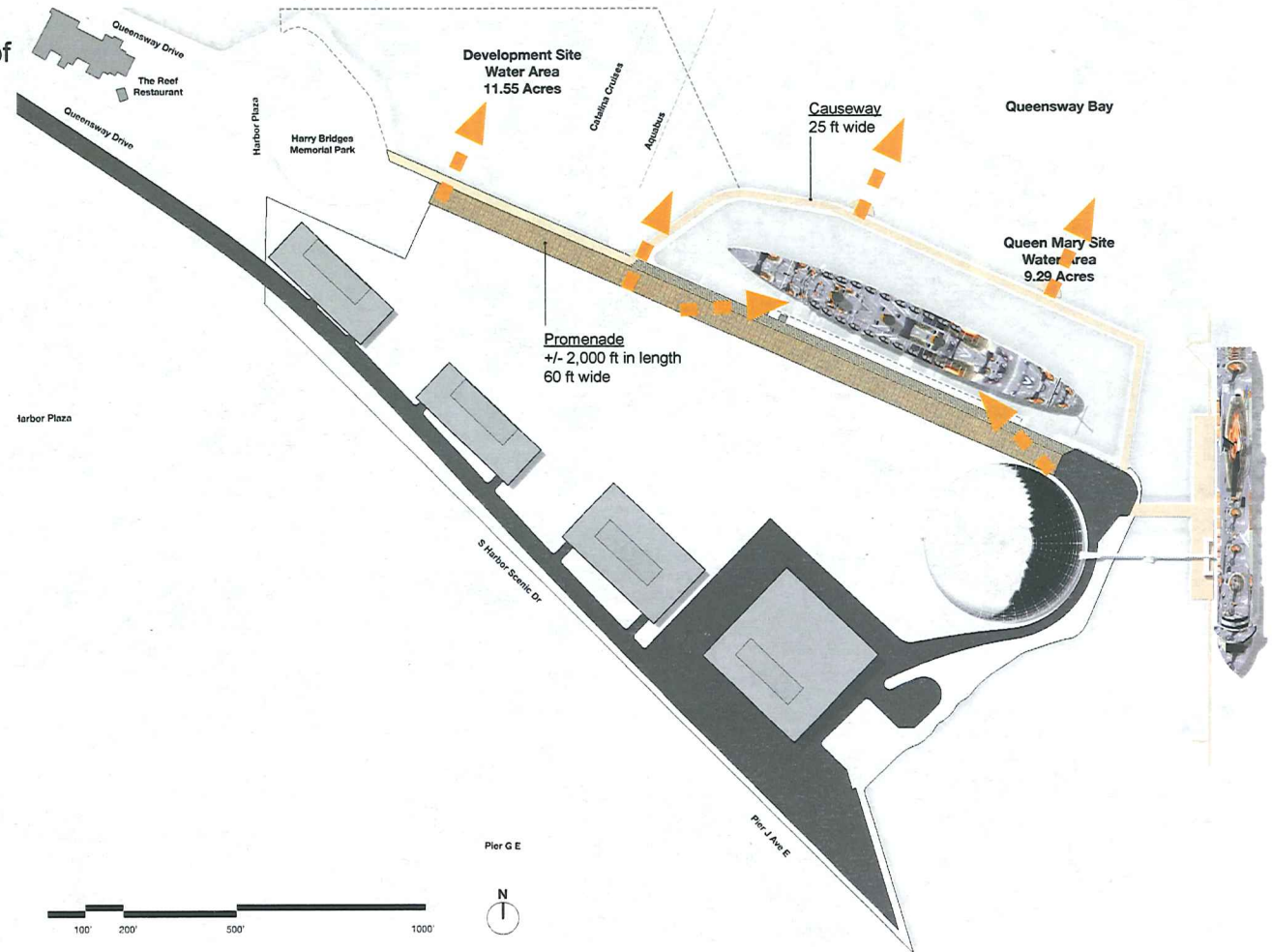

PROMENADE & CAUSEWAY - REFERENCE

9



PROMENADE & CAUSEWAY - REFERENCE

10



TERRACED PARK & EVENT SPACE

- Elevated views of the city and events
- Event space large enough for outdoor concerts
- Destinations along the waterfront and promenade
- Visual open space to draw people in

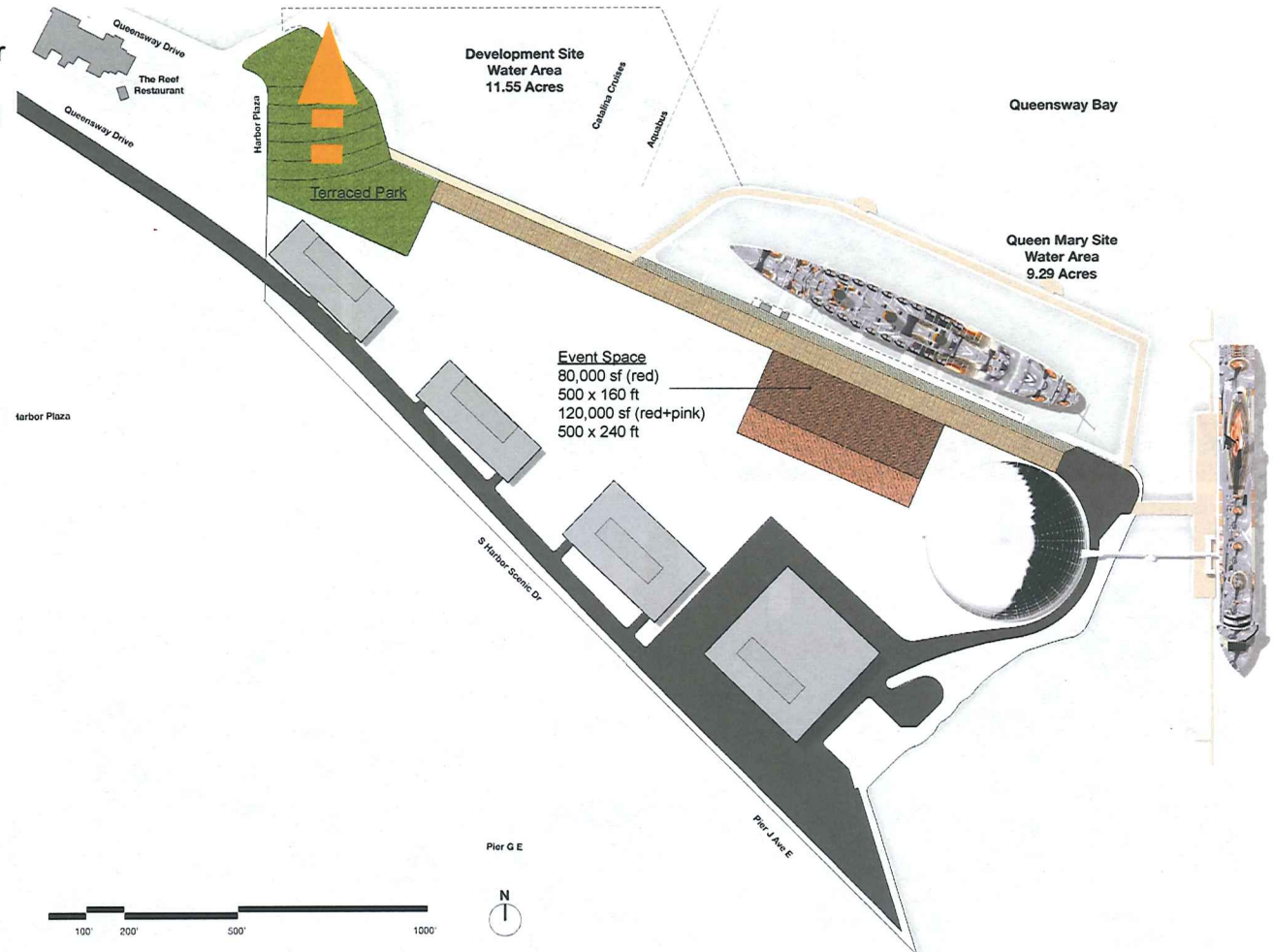

Queen Mary Land Development Task Force

PRELIMINARY SITE PLANNING CONCEPT

TERRACED PARK & EVENT SPACE - REFERENCE

12



TERRACED PARK & EVENT SPACE - REFERENCE

13



GRAND MARKET HALL

- Porous ground plan
- Restaurants, Markets, Cafes, Bars, Vendor shared space
- Activates the site year round
- Central hub of activity

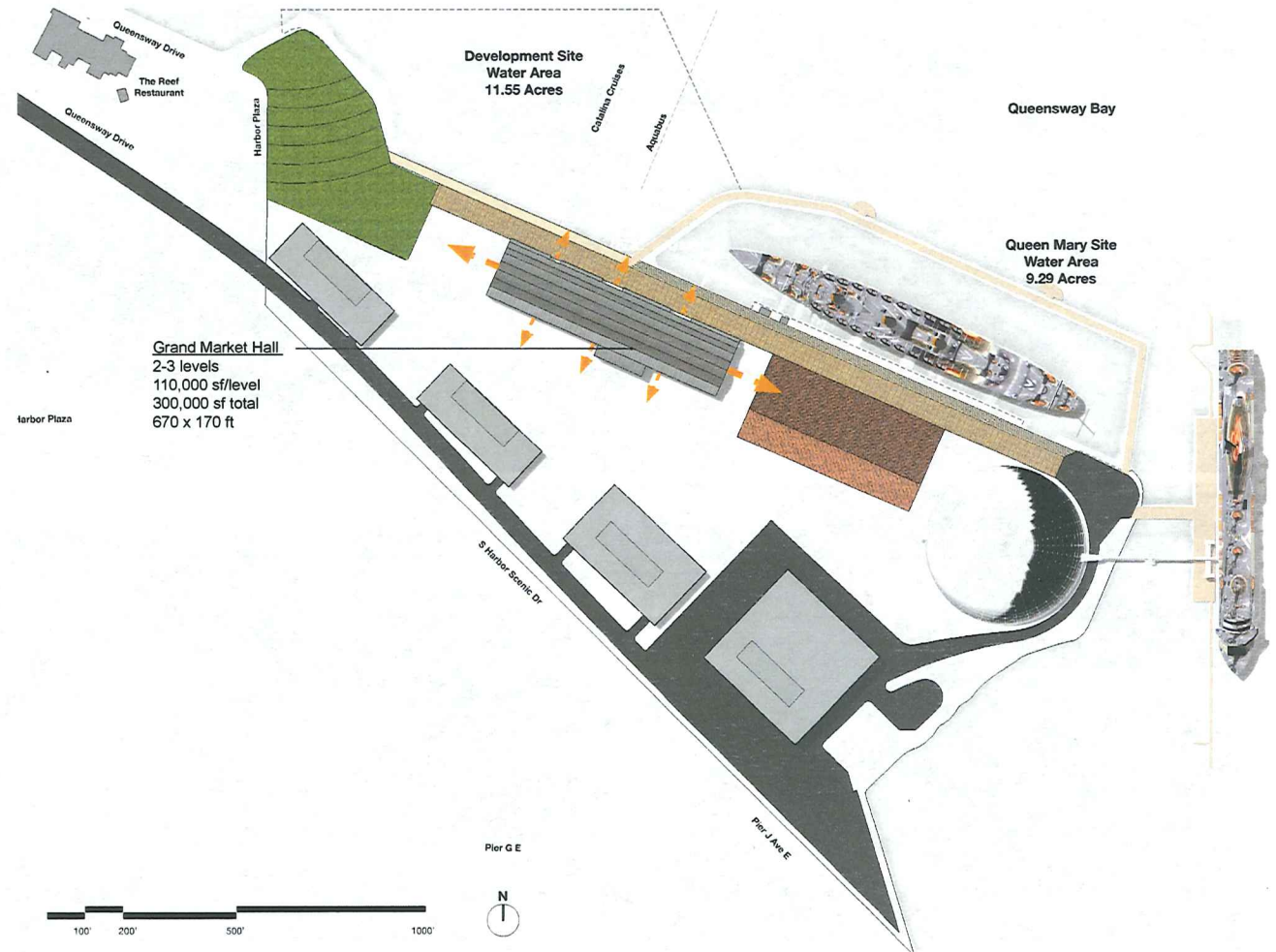

GRAND MARKET HALL - REFERENCE

15



GRAND MARKET HALL - REFERENCE

16



HOTEL(S)

- Anchor point along the waterfront
- Point tower allows views in every direction
- Creates activity within the property

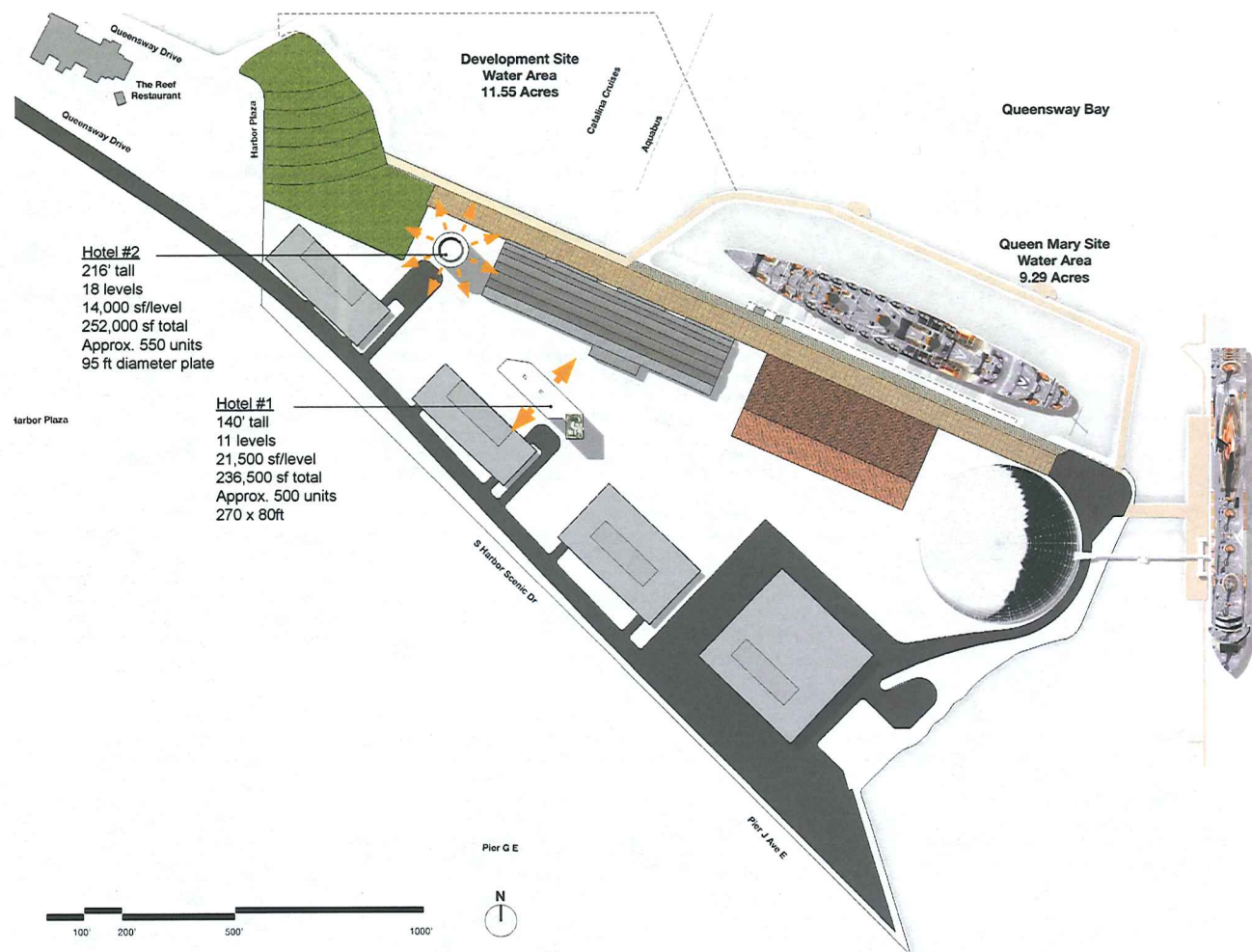

Queen Mary Land Development Task Force

PRELIMINARY SITE PLANNING CONCEPT

HOTEL(S) - REFERENCE

18

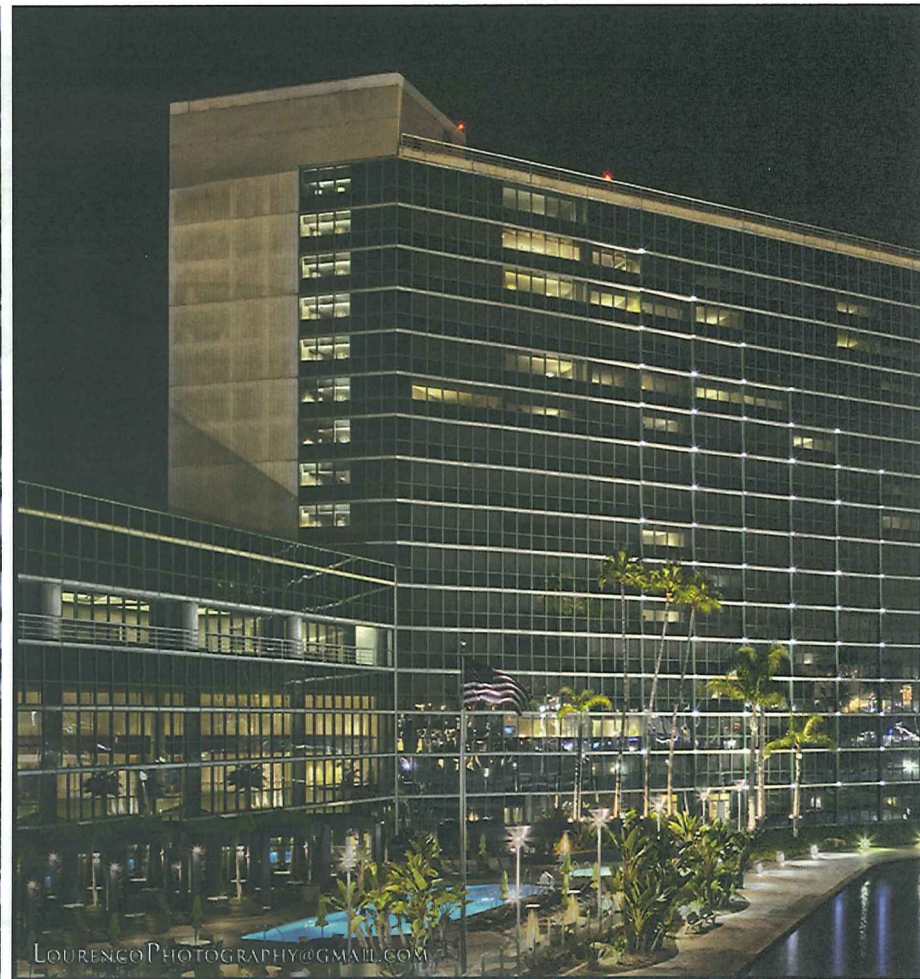
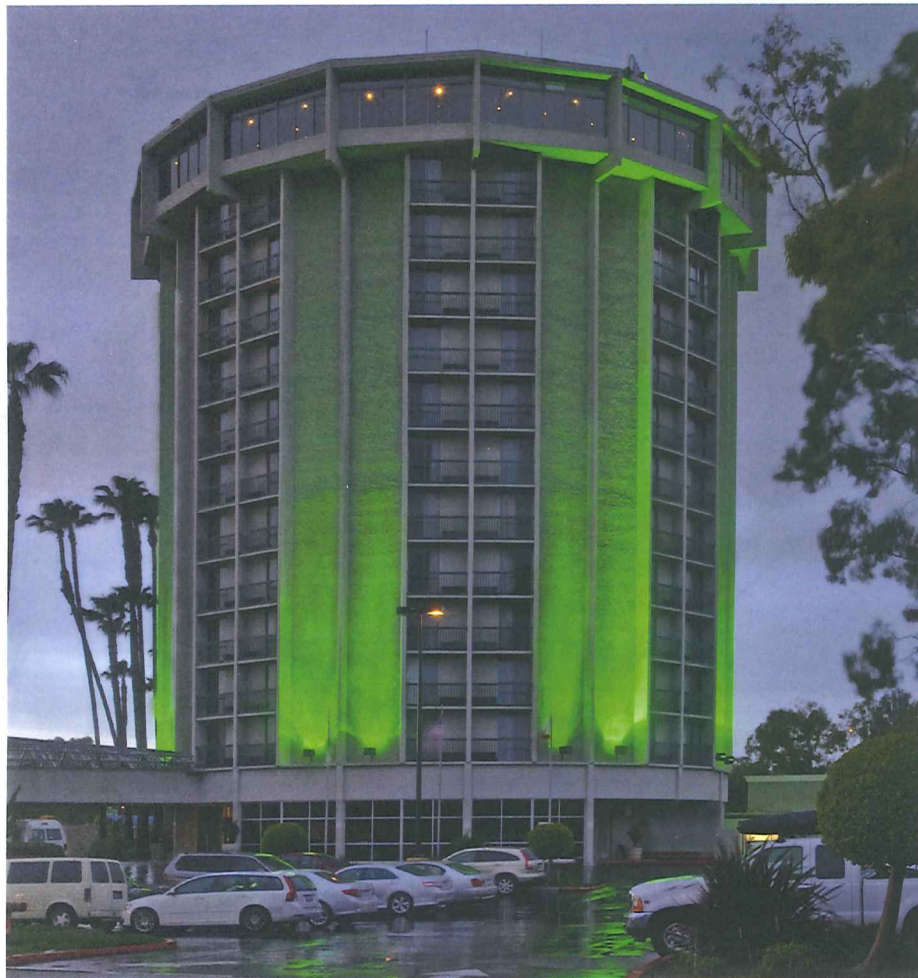

GWYNNE
PUGH
URBAN
STUDIO

Queen Mary Land Development Task Force
PRELIMINARY SITE PLANNING CONCEPT

MIXED-USE ADJACENT TO PARKING

- Provides a visual buffer between parking and event space
- Potential mixed-use, retail, commercial rentable space
- Approx. 152,000 sf total

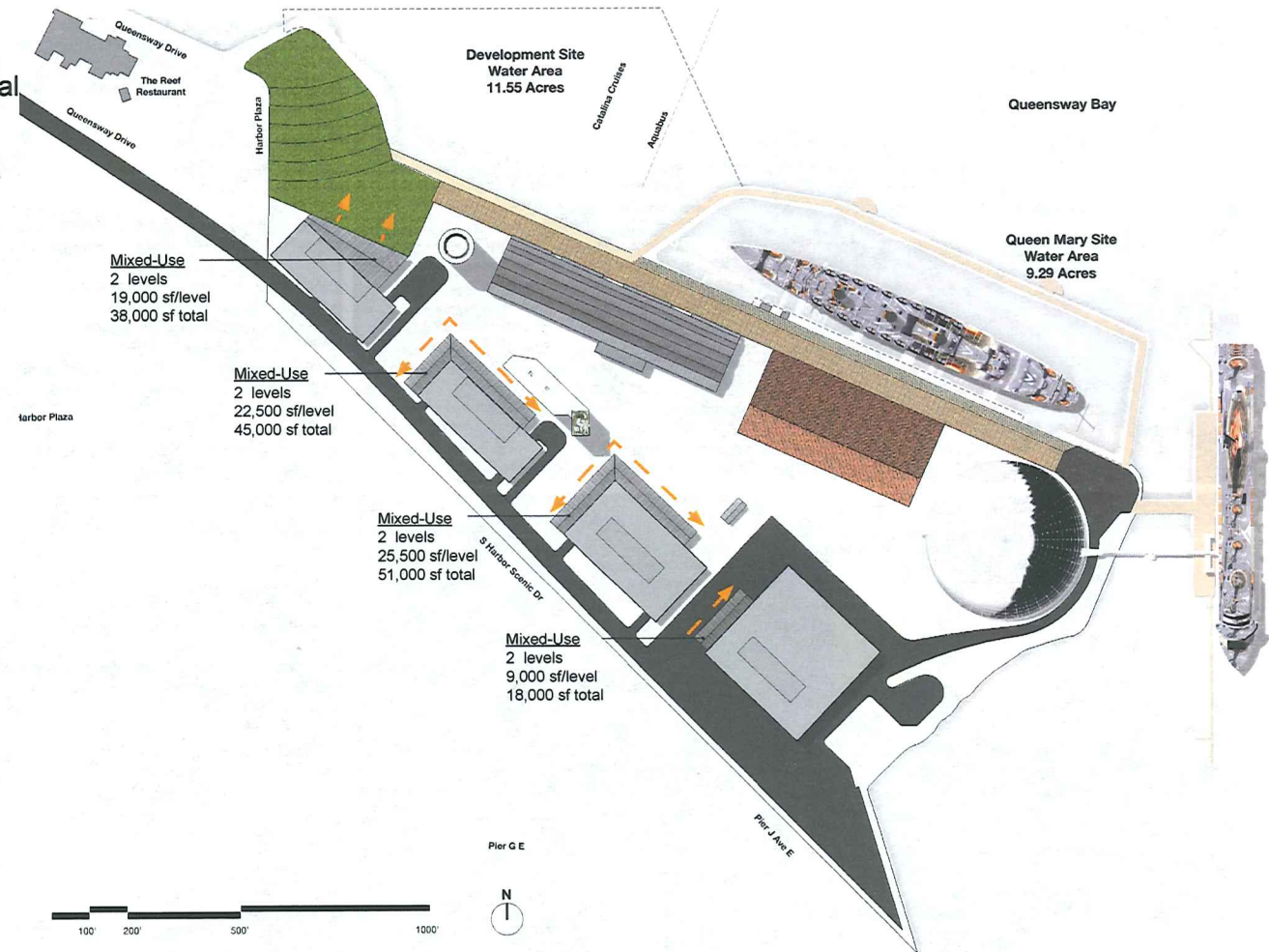

Queen Mary Land Development Task Force

PRELIMINARY SITE PLANNING CONCEPT

MIXED-USE ADJACENT TO PARKING - REFERENCE

20



ENTERTAINMENT ZONE

- Re-programmable, accessible fun zones with paid rides
- Integral to the internal activity on site
- Visual attraction within the internal zone and from across the Bay
- Approx. 100,000 sf total

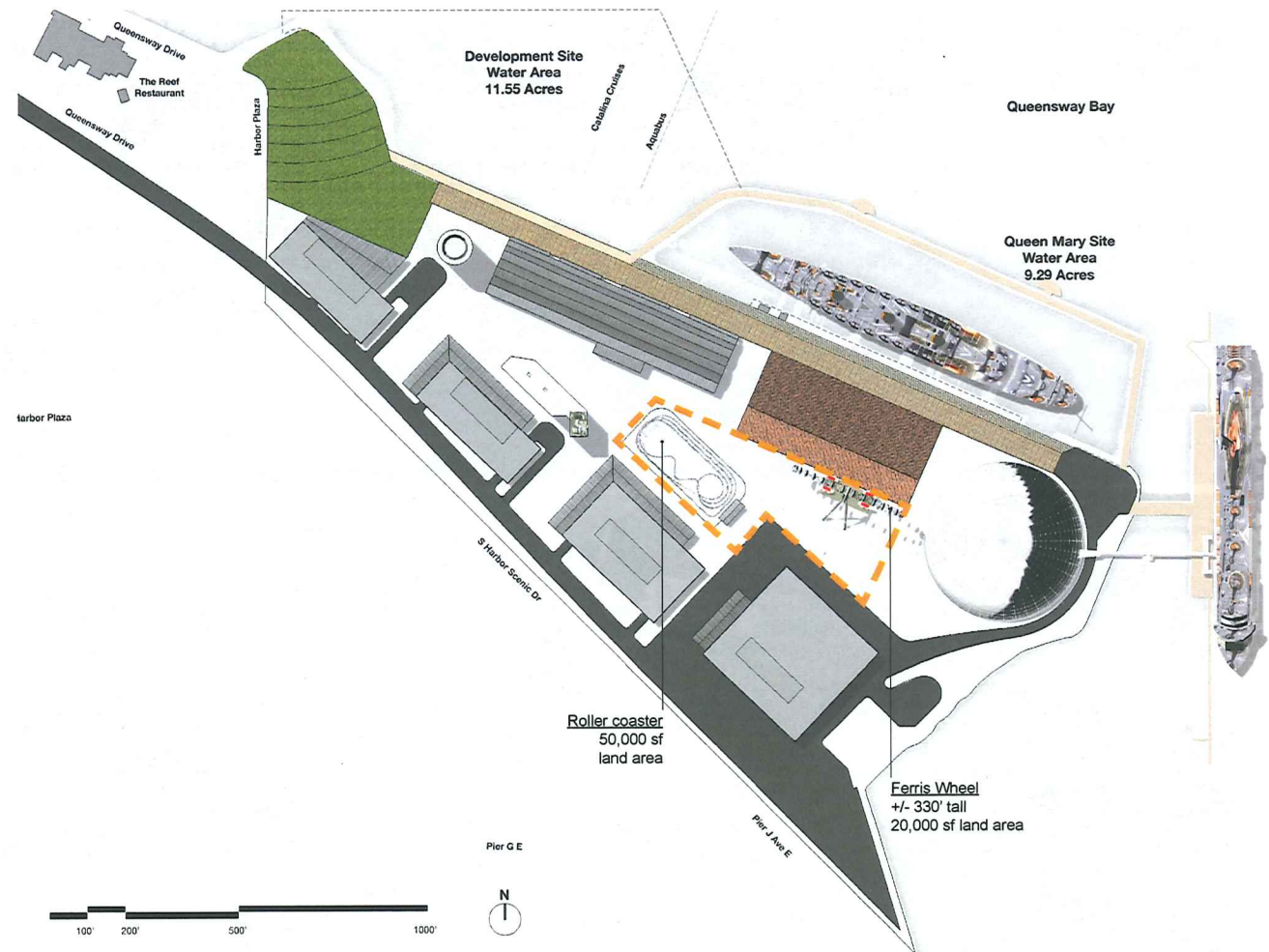

ENTERTAINMENT ZONE - REFERENCE

22



MARINA(S)

- Integral to the everyday activities of the site
- Large enough for yachts and shuttle boats
- Simple, efficient water taxi access
- A visual attraction to compliment the Queen Mary

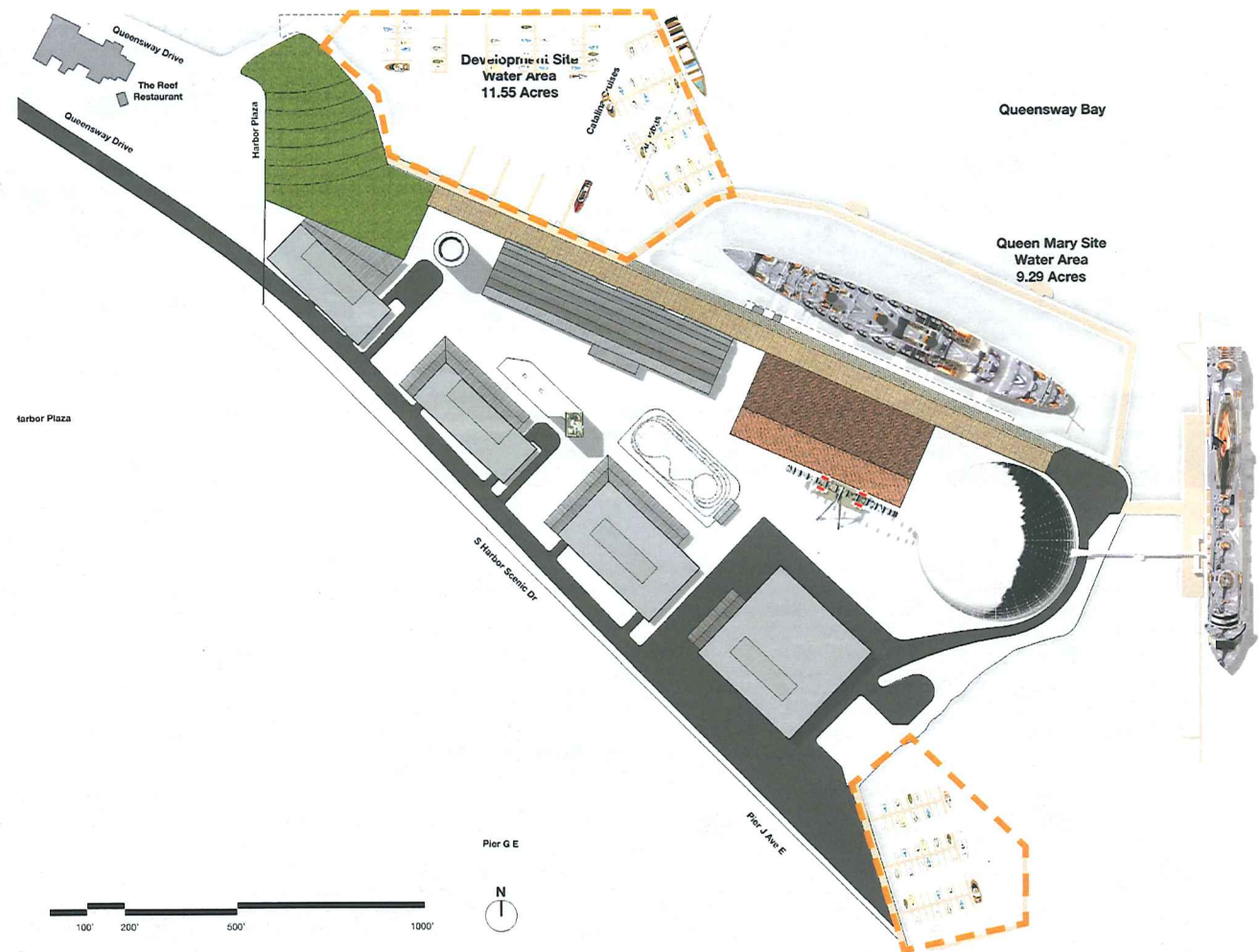

Queen Mary Land Development Task Force

PRELIMINARY SITE PLANNING CONCEPT

MARINA(S) - REFERENCE

24



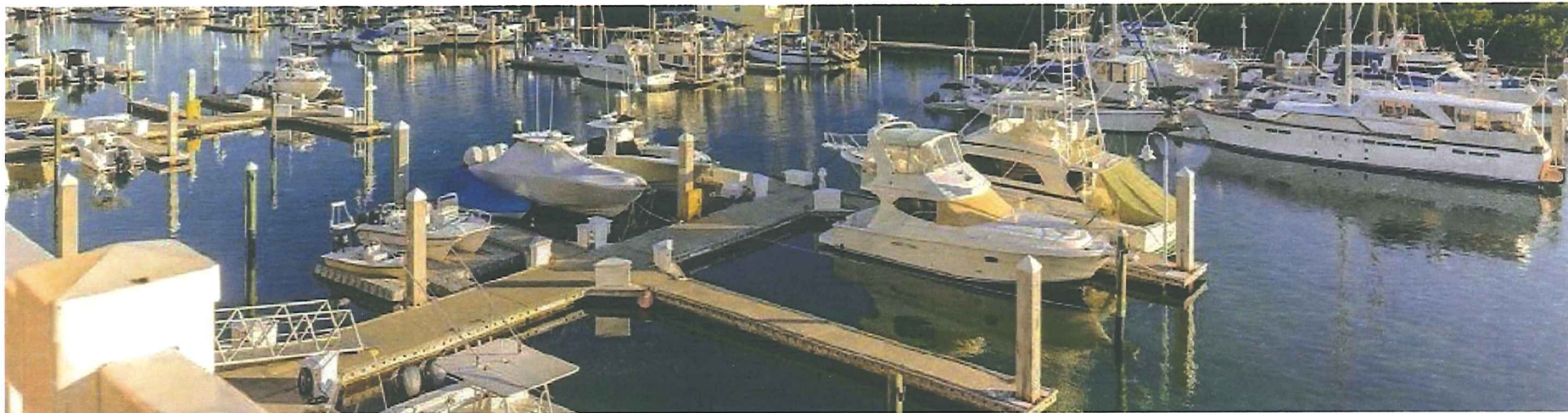

PUBLIC SPACE

- Varied textures and colors define walking, bicycling, event zones
- Green buffers sprinkled within the interstitial space
- Directionality and continuity to draw the visitors through the property

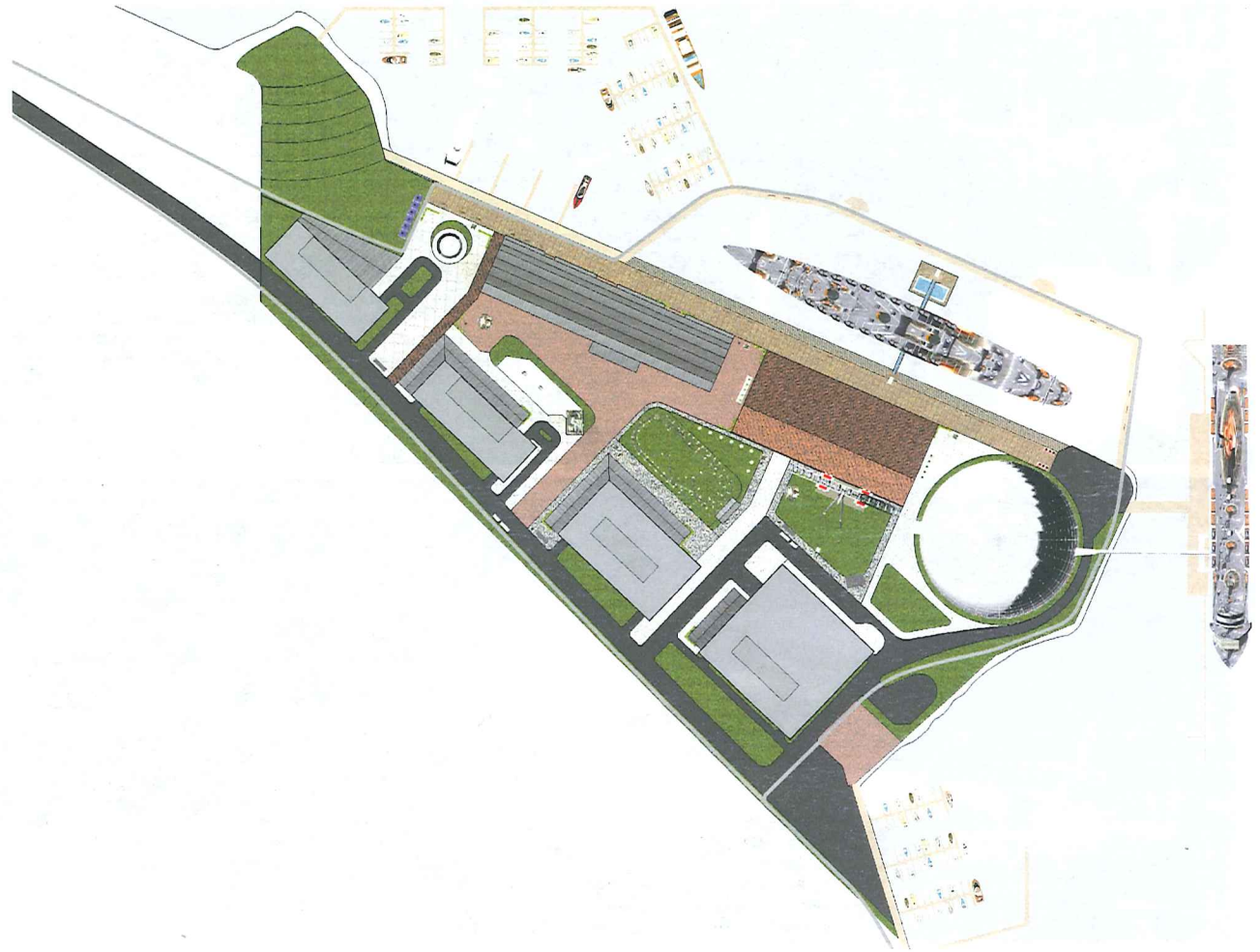

PUBLIC SPACE - REFERENCE

27



PUBLIC SPACE - REFERENCE

28



GWYNNE
PUGH
URBAN
STUDIO

Queen Mary Land Development Task Force
PRELIMINARY SITE PLANNING CONCEPT

OVERVIEW FROM SOUTH

29



OVERVIEW FROM NORTHWEST

30



OVERVIEW FROM NORTHEAST

31



ARRIVAL VIEW

32



PROMENADE VIEW SOUTH

33



PROMENADE VIEW NORTH

34



PARK VIEW

35

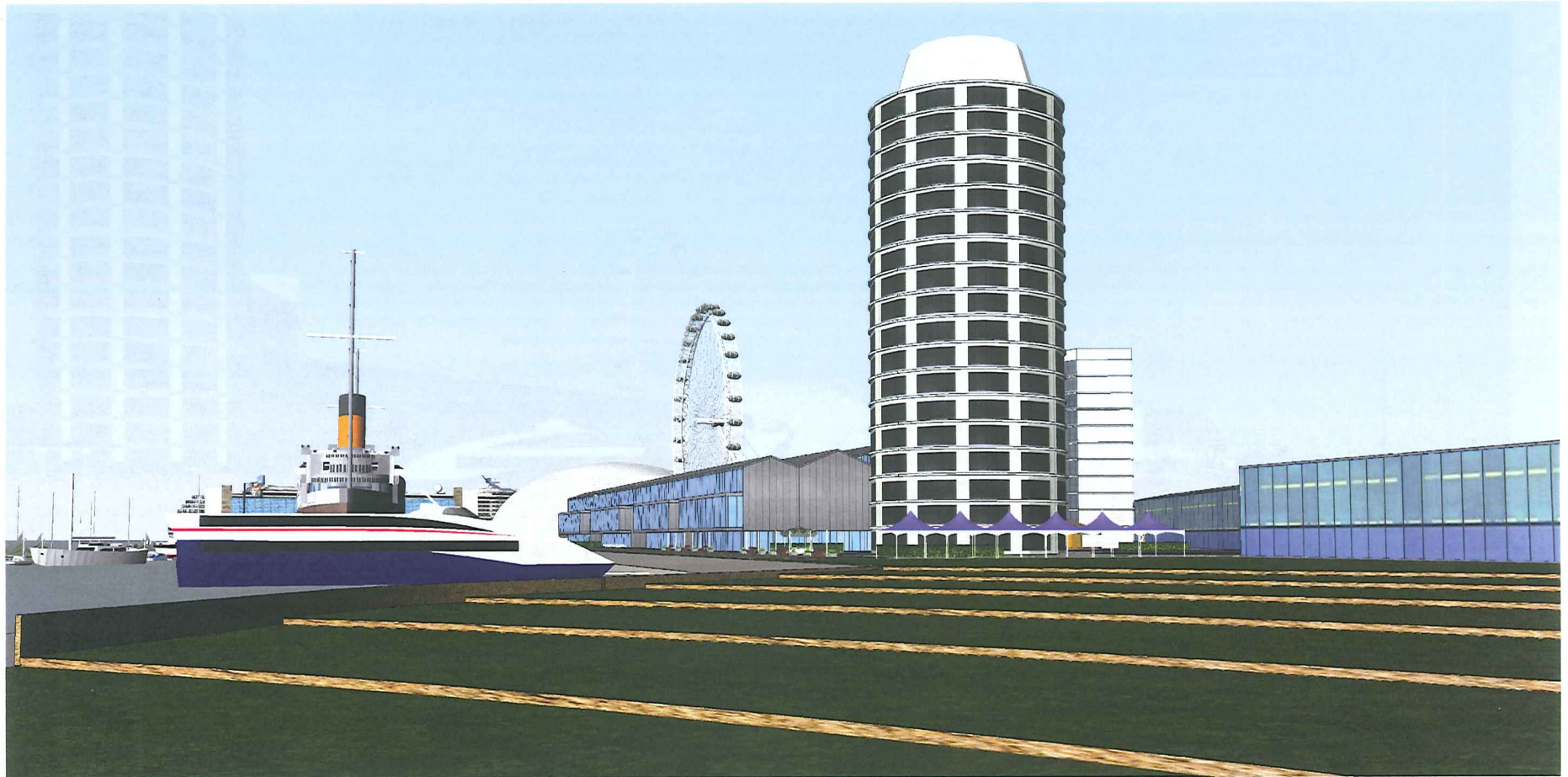

MARINA VIEW

36

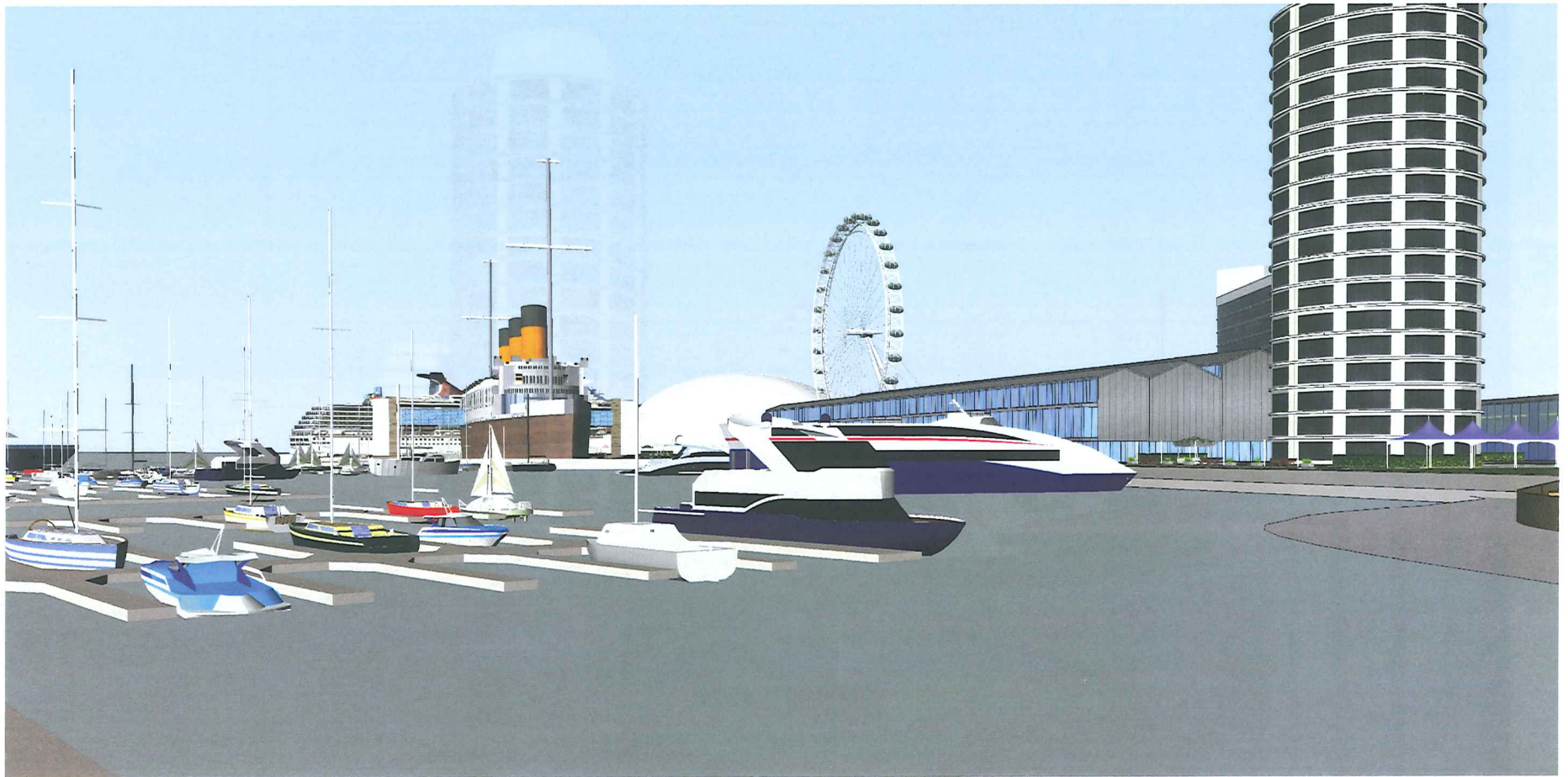

DOWNTOWN VIEW

37



