

RESOLUTION NO. RES-11-0045

A RESOLUTION OF THE CITY COUNCIL OF THE
CITY OF LONG BEACH MAKING APPLICATION TO AND
REQUESTING THE LOCAL AGENCY FORMATION
COMMISSION OF LOS ANGELES COUNTY TO TAKE
PROCEEDINGS PURSUANT TO THE CORTESE-KNOX-
HERTZBERG LOCAL GOVERNMENT REORGANIZATION
ACT OF 2000 FOR THE CITY OF LONG BEACH TO
ANNEX (AND/OR DETACH) APPROXIMATELY 41.28
ACRES OF PROPERTY

WHEREAS, City of Long Beach ("City") desires to initiate proceedings
pursuant to the Cortese-Knox-Hertzberg Local Reorganization Act of 2000, Division 3,
commencing with Section 56000 of the Government Code, for the annexation (and/or
detachment) of various areas in or adjacent to the City of Long Beach; and

WHEREAS, the City will file an application with the Local Agency Formation
Commission to annex/detach said areas as set forth and more particularly described in
Exhibit "A" (Chart) and Exhibit "B" (Maps), attached hereto and by this reference
incorporated herein; and

WHEREAS, the proposal includes changes to the boundary line between
the County of Los Angeles and the County of Orange. This proposal is processed
pursuant to Article 4, Chapter 2, Division 1 of Title 3 of the Government Code (Section
23200 et seq). The proposal also includes a detachment from the City of Seal Beach,
detachments from the City of Long Beach, annexations to the City of Long Beach,
annexations to the City of Seal Beach and annexation to the City of Los Alamitos. These
proposals are processed pursuant to the Cortese-Knox-Hertzberg Local Government
Reorganization Act of 2000 (Government Code Section 56000 et seq). All proposals are

1 linked and no proposal shall be effective until all proposals are effective. The two county
2 ordinances shall state that they shall not become effective until every city change of
3 organization is effective. Each city change of organization shall not become effective until
4 all city changes of organization are recorded and the two county ordinances are effective;
5 and

6 WHEREAS, the Los Angeles County and Orange County Boards of
7 Supervisors are proposing to make changes to seven (7) uninhabited areas in the
8 boundary line between the County of Orange and the County of Los Angeles so as to
9 cause the transfer of land as depicted in Exhibit B from Los Angeles County to Orange
10 County and from Orange County to Los Angeles County; and

11 WHEREAS, the City Council of the City of Long Beach reviewed the
12 boundary line adjustment and annexation/detachment proposals at its meeting held on
13 April 5, 2011. The City Council voted to proceed with making application to the Local
14 Agency Formation Commission of Los Angeles County to take proceedings for the
15 annexation for those areas described as Areas 1, 2, 3, 4, 5, and 7 depicted on Exhibits A
16 and B and voted not to approve any annexation/detachment for Area 6 as depicted in
17 Exhibit A and B; and

18 WHEREAS, this proposed annexation or reorganization shall be subject to
19 the following terms and conditions: the annexation shall be consistent with Government
20 Code Section 56375.3(a) and other applicable laws existing as of the date of the filing of
21 this Resolution; and

22 WHEREAS, the reason for the proposal is to provide boundary adjustments
23 of uninhabited areas so that the border between Los Angeles County and Orange County
24 is more closely aligned with the Coyote Creek Flood Channel and will allow for better
25 service delivery and improved public safety; and

26 WHEREAS, a Public Hearing will be held by the Planning Commission to
27 prezone those land areas to be annexed to the City that require a current zoning
28 designation.

1 NOW THEREFORE, the City Council of the City of Long Beach resolves as
2 follows:

3 Section 1. The City Council of the City of Long Beach, California, does
4 hereby approve the Resolution of Application for Annexation/Detachment, and requests
5 that the Local Agency Formation Commission of Los Angeles County take proceedings
6 for the annexation of territories to the City, as shown in Exhibits "A" and "B" (except Area
7 6 as noted more particularly in Exhibits A and B), attached hereto and incorporated
8 herein by this reference, according to the terms and conditions stated above and in the
9 manner provided by the Cortese-Knox-Hertzberg Local Government Reorganization Act
10 of 2000.

11 Section 2. This resolution shall take effect immediately upon its adoption
12 by the City Council, and the City Clerk shall certify the vote adopting this resolution.

13 I hereby certify that the foregoing resolution was adopted by the City
14 Council of the City of Long Beach at its meeting of April 5, 2011 by the
15 following vote:

16
17 Ayes: Councilmembers: Garcia, DeLong, O'Donnell, Schipske,
18 Andrews, Johnson, Gabelich, Lowenthal.

19
20
21 Noes: Councilmembers: None.

22
23 Absent: Councilmembers: Neal.

24
25
26 
27 _____
28 City Clerk

EXHIBIT A

Area	Description	Acres	Area Moved from City/to City	Before County Boundary Adjustment	After County Boundary Adjustment
1	Area includes a small portion of Long Beach Harbor (west side of rock jetty) and Khoury's Parking lot	10.54	Seal Beach to Long Beach	OC LAFCO detaches territory	LA LAFCO Annexes Territory
2	Area includes bike path located along San Gabriel River channel north of Marina Drive bridge	1.05	Seal Beach to Long Beach	OC LAFCO detaches territory	LA LAFCO Annexes Territory
3	Area includes portion of Seal Beach Trailer Park and parking lot behind Oakwood Apartments and eastern edge of San Gabriel River	3.83	Long Beach to Seal Beach	LA LAFCO detaches territory	OC LAFCO Annexes Territory
4	Area along west edge of Hellman Ranch near Haynes Plant cooling water outfall	4.97	Seal Beach to Long Beach	OC LAFCO detaches territory	LA LAFCO Annexes Territory
5	College Estates Park area that includes tennis court, park area (unincorporated Orange County) and west side of the San Gabriel River channel	2.17	County of Orange to Long Beach		LA LAFCO Annexes Territory
		17.41	Seal Beach to Long Beach	OC LAFCO detaches territory	LA LAFCO Annexes Territory
6	Area includes vacant parcel east of flood control channel AREA 6	36.53	Long Beach to Los Alamitos	LA LAFCO detaches territory	OC LAFCO Annexes territory
NOT APPROVED BY LONG BEACH CITY COUNCIL ON 4/5/11					
7	Area includes Stansbury Park and rear portions of 5 residential parcels located along Toland Ave	1.31	Long Beach to Los Alamitos	LA LAFCO detaches territory	OC LAFCO Annexes territory

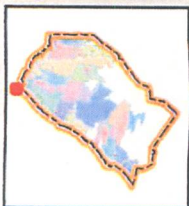
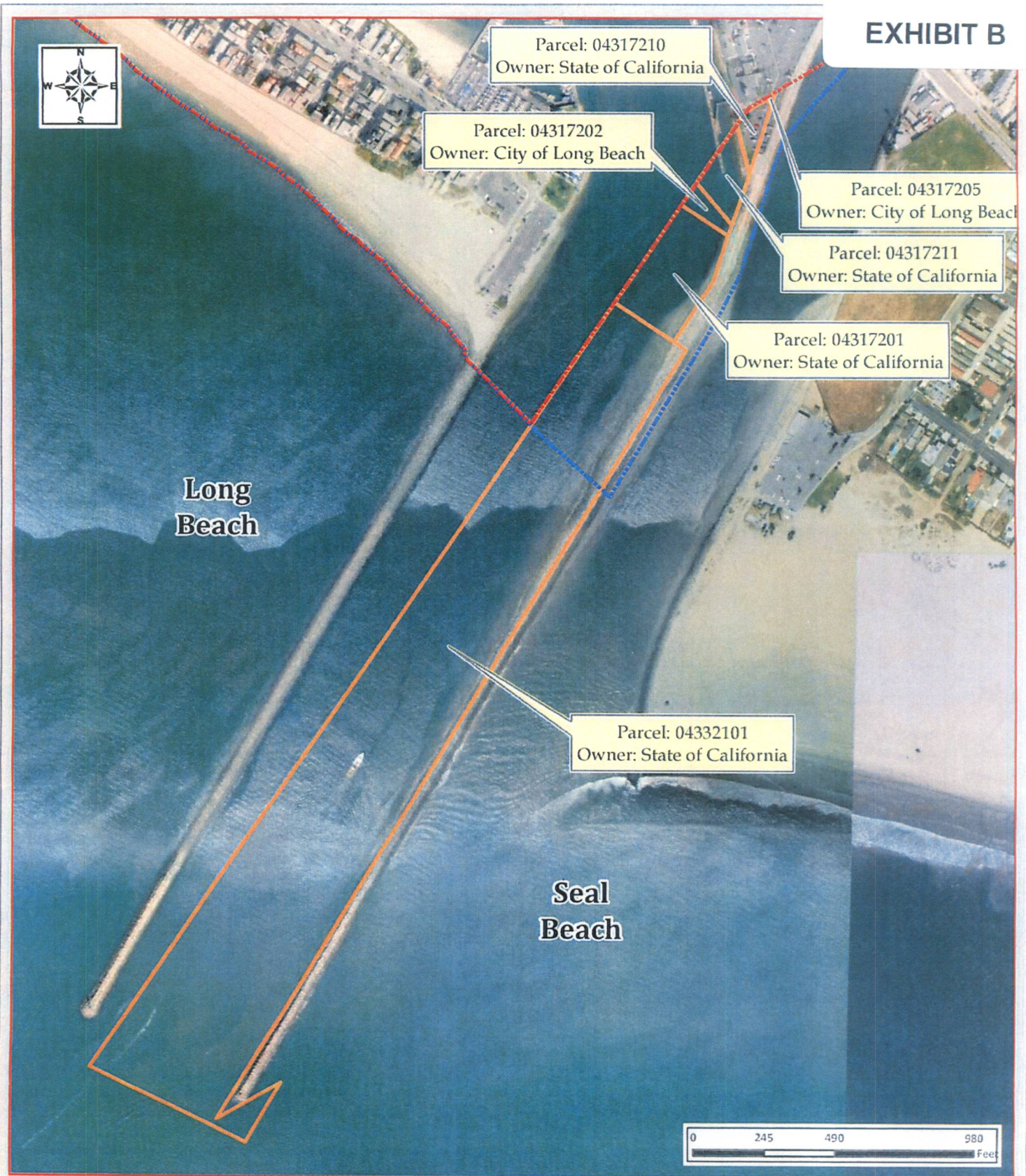

County Boundary Adjustment - Area 1

*From Orange to Los Angeles County
Detachment from Seal Beach & Annexation to Long Beach*

Legend	
	Existing Boundary
	Proposed Boundary
	Area 1 Parcels



Long
Beach

Area 2
1.05 Acres

Seal
Beach

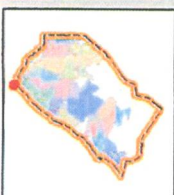
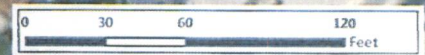

Los Angeles & Orange Counties Boundary Adjustment Areas Area 2

Legend	
	Existing Boundary
	Proposed Boundary
	Boundary Adjustment Area

Aerial imagery courtesy of Bing maps; data courtesy of the City of Long Beach and Orange County LAFCO.

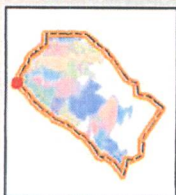

Los Angeles & Orange Counties Boundary Adjustment Areas Area 3

Legend

- Existing Boundary
- Proposed Boundary
- Boundary Adjustment Area

Aerial imagery courtesy of Bing maps; data courtesy of the City of Long Beach and Orange County LAFCO



Los Angeles & Orange Counties Boundary Adjustment Areas Area 4

Legend	
	Existing Boundary
	Proposed Boundary
	Boundary Adjustment Area

Aerial imagery courtesy of Bing maps; data courtesy of the City of Long Beach and Orange County LAFCO

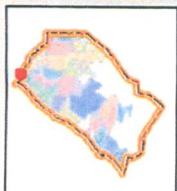

Los Angeles & Orange Counties Boundary Adjustment Areas Area 5

Legend	
	Existing Boundary
	Proposed Boundary
	Boundary Adjustment Area

Aerial imagery courtesy of Bing maps; data courtesy of the City of Long Beach and Orange County LAFCO

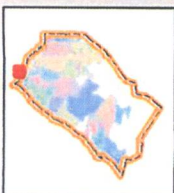

Los Angeles & Orange Counties Boundary Adjustment Areas

Area 6

NOT APPROVED BY LONG BEACH CITY COUNCIL ON 4/5/11

Aerial imagery courtesy of Bing maps; data courtesy of the City of Long Beach and Orange County LAFCO

Legend

- Existing Boundary
- Proposed Boundary
- Boundary Adjustment Area



Los Angeles & Orange Counties Boundary Adjustment Areas Area 7

Legend

- Existing Boundary
- Proposed Boundary
- Boundary Adjustment Area

Aerial imagery courtesy of Bing maps; data courtesy of the City of Long Beach and Orange County LAFCO