

NOTE: HVAC SYSTEM INSTALLERS SHALL BE TRAINED AND CERTIFIED IN THE PROPER INSTALLATION OF HVAC SYSTEMS. (702.1)

NOTE: SPECIAL INSPECTORS SHALL BE QUALIFIED AND ABLE TO DEMONSTRATE COMPETENCE IN THE DISCIPLINE THEY ARE INSPECTING. (702.2)

NOTE: CONSTRUCTION DOCUMENTS, PLANS, SPECIFICATIONS OF BUILDER OR INSTALLER CERTIFICATION, INSPECTION REPORTS, OR OTHER METHODS ACCEPTABLE TO BUILDING BUREAU ARE REQUIRED TO BE SUBMITTED TO CITY INSPECTORS FOR VERIFICATION AND COMPLIANCE AT THE TIME OF FINAL INSPECTION. (703.1)

NOTE: CONTRACTORS SHALL COMPLETE THE FOLLOWING DOCUMENTS AND PROVIDE THEM TO THE CITY INSPECTOR AT THE TIME OF FINAL INSPECTION, INSTALLATION CERTIFICATES FOR VOC CONTENT VERIFICATION CHECKLIST FORM GRN-02 AND FORMALDEHYDE EMISSIONS VERIFICATION CHECKLIST FORM GRN-03. PRODUCTION INFORMATION SHEETS AND DECLARATION STATEMENTS FOR ADHESIVE, SEALANTS AND CAULKS; PAINTS AND COATINGS; FINISH FLOORING MATERIALS; AND COMPOSITE WOOD PRODUCTS.

NOTE: ANNULAR SPACES AROUND PIPES, ELECTRICAL CABLES, CONDUITS OR OTHER OPENINGS IN SOLE/BOTTOM PLATES AT EXTERIOR WALLS SHALL BE CLOSED WITH CEMENT MORTAR, CONCRETE MASONRY, OR A SIMILAR METHOD ACCEPTABLE TO THE ENFORCING AGENCY TO PREVENT THE PASSAGE OF RODENTS.

NOTE: THIS PROJECT IS REQUIRED TO DIVERT A MINIMUM OF 65% OF RECYCLABLE CONSTRUCTION WASTE PER THE CONSTRUCTION AND DEMOLITION MANAGEMENT PLAN. WITHIN 30 DAYS AFTER RECEIPT OF CERTIFICATE OF OCCUPANCY, FINAL INSPECTION, OR THE COMPLETION OF DEMOLITION, THE FINAL COMPLIANCE REPORT MUST BE SIGNED AND SUBMITTED WITH THE FOLLOWING INFORMATION:

1. PROOF THAT C&D MATERIALS WERE TAKEN TO A CERTIFIED DIVERSION FACILITY THAT PROCESSES AND RECYCLES MIXED DEBRIS.
2. RECYCLING RECEIPTS INDICATING THE ORIGIN OF RECYCLED MATERIAL, TONNAGE OR QUANTITY RECYCLED/DIVERTED AND MATERIAL TYPES.
3. THE WASTE FACILITIES MUST BE TOLD THAT THE RECEIPTS "SHALL INDICATE THAT THE MATERIAL IS BEING RECYCLED".

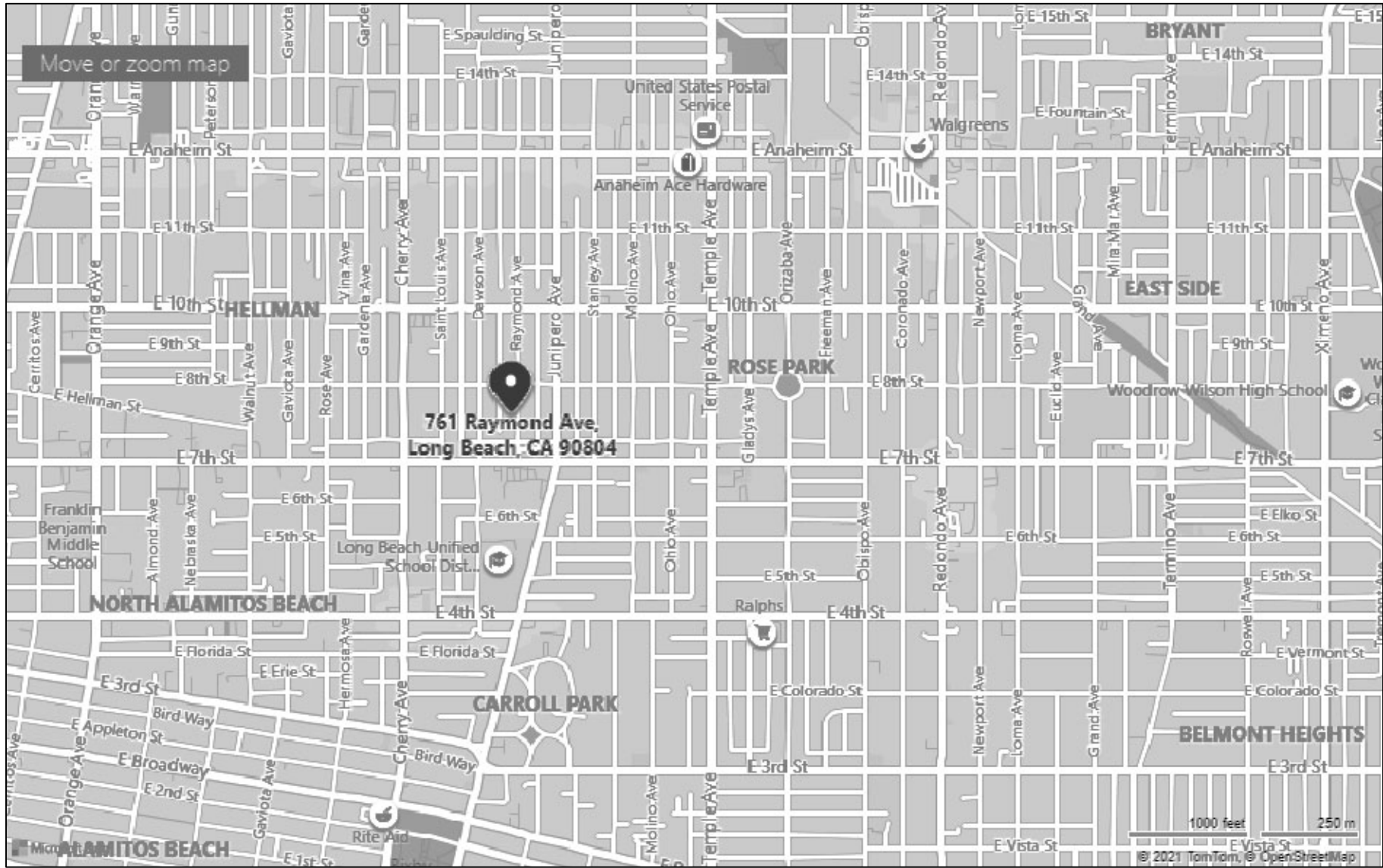

VICINITY MAP

1. ALL CONSTRUCTION AND WORKMANSHIP SHALL CONFORM TO THE 2019 CBC. NOTE ALL REFERENCES ON PLANS TO THE SECTIONS AND TABLES WITHIN THE LATEST BUILDING CODE.
2. THESE NOTES SHALL BE USED IN CONJUNCTION WITH THE PLANS AND ANY DISCREPANCIES SHALL BE BROUGHT TO THE ATTENTION OF THE ENGINEER OF RECORD.
3. CONTRACTOR IS RESPONSIBLE TO CHECK DIMENSIONS, FRAMING CONDITIONS, AND SITE CONDITIONS PRIOR TO STARTING WORK. ENGINEER SHALL BE NOTIFIED IMMEDIATELY OF ANY DISCREPANCIES OR POSSIBLE DEFICIENCIES.
4. CONDITIONS NOT SPECIFICALLY DETAILED SHALL BE CONSTRUCTED AS SPECIFIED IN TYPICAL DETAILS FOR THE RESPECTIVE MATERIALS.
5. DRAWINGS AND SPECIFICATIONS REPRESENT THE FINISH STRUCTURE. ALL BRACING, TEMPORARY SHORING, ETC. ARE THE SOLE RESPONSIBILITY OF THE CONTRACTOR. OBSERVATION VISITS BY THE ARCHITECT OR ENGINEER DO NOT INCLUDE INSPECTION OF CONSTRUCTION PROCEDURES. THE CONTRACTOR IS SOLELY RESPONSIBLE FOR ALL CONSTRUCTION METHODS AND FOR THE SAFETY AT THE WORKSITE.
6. SEE ARCHITECTURAL, MECHANICAL, AND ELECTRICAL DRAWINGS FOR SLAB DEPRESSIONS, ROOF OPENINGS, TRENCHES, SOFFITS, ETC. NOT SHOWN ON STRUCTURAL DRAWINGS. ANY AMBIGUOUS DISCREPANCIES AMONGST THESE DRAWINGS SHALL BE BROUGHT TO THE ATTENTION OF THE ARCHITECT AND ENGINEER.
7. CONTRACTOR SHALL INVESTIGATE JOB SITE DURING EARTHWORK OPERATIONS AND NOTIFY ENGINEER OF ANY CESSPOOLS, CISTERNS, BURIED FOUNDATION, ETC. ARE FOUND.
8. TEMPORARY LOADING OF MEMBERS SHALL BE SPREAD OUT UNIFORMLY AS TO NOT EXCEED THE SPECIFIED DESIGN LIVE LOAD PER SQUARE FOOT.
9. DRAWINGS AND CALCULATIONS THAT ARE NOT SEALED WITH A "WET SIGNATURE" SHALL NOT BE USED FOR CONSTRUCTION DOCUMENTS.
10. THE SLAB ON GRADE IS A NON-STRUCTURAL ITEM AND THEREFORE HAS NOT BEEN DESIGNED BY THE STRUCTURAL DESIGN ENGINEER. ISSUES RELATING TO MOISTURE MIGRATION, CRACKING, AND DIFFERENTIAL SETTLEMENT OF THE SLAB ON GRADE HAS NOT BEEN ADDRESSED BY THE ENGINEER. OWNER AND CONTRACTOR ASSUME FULL RESPONSIBILITY FOR ITEMS RELATING TO SLAB ON GRADE.

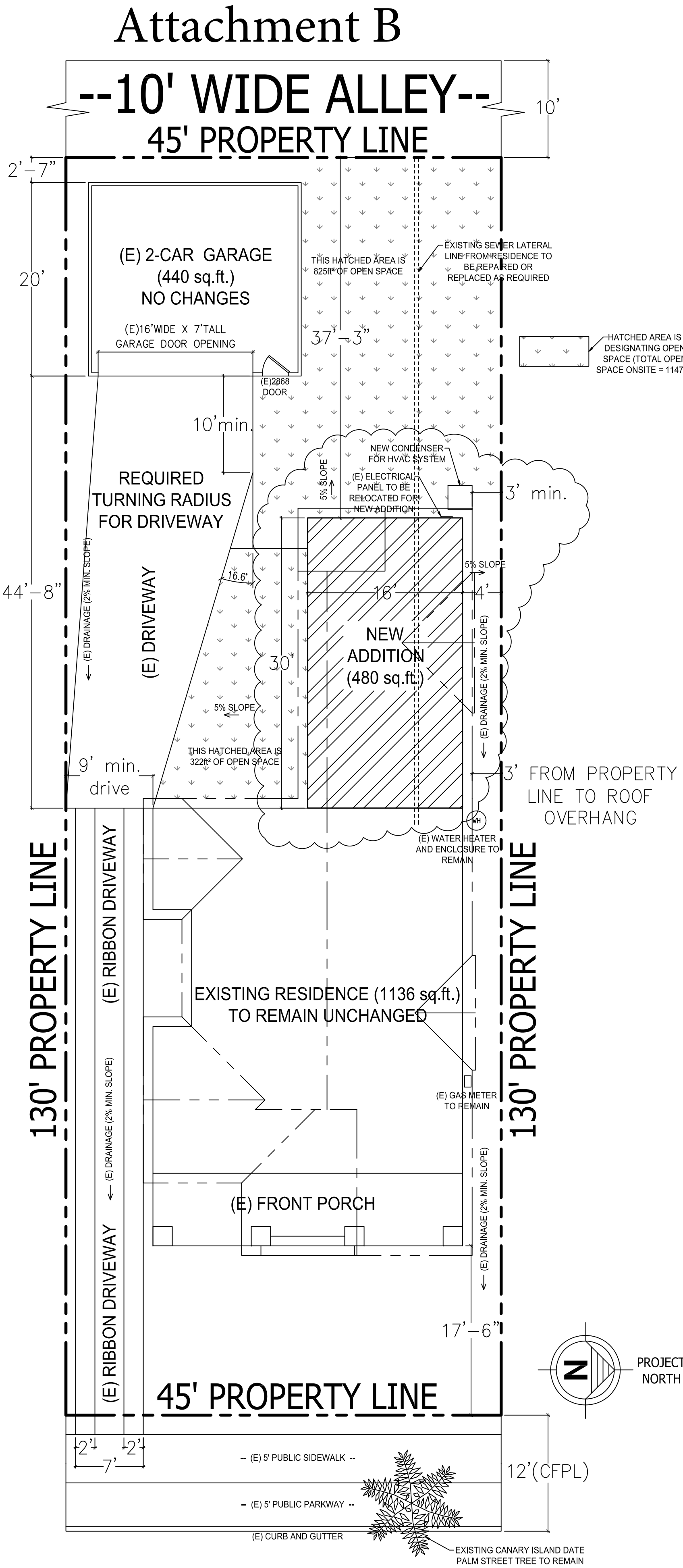

-- RAYMOND AVE. -- SITE PLAN

SCALE: 1/8" = 1'-0"

NOTE: SMOKE ALARMS SHALL BE TESTED AND MAINTAINED IN ACCORDANCE WITH THE MANUFACTURER'S INSTRUCTIONS. SMOKE ALARMS THAT NO LONGER FUNCTION SHALL BE REPLACED. SMOKE ALARMS INSTALLED IN DWELLINGS SHALL BE REPLACED AFTER 10 YEARS FROM THE DATE OF MANUFACTURE MARKED ON THE UNIT, OR IF THE DATE OF MANUFACTURE CANNOT BE DETERMINED.

SHEET INDEX:

T-1	TITLE SHEET WITH SITE PLAN AND VICINITY MAP
T-2	NOTES FOR LONG BEACH
GN1	GENERAL NOTES
A-1	EXISTING AND NEW FLOOR PLANS
A-2	ROOF PLAN, SECTIONS, AND ELECTRICAL PLAN
A-3	ELEVATIONS
S-1	FOUNDATION PLAN AND FRAMING PLAN AND DETAILS
S-2	DETAILS
T24-1	TITLE-24 ENERGY CALCULATIONS
T24-2	TITLE-24 ENERGY CALCULATIONS

PROJECT INFORMATION:

HARMOLA RESIDENCE ADDITION

APN = 7262-022-008 LOT#31 TRACT:EJ BRADY

OCCUPANCY TYPE: R-3/U

CONSTRUCTION TYPE: VB (NON-SPRINKLERED BUILDING)

EXISTING FLOOR PLAN = 1136 sq.ft.

PROPOSED NEW ADDED SQUARE FOOTAGE = 480 sq.ft.

EXISTING DETACHED 2-CAR GARAGE = 440 sq.ft. (NO CHANGES)

LOT SIZE = 5850sq.ft. LOT COVERAGE= $\frac{1616}{5850}=28\%$ OPEN SPACE= $\frac{1147}{5850}=20\%$

SCOPE OF WORK:

- NEW ADDITION(480R²) FOR NEW MASTER SUITE AND LAUNDRY ROOM.
- EXISTING HEATER TO BE REMOVED AND REPLACED WITH NEW ATTIC MOUNTED HVAC UNIT WITH ALL NEW DUCTING THROUGHOUT THE EXISTING RESIDENCE AND NEW ADDITION WITH NEW EXTERIOR GROUND MOUNTED CONDENSER.
- RELOCATE ELECTRICAL PANEL FOR NEW ADDITION.
- EXISTING SEWER LATERAL LINE FROM RESIDENCE TO BE REPAIRED OR REPLACED AS REQUIRED.

GOVERNING CODES:

2019 CALIFORNIA BUILDING CODE
2019 CALIFORNIA RESIDENTIAL CODE
2019 CALIFORNIA MECHANICAL CODE
2019 CALIFORNIA PLUMBING CODE
2019 CALIFORNIA ELECTRICAL CODE
2019 CALIFORNIA ENERGY REGULATIONS T-24
2019 CALIFORNIA GREEN BUILDING STANDARDS CODE
CITY OF LONG BEACH MUNICIPAL CODE TITLE 18

DESIGN LOADS:

ROOF LOAD:
LL = 20 psf DL = 16 psf
FLOOR LOAD:
LL = 40 psf DL = 15 psf
EXTERIOR WALL LOAD:
DL = 11 psf
INTERIOR WALL LOAD:
DL = 6 psf

ENGINEERING:

1. MAPPED SPECTRAL RESPONSE ACCELERATIONS
Ss = 1.603
S1 = 0.581
2. SPECTRAL RESPONSE COEFFICIENTS
Sds = 1.282
Sd1 = 0.666
3. SEISMIC IMPORTANCE FACTOR = 1 SEISMIC OCCUPANCY TYPE = R
4. SITE CLASS = D
5. SEISMIC DESIGN CATEGORY = D
6. BASIC SEISMIC-FORCE RESISTING SYSTEM = LIGHT FRAME WALLS
7. DESIGN BASE SHEAR = 0.1583 x W
8. R = 6.5
9. RISK CATEGORY = II
10. ANALYSIS METHOD = PER ASCE7-16 12.14
11. FLOOD LOADS DO NOT APPLY
12. WIND LOAD: Vult = 110mph EXPOSURE:B I = 1.0
13. INTERNAL PRESSURE COEFFICIENT(Gcpl) = ±0.18
14. COMPONENTS AND CLADDING PRESSURE = +2.8psf -6.6psf
15. ASSUMED SOIL BEARING PRESSURE = 1000 PSF

SPECIAL INSPECTIONS:

NO SPECIAL INSPECTIONS REQUIRED FOR THIS PROJECT

THESE PLANS ARE NOT TO BE USED FOR CONSTRUCTION UNLESS THEY HAVE BEEN STAMPED AS APPROVED BY THE BUILDING DEPARTMENT AND THERE IS A WET SIGNATURE ACROSS ENGINEERS STAMP. THESE PLANS ARE NOT TO BE REPRODUCED WITHOUT PERMISSION BY ARMSTRONG ENGINEERING & DRAFTING INC.

TITLE SHEET

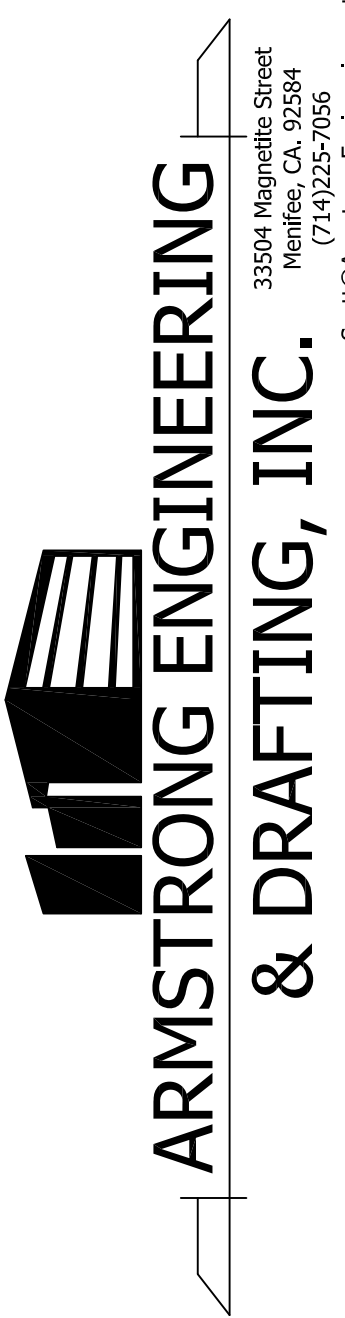

HARMOLA RESIDENCE ADDITION
761 RAYMOND AVENUE
LONG BEACH, CA. 90804



PLOT/SIGN DATE:	08/08/2021
SCALE:	AS NOTED
JOB #:	2021-007
REVISION:	#
SHEET #:	T-1

NOTE: DUCT OPENINGS AND OTHER RELATED AIR DISTRIBUTION COMPONENT OPENINGS SHALL BE COVERED DURING CONSTRUCTION (4.504.1)

NOTE: WHERE RESILIENT FLOORING IS INSTALLED, AT LEAST 80% OF FLOOR AREA SHALL COMPLY WITH ONE OR MORE OF THE FOLLOWING: (4.504.4), CHPS LOW-EMITTING MATERIAL IN THE COLLABORATIVE FOR HIGH PERFORMANCE SCHOOLS (CHPS) HIGH PERFORMANCE PRODUCTS DATABASE, CERTIFIED UNDER UL GREENGUARD GOLD, CERTIFIED UNDER THE RESILIENT FLOOR COVERING INSTITUTE (RFC) FLOORSORE PROGRAM AND MEET THE CALIFORNIA DEPARTMENT OF PUBLIC HEALTH STANDARD METHOD FOR THE TESTING AND EVALUATION OF VOLATILE ORGANIC CHEMICAL EMISSIONS FROM INDOOR SOURCES USING ENVIRONMENTAL CHAMBERS.

NOTE: HARDWOOD PLYWOOD, PARTICLEBOARD AND MEDIUM DENSITY FIBERBOARD COMPOSITE WOOD PRODUCTS USED ON THE INTERIOR OR EXTERIOR OF THE BUILDING, SHALL MEET THE REQUIREMENTS FOR FORMALDEHYDE AS SPECIFIED IN ARB'S AIR TOXIC CONTROL MEASURE FOR COMPOSITE WOOD. (4.504.5)

NOTE: MOISTURE CONTENT OF BUILDING MATERIALS USED IN WALLS AND FLOOR FRAMINGS SHALL BE CHECKED AND VERIFIED TO BE LESS THAT 19% BEFORE ENCLOSURE. (4.505.3)

NOTE: EACH BATHROOM SHALL BE MECHANICALLY VENTILATED AND SHALL COMPLY WITH THE FOLLOWING: (4.506.1), FANS SHALL BE ENERGY STAR COMPLIANT AND SHALL BE DUCTED TO TERMINATE OUTSIDE THE BUILDING. FANS MUST BE CONTROLLED BY A HUMIDITY CONTROL.

NOTE: USE THE FOLLOWING METHODS TO SIZE DUCT SYSTEMS AND SELECT EQUIPMENT: (4.507.2), ESTABLISH HEAT LOSS AND HEAT GAIN VALUES ACCORDING TO ANSY/ACCA 2 MANUAL J-2011 OR EQUIVALENT. SIZE DUCT SYSTEMS ACCORDING TO ANSY/ACCA 1 MANUAL D-2014 OR EQUIVALENT. SELECT HEATING AND COOLING EQUIPMENT ACCORDING TO ANSY/ACCA 3 MANUAL S-2014 (MANUAL S) OR EQUIVALENT.

SHOWER COMPARTMENT SHALL NOT BE LESS THAN 1024 SQUARE INCHES AND ALSO BE CAPABLE OF ENCOMPASSING A 30" DIAMETER CIRCLE. SHOWER COMPARTMENT SHALL BE FINISHED WITH A SMOOTH, NONABSORBENT SURFACE TO A HEIGHT NOT LESS THAN 6 FEET ABOVE FLOOR. CEMENT, FIBER-CEMENT, FIBER-MAT REINFORCED CEMENT, GLASS MATT GYPSUM, OR FIBER-REINFORCED GYPSUM BACKERS SHALL BE USED AS A BASE FOR WALL TILE IN SHOWER AND WALL AND CEILING PANELS IN SHOWER. SHOWER DOOR SHALL BE TEMPERED GLASS.

NOTE: ALL NEW WINDOWS AND DOORS SHALL BE INSTALLED PER MANUFACTURER'S SPECIFICATIONS. NEW WINDOWS AND DOORS WITH GLAZING SHALL MEET THE FOLLOWING CRITERIA:
DUAL-GLAZE LOW-E GLASS WITH:
U-FACTOR = 0.3 MAXIMUM
SHGC = 0.3 MAXIMUM
REFER TO TITLE-24 ENERGY CALCULATIONS FOR ADDITIONAL INFORMATION NOTE SHOWN HERE.

NOTE: EGRESS REQUIREMENTS FOR EXTERIOR WINDOWS WITHIN SLEEPING UNITS SHALL COMPLY AS FOLLOWS:
BOTTOM OF THE CLEAR OPENING SHALL NOT BE GREATER THAN 44" ABOVE THE FLOOR
MINIMUM NET CLEAR OPENING OF 5 square feet (AT FIRST FLOOR EGRESS WINDOWS)
MINIMUM NET CLEAR OPENING OF 5.7 square feet (AT SECOND FLOOR EGRESS WINDOWS)
MINIMUM NET CLEAR OPENING HEIGHT = 24"
MINIMUM NET CLEAR OPENING WIDTH = 20"
EGRESS WINDOWS SHALL OPEN DIRECTLY INTO A PUBLIC WAY, OR TO A YARD OR COURT THAT OPENS TO A PUBLIC WAY.

NOTE: APPROVED SAFETY GLAZING(TEMPERED) SHALL BE INSTALLED IN ALL WINDOWS WITH FIXED OR OPERABLE PANELS WHICH ARE ADJACENT TO A DOOR WHERE THE NEAREST EXPOSED EDGE OF THE GLAZING IS WITHIN A 24 INCH ARC OF EITHER VERTICAL EDGE OF THE DOOR IN A CLOSED POSITION AND WHERE THE BOTTOM EXPOSED EDGE OF THE GLAZING IS LESS THAN 60 INCHES ABOVE THE WALKING SURFACE.

KITCHEN FAUCETS SHALL HAVE A MAXIMUM FLOW RATE OF 1.8 GALLONS PER MINUTE AT 60 psi. FAUCETS MAY TEMPORARILY INCREASE THE FLOW ABOVE THE MAXIMUM RATE, BUT NOT TO EXCEED 2.2 GALLONS PER MINUTE AT 60 psi, AND MUST DEFAULT TO A MAXIMUM FLOW RATE OF 1.8 GALLONS PER MINUTE AT 60 psi.

WHEN A SHOWER IS SERVED BY MORE THAN ONE SHOWERHEAD, THE COMBINED FLOW RATE OF ALL SHOWERHEADS AND/OR OTHER SHOWER OUTLETS CONTROLLED BY A SINGLE VALVE SHALL NOT EXCEED 1.8 GALLONS PER MINUTE AT 80 psi, OR THE SHOWER SHALL BE DESIGNED TO ALLOW ONLY ONE SHOWER OUTLET TO BE IN OPERATION AT A TIME. (A HAND-HELD SHOWER IS TO BE CONSIDERED A SHOWERHEAD FOR PURPOSES OF THIS PROVISION.

SHOWERS AND TUB-SHOWER COMBINATIONS SHALL BE PROVIDED WITH INDIVIDUAL CONTROL VALVES OR THE PRESSURE BALANCE, THERMOSTATIC, OR COMBINATION PRESSURE BALANCE/THERMOSTATIC MIXING VALVE TYPE THAT PROVIDE SCALD AND THERMAL SHOCK PROTECTION FOR THE RATED FLOW RATE OF THE INSTALLED SHOWERHEAD. THESE VALVES SHALL CONFORM TO ASSE 1016 OR ASME A112.18.1/CSA B125.1. HANDLE POSITION STOPS SHALL BE PROVIDED ON SUCH VALVES AND SHALL BE ADJUSTED PER THE MANUFACTURER'S INSTRUCTIONS TO DELIVER A MAXIMUM MIXED WATER SETTING OF 120°F. WATER HEATER THERMOSTATS SHALL NOT BE CONSIDERED A SUITABLE CONTROL FOR MEETING THIS PROVISION. (CPC 408.3).

ALL PLUMBING FIXTURES WITHIN THE RESIDENCE IDENTIFIED IN THE FOLLOWING SCHEDULE SHALL COMPLY WITH THE MAXIMUM FLOW RATES SHOWN:

FIXTURE TYPE	MAXIMUM FLOW RATE
SHOWER HEAD	1.8 GPM @ 80psi
KITCHEN FAUCET	1.8 GPM @ 60psi
LAVATORY FAUCET	1.2 GPM @ 60psi
WATER CLOSET	1.28 GALLONS PER FLUSH

DOOR SCHEDULE

MARK	DOOR SIZE			NOTES
	WD	HGT	THK	
1	3'-6"	6'-8"	1 3/4"	EXISTING ENTRY DOOR TO REMAIN
2	2'-8"	6'-8"	1 3/4"	EXISTING EXTERIOR DOOR TO REMAIN
4	8'-0"	7'-8"	1 1/4"	NEW WOOD ACCORDION DOOR WITH TEMPERED GLASS WITH HEADER AT 7'-10" OR AS REQUIRED PER DOOR MANUFACTURER
5	2'-8"	6'-8"	1 3/4"	NEW DOOR WITH TEMPERED GLASS INSERT
6	2'-8"	6'-8"	NA	EXISTING DOOR TO BECOME NEW CASSED DOOR OPENING
7	2'-8"	6'-8"	1 3/8"	NEW BARN DOOR
8	2'-6"	6'-8"	1 3/4"	NEW INTERIOR DOOR
9	2'-6"	6'-8"	1 3/4"	NEW INTERIOR DOOR

WINDOW SCHEDULE

MARK	SIZE		NOTES
	WIDTH	HEIGHT	
2	3'-9"	4'-4"	EXISTING WINDOW TO REMAIN
3	1'-6"	4'-6"	EXISTING WINDOW TO REMAIN
4	1'-6"	4'-6"	EXISTING WINDOW TO REMAIN
5	1'-6"	4'-6"	EXISTING WINDOW TO REMAIN
6	8'-6"	4'-6"	EXISTING WINDOW TO REMAIN
7	2'-6"	2'-6"	EXISTING WINDOW TO REMAIN
8	2'-6"	2'-6"	EXISTING WINDOW TO REMAIN
9	6'-0"	4'-6"	EXISTING WINDOW TO REMAIN
10	6'-0"	4'-6"	EXISTING WINDOW TO REMAIN
11	2'-6"	4'-6"	EXISTING WINDOW TO REMAIN
12	2'-6"	4'-6"	EXISTING WINDOW TO REMAIN
13	1'-6"	3'-0"	EXISTING WINDOW TO REMAIN
14	2'-6"	3'-0"	EXISTING WINDOW TO REMAIN
15	2'-6"	4'-6"	EXISTING WINDOW TO REMAIN
16	2'-6"	4'-6"	EXISTING WINDOW TO REMAIN
17	3'-0"	4'-0"	NEW DOUBLE HUNG WINDOW
18	2'-0"	4'-0"	NEW DOUBLE HUNG WINDOW
19	2'-0"	4'-0"	NEW DOUBLE HUNG WINDOW
20	5'-0"	1'-6"	NEW TEMPERED GLASS AWNING WINDOW
21	3'-0"	4'-0"	NEW TEMPERED DOUBLE HUNG WINDOW
22	4'-0"	4'-0"	NEW TEMPERED DOUBLE HUNG WINDOW
23	8'-2"	4'-0"	NEW TEMPERED FIXED WINDOW. HEADER HEIGHT AT ±13'-3"
24	3'-0"	4'-0"	NEW TEMPERED FIXED WINDOW WITH HEADER AT ±13'-3"
25	3'-0"	7'-8"	NEW TEMPERED FIXED WINDOW WITH HEADER AT 7'-10" OR AS REQUIRED PER WINDOW MANUFACTURER

ALL NEW DOOR AND WINDOW HEADERS TO HAVE BOTTOM AT 6'-10" ABOVE THE PLYWOOD SUB-FLOOR SHEATHING UNLESS NOTED OTHERWISE OR UNLESS OTHERWISE REQUIRED BY DOOR OR WINDOW MANUFACTURER.

NOTE: NEW WINDOWS AND EXTERIOR DOORS SHALL BE MANUFACTURED BY JELD WEN AND BE OF ALL WOOD FRAME MATERIAL. WINDOWS SHALL BE JELD WEN WOOD SITELINE SERIES AND DOORS SHALL BE JELD WEN IWP WOOD 510 GLASS PANEL SERIES OR EQUIVALENT.

REFER TO TITLE-24 ENERGY CALCULATIONS FOR ADDITIONAL INFORMATION NOT SHOWN HERE

- EXISTING WALL TO REMAIN
- NEW WALL (2X6 STUDS AT 16" O.C.)
- NEW WALL (2X4 STUDS AT 16" O.C.)

REFER TO DOOR SCHEDULE FOR DOOR INFORMATION

REFER TO WINDOW SCHEDULE FOR WINDOW INFORMATION

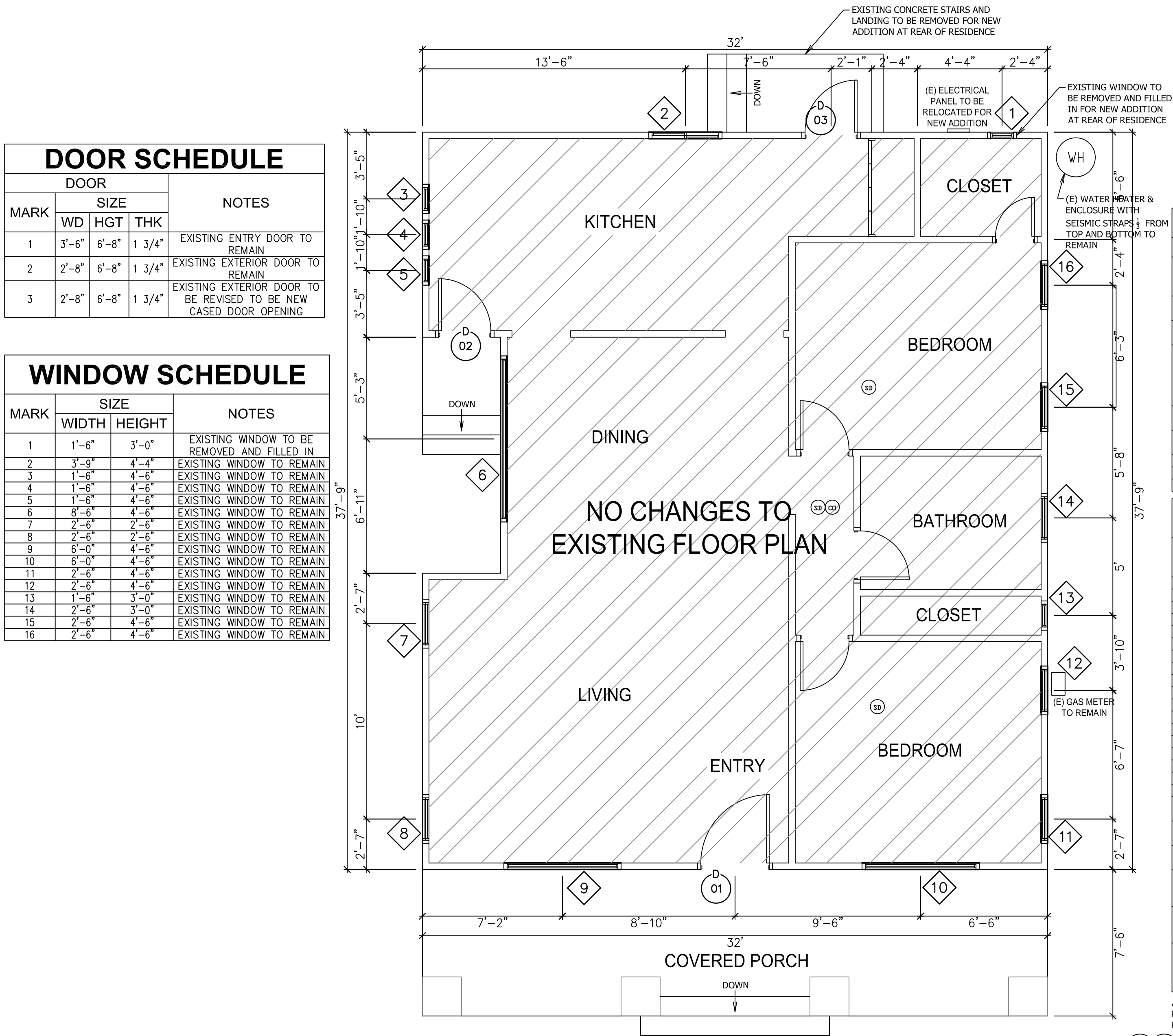
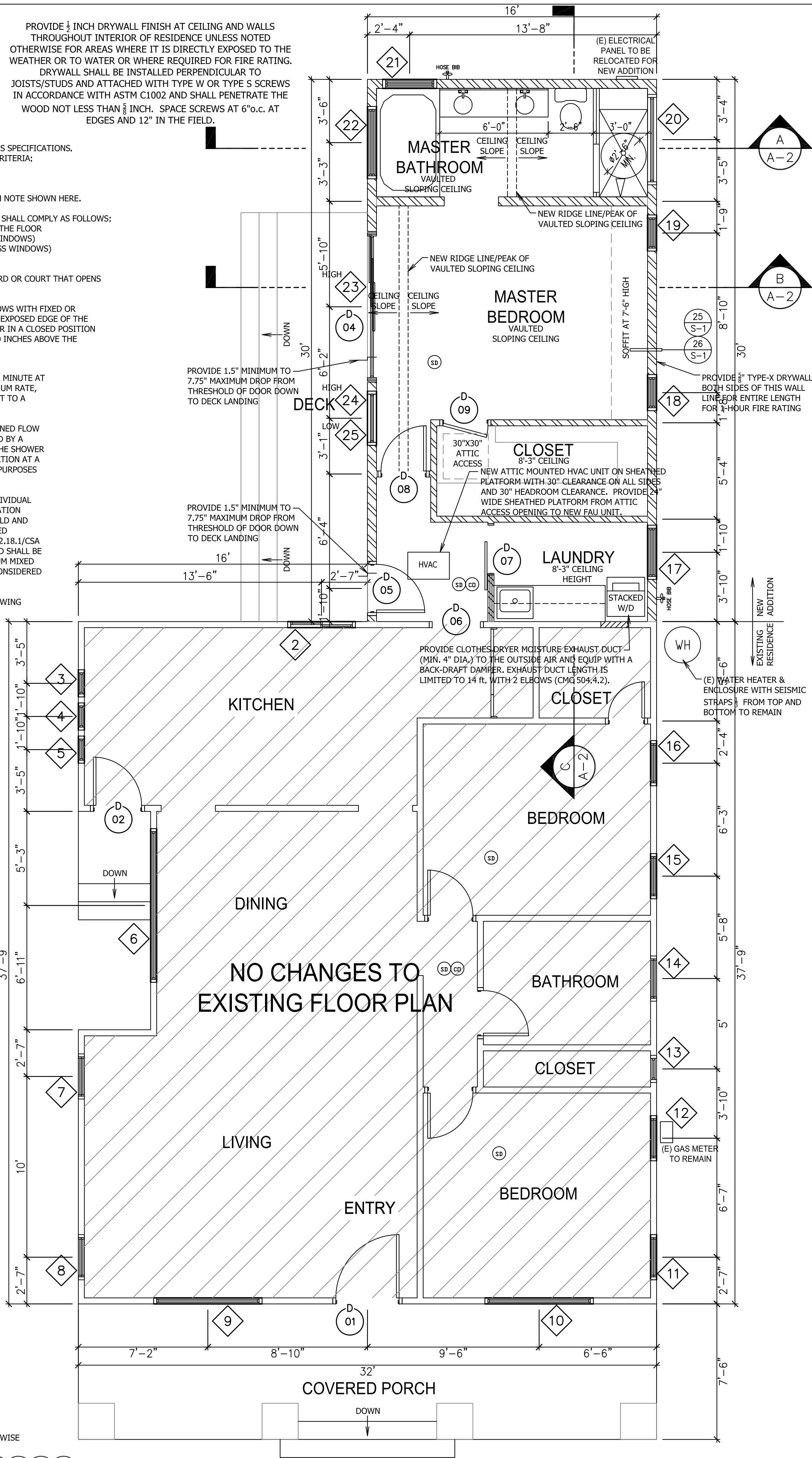

DOOR SCHEDULE				
MARK	DOOR SIZE			NOTES
	WD	HGT	THK	
1	3'-6"	6'-8"	1 3/4"	EXISTING ENTRY DOOR TO REMAIN
2	2'-8"	6'-8"	1 3/4"	EXISTING EXTERIOR DOOR TO REMAIN
3	2'-8"	6'-8"	1 3/4"	EXISTING EXTERIOR DOOR TO BE REVISED TO BE NEW CASSED DOOR OPENING

WINDOW SCHEDULE			
MARK	SIZE		NOTES
	WIDTH	HEIGHT	
1	1'-6"	3'-0"	EXISTING WINDOW TO BE REMOVED AND FILLED IN
2	3'-9"	4'-4"	EXISTING WINDOW TO REMAIN
3	1'-6"	4'-6"	EXISTING WINDOW TO REMAIN
4	1'-6"	4'-6"	EXISTING WINDOW TO REMAIN
5	1'-6"	4'-6"	EXISTING WINDOW TO REMAIN
6	8'-6"	4'-6"	EXISTING WINDOW TO REMAIN
7	2'-6"	2'-6"	EXISTING WINDOW TO REMAIN
8	2'-6"	2'-6"	EXISTING WINDOW TO REMAIN
9	6'-0"	4'-6"	EXISTING WINDOW TO REMAIN
10	6'-0"	4'-6"	EXISTING WINDOW TO REMAIN
11	2'-6"	4'-6"	EXISTING WINDOW TO REMAIN
12	2'-6"	4'-6"	EXISTING WINDOW TO REMAIN
13	1'-6"	3'-0"	EXISTING WINDOW TO REMAIN
14	2'-6"	3'-0"	EXISTING WINDOW TO REMAIN
15	2'-6"	4'-6"	EXISTING WINDOW TO REMAIN
16	2'-6"	4'-6"	EXISTING WINDOW TO REMAIN

EXISTING WALL TO REMAIN

REFER TO DOOR SCHEDULE FOR DOOR INFORMATION

REFER TO WINDOW SCHEDULE FOR WINDOW INFORMATION

EXISTING FLOOR PLAN

NEW FLOOR PLAN

THESE PLANS ARE NOT TO BE USED FOR CONSTRUCTION UNLESS THEY HAVE BEEN STAMPED AS APPROVED BY THE BUILDING DEPARTMENT AND THERE IS A WET SIGNATURE ACROSS ENGINEERS STAMP. THESE PLANS ARE NOT TO BE REPRODUCED WITHOUT PERMISSION BY ARMSTRONG ENGINEERING & DRAFTING INC.

no.	REVISION	DATE



**ARMSTRONG ENGINEERING
& DRAFTING, INC.**

33504 Magnette Street
Menifee, CA. 92584
(714) 225-7056
scott@armstrongengineering.net

HARMOLA RESIDENCE ADDITION
761 RAYMOND AVENUE
LONG BEACH, CA. 90804

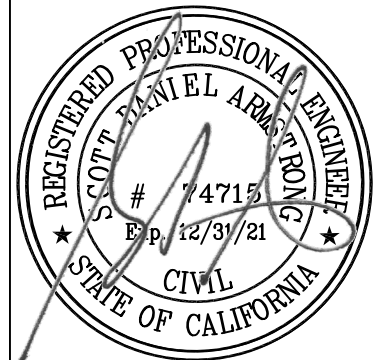

PLOT/SIGN DATE:	08/08/2021
SCALE:	1/4" = 1'-0"
JOB #:	2021-007
REVISION:	#
SHEET #:	A-1



NOTE: ALL PAINT COLORS AT NEW ADDITION TO BE FIELD VERIFIED TO MATCH EXISTING COLORS AND LOCATIONS. VERIFY PAINT COLORS: MAIN HOUSE COLOR = SW7544 FENLAND TRIM COLOR = SW7006 EXTRA WHITE



NOTE: ALL PAINT COLORS AT NEW ADDITION TO
BE FIELD VERIFIED TO MATCH EXISTING COLORS
AND LOCATIONS. VERIFY PAINT COLORS:
MAIN HOUSE COLOR = SW7544 FENLAND
TRIM COLOR = SW7006 EXTRA WHITE



NOTE: ALL PAINT COLORS AT NEW ADDITION TO
BE FIELD VERIFIED TO MATCH EXISTING COLORS
AND LOCATIONS. VERIFY PAINT COLORS:
MAIN HOUSE COLOR = SW7544 FENLAND
TRIM COLOR = SW7006 EXTRA WHITE

THESE PLANS ARE NOT TO BE USED FOR CONSTRUCTION UNLESS THEY HAVE BEEN STAMPED AND APPROVED BY THE BUILDING DEPARTMENT AND THERE IS A WET SIGNATURE ACROSS ENGINEERS STAMP. THESE PLANS ARE NOT TO BE REPRODUCED WITHOUT PERMISSION BY ARMSTRONG ENGINEERING & DRAFTING INC.

no.	REVISION	DATE

ELEVATIONS

HARMOLA RESIDENCE ADDITION

761 RAYMOND AVENUE
LONG BEACH, CA. 90804

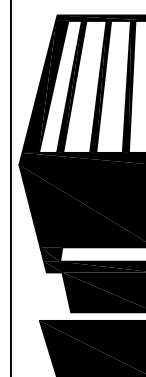

**ARMSTRONG ENGINEERING
& DRAFTING, INC.**

33504 Magnetite Street
Menifee, CA. 92584
(714)225-7056
Scott@ArmstrongEngineering.net

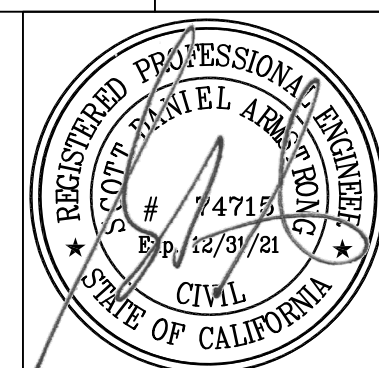

PLOT/SIGN DATE:
08/08/2021

SCALE: $1/4" = 1'-0"$

JOB #: 2021-007

REVISION: 7

SHEET #:

A-3