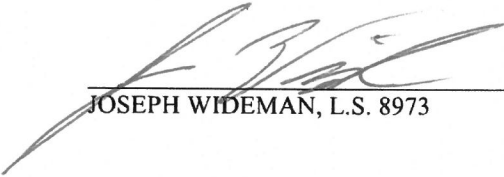


EXHIBIT "A"
LEGAL DESCRIPTION

LOTS 2, 4, 6, 8, 10, 12, 14, AND 16 IN BLOCK 40, MAP OF TOWN SITE OF LONG BEACH, AS PER MAP RECORDED IN BOOK 19, PAGES 91 THROUGH 96, INCLUSIVE, OF MISCELLANEOUS RECORDS, IN THE CITY OF LONG BEACH, COUNTY OF LOS ANGELES, STATE OF CALIFORNIA, IN THE OFFICE OF THE RECORDER FOR SAID COUNTY, TO BE HELD AS A SINGLE PARCEL OF LAND.

EXHIBIT "B": ATTACHED HERETO AND MADE A PART HEREOF.

PREPARED BY ME OR UNDER MY SUPERVISION:

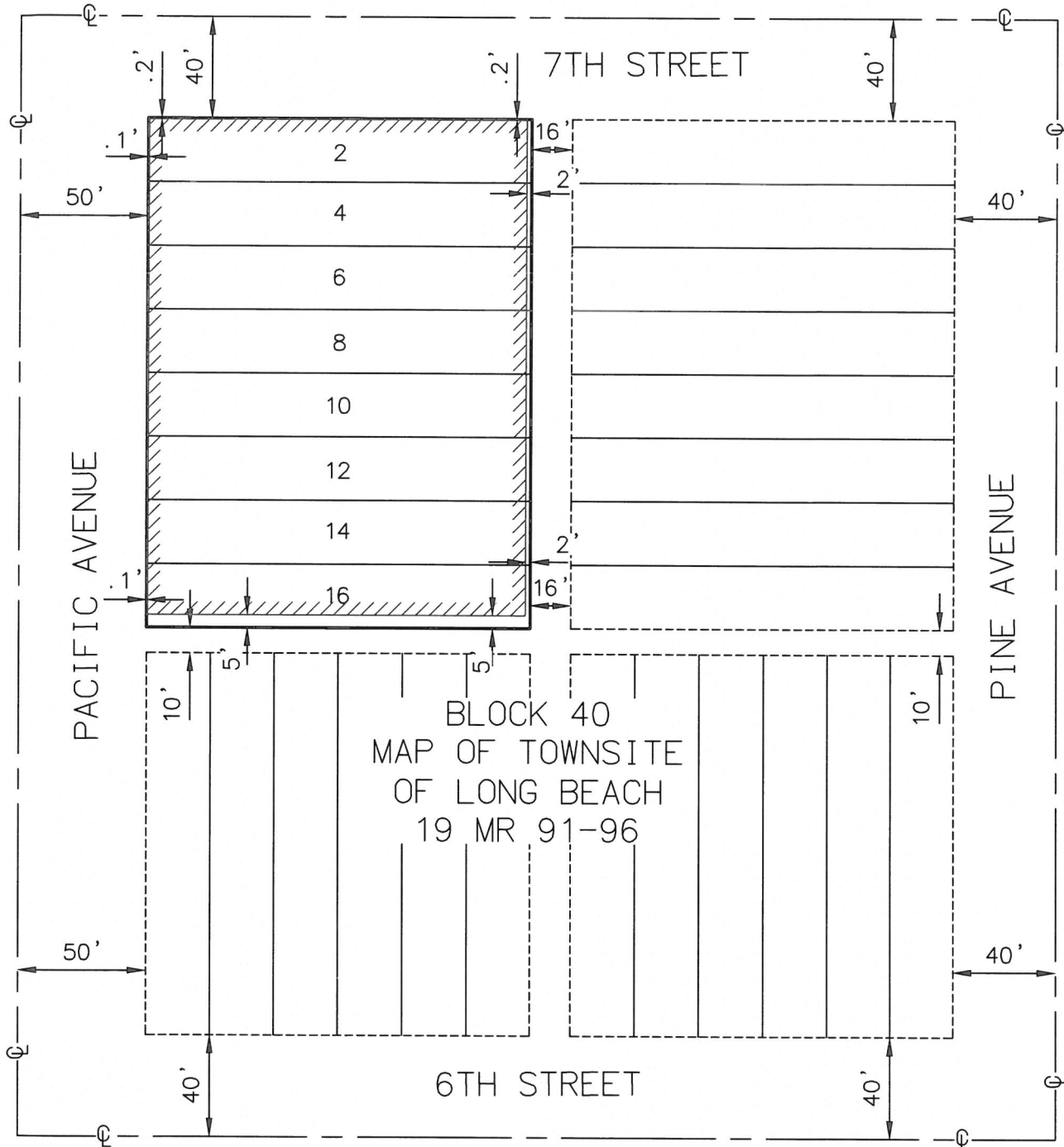


JOSEPH WIDEMAN, L.S. 8973

4-16-18
DATE

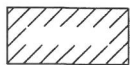


EXHIBIT "B"

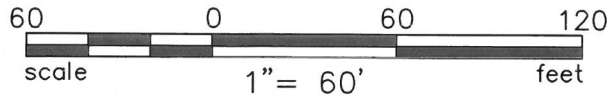


BLOCK 40
MAP OF TOWNSITE
OF LONG BEACH
19 MR 91-96

LEGEND



PROPOSED
BUILDING



**DAVID EVANS
AND ASSOCIATES INC.**
25152 SPRINGFIELD COURT, SUITE 350
SANTA CLARITA, CA 91355
Phone: 661-284-7400

Job Number:	HOLPOHAC0002
Date:	04-16-2018
Scale:	1"=60'
Sheet 2 of	2 Sheets