



Transportation &
Infrastructure Committee
October 8, 2008

COMMUNITY
LivabilityPlan

All Roads Lead Home

I-710 Corridor Neighborhoods
LONG BEACH CALIFORNIA

Introduction

Community Input

Plan Concepts

Conclusion

Project Introduction

A City of Long Beach Initiative, in the wake of the I-710 MCS
Caltrans Environmental Justice Grant

Working with neighborhoods to identify and think about solutions to
impacts from the I-710 Freeway

Strategies and designs for corridor and neighborhoods

The Plan will be implemented in short- and long-term stages, based on
funding availability



Introduction

Community Input

Plan Concepts

Conclusion

All Roads Lead Home



8-mile stretch of freeway – and LA River–
corridor

16 square mile area of City, with nearly 40%
of City population living in it

All or part of 29 neighborhoods

Neighborhoods in the I-710 corridor bear a
disproportionate share of the negative
impacts of the Ports, freeways and rail
system, and get few benefits of \$3 billion in
goods

19 parks and 24 schools are here

Should be a place for people, with a quality
of life the people in the corridor deserve

Introduction

Community Input

Plan Concepts

Conclusion

A Collaborative Effort

Public Works

Community Development

Parks, Recreation & Marine

Planning & Building

Health and Human Services

Long Beach Police Department

Long Beach Transit

Long Beach Unified School District

Port of Long Beach

Gateway Cities COG

Metro



Introduction

Community Input

Plan Concepts

Conclusion

Project Philosophy

Start with existing plans and programs

“What We’ve Heard” vs. “A Clean Slate”

Look for links among ongoing planning efforts

Focus on local community assets and physical community design issues

Project Process to Date

Spring 2007

Task 1: Project Start-up and Data Gathering
Information Gathering
Site, People, Base Data, Community Outreach

City Staff
City Council & Mayor
Community Leaders

Summer 2007

Task 2: Cultural Needs Assessment
Asset Based
Fed by Stakeholder Reps
Fueled by Neighborhood Design Workshops
Focused on Community Design

Metro, Caltrans, DOTs, SCAG, GCCOG, Schools, County, River & Open Space Advocates & Agencies

City Staff
Community Leaders
Community Participants

Fall 2007

Task 3: Community Livability Plan
Includes Entities Active in Community Design
Connections to City plans, models from other regions

City Staff
Community Leaders
Community Participants

Fall 2007 – Jan. 08

Task 4: Plan Approval
Review/Aligning Expectations
Sharing Results

Decision Makers

All Roads Lead Home

I-710 Corridor Neighborhoods
LONG BEACH CALIFORNIA

Introduction

Community Input

Plan Concepts

Conclusion

I-710 Oversight Committee
February 19, 2008

Corridor Overview



Introduction

Community Input

Plan Concepts

Conclusion

Corridor Overview



All Roads Lead Home

I-710 Corridor Neighborhoods
LONG BEACH CALIFORNIA

Introduction

Community Input

Plan Concepts

Conclusion

I-710 Oversight Committee
February 19, 2008

Corridor Overview



COMMUNITY
LivabilityPlan

All Roads Lead Home.

I-710 Corridor Neighborhoods
LONG BEACH CALIFORNIA

Introduction

Community Input

Plan Concepts

Conclusion

I-710 Oversight Committee
February 19, 2008

Corridor Overview



Introduction

Community Input

Plan Concepts

Conclusion

Corridor Overview



All Roads Lead Home

I-710 Corridor Neighborhoods
LONG BEACH CALIFORNIA

Introduction

Community Input

Plan Concepts

Conclusion

I-710 Oversight Committee
February 19, 2008

Corridor Overview



Introduction

Community Input

Plan Concepts

Conclusion

Corridor Overview



COMMUNITY
LivabilityPlan

All Roads Lead Home

I-710 Corridor Neighborhoods
LONG BEACH CALIFORNIA

Introduction

Community Input

Plan Concepts

Conclusion

I-710 Oversight Committee
February 19, 2008

RiverLink Plan



COMMUNITY LivabilityPlan

All Roads Lead Home

I-710 Corridor Neighborhoods
LONG BEACH CALIFORNIA

Introduction

Community Input

Plan Concepts

Conclusion

I-710 Oversight Committee
February 19, 2008

Community Assets

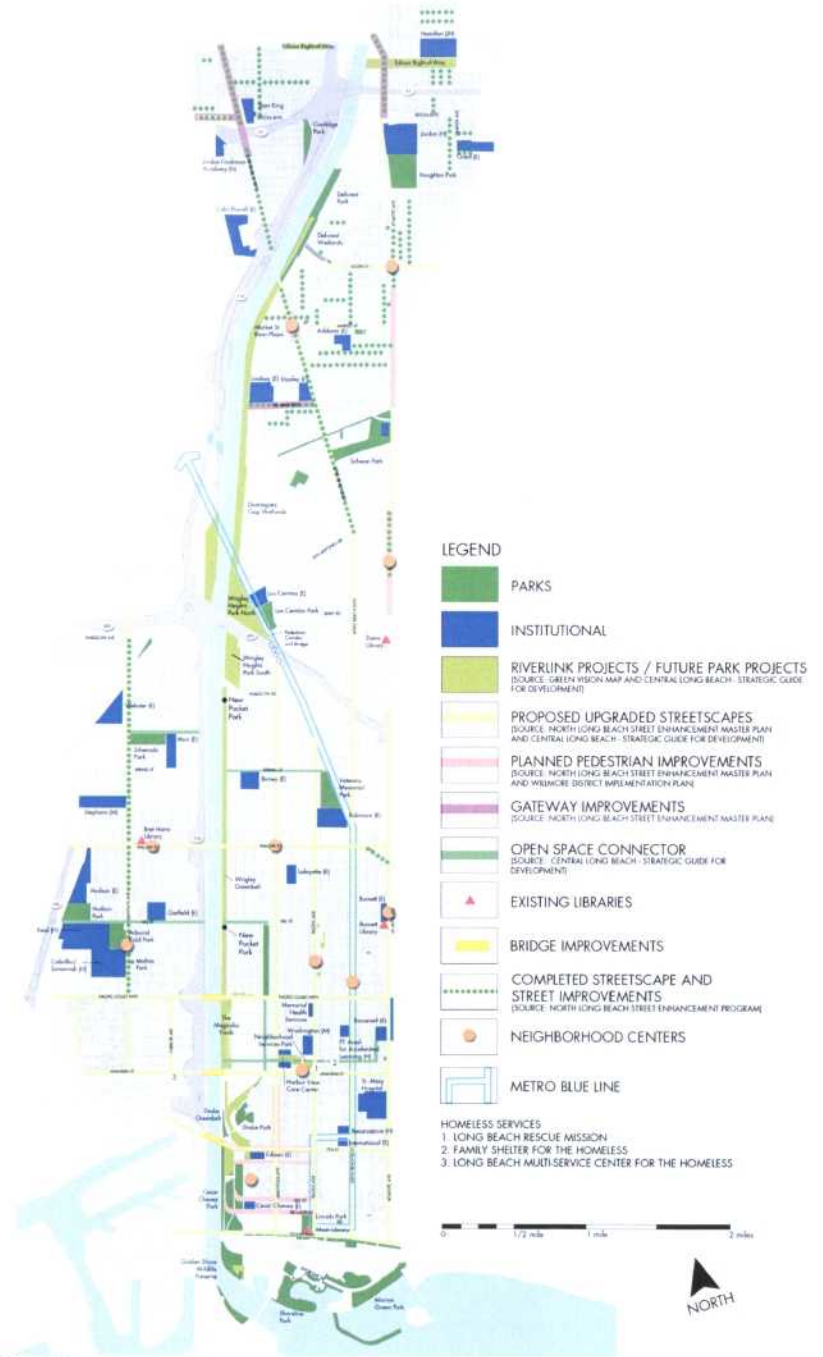

LEGEND

- PARKS
- INSTITUTIONAL
- RIVERLINK PROJECTS / FUTURE PARK PROJECTS
(SOURCE: GREEN VISION MAP AND CENTRAL LONG BEACH - STRATEGIC GUIDE FOR DEVELOPMENT)
- PROPOSED UPGRADED STREETSCAPES
(SOURCE: NORTH LONG BEACH STREET ENHANCEMENT MASTER PLAN AND CENTRAL LONG BEACH - STRATEGIC GUIDE FOR DEVELOPMENT)
- PLANNED PEDESTRIAN IMPROVEMENTS
(SOURCE: NORTH LONG BEACH STREET ENHANCEMENT MASTER PLAN AND WILMORE DISTRICT WILDMENESTATION PLAN)
- GATEWAY IMPROVEMENTS
(SOURCE: NORTH LONG BEACH STREET ENHANCEMENT MASTER PLAN)
- OPEN SPACE CONNECTOR
(SOURCE: CENTRAL LONG BEACH - STRATEGIC GUIDE FOR DEVELOPMENT)
- EXISTING LIBRARIES
- BRIDGE IMPROVEMENTS
- COMPLETED STREETSCAPE AND STREET IMPROVEMENTS
(SOURCE: NORTH LONG BEACH STREET ENHANCEMENT PROGRAM)
- NEIGHBORHOOD CENTERS
- METRO BLUE LINE

- HOMELESS SERVICES
1. LONG BEACH RESCUE MISSION
 2. FAMILY SHELTER FOR THE HOMELESS
 3. LONG BEACH MULTI-SERVICE CENTER FOR THE HOMELESS

0 1/2 mile 1 mile 2 miles



COMMUNITY ASSETS

Introduction

Community Input

Plan Concepts

Conclusion

Plan Mission

Educate the community about the complexity of the issues

Provide information about steps already being taken in the corridor, region and statewide

Make corridor-wide recommendations to tie to the I-710 Corridor Project EIR/EIS

Make neighborhood design recommendations to improve local quality of life

Introduction

Community Input

Plan Concepts

Conclusion

Community Stakeholder Input

Introduced the project in nearly 30 presentations at community group meetings throughout the corridor

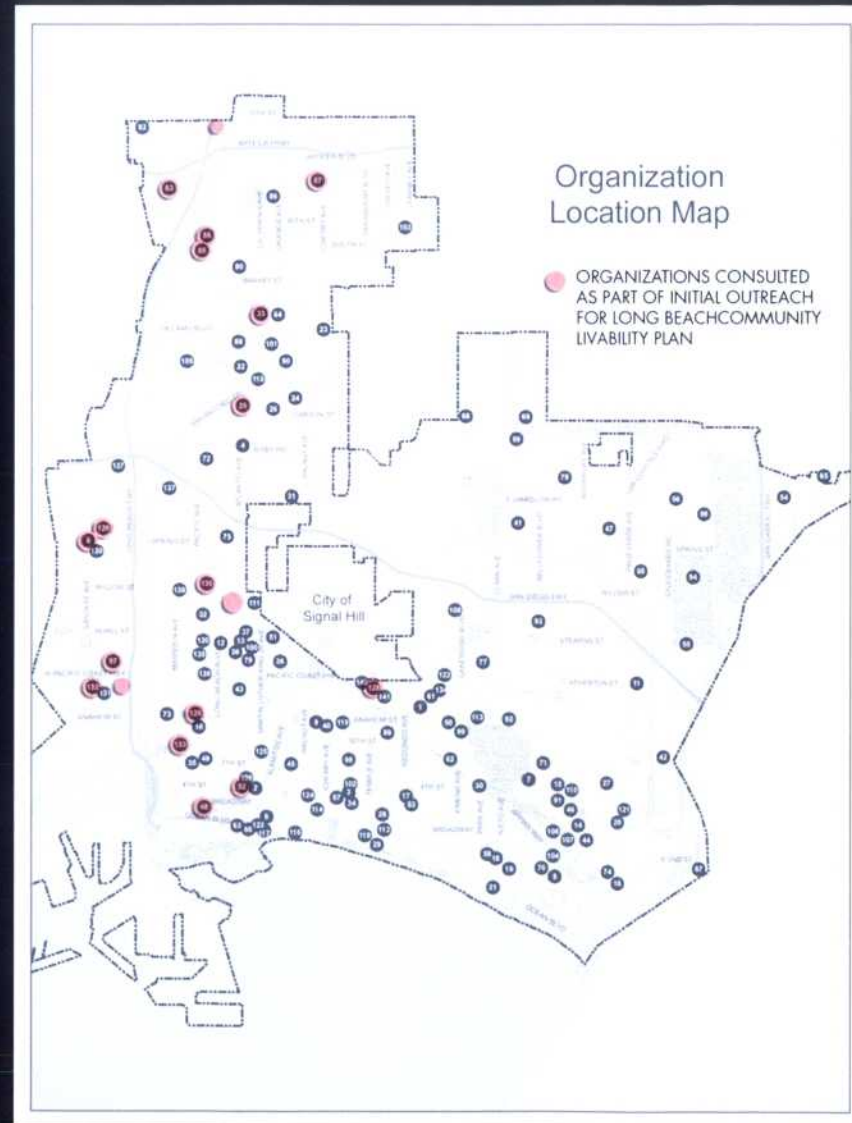

All Roads Lead Home

I-710 Corridor Neighborhoods
LONG BEACH CALIFORNIA

Introduction

Community Input

Plan Concepts

Conclusion

I-710 Oversight Committee
February 19, 2008

Corridor Subareas

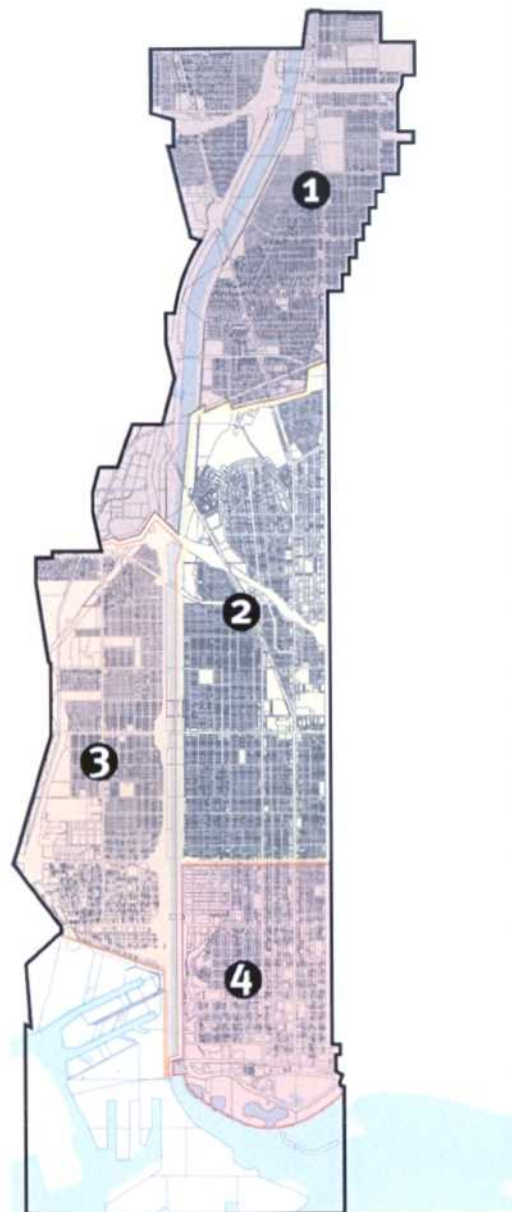

Legend

-  North Corridor
-  Central Corridor
-  West Corridor
-  South Corridor
-  Livability Plan Area

COMMUNITY LivabilityPlan

All Roads Lead Home

I-710 Corridor Neighborhoods
LONG BEACH CALIFORNIA

Introduction

Community Input

Plan Concepts

Conclusion

I-710 Oversight Committee
February 19, 2008

Community Stakeholder Input



Workshop #1 Jordan HS



Workshop #2 Cesar Chavez Park



Workshop #3 Los Cerritos Elementary



Workshop #4 Cabrillo High School

Introduction

Community Input

Plan Concepts

Conclusion

What the Community Said

Concerns About Their Neighborhood

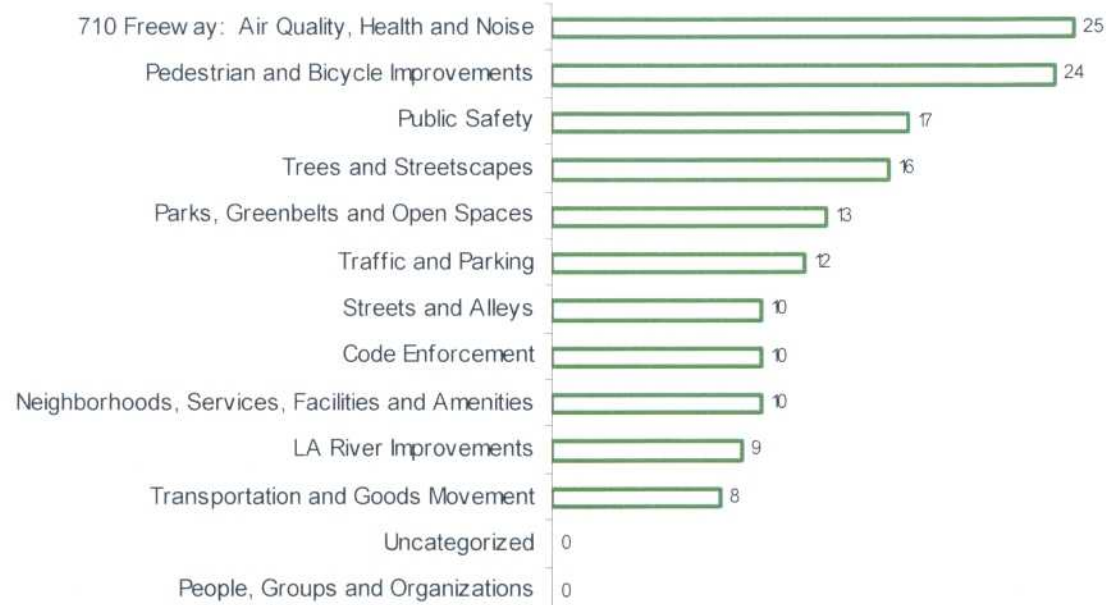

Introduction

Community Input

Plan Concepts

Conclusion

What the Community Said

Strengths Of Their Neighborhood



Introduction

Community Input

Plan Concepts

Conclusion

What the Community Said

Changes They'd Like to See in Their Neighborhood

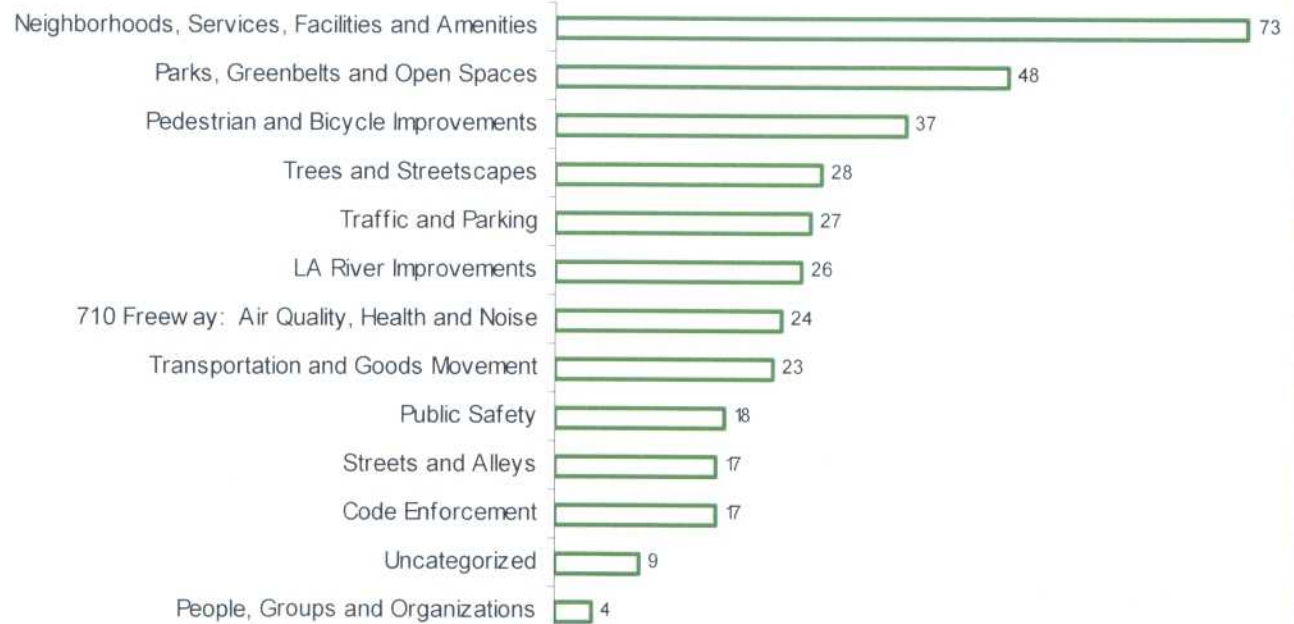

Introduction

Community Input

Plan Concepts

Conclusion

Regional and Corridor Issues

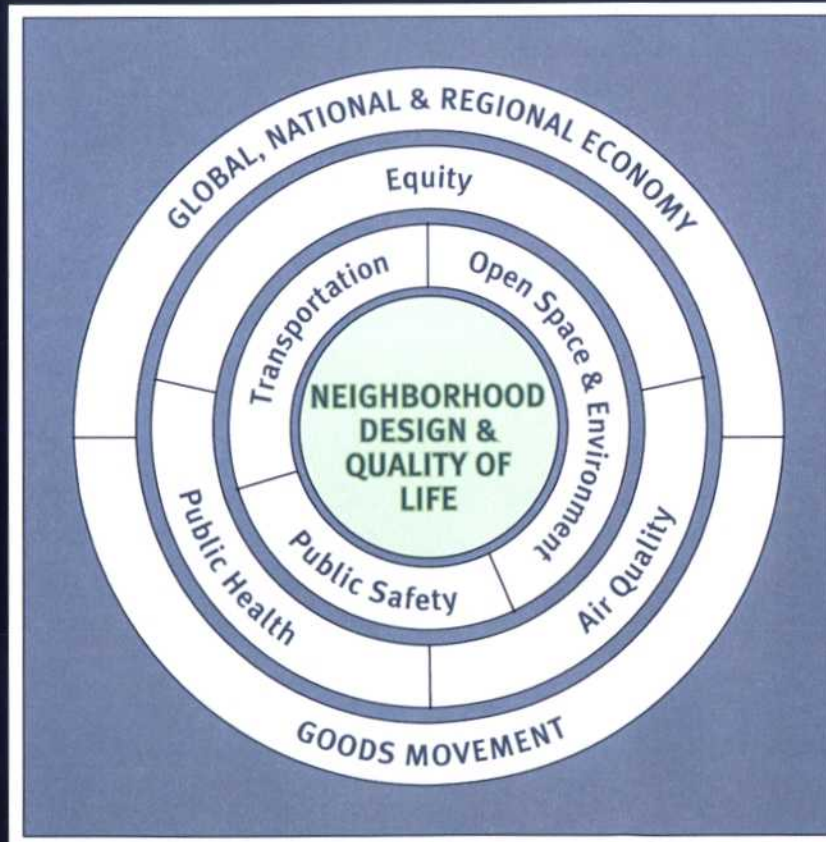

Introduction

Community Input

Plan Concepts

Conclusion

Regional Issues

Port Air Quality Improvements Measures:

Port of Long Beach Green Port Policy
Port of Los Angeles Clean Air Program
San Pedro Bay Ports Clean Air Action Plan
Prop 1B

- In Port greening and equipment conversion
- Cold Ironing and shipping/marine equipment upgrades
- Trucking systems and goods movement corridors

Rail Air Quality Improvements Measures:

- Mode shifts – more on-dock rail/less trucking?
- Advanced technologies for goods movement – mag lev?
- Rail equipment – e.g. green locomotives due to new EPA standards

Harbor Area Refineries

Introduction

Community Input

Plan Concepts

Conclusion

Regional Plans

Gateway Cities COG Clean Air Program

Fleet Modernization

Emission reduction devices on port trucks

Cleaner off-road vehicles

Gateway Cities COG Air Quality Action Plan

Determine/quantify existing air and health quality setting

Determine effectiveness of planned near-term air quality improvements

Analyze/determine possible new air quality improvements or strategies

Develop plan to implement and measure air quality improvements for the region

Work with Regional, State and Federal Agencies, industry stakeholders, local communities to develop consensus

CARB/SCAQMD Goods Movement Action Plan

CARB Diesel Risk Reduction Plan

Corridor Wide Improvements

I 710 Corridor Buffers & Screening

Planting

Sound Walls

I 710 Bridges, Overpasses, Underpasses

I 710 Noise/Air Mitigation

Windows

Air Conditioning/Air Filtration

I 710 Interchanges & Interface with LA River

LARIO Trail Improvements

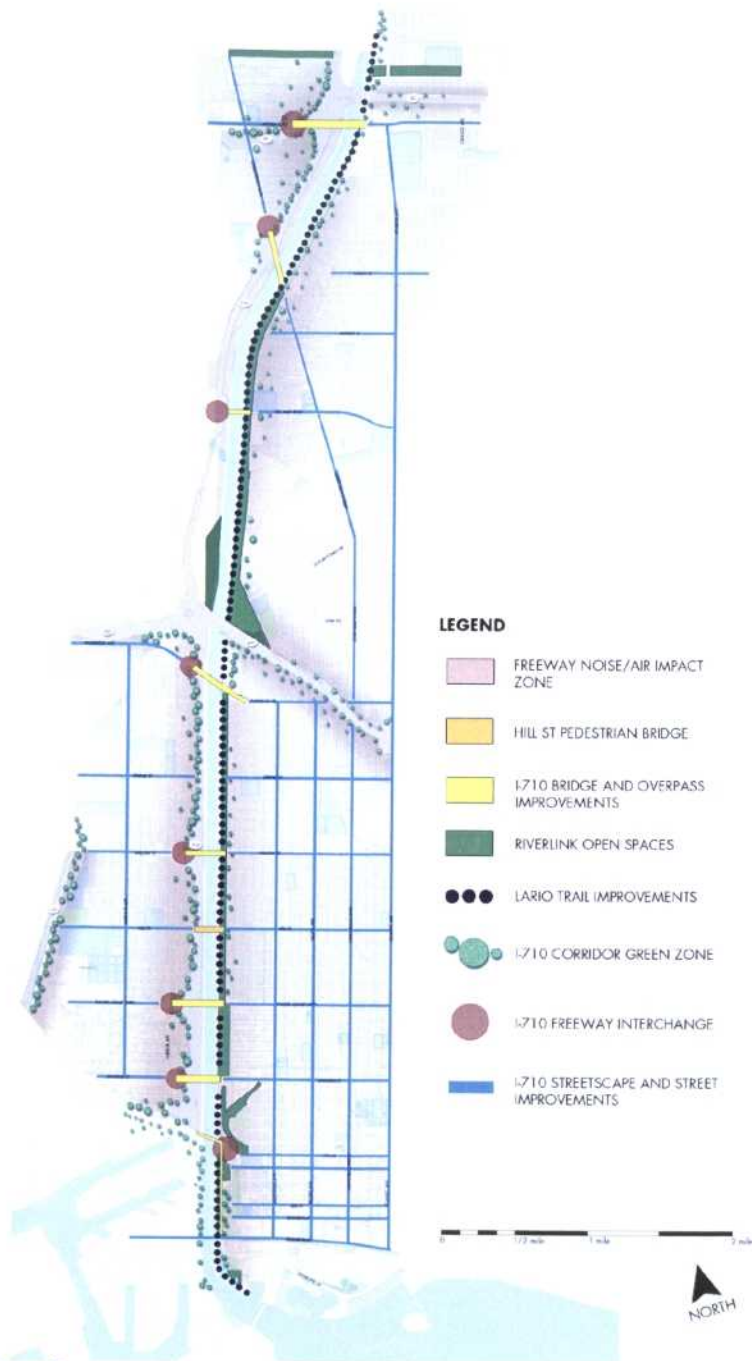

CORRIDOR IMPROVEMENTS

MELÉNDREZ
FEBRUARY 2008

Freeway Noise/Air Impact Zone

Indoor Air Quality, Noise

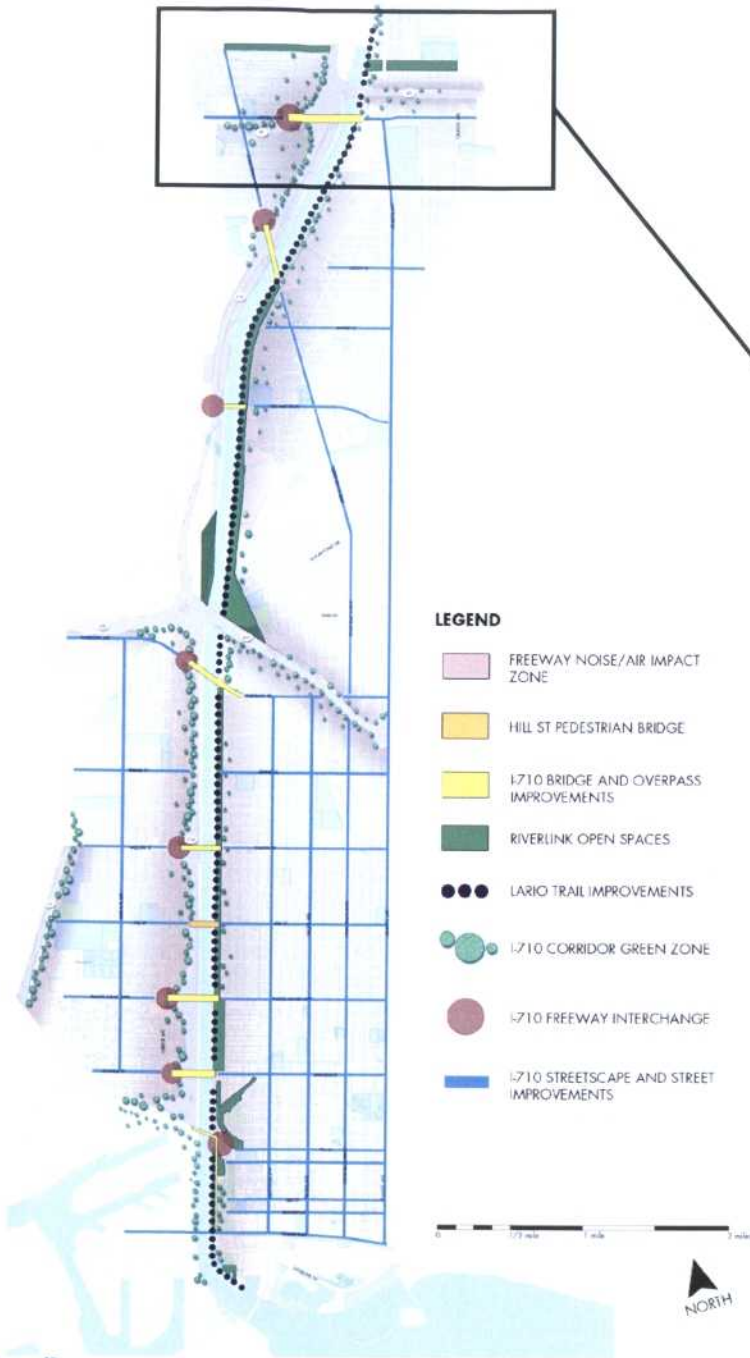

LEGEND

-  FREEWAY NOISE/AIR IMPACT ZONE
-  HILL ST PEDESTRIAN BRIDGE
-  I-710 BRIDGE AND OVERPASS IMPROVEMENTS
-  RIVERLINK OPEN SPACES
-  LARIO TRAIL IMPROVEMENTS
-  I-710 CORRIDOR GREEN ZONE
-  I-710 FREEWAY INTERCHANGE
-  I-710 STREETSCAPE AND STREET IMPROVEMENTS

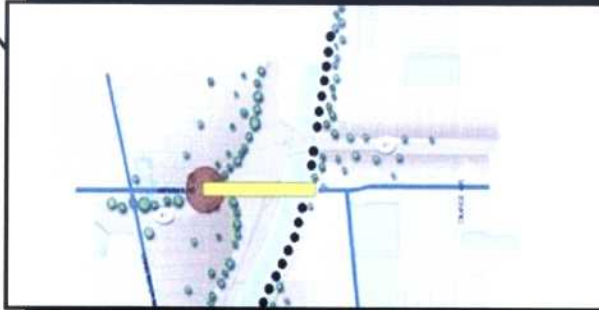

CORRIDOR IMPROVEMENTS

MELÉNDREZ
FEBRUARY 2008



Soundwalls

Hill Street Pedestrian Bridge

Pedestrian Separated Crossings

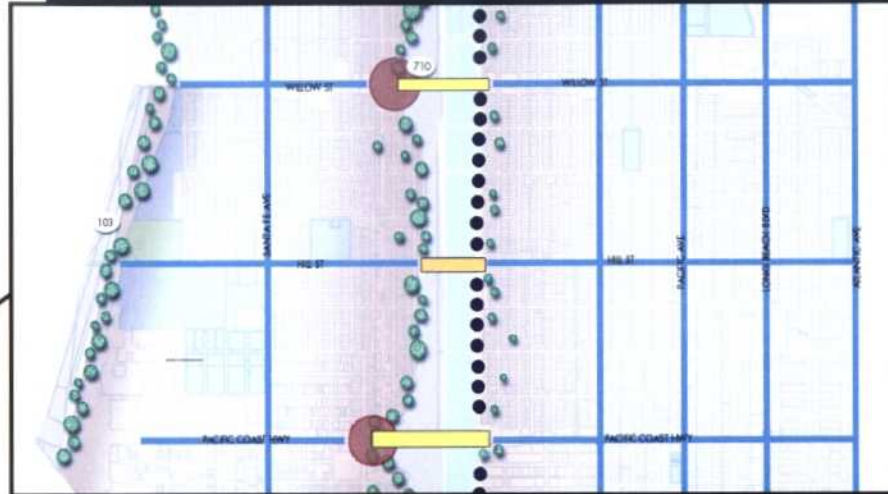
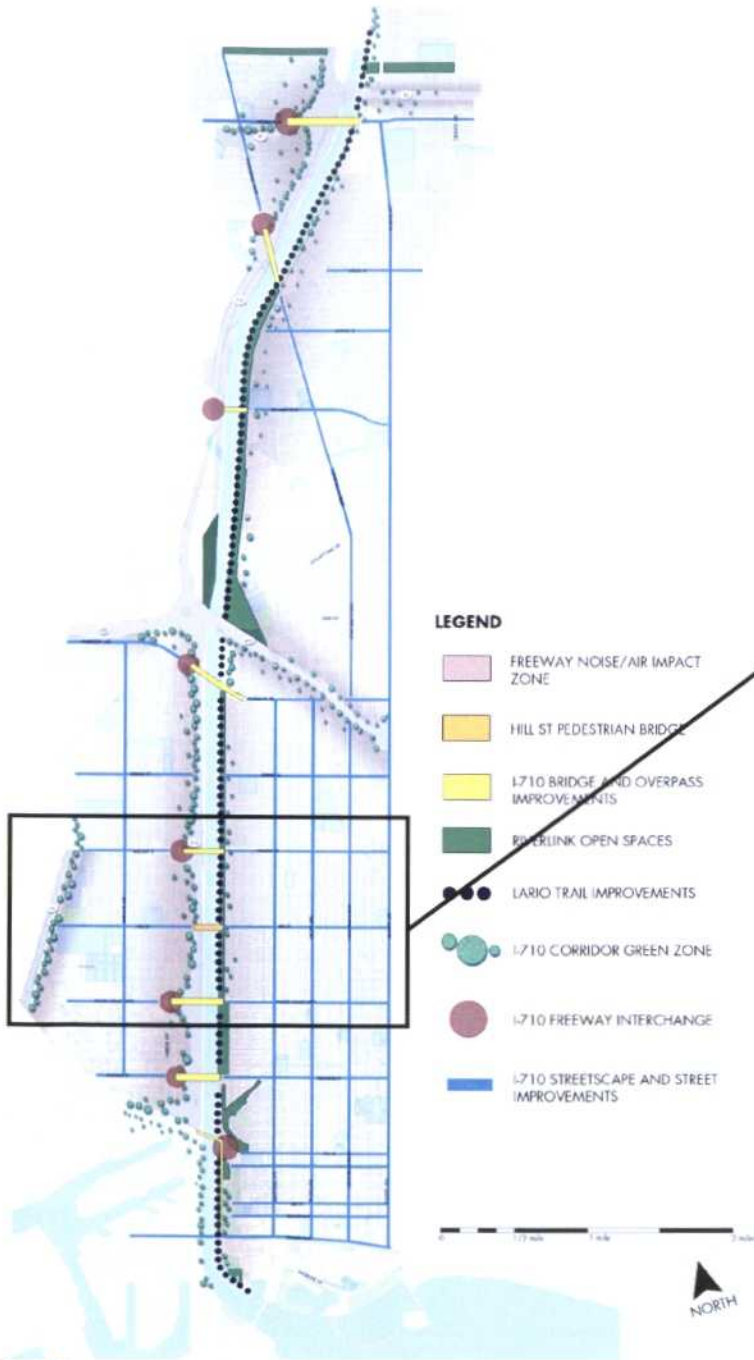

CORRIDOR IMPROVEMENTS

MELÉNDREZ
FEBRUARY 2008



Pedestrian Bridges

I-710 Bridge and Overpass

Bridge & Overpass Improvements

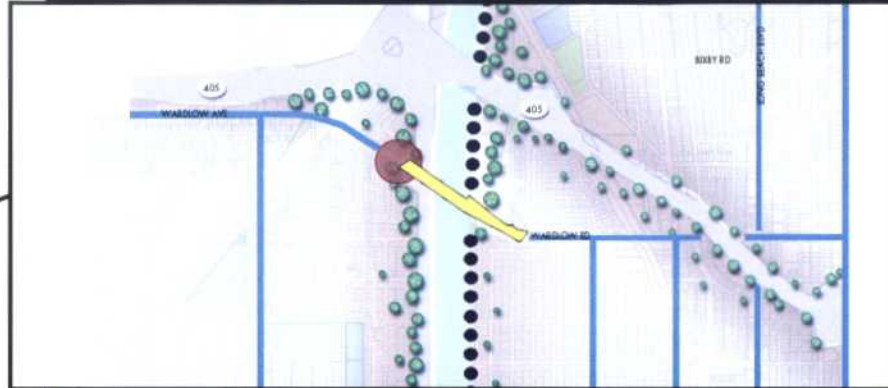
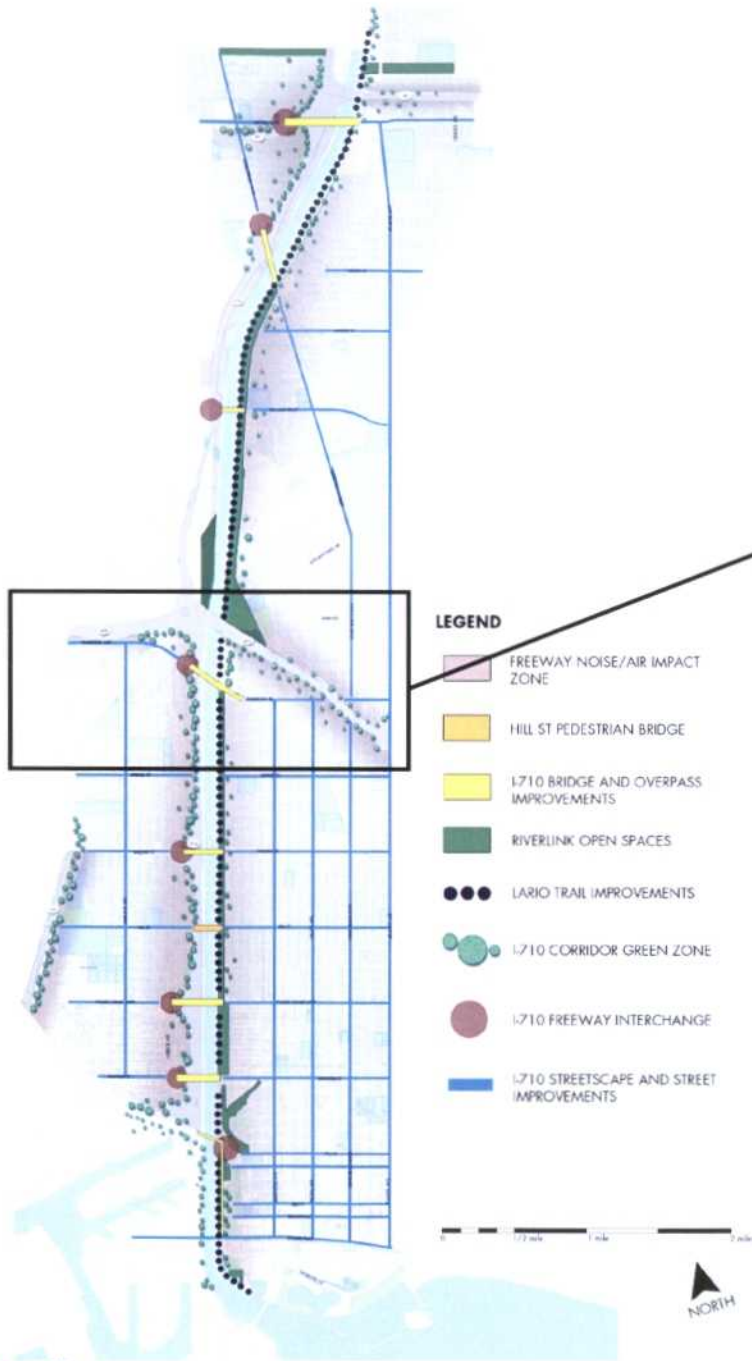



Pedestrian Bridges



I-710 Corridor Forestation Zone

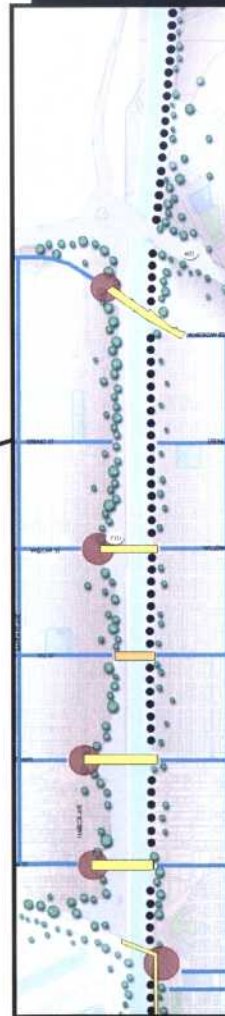
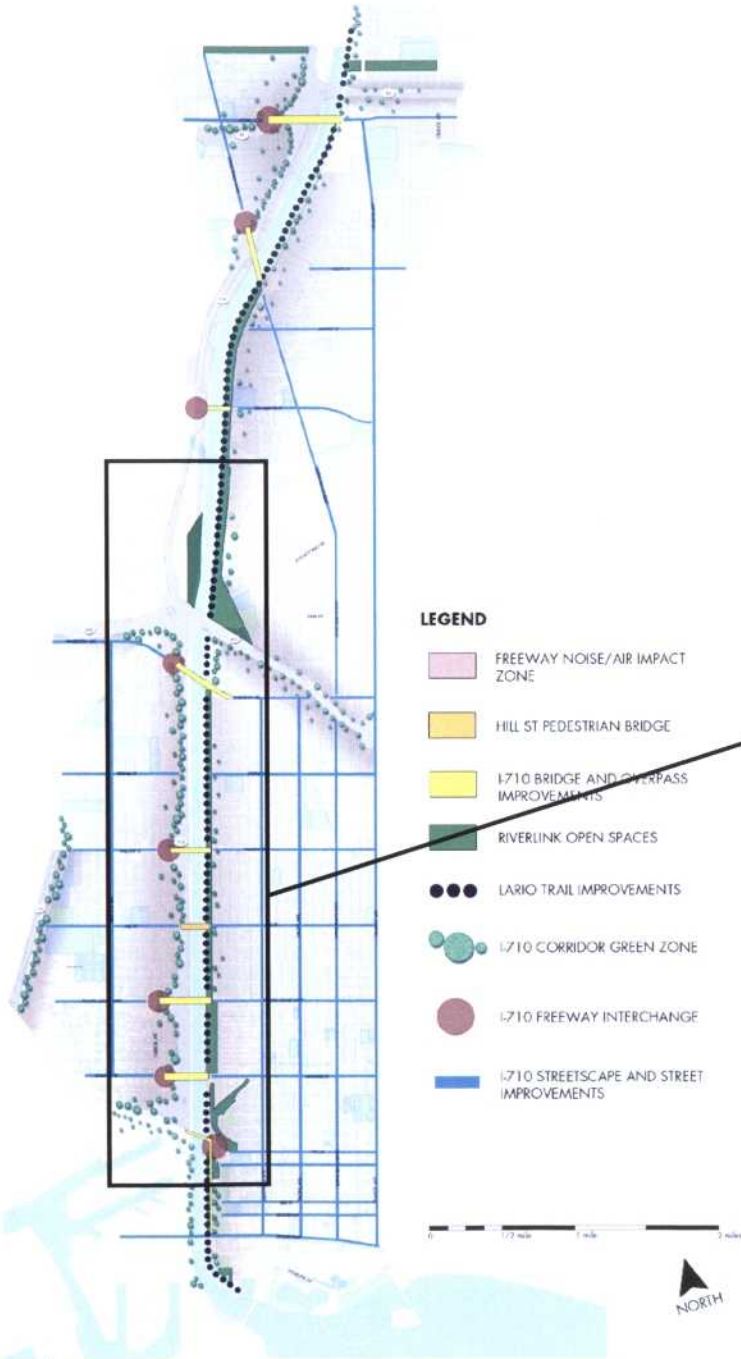

CORRIDOR IMPROVEMENTS

MELÉNDREZ
FEBRUARY 2008

All Roads Lead Home

I-710 Corridor Neighborhoods
LONG BEACH CALIFORNIA

Introduction

Community Input

Plan Concepts

Conclusion

I-710 Oversight Committee
February 19, 2008

Community Livability

The Region – The City – The Neighborhood

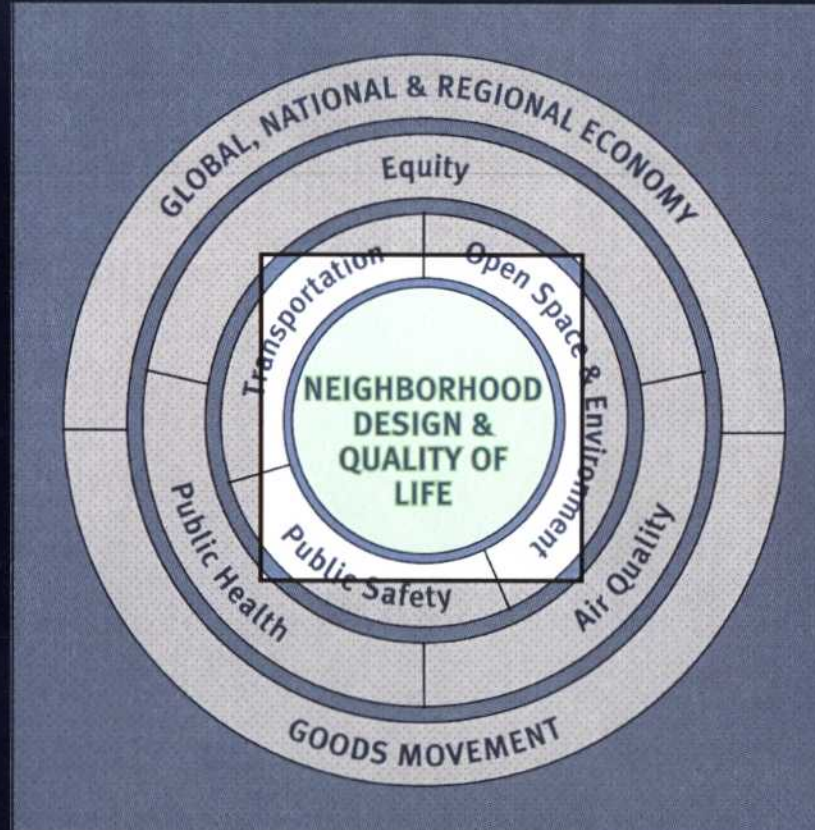

Introduction

Community Input

Plan Concepts

Conclusion

Measuring Community Livability

WE MEASURE QUALITY OF LIFE IN A NEIGHBORHOOD BY:

The neighborhood's physical condition, and whether or not it is *well connected by pathways* for people, *comfortable* to live and move around in

The neighborhood is *safe* and its residents *healthy*

Strong and active *neighborhood groups* and organizations, and residents are taking advantage of *local services* and have *community pride*

Cultural and environmental resources are being preserved in the neighborhood, like *historic buildings*, *trees*, *landscaping* and *open space*, and real architectural character

The neighborhood is *prosperous*, its residents are *employed*, and its businesses are doing well

LEGEND

- PEDESTRIAN AND BICYCLE IMPROVEMENTS
- RIVERLINK, PARKS, GREENBELTS AND CONNECTIONS
- TREES AND STREETSCAPES
- NEIGHBORHOOD SERVICES, FACILITIES AND AMENITIES
- BRIDGES/OVERPASSES
- PEDESTRIAN BRIDGES
- EXISTING PARKS
- LIVABLE SCHOOLS
- PLANNED BIKE PATHS

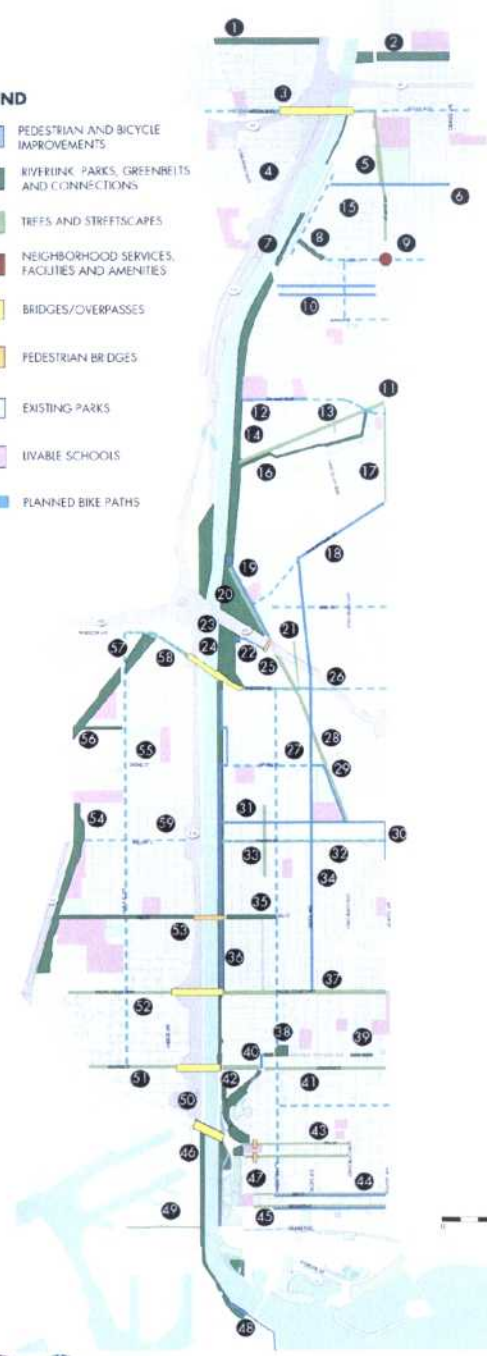

- NORTH CORRIDOR**
1. EDISON ROW GREENBELT WEST
 2. EDISON ROW GREENBELT EAST
 3. ARTESIA BLVD SAFE ROUTE TO SCHOOL
 4. NORTH LONG BEACH TREE BUFFER
 5. ATLANTIC AVE STREETSCAPE
 6. HARDING ST CLASS II BIKE PATH*
 7. DEFOREST WETLANDS*
 8. SOUTH ST PARKWAY
 9. ATLANTIC ST NORTH VILLAGE
 10. DARY AND ADDAMS ONE WAY COULETS*
 11. CARMELITOS SENIOR CENTER ADA ACCESS
 12. DOMINGUEZ GAP WETLANDS CONNECTOR
 13. UNION PACIFIC ROW LANDSCAPING
 14. DOMINGUEZ GAP WETLANDS*
 15. ALLEY IMPROVEMENTS

- CENTRAL CORRIDOR**
16. STORM DRAIN 130 GREENING
 17. ATLANTIC AVE STREETSCAPE
 18. SAN ANTONIO ST CLASS II BIKE PATH*
 19. LOS CERRITOS/DEL MAR TRAIL AND RIVER CONNECTOR
 20. DEL MAR PARK
 21. PACIFIC AVE STREETSCAPE
 22. WRIGLEY HEIGHTS RIVERLINK CONNECTOR
 23. WRIGLEY HEIGHTS PARK*
 24. WRIGLEY HEIGHTS RIVER CONNECTOR
 25. LOS CERRITOS/DEL MAR PEDESTRIAN BRIDGE
 26. WARDLOW STREETSCAPE/405 OVERPASS
 27. SPRING ST BIKE IMPROVEMENTS
 28. METRO BLUE LINE LANDSCAPING
 29. VETERAN'S PARK/BLUE LINE BIKE PATH
 30. PE ROW BIKE CONNECTION
 31. 27TH ST CLASS II BIKE PATH*
 32. WILLOW STREETSCAPE*
 33. DASY AVE MEDIAN
 34. PACIFIC AVE CLASS II BIKE PATH*

- SOUTH CORRIDOR**
35. HILL ST OPEN SPACE CONNECTOR
 36. LOS ANGELES RIVER CLASS II BIKE PATH*
 37. PACIFIC COAST HIGHWAY STREETSCAPE
 38. SEASIDE PARK*
 39. 14TH ST PARK EXPANSION*
 40. ANAHEIM ST RIVER CONNECTION
 41. ANAHEIM ST STREETSCAPE
 42. DRAKE PARK EXPANSION*
 43. 6TH ST AND 7TH PEDESTRIAN IMPROVEMENTS*
 44. BROADWAY AND THIRD CLASS II BIKE PATHS*
 45. BROADWAY AND THIRD TRAFFIC CALMING*
 46. HARBOR DISTRICT RIVER EDGE GREENING
 47. ALLEY IMPROVEMENTS

- WEST CORRIDOR**
48. WATERFRONT BIKE PATH*
 49. OCEAN BLVD GREENING
 50. SHOEMAKER BRIDGE/CHAVEZ PARK REALIGNMENT*
 51. ANAHEIM STREETSCAPE/710 OVERPASS
 52. PACIFIC COAST HIGHWAY STREETSCAPE/710 OVERPASS SAFE ROUTE TO SCHOOL
 53. HILL ST OPEN SPACE CONNECTOR
 54. TERMINAL ISLAND FREEWAY TREE BUFFER
 55. SILVERADO PARK FITNESS ZONE
 56. TANAKA GREENBELT
 57. TANAKA PARK EXPANSION
 58. WARDLOW STREETSCAPE IMPROVEMENTS/710 OVERPASS
 59. 27TH ST ALLEY IMPROVEMENTS

* Denotes available funding



Nighborhood Improvements

Changes They'd Like To See In Their Neighborhood



Neighborhood Improvements

Some issues can be mapped, and become potential projects (case studies):

Freeway corridor design issues

Freeway bridge/overpass/underpass short & long term improvements

Pedestrian, bike and streetscape projects

Greening and open space projects

Others will be noted in the Plan, and can be followed up by specific City departments:

Tree maintenance

Specific improvements at existing parks, facilities

Programming

Murals and public art

Parking and code enforcement issues

Specific traffic control improvements, e.g. signals

Specific neighborhood services/facilities requests

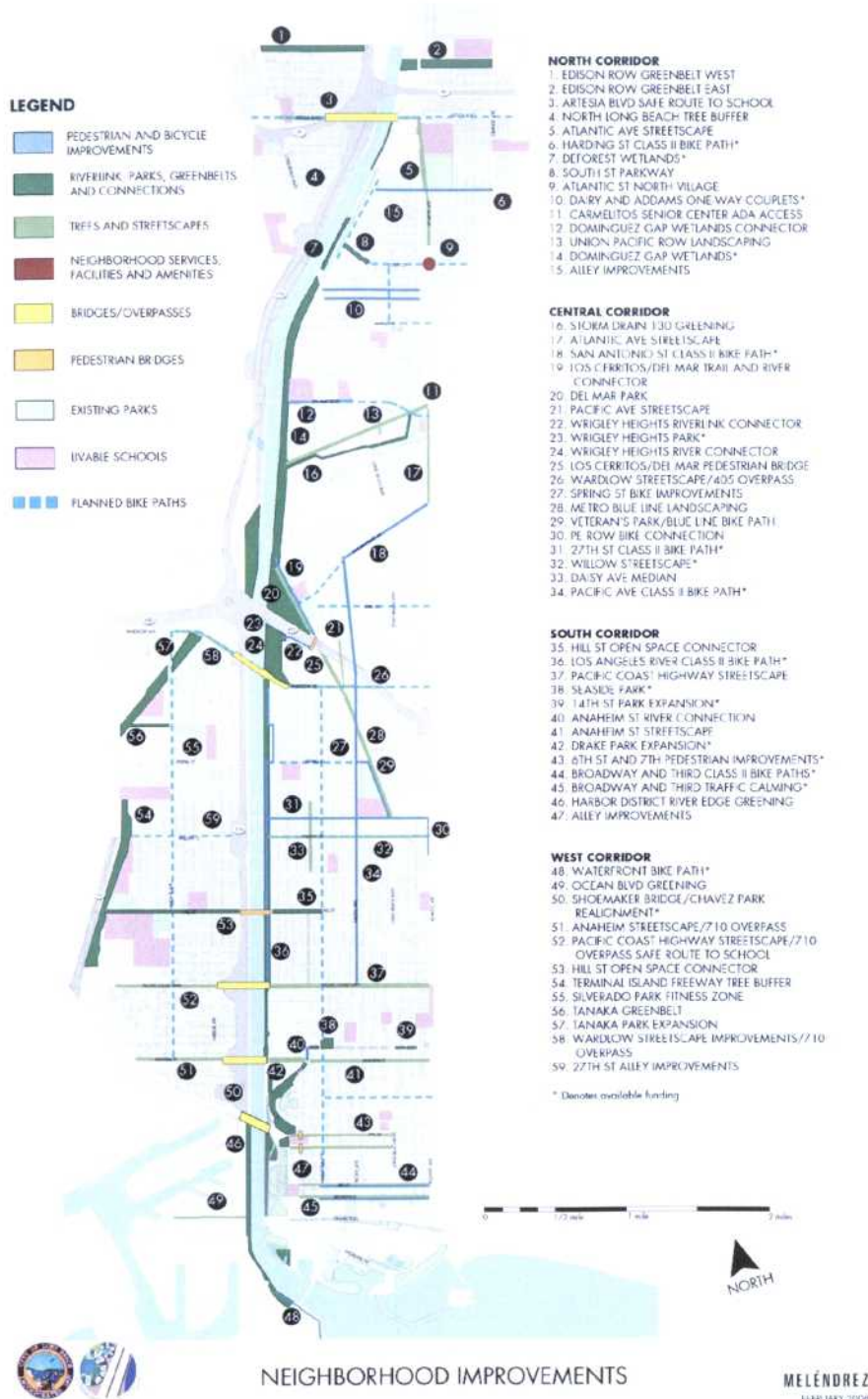

North Corridor Improvements

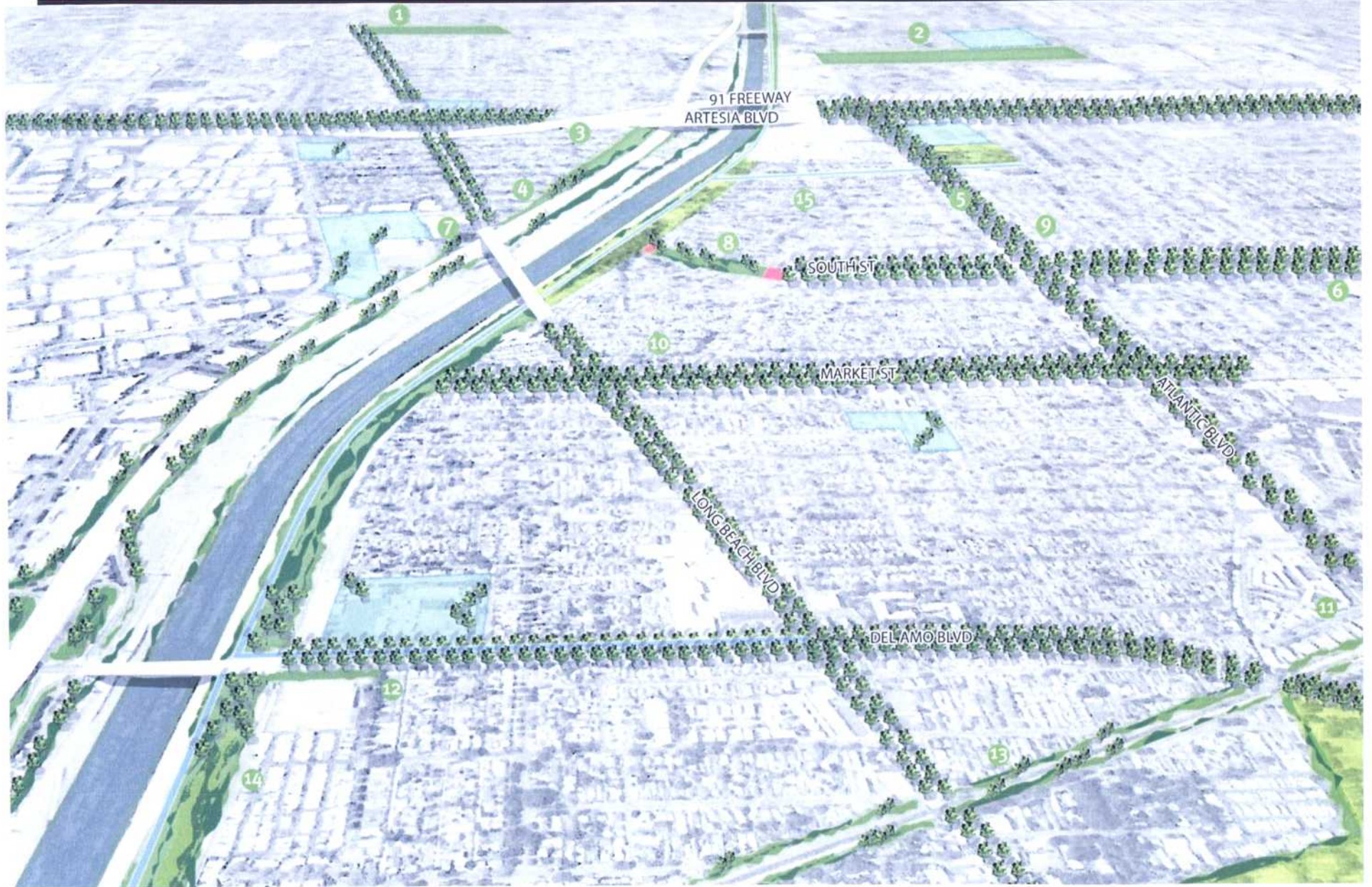

Recommendations Table

North Corridor Neighborhood Improvements

TABLE 4-2: NORTH CORRIDOR RECOMMENDATIONS

PROJECT	DESCRIPTION	RESPONSIBILITY	TIMELINE	IMPLEMENTATION/FUNDING
1. Edison ROW Greenbelt West	Greening of the Edison ROW west of the 710	DPRM	Long-term	DPRM, Possible state funding
2. Edison ROW Greenbelt East	Greening of the Edison ROW east of the 710	DPRM	Long-term	DPRM, Possible state funding
3. Artesia Blvd. Safe Route to School	Pedestrian, bridge and streetscape improvements between Long Beach Blvd. and Atlantic	DPW	Short-term	DPW, Safe Routes to Schools funding
4. North Long Beach Tree Buffer	Street tree planting in the residential neighborhoods adjacent to the 710, the 405, and the 91	DPW, DS	Short- and Long-term	DPW, Potentially Port of Long Beach, DS
5. Atlantic Ave. Streetscape	Pedestrian and open space improvements between South St. and Artesia as link between existing streetscape projects	DPW, DS	Long-term	DS, Possible state and federal funding
6. Harding St. Class II Bicycle Path*	Construction of class II bikeway along Harding per Bicycle Master Plan	DPW	Short-term	Funded
7. DeForest Wetlands*	Transform current nature trail area of DeForest Park into a wetlands park, per RiverLink plans	DPRM	Short-term	\$2.5 million awarded from LA County
8. South St. Parkway	Pedestrian and open space improvements and traffic calming measures along South St. between Dairy St. and the River	DPRM, DPW	Long-term	DPRM, Possible state and federal funding
9. Atlantic St. North Village	Enhanced neighborhood services, facilities, and parking in a new neighborhood center	DS	Short-term	DS, North Village Redevelopment Project in design now
10. Dairy and Addams One-Way Couplets	Multiple one way couplets in the Dairy and Addams neighborhoods to improve traffic, including couplets and additional streetscape and parking improvements at Ellis and 56th	DS, DPW	Short-term	DS, DPW
11. Carmelitos Senior Ctr. ADA Access	ADA improvements at Carmelitos to improve transit stop access and shopping center on Atlantic Blvd.	DPW	Long-term	DPW
12. Dominguez Gap Wetlands Connector	Proposed open space connection from east to the Dominguez Gap Wetlands	DPRM	Long-term	RiverLink, Possible state and federal funding or Port of Long Beach
13. Union Pacific Landscaping	Landscape improvements to rail corridor including the addition of screen fabric on bridge	DPRM, DS	Short-term	DS, DPRM
14. Dominguez Gap Wetlands*	Restored wetlands adjacent to the LA River	DPRM	Short-term	Funded, Under Construction
15. Alley Improvements	Alley improvements pilot project (location to be identified)	DPW	Long-term	DPW, Grant Funding

* Denotes available funding

LEGEND

Metro: Los Angeles County Metropolitan Transportation Authority
 Caltrans: California Department of Transportation
 DPW: City of Long Beach Department of Public Works
 DPRM: City of Long Beach Department of Parks, Recreation, and Marine
 LAC: Los Angeles County
 DS: City of Long Beach Development Services
 BNS: City of Long Beach Bureau of Neighborhood Services
 CLB: City of Long Beach - Multiple Departments

I-710 Corridor Forestation Zone

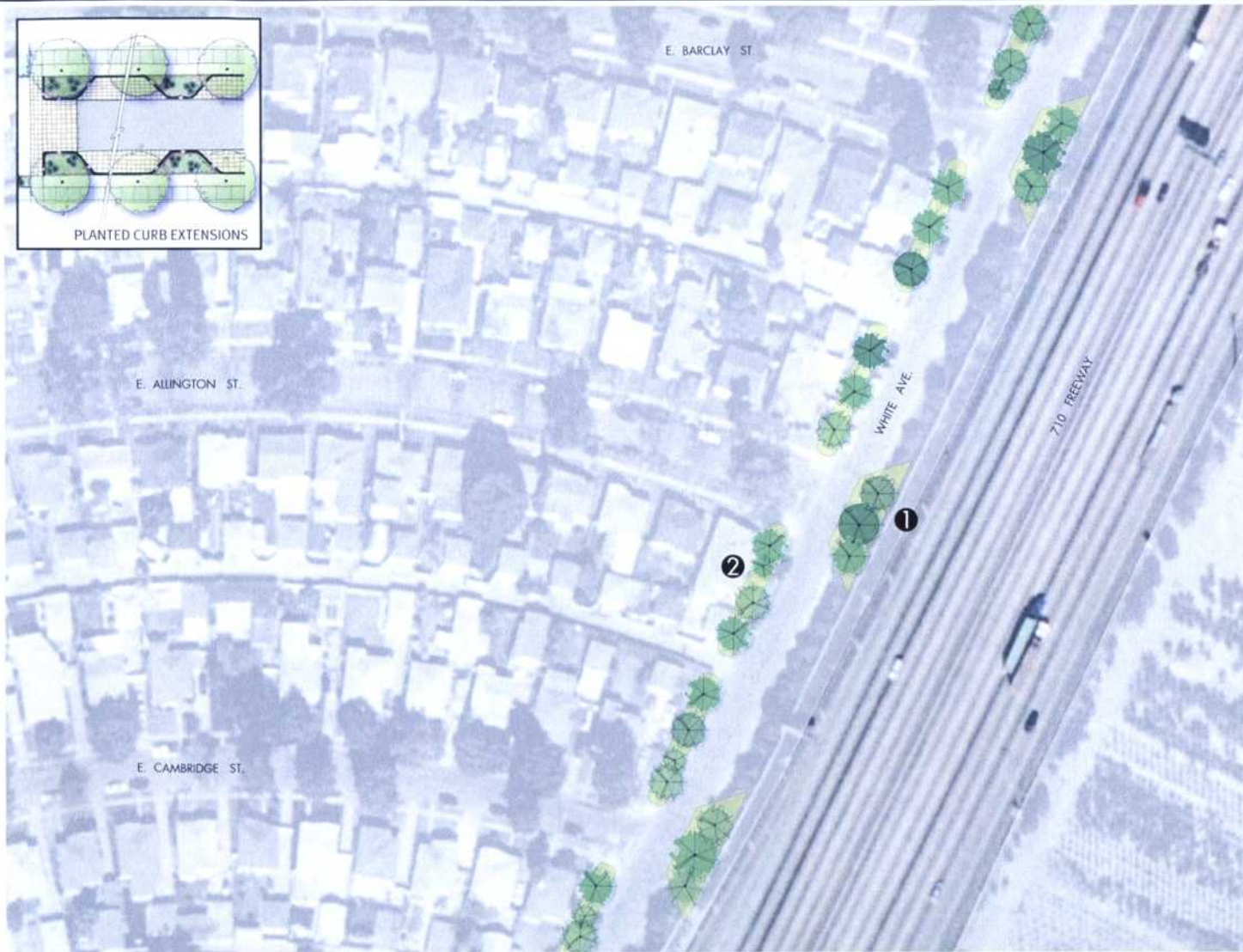
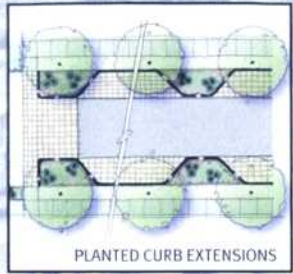

1 PLANTED CURB EXTENSIONS

Extend curb to add planters on "freeway side" of City street ends, and plant additional trees there as well

2 I-710 URBAN FOREST BUFFER

Pilot tree planting project targeted on City right of way and private side yards in residential neighborhoods

DESIGN INTENT

Buffer residents from the aesthetic, air pollution and noise impacts of the I-710

APPLICATION

Corridor neighborhoods west of the I-710, both in north and west Long Beach



I-710 Corridor Forestation Zone



AFTER

1 TREE PLANTING AND LANDSCAPING ALONG OCEAN BOULEVARD THROUGH HARBOR DISTRICT

2 LOS ANGELES RIVER EDGE SCREENING AND BIKEWAY CONNECTION TO THE QUEEN MARY

DESIGN INTENT

Capitalize on unused right of way edges on roadway corridors throughout the Harbor District for greening opportunities and expansion of urban forest

Focus efforts to green the LA River edge where it also adjoins the Harbor District in order to buffer the City from the Port and enhance the aesthetics of a major gateway into the community and its destinations, including the Queen Mary

APPLICATION

Roadway right of way edges within the Harbor District, and on the west side of the LA River



BEFORE

LEGEND

-  PEDESTRIAN AND BICYCLE IMPROVEMENTS
-  RIVERLINK PARKS, GREENBELTS AND CONNECTIONS
-  TREES AND STREETSCAPES
-  NEIGHBORHOOD SERVICES, FACILITIES AND AMENITIES
-  BRIDGES/OVERPASSES
-  PEDESTRIAN BRIDGES
-  EXISTING PARKS
-  LIVABLE SCHOOLS
-  PLANNED BIKE PATHS



- NORTH CORRIDOR**
1. EDISON ROW GREENBELT WEST
 2. EDISON ROW GREENBELT EAST
 3. ARTESIA BLVD SAFE ROUTE TO SCHOOL
 4. NORTH LONG BEACH TREE BUFFER
 5. ATLANTIC AVE STREETSCAPE
 6. HARDING ST CLASS II BIKE PATH*
 7. DEFOREST WETLANDS*
 8. SOUTH ST PARKWAY
 9. ATLANTIC ST NORTH VILLAGE
 10. DARBY AND ADAMS ONE-WAY COURTS*
 11. CARMELITOS SENIOR CENTER ADA ACCESS
 12. DOMINGUEZ GAP WETLANDS CONNECTOR
 13. UNION PACIFIC ROW LANDSCAPING
 14. DOMINGUEZ GAP WETLANDS*
 15. ALLEY IMPROVEMENTS

- CENTRAL CORRIDOR**
16. STORM DRAPY 130 GREENING
 17. ATLANTIC AVE STREETSCAPE
 18. SAN ANTONIO ST CLASS II BIKE PATH*
 19. LOS CERRITOS/DEL MAR TRAIL AND RIVER CONNECTOR
 20. DEL MAR PARK
 21. PACIFIC AVE STREETSCAPE
 22. WRIGLEY HEIGHTS RIVERLINK CONNECTOR
 23. WRIGLEY HEIGHTS PARK*
 24. WRIGLEY HEIGHTS RIVER CONNECTOR
 25. LOS CERRITOS/DEL MAR PEDESTRIAN BRIDGE
 26. WARDLOW STREETSCAPE/405 OVERPASS
 27. SPRING ST BIKE IMPROVEMENTS
 28. METRO BLUE LINE LANDSCAPING
 29. VETERAN'S PARK/BLUE LINE BIKE PATH
 30. PE ROW BIKE CONNECTION*
 31. 27TH ST CLASS II BIKE PATH*
 32. WILLOW STREETSCAPE*
 33. DASSY AVE MEDIAN
 34. PACIFIC AVE CLASS II BIKE PATH*

- SOUTH CORRIDOR**
35. HILL ST OPEN SPACE CONNECTOR
 36. LOS ANGELES RIVER CLASS II BIKE PATH*
 37. PACIFIC COAST HIGHWAY STREETSCAPE
 38. SEASIDE PARK*
 39. 14TH ST PARK EXPANSION*
 40. ANAHEIM ST RIVER CONNECTION
 41. ANAHEIM ST STREETSCAPE
 42. DRAKE PARK EXPANSION*
 43. 6TH ST AND 7TH PEDESTRIAN IMPROVEMENTS*
 44. BROADWAY AND THIRD CLASS II BIKE PATHS*
 45. BROADWAY AND THIRD TRAFFIC CALMING*
 46. HARBOR DISTRICT RIVER EDGE GREENING
 47. ALLEY IMPROVEMENTS

- WEST CORRIDOR**
48. WATERFRONT BIKE PATH*
 49. OCEAN BLVD GREENING
 50. SHOEMAKER BRIDGE/CHAVEZ PARK REALIGNMENT*
 51. ANAHEIM STREETSCAPE/710 OVERPASS
 52. PACIFIC COAST HIGHWAY STREETSCAPE/710 OVERPASS SAFE ROUTE TO SCHOOL
 53. HILL ST OPEN SPACE CONNECTOR
 54. TERMINAL ISLAND FREEWAY TREE BUFFER
 55. SILVERADO PARK FITNESS ZONE
 56. TANAKA GREENBELT
 57. TANAKA PARK EXPANSION
 58. WARDLOW STREETSCAPE IMPROVEMENTS/710 OVERPASS
 59. 27TH ST ALLEY IMPROVEMENTS

* Denotes available funding



Artesia Boulevard

Safe Route to School



Artesia Boulevard

Safe Route to School

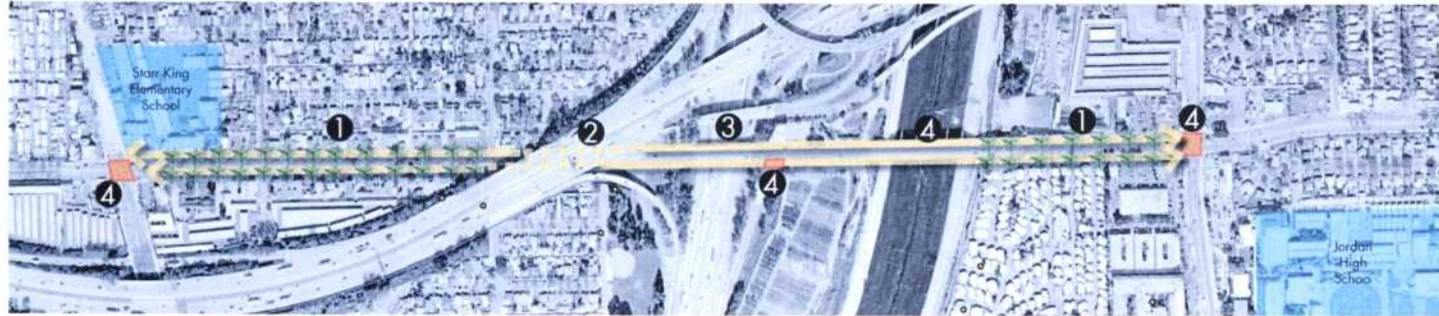

- 1 SAFE ROUTE TO SCHOOL (AT GRADE)**
Widened and continuous sidewalk
Street furniture and lighting
Bikeways
- 2 SAFE ROUTE TO SCHOOL (AT UNDERPASS)**
Widened and continuous sidewalk
Bikeways
Protective barrier between vehicles and pedestrians/cyclists
Include wall or ceiling mounted lighting through underpass
Painting walls of underpass
- 3 SAFE ROUTE TO SCHOOL (ON BRIDGE)**
Widened and continuous
Off street bikeways
Protective barrier between vehicles and pedestrians/cyclists
Potential railing improvements
Continue existing street lighting across entire span
- 4 IMPROVED CROSSWALKS**
Demarcated with decorative pavement or enhanced striping

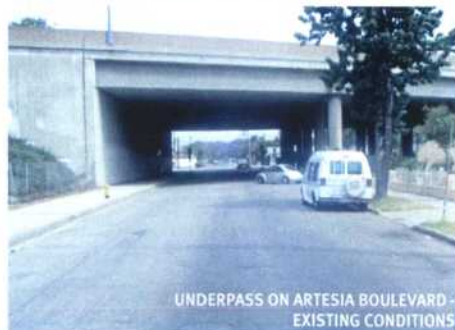

DESIGN INTENT
Improve the safety and livability of routes to school for students accessing their campuses on foot and by bicycle, crossing the I-710 and the LA River

Modernize and enhance the aesthetic quality and pedestrian safety features of the I-710 overpasses, and LA River bridges along the length of the corridor

APPLICATION
Bridges, overpasses and underpasses at Long Beach Boulevard, Del Amo, Wardlow, Willow, Pacific Coast Highway and Anaheim.



FIGURE 4-5: ARTESIA BOULEVARD SAFE ROUTE TO SCHOOL

Conceptual Plan # 1 on Key Map, Figure 4-4

Los Cerritos/Wrigley Heights

RiverLink Connector, Buffer & Ped. Bridge

LEGEND

-  PEDESTRIAN AND BICYCLE IMPROVEMENTS
-  RIVERLINK PARKS, GREENBELTS AND CONNECTIONS
-  TREES AND STREETSCAPES
-  NEIGHBORHOOD SERVICES, FACILITIES AND AMENITIES
-  BRIDGES/OVERPASSES
-  PEDESTRIAN BRIDGES
-  EXISTING PARKS
-  LIVABLE SCHOOLS
-  PLANNED BIKE PATHS

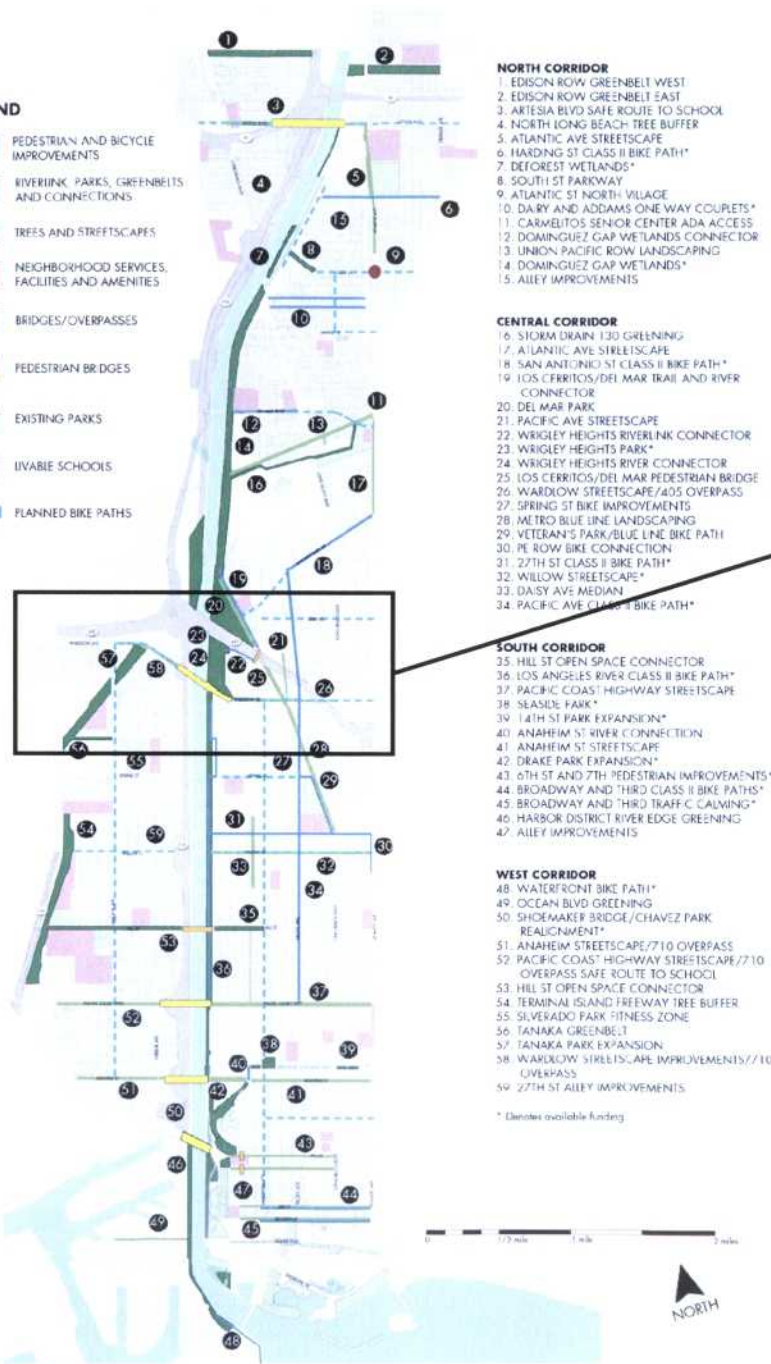

- NORTH CORRIDOR**
1. EDISON ROW GREENBELT WEST
 2. EDISON ROW GREENBELT EAST
 3. ARTESIA BLVD SAFE ROUTE TO SCHOOL
 4. NORTH LONG BEACH TREE BUFFER
 5. ATLANTIC AVE STREETSCAPE
 6. HARDING ST CLASS II BIKE PATH*
 7. DEFOREST WETLANDS*
 8. SOUTH ST PARKWAY
 9. ATLANTIC ST NORTH VILLAGE
 10. DARY AND ADAMS ONE WAY COURTESY*
 11. CARMELITO SENIOR CENTER ADA ACCESS
 12. DOMINGUEZ GAP WETLANDS CONNECTOR
 13. UNION PACIFIC ROW LANDSCAPING
 14. DOMINGUEZ GAP WETLANDS*
 15. ALLEY IMPROVEMENTS

- CENTRAL CORRIDOR**
16. STORM DRAIN 130 GREENING
 17. ATLANTIC AVE STREETSCAPE
 18. SAN ANTONIO ST CLASS II BIKE PATH*
 19. LOS CERRITOS/DEL MAR TRAIL AND RIVER CONNECTOR
 20. DEL MAR PARK
 21. PACIFIC AVE STREETSCAPE
 22. WRIGLEY HEIGHTS RIVERLINK CONNECTOR
 23. WRIGLEY HEIGHTS PARK*
 24. WRIGLEY HEIGHTS RIVER CONNECTOR
 25. LOS CERRITOS/DEL MAR PEDESTRIAN BRIDGE
 26. WARDLOW STREETSCAPE/405 OVERPASS
 27. SPRING ST BIKE IMPROVEMENTS
 28. METRO BLUE LINE LANDSCAPING
 29. VETERAN'S PARK/BLUE LINE BIKE PATH
 30. PE ROW BIKE CONNECTION
 31. 27TH ST CLASS II BIKE PATH*
 32. WILLOW STREETSCAPE*
 33. DAISY AVE MEDIAN
 34. PACIFIC AVE CLASS I BIKE PATH*

- SOUTH CORRIDOR**
35. HILL ST OPEN SPACE CONNECTOR
 36. LOS ANGELES RIVER CLASS II BIKE PATH*
 37. PACIFIC COAST HIGHWAY STREETSCAPE
 38. SEASIDE PARK*
 39. 14TH ST PARK EXPANSION*
 40. ANAHEIM ST RIVER CONNECTION
 41. ANAHEIM ST STREETSCAPE
 42. DRAKE PARK EXPANSION*
 43. 6TH ST AND 7TH PEDESTRIAN IMPROVEMENTS*
 44. BROADWAY AND THIRD CLASS II BIKE PATHS*
 45. BROADWAY AND THIRD TRAFFIC CALMING*
 46. HARBOR DISTRICT RIVER EDGE GREENING
 47. ALLEY IMPROVEMENTS

- WEST CORRIDOR**
48. WATERFRONT BIKE PATH*
 49. OCEAN BLVD GREENING
 50. SHOEMAKER BRIDGE/CHAVEZ PARK REALIGNMENT*
 51. ANAHEIM STREETSCAPE/710 OVERPASS
 52. PACIFIC COAST HIGHWAY STREETSCAPE/710 OVERPASS SAFE ROUTE TO SCHOOL
 53. HILL ST OPEN SPACE CONNECTOR
 54. TERMINAL ISLAND FREEWAY TREE BUFFER
 55. SILVERADO PARK FITNESS ZONE
 56. TANAKA GREENBELT
 57. TANAKA PARK EXPANSION
 58. WARDLOW STREETSCAPE IMPROVEMENTS/710 OVERPASS
 59. 27TH ST ALLEY IMPROVEMENTS

* Denotes available funding



Los Cerritos/Wrigley Heights

RiverLink Connector, Buffer & Ped. Bridge

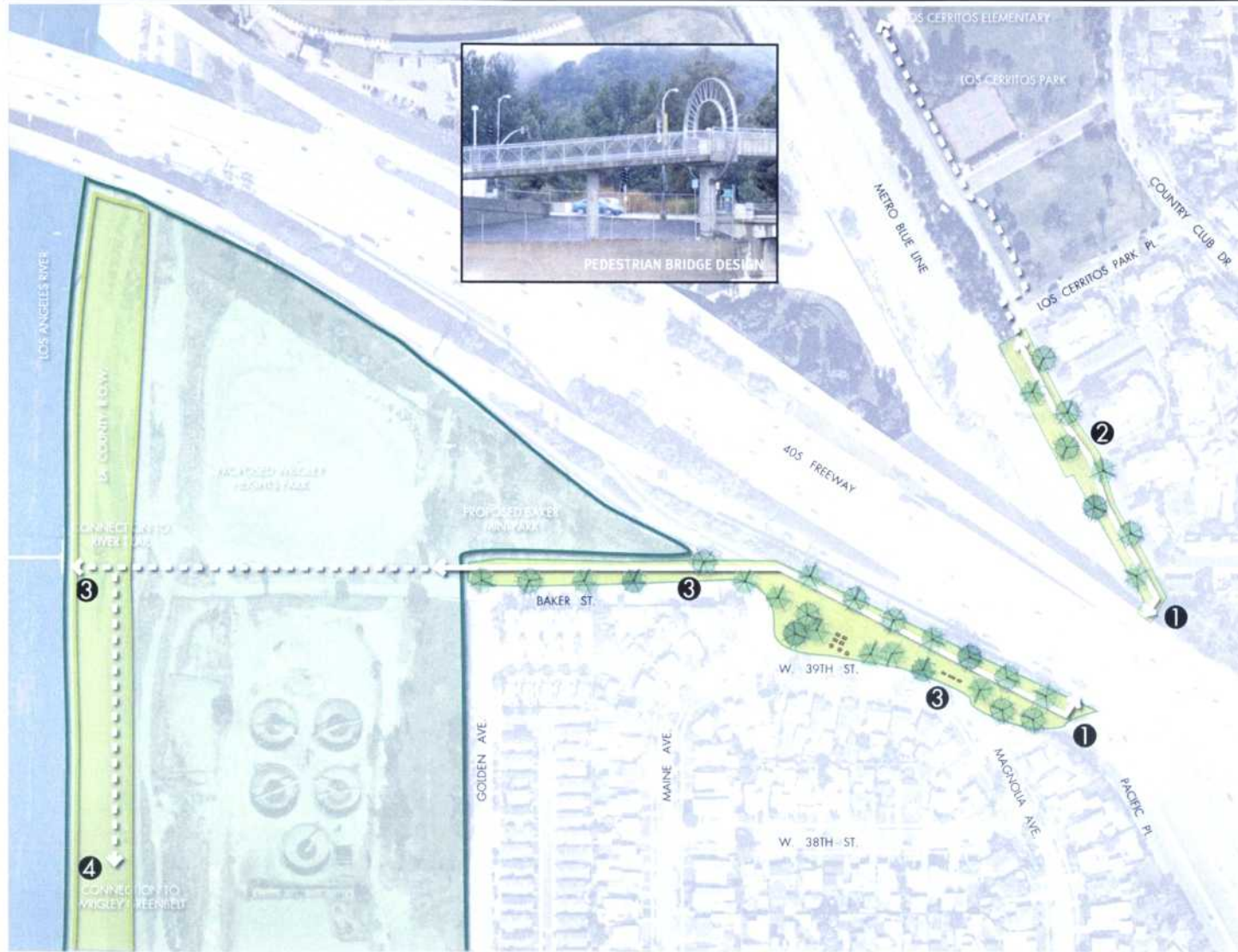

- 1 **EXISTING PEDESTRIAN CROSSING OVER METRO BLUE LINE AND UNDER 405 FREEWAY**
Remove turnstiles, improve lighting, upgrade fencing and screening materials, add public art elements
- 2 **WALKWAY FROM LOS CERRITOS TO PEDESTRIAN CROSSING**
Improve and light the walkway, and provide upgraded landscaping and fencing and screening materials
- 3 **STREESCAPE/PEDESTRIAN/BICYCLE IMPROVEMENTS**
Improve connection from Blue Line/ 405 pedestrian crossing to LA River with street trees, pathway and lighting
- 4 **COUNTY RIGHT OF WAY**
Acquire access to LA County ROW to north and south, continuing LA River trail connection through this area, adjacent to planned RiverLink Park

DESIGN INTENT
Provide safe route to school access for Los Cerritos Elementary School students, from Wrigley Heights Better connect proposed RiverLink parks into their corridor neighborhoods

APPLICATION
Pedestrian bridges in the City connecting schools to corridor neighborhoods
Streets adjacent to proposed RiverLink parks

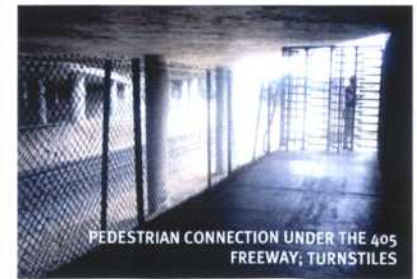

FIGURE 4-8: WRIGLEY HEIGHTS RIVERLINK CONNECTOR, BUFFER AND PEDESTRIAN BRIDGE

Conceptual Plans 4 5 6 on Key Map, Figure 4-4

LEGEND

- PEDESTRIAN AND BICYCLE IMPROVEMENTS
- RIVERLINK, PARKS, GREENBELTS AND CONNECTIONS
- TREES AND STREETSCAPES
- NEIGHBORHOOD SERVICES, FACILITIES AND AMENITIES
- BRIDGES/OVERPASSES
- PEDESTRIAN BRIDGES
- EXISTING PARKS
- LIVABLE SCHOOLS
- PLANNED BIKE PATHS



- NORTH CORRIDOR**
1. EDISON ROW GREENBELT WEST
 2. EDISON ROW GREENBELT EAST
 3. ARTESIA BLVD SAFE ROUTE TO SCHOOL
 4. NORTH LONG BEACH TREE BUFFER
 5. ATLANTIC AVE STREETSCAPE
 6. HARDING ST CLASS II BIKE PATH*
 7. DEFOREST WETLANDS*
 8. SOUTH ST PARKWAY
 9. ATLANTIC ST NORTH VILLAGE
 10. DAIRY AND ADDAMS ONE WAY COUPLETS*
 11. CARMELITOS SENIOR CENTER ADA ACCESS
 12. DOMINGUEZ GAP WETLANDS CONNECTOR
 13. UNION PACIFIC ROW LANDSCAPING
 14. DOMINGUEZ GAP WETLANDS*
 15. ALLEY IMPROVEMENTS

- CENTRAL CORRIDOR**
16. STORM DRAIN 130 GREENING
 17. ATLANTIC AVE STREETSCAPE
 18. SAN ANTONIO ST CLASS II BIKE PATH*
 19. LOS CERROS/DEL MAR TRAIL AND RIVER CONNECTOR
 20. DEL MAR PARK
 21. PACIFIC AVE STREETSCAPE
 22. WRIGLEY HEIGHTS RIVERLINK CONNECTOR
 23. WRIGLEY HEIGHTS PARK*
 24. WRIGLEY HEIGHTS RIVER CONNECTOR
 25. LOS CERROS/DEL MAR PEDESTRIAN BRIDGE
 26. WARDLOW STREETSCAPE/ADS OVERPASS
 27. SPRING ST BIKE IMPROVEMENTS
 28. METRO BLUE LINE LANDSCAPING
 29. VETERAN'S PARK/BLUE LINE BIKE PATH
 30. PE ROW BIKE CONNECTION
 31. 27TH ST CLASS II BIKE PATH*
 32. WILLOW STREETSCAPE*
 33. DASY AVE MEDIAN
 34. PACIFIC AVE CLASS II BIKE PATH*

- SOUTH CORRIDOR**
35. HILL ST OPEN SPACE CONNECTOR
 36. LOS ANGELES RIVER CLASS II BIKE PATH*
 37. PACIFIC COASTS HIGHWAY STREETSCAPE
 38. SEASIDE PARK*
 39. 14TH ST PARK EXPANSIONS*
 40. ANAHEIM ST RIVER CONNECTION
 41. ANAHEIM ST STREETSCAPE
 42. DRAKE PARK EXPANSION*
 43. 6TH ST AND 7TH PEDESTRIAN IMPROVEMENTS*
 44. BROADWAY AND THIRD CLASS II BIKE PATHS*
 45. BROADWAY AND THIRD TRAFFIC CALMING*
 46. HARBOR DISTRICT RIVER EDGE GREENING
 47. ALLEY IMPROVEMENTS

- WEST CORRIDOR**
48. WATERFRONT BIKE PATH*
 49. OCEAN BLVD GREENING
 50. SHOEMAKER BRIDGE/CHAVEZ PARK REALIGNMENT*
 51. ANAHEIM STREETSCAPE/710 OVERPASS
 52. PACIFIC COASTS HIGHWAY STREETSCAPE/710 OVERPASS SAFE ROUTE TO SCHOOL
 53. HILL ST OPEN SPACE CONNECTOR
 54. TERMINAL ISLAND FREEWAY TREE BUFFER
 55. SILVERADO PARK FITNESS ZONE
 56. TANAKA GREENBELT
 57. TANAKA PARK EXPANSION
 58. WARDLOW STREETSCAPE IMPROVEMENTS/710 OVERPASS
 59. 27TH ST ALLEY IMPROVEMENTS

* Denotes available funding



Hill Street

Open Space Connector

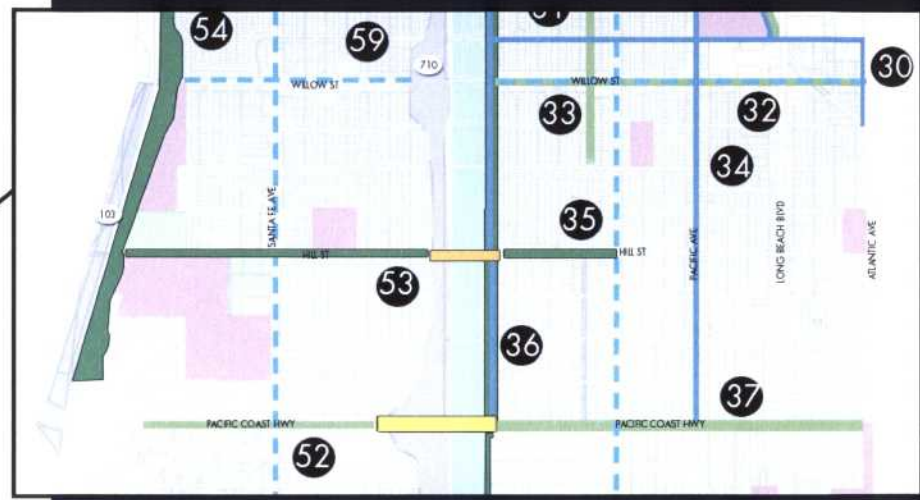

Hill Street

Open Space Connector

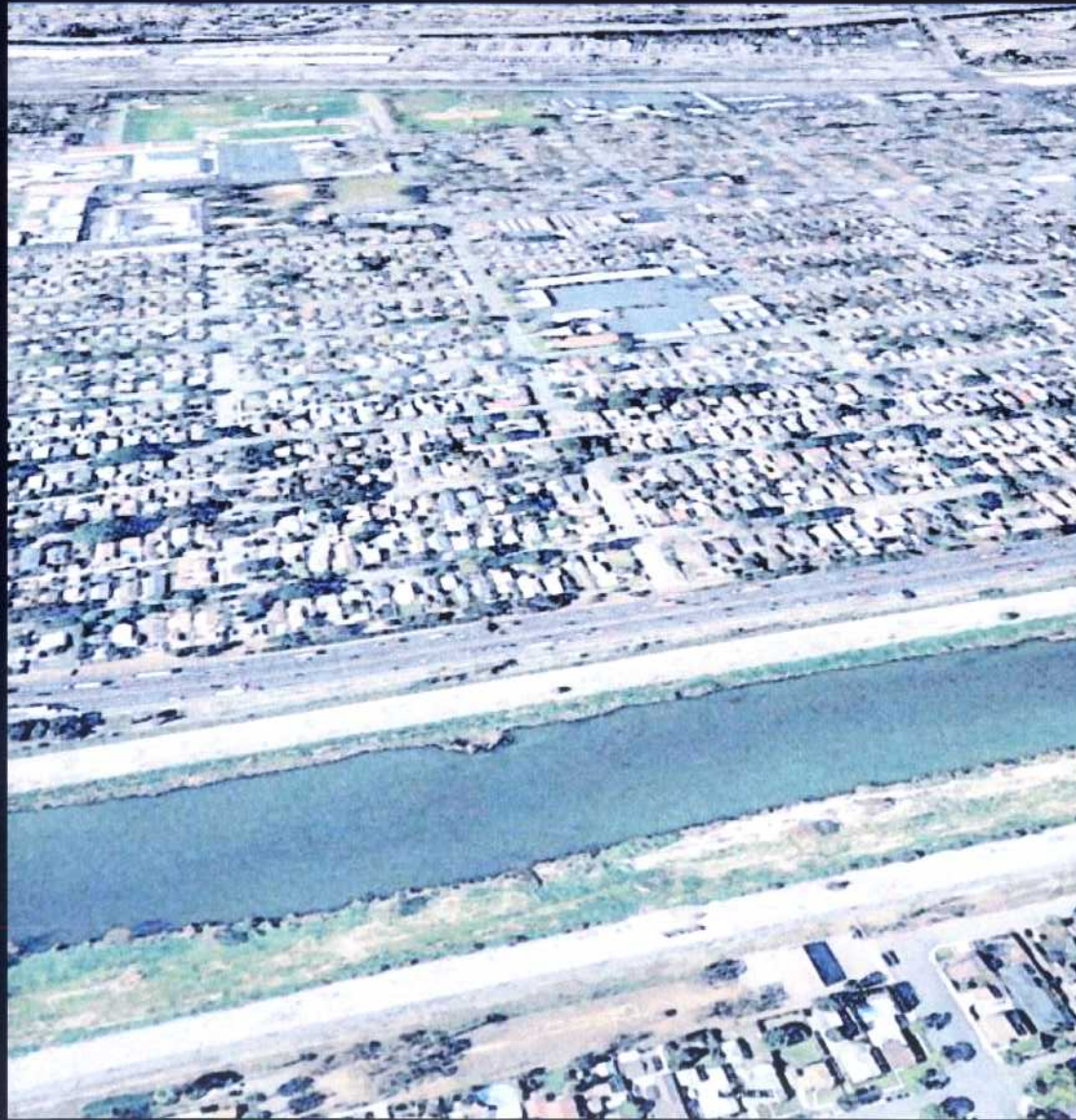

Hill Street

Open Space Connector



14th Street Park Expansion

And Anaheim Street River Connection

LEGEND

-  PEDESTRIAN AND BICYCLE IMPROVEMENTS
-  RIVERLINK, PARKS, GREENBELTS AND CONNECTIONS
-  TREES AND STREETSCAPES
-  NEIGHBORHOOD SERVICES, FACILITIES AND AMENITIES
-  BRIDGES/OVERPASSES
-  PEDESTRIAN BRIDGES
-  EXISTING PARKS
-  LIVABLE SCHOOLS
-  PLANNED BIKE PATHS

NORTH CORRIDOR

1. EDISON ROW GREENBELT WEST
2. EDISON ROW GREENBELT EAST
3. ARTESIA BLVD SAFE ROUTE TO SCHOOL
4. NORTH LONG BEACH TREE BUFFER
5. ATLANTIC AVE STREETSCAPE
6. HARDING ST CLASS II BIKE PATH*
7. DEFOREST WETLANDS*
8. SOUTH ST PARKWAY
9. ATLANTIC ST NORTH VILLAGE
10. DAIRY AND ADDAMS ONE WAY COUPLETS*
11. CARMELITOS SENIOR CENTER ADA ACCESS
12. DOMINGUEZ GAP WETLANDS CONNECTOR
13. UNION PACIFIC ROW LANDSCAPING
14. DOMINGUEZ GAP WETLANDS*
15. ALLEY IMPROVEMENTS

CENTRAL CORRIDOR

16. STORM DRAINS 130 GREENING
17. ATLANTIC AVE STREETSCAPE
18. SAN ANTONIO ST CLASS II BIKE PATH*
19. LOS CERRITOS/DEL MAR TRAIL AND RIVER CONNECTOR
20. DEL MAR PARK
21. PACIFIC AVE STREETSCAPE
22. WRIGLEY HEIGHTS RIVERLINK CONNECTOR
23. WRIGLEY HEIGHTS PARK*
24. WRIGLEY HEIGHTS RIVER CONNECTOR
25. LOS CERRITOS/DEL MAR PEDESTRIAN BRIDGE
26. WARDLOW STREETSCAPE/405 OVERPASS
27. SPRING ST BIKE IMPROVEMENTS
28. METRO BLUE LINE LANDSCAPING
29. VETERAN'S PARK/BLUE LINE BIKE PATH
30. PE ROW BIKE CONNECTION
31. 27TH ST CLASS II BIKE PATH*
32. WILLOW STREETSCAPE*
33. DAISY AVE MEDIAN
34. PACIFIC AVE CLASS II BIKE PATH*

SOUTH CORRIDOR

35. HILL ST OPEN SPACE CONNECTOR
36. LOS ANGELES RIVER CLASS II BIKE PATH*
37. PACIFIC COAST HIGHWAY STREETSCAPE
38. SEASIDE PARK*
39. 14TH ST PARK EXPANSION*
40. ANAHEIM ST RIVER CONNECTION
41. ANAHEIM ST STREETSCAPE
42. DRAKE PARK EXPANSION*
43. 6TH ST AND 7TH PEDESTRIAN IMPROVEMENTS*
44. BROADWAY AND THIRD CLASS II BIKE PATHS*
45. BROADWAY AND THIRD TRAFFIC CALMING*
46. HARBOR DISTRICT RIVER EDGE GREENING
47. ALLEY IMPROVEMENTS

WEST CORRIDOR

48. WATERFRONT BIKE PATH*
49. OCEAN BLVD GREENING
50. SILVERADO BRIDGE/CHAVEZ PARK REALIGNMENT*
51. ANAHEIM STREETSCAPE/710 OVERPASS
52. PACIFIC COAST HIGHWAY STREETSCAPE/710 OVERPASS SAFE ROUTE TO SCHOOL
53. HILL ST OPEN SPACE CONNECTOR
54. TERMINAL ISLAND FREEWAY TREE BUFFER
55. SILVERADO PARK FITNESS ZONE
56. TANAKA GREENBELT
57. TANAKA PARK EXPANSION
58. WARDLOW STREETSCAPE IMPROVEMENTS/710 OVERPASS
59. 27TH ST ALLEY IMPROVEMENTS

* Denotes available funding

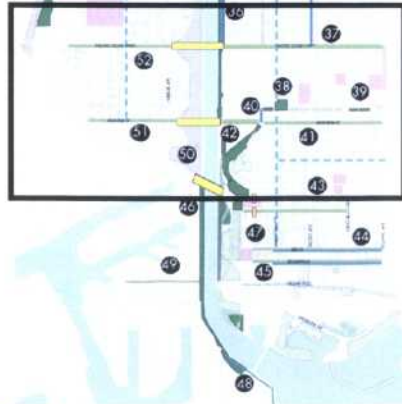
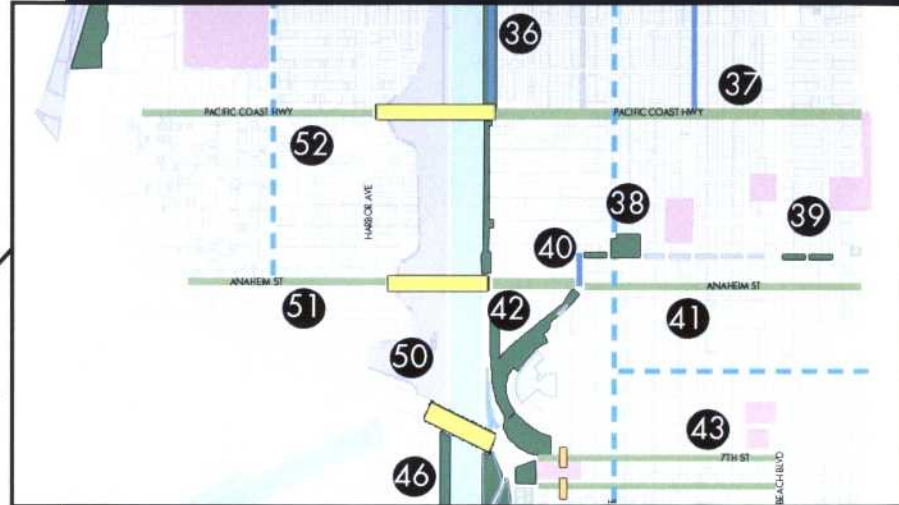

NEIGHBORHOOD IMPROVEMENTS

MELÉNDRÉZ
FEBRUARY 2008

14th Street Park Expansion And Anaheim Street River Connection



- 1 DEVELOPMENT OF PROPOSED SEASIDE PARK
- 2 OPEN SPACE CONNECTION TO MAGNOLIA YARDS REDEVELOPMENT / RIVERLINK
- 3 OPEN SPACE MID-BLOCK CONNECTION TO DRAKE PARK TO THE SOUTH
- 4 MAGNOLIA YARDS / RIVERLINK PLAN AREA
- 5 EXPANSION OF 14TH STREET LINEAR PARK FROM PINE AVE. TO LONG BEACH BLVD.
- 6 EXTENSION OF STREETSCAPE AND PEDESTRIAN IMPROVEMENTS FROM LONG BEACH BLVD. TO ATLANTIC AVE.
- 7 CONNECTIONS TO WASHINGTON MIDDLE & LONG BEACH POLYTECHNIC HIGH SCHOOL

DESIGN INTENT
Build on the 14th Street Park areas and enhance their connectivity to the west, Drake Park, and its associated RiverLink park spaces to the south, and Washington Middle School to the east.

APPLICATION
14th Street, or other local streets in the corridor neighborhoods with excess right of way, that can be repurposed as open space.



FIGURE 4-12: 14TH STREET PARK EXPANSION AND ANAHEIM STREET RIVER CONNECTION

Conceptual Plans on Key Map, Figure 4-4

Livable Schools Concept



1 SAFE, PEDESTRIAN FRIENDLY INTERSECTIONS; CURB EXTENSIONS

2 MID BLOCK CROSSINGS

3 GREEN STREETS

Street tree planting, sidewalk improvements, bioswales and natural drainage systems

4 PARKING LOT IMPROVEMENTS

Shade parking areas with tree plantings; incorporate pervious paving and natural drainage systems, bioswales; capture storm water runoff from surrounding streets

5 PERVIOUS SURFACES AND RE-GREENING TECHNIQUES

Tree plantings, bioswales, minimized paving, pervious surfaces; above and underground cisterns and planters to collect grey water for reuse, etc.

6 HEALTH OF THE INDOOR ENVIRONMENT

Improve indoor air quality with air filtration systems; use low- or no-voc paints and materials; install double-paned windows for noise abatement and pollutant sealing; provide ample daylighting for classrooms

7 JOINT USE

Negotiate joint use agreements to allow access to school fields and recreation facilities after school hours and on weekends

DESIGN INTENT

Improve the livability of corridor neighborhoods by enhancing their existing assets, such as schools

Improve corridor schools' sustainability and environmental contribution to their neighborhoods over the long term

Recreate schools as environments that teach about livability and sustainability

Expand the City's open space and recreational facilities and system, despite the fact that new park space is difficult to find in this dense corridor area

APPLICATION

All schools in the I-710 Corridor

FIGURE 4-14: LIVABLE SCHOOLS CONCEPT

Alley Greening Concepts



CONCEPT ONE
Pervious Paving; Tree Planting

CONCEPT TWO
"Hollywood track" Pervious Paving with planting

CONCEPT THREE
Secure Alley Park with tree Plantings, pathway, areas for additional plantings

DESIGN INTENT

Implement a range of creative solutions to the problem of deteriorating alleys in neighborhoods throughout the corridor.

Where automobile and service access is required, rehabilitate paving only to the degree necessary to accommodate it. Where motorized vehicle access can be eliminated, explore securing the right of way areas and creating shared green space for residents to use and potentially maintain.

Enhance the permeability of the spaces, while acting on opportunities to green neighborhoods, expand the urban forest, and turn currently degraded areas into assets.

APPLICATION

Degraded alleys throughout the corridor



EXAMPLES OF ALLEY GREENING

FIGURE 4-15: ALLEY GREENING CONCEPTS

Conceptual Plan **B** on Key Map, Figure 4-4

Introduction

Community Input

Plan Concepts

Conclusion

What Will Success Look Like?

Community awareness of livability issues and actions

Community vision to guide investments in corridor neighborhoods

Information to feed into other citywide, countywide and regional planning processes



Transportation &
Infrastructure Committee
October 8, 2008

COMMUNITY **Livability**Plan

All Roads Lead Home

I-710 Corridor Neighborhoods
LONG BEACH CALIFORNIA