

October 20, 2020

R-14

HONORABLE MAYOR AND CITY COUNCIL
City of Long Beach
California

RECOMMENDATION

Authorize the City Manager, or designee, to execute all documents necessary for a new Right-of-Entry Permit to Camp Fire Angeles, a nonprofit 501c3, for the construction of Discovery Trails at DeForest Park, for a period of two years from September 1, 2020 through August 30, 2022, with the option to renew for one year; and, the approval of the Discovery Trails for public recreation, which meets a recreational need within the City. (District 9)

DISCUSSION

The DeForest Park Vision Plan (Vision Plan) was produced in partnership with Conservation Corps of Long Beach, Camp Fire Angeles (Camp Fire), the DeForest Park Neighborhood Association, and the Parks, Recreation and Marine Department (Department) and serves as a visionary document to guide potential future development of DeForest Park (Park). While the Vision Plan is a plan for future park investment, anticipated over a long-term horizon and implemented incrementally over time as resources allow, funding has been secured to begin early action projects n.

Camp Fire was awarded a \$645,286 grant by the Port of Long Beach to build a series of Discovery Trails in the Park. The Discovery Trails are proposed to be located in the northern section of the Park, north of the existing Community Center building (Attachment A). Proposed trails link the north end of the Park with the walking path on the east side of the Park and the proposed nature trail and dry creek on the west side of the park. The trails will enhance park users' experience and Camp Fire programming, providing an outdoor area that is an extension of programming already provided in partnership with the Department at the Park Community Center. The trails will remain open to the public during regular park hours but will be closed for use by Camp Fire for programming purposes during specific evening classes.

Along the Discovery Trail, strategically placed lighting, mileage markers, and additional native, drought-tolerant shade-providing trees will foster a safe and unique walking experience off of the street amidst nature. A dry creek bed with bioswales along the eastern side of the Park will be created for stormwater management and nature play and can extend down to the entrance of the DeForest Wetlands. Plans also include an environmental outdoor classroom to host supplemental educational programs. Additionally, Discovery Trails will contain several small group gathering spaces that spur off of the pathway and can be programmed as a youth camping or nature education site programmed by the City's community partners. These small group gathering spaces include seating to provide break-

out locations for specialized hands-on demonstrations and practice by students, and other community team-building group experiences. New plantings of trees and shrubs will help meet the Port Community Grant objectives of reducing air pollution and environmental sustainability, providing benefits of dynamic controlled water usage while also providing campers, walkers, and neighbors with the sense of discovery and adventure.

Camp Fire has been serving young people and their families in the greater Long Beach area since 1923. Camp Fire groups continue to be the oldest, continuously operating program of the Council. Camp Fire is chartered to serve Long Beach, Artesia, Bellflower, Cerritos, and Signal Hill and, recently assumed jurisdiction of four additional Los Angeles County cities. Camp Fire offers a variety of programs through community collaborations.

It is anticipated that the Department will enter into a long-term lease, anticipated for 20 years, with Camp Fire for the operation of the Discovery Trails where Camp Fire will provide free and fee-based youth camp programming and family community classes, along with public access in the northern section of the Park. A proposed lease will be brought to the Parks and Recreation Commission and City Council for consideration at a later date. The new trails will ultimately become the property of the City. The Discovery Trails help to address the 0.9 acres of parkland per 1,000 residents in North Long Beach versus the 5.6 acres of parkland per 1,000 residents citywide by adding trails where none currently exist, maximizing park access and open space programming. This is a priority project identified in the Vision Plan, which was produced through an inclusive community engagement process consistent with the City's Language Access Policy.

On July 16, 2020, the Parks and Recreation Commission approved the new park amenity and the issuance of a Right-of-Entry (ROE) Permit from September 1, 2020 to August 30, 2022, or until a City Council-approved lease could be executed. The ROE Permit allows construction of the trails to begin.

It is requested that the City Council authorize the ROE Permit to begin construction. Camp Fire's proposal is aligned with the Vision Plan for the development, beautification, and maintenance of the Park. The permit will contain the following major terms and conditions:

- Permittee: Camp Fire Angeles, a nonprofit 501c3 corporation.
- Location: DeForest Park (Attachment A).
- Use/Program: Construction of Discovery Trails.
- Term: Two years, from September 1, 2020 through August 30, 2022.
- Option to Renew: One, one-year option to renew at the discretion of the Department Director.

- Termination: Either party may terminate the permit upon 60 days written notice to the other party. Termination provisions will ensure Permittee will not leave the Department with an unfinished building or site.
- Funding: All demolition, site preparation, and construction will be provided by Permittee. Any additional funding be needed for the completion of the Discovery Trails will be secured by the Permittee. The Department will not provide any funding, supplies, or staff support, other than review of the proposed site work, and a liaison for communication purposes, unless approved in advance and in writing by the Department Director.
- Site Preparation: Permittee will demolish existing restroom building, remove all debris, cap any unused utilities, and prepare the site for a new building structure.
- Ongoing Maintenance and Rights: Permittee will enter into lease with the City for the long-term operation of the Discovery Trails. The lease will be completed prior to the conclusion of the ROE Permit and the opening of the trails.
- Permits: Permittee will pay fees and secure all demolition, grading, utility, and construction permits necessary for the construction of the Discovery Trails. Copies of all permits will be submitted to the Department prior to construction. All contractors will be licensed, bonded and insured, and must follow all City policies for prevailing wage when working on public property.
- Insurance: Permittee and its agents will maintain all applicable insurance and endorsements, as required and approved by the City Risk Manager

This matter was reviewed by Deputy City Attorney Arturo D. Sanchez and Revenue Management Officer Geraldine Alejo on October 1, 2020.

SUSTAINABILITY

Project funding from the Port of Long Beach Community Grants Program secured by Camp Fire will support the implementation of the first phase of the Vision Plan, increasing access to open space that reduces greenhouse gas emissions and improves air quality. This grant will provide new passive walking trails that encourage healthy outdoor exercise, which help to decrease obesity and other adverse health impacts. This Project will use and feature sustainable materials. This Project will comply with the City's green building and water efficiency policies, Park Development Standards and increases the amount of open space acres, consistent with the City's Open Space Element.

TIMING CONSIDERATIONS

City Council action is requested on October 20, 2020, to execute the ROE Permit expeditiously to move forward with design and construction of the Discovery Trails to meet the requirements of the Port of Long Beach Community Grants Program.

FISCAL IMPACT

The total project cost associated with the Discovery Trails will be the responsibility of Camp Fire, funded through a grant from the Port of Long Beach's Community Grants Program Parks and Open Space Grant. Prior to project completion, the Department will return to the City Council with a long-term lease agreement with Camp Fire. The lease agreement term is anticipated for 20 years and will specify that Camp Fire will be responsible for the ongoing operating and maintenance costs. The lease terms are currently under development. However, when the lease concludes, it is anticipated that the operating and maintenance costs will be the responsibility of the City. The estimated cost and funding source are currently unknown. City staff costs associated with worksite review, project coordination, as well as management of the permit and lease agreement, will be funded within current resources in the General Fund Group in the Parks, Recreation and Marine Department.

This recommendation has no staffing impact beyond the normal budgeted scope of duties and is consistent with the existing City Council priorities. It is anticipated there will be a positive local job impact associated with this recommendation through the hiring of construction contractors.

SUGGESTED ACTION:

Approve the recommendation.

Respectfully submitted,



BRENT DENNIS
DIRECTOR OF PARKS,
RECREATION AND MARINE

Attachment A: DeForest Park Discovery Trails Map

APPROVED:



THOMAS B. MODICA
CITY MANAGER

DeForest Park Vision Plan

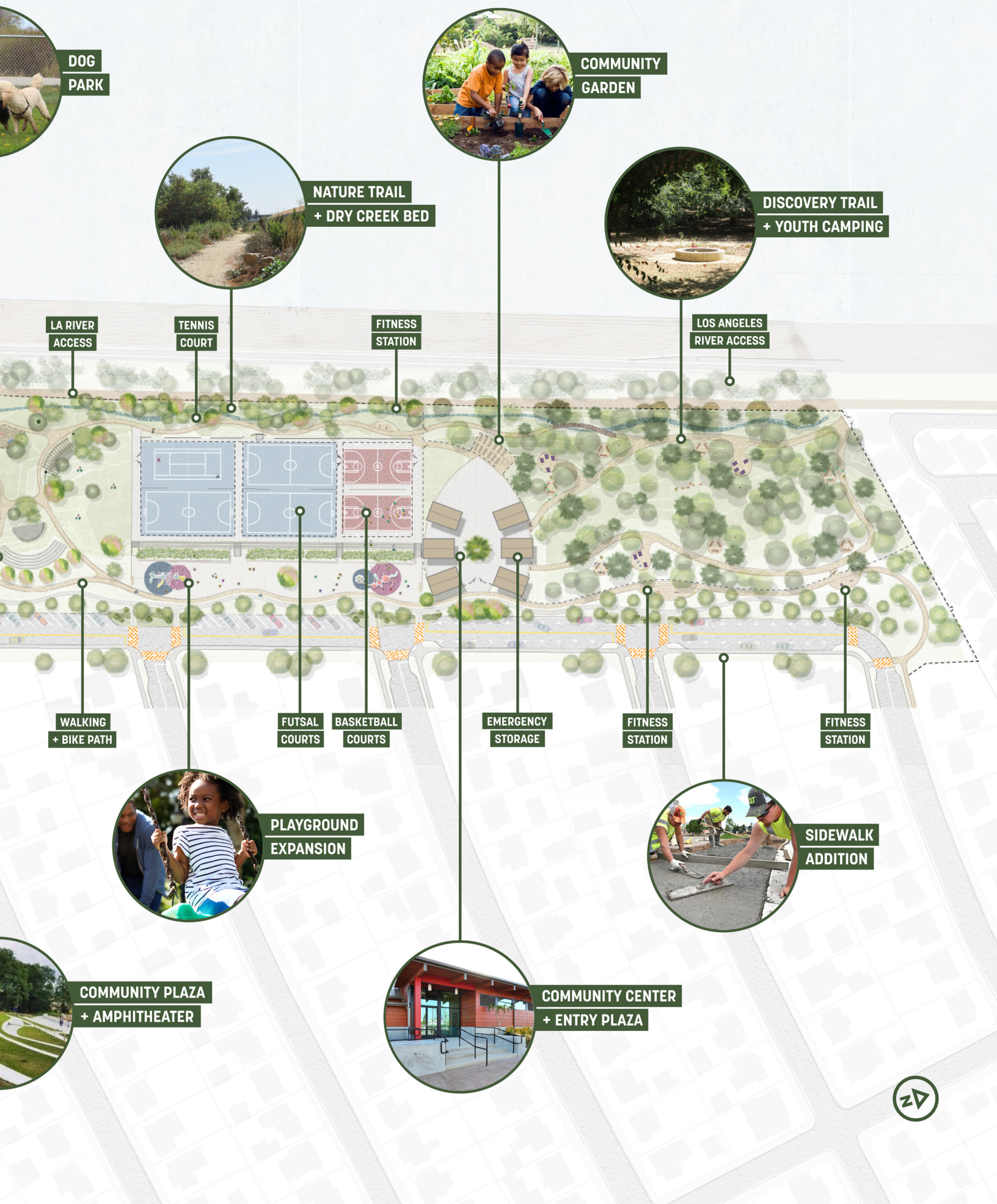

**DOG
PARK**

**COMMUNITY
GARDEN**

**NATURE TRAIL
+ DRY CREEK BED**

**DISCOVERY TRAIL
+ YOUTH CAMPING**

**LA RIVER
ACCESS**

**TENNIS
COURT**

**FITNESS
STATION**

**LOS ANGELES
RIVER ACCESS**

**WALKING
+ BIKE PATH**

**FUTSAL
COURTS**

**BASKETBALL
COURTS**

**EMERGENCY
STORAGE**

**FITNESS
STATION**

**FITNESS
STATION**

**PLAYGROUND
EXPANSION**

**SIDEWALK
ADDITION**

**COMMUNITY PLAZA
+ AMPHITHEATER**

**COMMUNITY CENTER
+ ENTRY PLAZA**



DeForest Park Discovery Trails



DeFOREST PARK SITE PLAN



DeFOREST NEIGHBORHOOD



CAMP FIRE AT DeFOREST PARK PLAN



FENCING OPTIONS



POTENTIAL CAMPFIRE PLANT PALETTE



TOP TO BOTTOM - LEFT TO RIGHT: TOYON, CALIFORNIA LAUREL, INCENSE CEDAR, CATALINA IRONWOOD

POTENTIAL AIR POLLUTION REMOVAL PLANTS

DeForest Park Discovery Trails



QUERCUS agrifolia- California Coast Live Oak

Category: Tree

Evergreen: Yes

Origin: California

Height: 30-60 feet

Width: 40-70 feet

Leaves: Leathery, Dark Green, Holly Like Leaves with Toothed Edges

Fruit: Acorns

Exposure: Full Sun

Irrigation (H2O Info): Low to Moderate Water Needs

Plant Factor: M/L

Zones: 7-9, 14-24

DeForest Park Discovery Trails



CALOCEDRUS decurrens- Incense Cedar

Category: Tree/ Conifer

Evergreen: Yes

Origin: California Native

Height: 40-60 feet

Width: 10-20 feet

Leaves: Shiny Green Foliage

Fruit: Reddish Brown Cones

Exposure: Full Sun

Irrigation (H2O Info): Low Water Needs

Plant Factor: L

Zones: 2-12, 14-24

DeForest Park Discovery Trails



SEQUIOA sempervirens- Coast Redwood

Category: Tree

Origin: California Native

Evergreen: Yes

Flower Color: Not significant

Height: 60-100 feet

Width: 10-30 feet

Exposure: Sun or light shade

Drought Tolerant: Yes

Irrigation (H2O Info): Medium Water Needs

Sunset Zones: 4-9, 14-24

DeForest Park Discovery Trails



PINUS eldarica- Afghan Pine

Category: Tree

Evergreen: Yes

Origin: Russia, Afghanistan, Pakistan

Height: 50-80 feet

Width: 20-35 feet

Leaves: Dark Green Needles in Groups

Cones: Oval to Oblong 3" long

Exposure: Full Sun to Partial Sun

Irrigation (H2O Info): Regular to Low Water Needs

Plant Factor: M/L

Zones: 8,9, 13-24

DeForest Park Discovery Trails



CEDRUS deodara- Deodar Cedar

Category: Tree

Evergreen: Yes

Origin: Western Himalayas

Height: 60-80 feet

Width: 30 feet

Trunk: Branch Tips and Tree Top Droop to Produce a Weeping Habit

Leaves: Needles

Fruit: Pine Cones

Exposure: Full Sun

Irrigation (H2O Info): Regular Water Needs

Plant Factor: M/L

Cultivars: Provide Varying Sizes and Foliage Color

Zones: 3-9, 14-24

DeForest Park Discovery Trails



JUNIPERUS californica- California Juniper

Category: Tree

Evergreen: Yes

Origin: California

Height: 10-40 feet

Width: 10-40 feet

Trunk: Smooth Red Brown Bark Peels off in Thin Flakes

Leaves: Rich Yellow Green Foliage is composed of Small Overlapping Scales

Fruit: Blue Gray Round Fruit Matures in Early Spring

Exposure: Full Sun to Partial Shade

Irrigation (H2O Info): Medium to Low Water Needs

Plant Factor: M/L

Zones: 3-11, 14-24

DeForest Park Discovery Trails



PINUS canariensis- Canary Island Pine

Category: Tree

Evergreen: Yes

Origin: Canary Islands

Height: 50-80 feet

Width: 20-35 feet

Leaves: New Growth is Bluish Green, Mature Growth is Dark Green

Cones: Oval, Yellowish Brown

Exposure: Full Sun to Partial Sun

Irrigation (H2O Info): Regular to Low Water Needs

Plant Factor: M/L

Zones: 8,9, 13-24

DeForest Park Discovery Trails



SEQUOIA sempervirens 'Aptos Blue'- Aptos Blue Coast Redwood

Category: Tree

Evergreen: Yes

Origin: California Native

Height: 70-100 feet

Trunk: Reddish Brown Bark, Lateral Branching is Uniform and Symmetrical

Leaves: Medium Blue-Green Narrow, Pointed, Feather-like

Exposure: Partial Shade, Sun

Irrigation (H2O Info): Regular Water Needs

Plant Factor: H

Zones: 7-9, 14-24

DeForest Park Discovery Trails



PINUS halepensis- Aleppo Pine

Category: Tree

Evergreen: Yes

Origin: Mediterranean Region

Height: 30-60 feet

Width: 20-40 feet

Trunk: Branches are Flexible and Wispy when Young

Leaves: Light Green Needles

Cones: Oval to Oblong, Brown when Mature

Exposure: Full Sun

Irrigation (H2O Info): Low Water Needs

Plant Factor: L/VL

Zones: 7-23