



CITY OF LONG BEACH

R-29

DEPARTMENT OF PUBLIC WORKS

333 West Ocean Boulevard 9th Floor • Long Beach, CA 90802 • (562) 570-6383 • Fax (562) 570-6012

September 17, 2013

HONORABLE MAYOR AND CITY COUNCIL
City of Long Beach
California

RECOMMENDATION:

Request the City Attorney to prepare an amendment to the Long Beach Municipal Code, Sections 10.12.010 and 10.12.020 relating to Speed Limits on City Streets as recommend by the City Traffic Engineer. (Districts 4, 5)

DISCUSSION

Under the provisions of Section 40802 of the California Vehicle Code, engineering and traffic surveys are a necessary prerequisite to radar enforcement of speed limits. Any posted limit, other than the maximum limit of 65 miles per hour (mph) or the prima facie 25 mph limit on local streets in a business or residential district must be justified by such a survey in order to employ radar enforcement. The City updates the engineering and traffic surveys for each speed zone every five years to validate speed limits and to facilitate enforcement within the City.

Based upon the results of 103 engineering and traffic surveys recently conducted and approved by the City Traffic Engineer, two street segments warrant a 5 mph decrease, and one street segment warrants a 5 mph increase of their existing speed limits. In addition, an establishment of new speed limit zones is recommended on three street segments within the newly developed Douglas Park area. The remaining 97 segments warranted no change in existing limits, but remain enforceable based upon their updated surveys previously administratively approved by the City Traffic Engineer. The following street segments, as highlighted on the attached vicinity maps, are recommended for change in speed limit:

| <u>Street</u> | Limits | | Speed Limit Change | |
|--------------------|----------------|-----------------------|---------------------------|-----------|
| | From | To | From | To |
| Stearns Street | Clark Avenue | Marwick Avenue | 35 | 30 |
| Termino Avenue | Anaheim Street | Hathaway Avenue | 30 | 25 |
| Lakewood Boulevard | Carson Street | 710' S. of Conant St. | 40 | 45 |

The establishment of new speed limit zone on three street segments within the Douglas Park development are recommended as follows:

HONORABLE MAYOR AND CITY COUNCIL

September 17, 2013

Page 2

| <u>Street</u> | Limits | | Speed Limit |
|----------------|------------------|--------------------|--------------------|
| | From | To | |
| Conant Street | Heinemann Avenue | Lakewood Boulevard | 35 |
| Cover Street | West City Limit | Lakewood Boulevard | 30 |
| Worsham Avenue | Carson Street | Conant Street | 30 |

This matter was reviewed by Deputy City Attorney Amy R. Webber on August 27, 2013 and by Budget Management Officer Victoria Bell on August 26, 2013.

TIMING CONSIDERATIONS

Council action on this matter is not time critical.

FISCAL IMPACT

The cost of materials and installation of the proposed "Speed Limit" signs is estimated at \$1,800. Sufficient funds are budgeted in the Gas Tax Street Improvement Fund (SR181) in the Department of Public Works (PW) to support this activity.

SUGGESTED ACTION:

Approve recommendation.

Respectfully submitted,

ARA MALOYAN, PE
ACTING DIRECTOR OF PUBLIC WORKS

P:\CL\Speed Limit CL revised.v2.doc
AM:DR:AK:td

APPROVED:

PATRICK H. WEST
CITY MANAGER

Attachments

- Exhibit A-Stearns St
- Exhibit B-Termino Ave
- Exhibit C-Lakewood Blvd
- Exhibit D-Conant St.
- Exhibit E-Cover St.
- Exhibit F-Worsham Ave

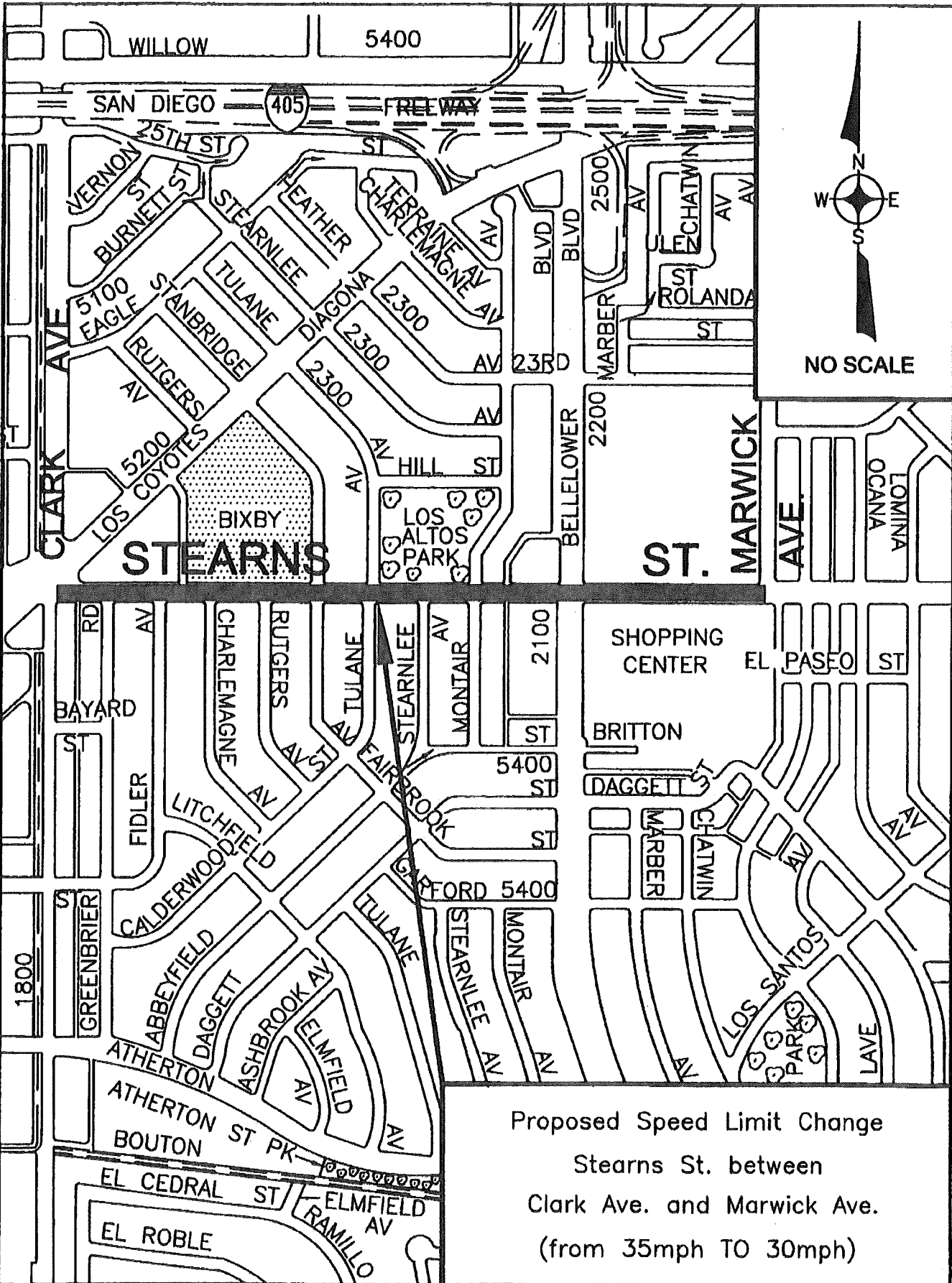
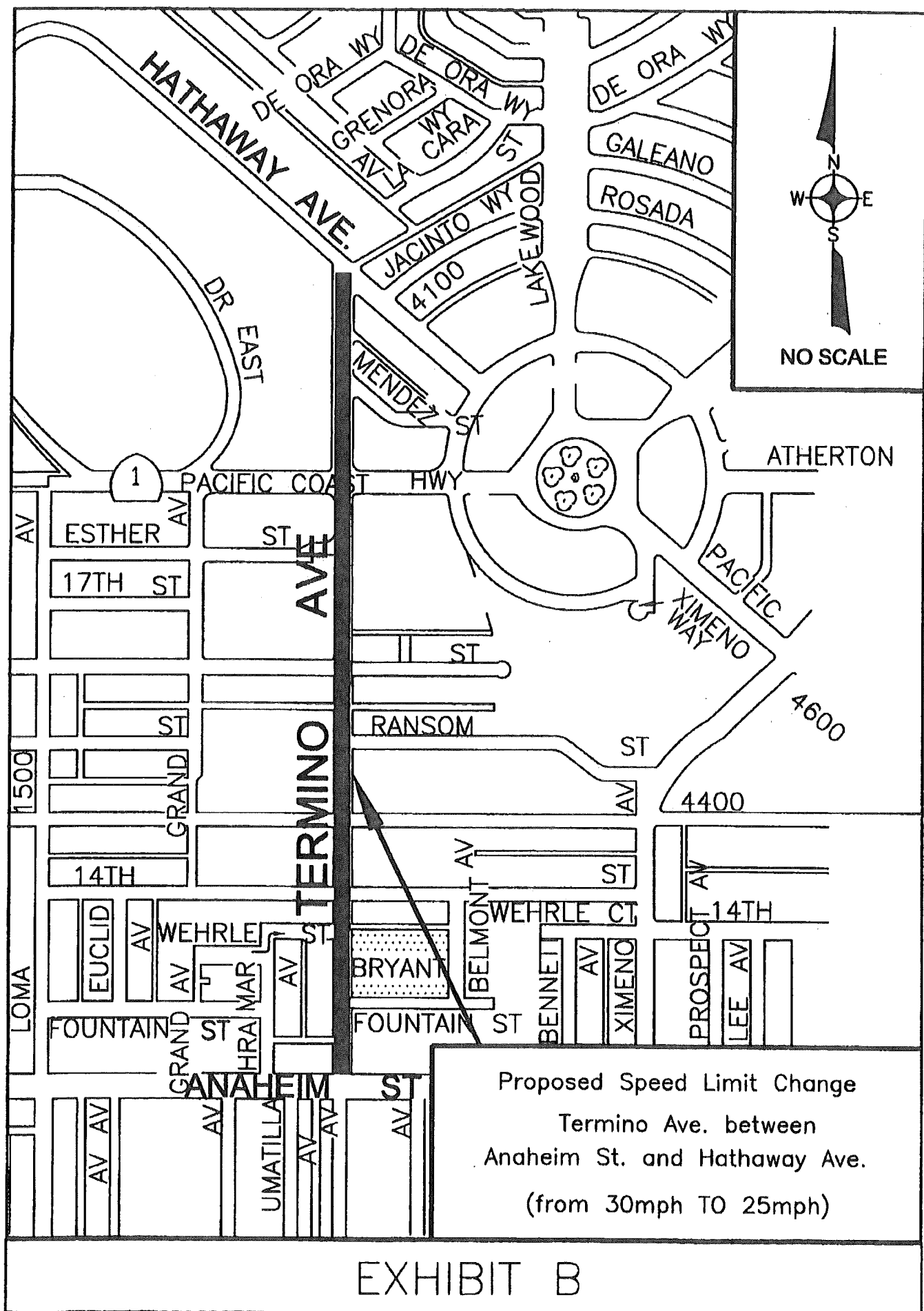

EXHIBIT A



Proposed Speed Limit Change
 Termino Ave. between
 Anaheim St. and Hathaway Ave.
 (from 30mph TO 25mph)

EXHIBIT B

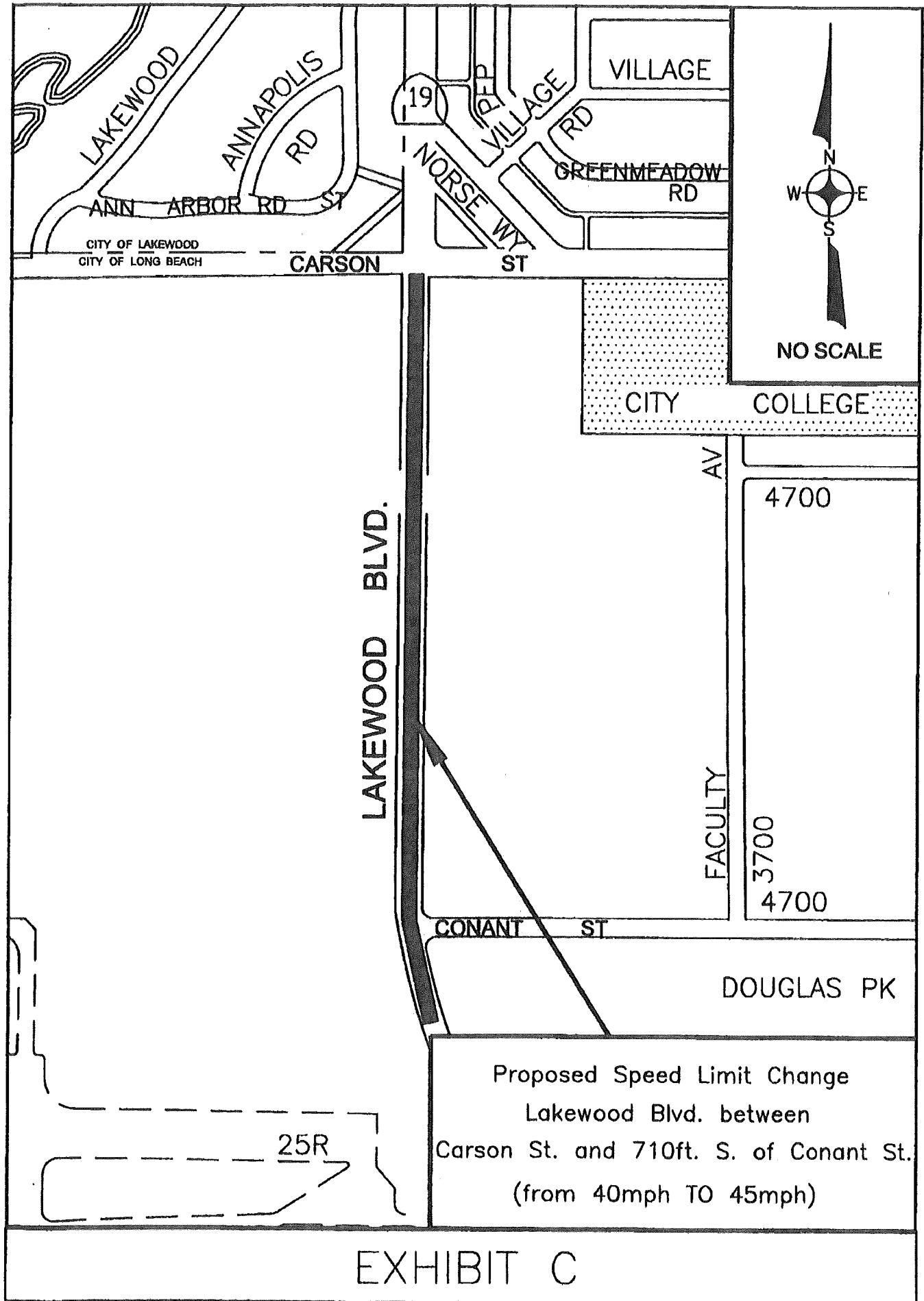
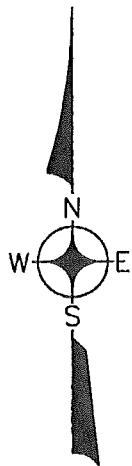
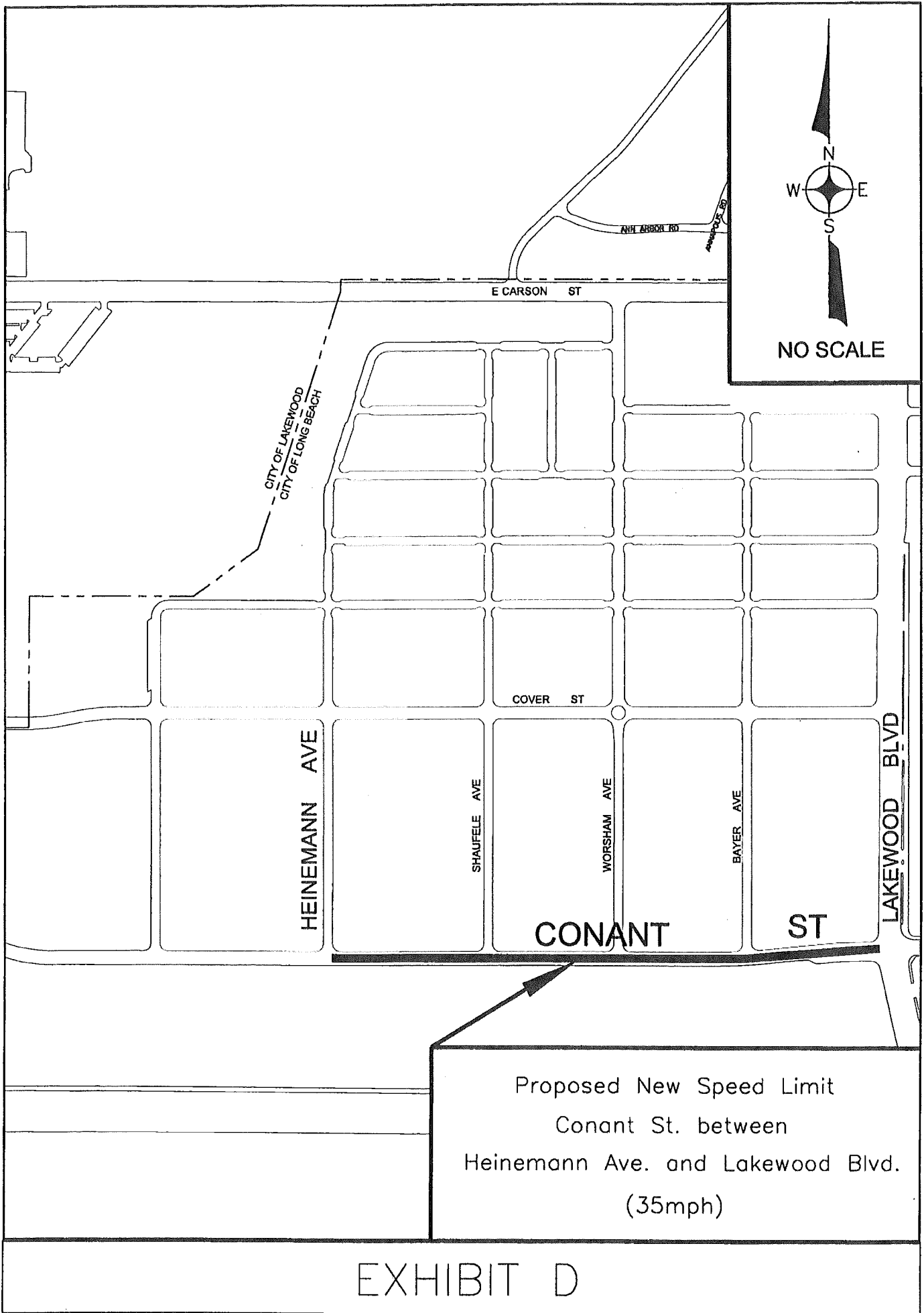

EXHIBIT C



NO SCALE

CITY OF LAKEWOOD
CITY OF LONG BEACH

E CARSON ST

COVER ST

HEINEMANN AVE

SHAUFELE AVE

WORSHAM AVE

BAYER AVE

LAKEWOOD BLVD

CONANT ST

Proposed New Speed Limit
Conant St. between
Heinemann Ave. and Lakewood Blvd.
(35mph)

EXHIBIT D

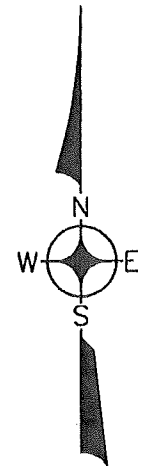
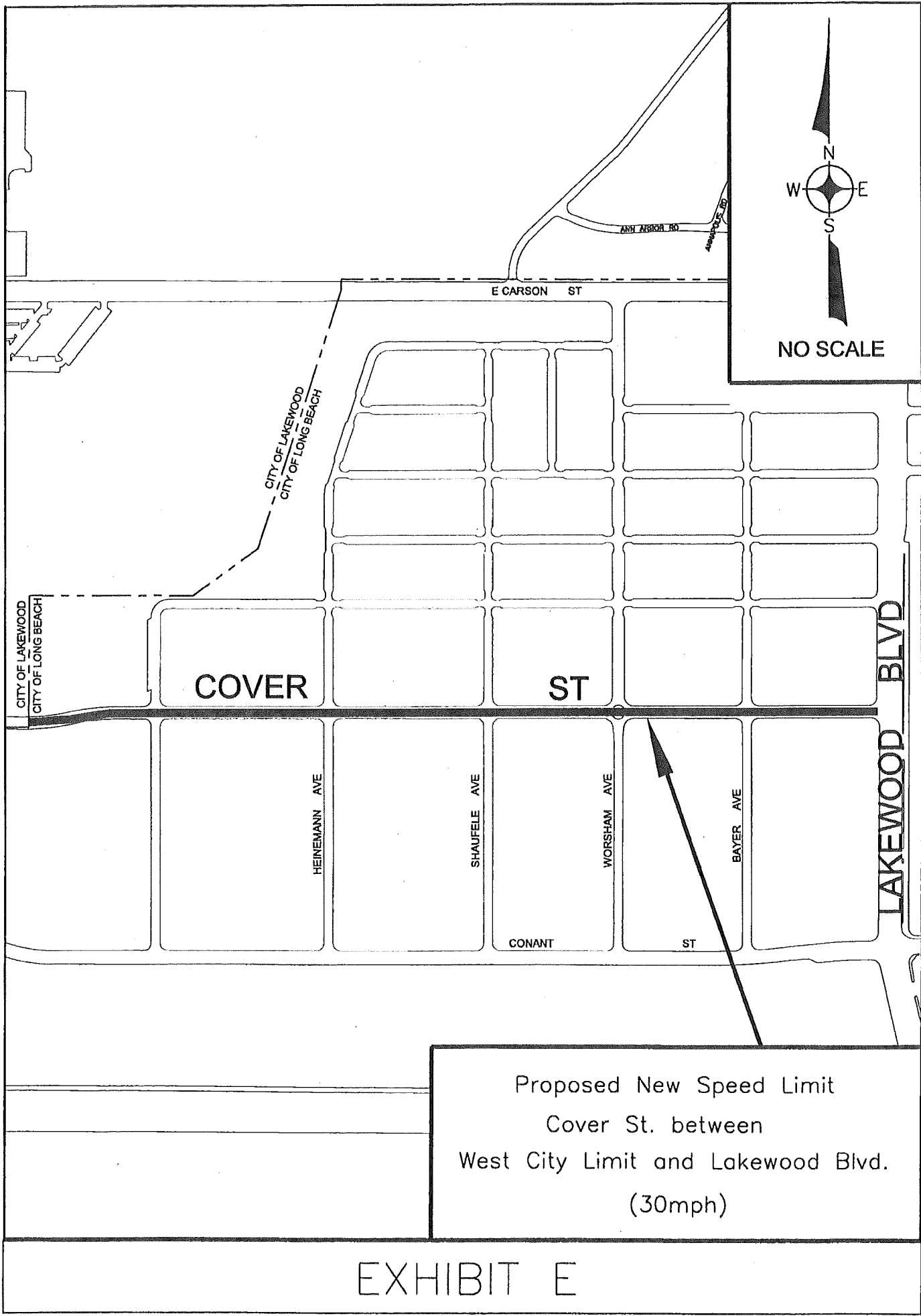

NO SCALE

COVER

ST

LAKWOOD BLVD

CITY OF LAKWOOD
CITY OF LONG BEACH

CITY OF LAKWOOD
CITY OF LONG BEACH

E CARSON ST

HEINEMANN AVE

SHAUFELLE AVE

WORSHAM AVE

BAYER AVE

CONANT

ST

Proposed New Speed Limit
Cover St. between
West City Limit and Lakewood Blvd.
(30mph)

EXHIBIT E

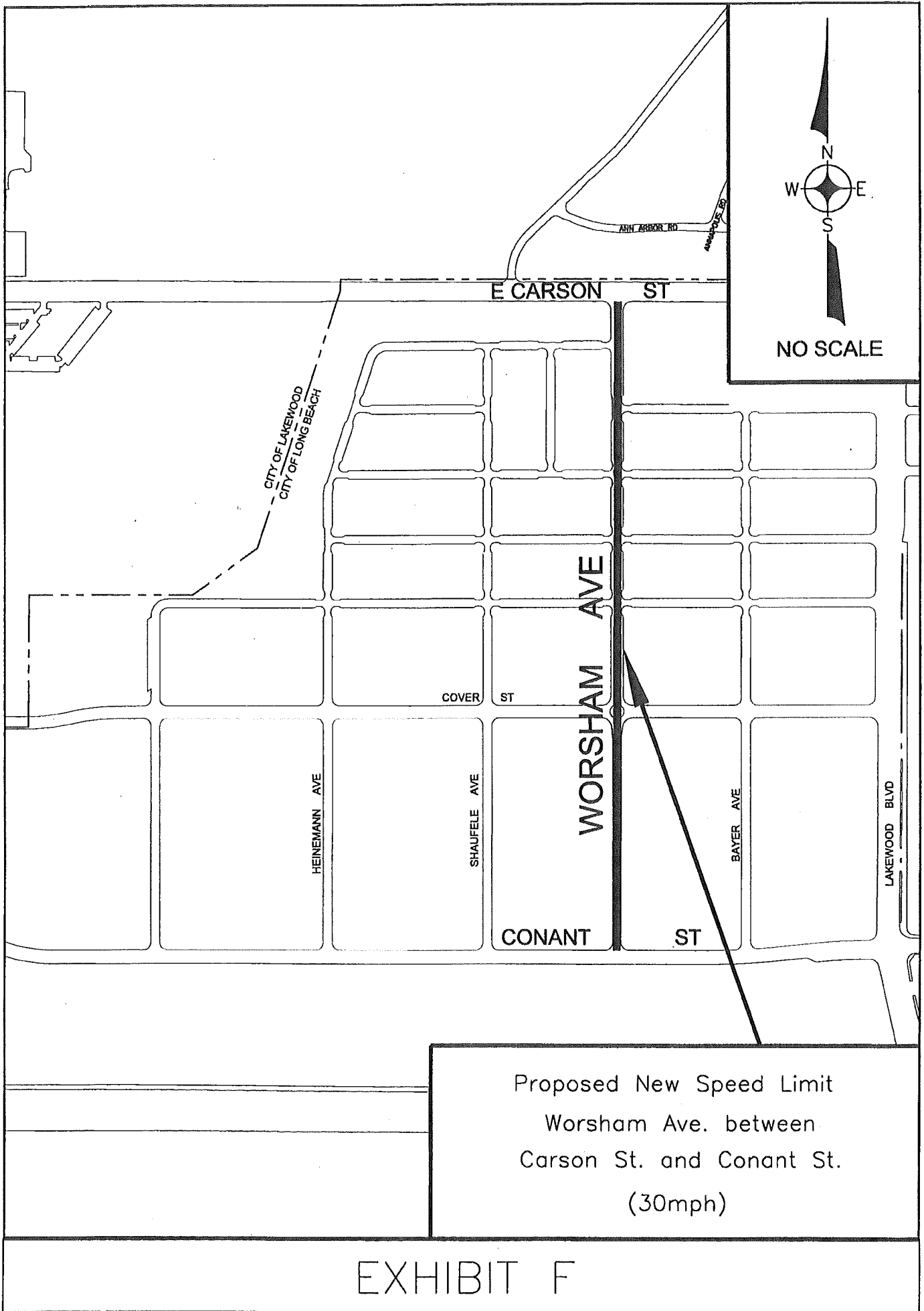

EXHIBIT F