



CITY OF LONG BEACH

H-4

DEPARTMENT OF PUBLIC WORKS

333 WEST OCEAN BOULEVARD • LONG BEACH, CA 90802 • (562) 570-6383 • FAX (562) 570-6012

November 11, 2008

HONORABLE MAYOR AND CITY COUNCIL
City of Long Beach
California

RECOMMENDATION:

Hold a public hearing and conclude the election of the property owners regarding the undergrounding of utilities between 5430 and 5544 The Toledo to be funded by Assessment District No. 08-01; Adopt the attached resolutions overruling protests, determining results of the election, adopting the Engineer's Report, confirming assessments and ordering the improvements, if supported by the majority of votes in the election. (District 3)

DISCUSSION

On September 23, 2008, City Council adopted RES-08-0116, declaring its intention to order improvements and to form Assessment District No. 08-01, and RES-08-0117, preliminarily approving the Engineering Report for the Assessment District and calling for a public hearing and a property owner election for the Assessment District on November 11, 2008. The September 23rd council letter describing the project is attached as Exhibit A. Ballots were subsequently mailed to each property owner of record within the proposed Assessment District as provided for by California law. If the majority of votes cast in the election support the formation of the Assessment District, the City Council may confirm the assessment and order the work to be done. In conformance with the California Environmental Quality Act, Categorical Exemption Number CE-110-08 was filed for this project.

This matter was reviewed by Chief Assistant City Attorney Heather Mahood on October 23, 2008 and Budget Management Officer Victoria Bell on October 22, 2008

TIMING CONSIDERATIONS

The date of this action was set by Resolution No. RES-08-0117.

**DIRECTOR'S OFFICE
BUDGET & PERSONNEL**
333 W. Ocean Blvd., 9th Floor
Long Beach, CA 90802
Ph. (562) 570-6383
Fax (562) 570-6012

ENGINEERING
333 W. Ocean Blvd., 9th Floor
Long Beach, CA 90802
Ph. (562) 570-6634
Fax (562) 570-6012

**ENVIRONMENTAL
SERVICES**
2929 E. Willow Street
Long Beach, CA 90806
Ph. (562) 570-2850
Fax (562) 570-2861

FLEET SERVICES
2600 Temple Avenue
Long Beach, CA 90806
Ph. (562) 570-5400
Fax (562) 570-5414

PUBLIC SERVICE
1601 San Francisco Avenue
Long Beach, CA 90813
Ph. (562) 570-2782
Fax (562) 570-2729

FISCAL IMPACT

If the election is successful, there will be a 30-day cash collection period for property owners to prepay their assessments. Subsequently, it is anticipated that the City, by future action, will issue tax-exempt bonds for the remaining amount. In order to reduce costs, the property owners propose that the bonds be sold as a direct private placement rather than as a public offering. The private placement will eliminate certain costs including printing, registration, servicing costs, and the underwriter's discount. If the direct placement is unsuccessful, the project may be underfunded and therefore infeasible. In this scenario, the bonds will not be issued.

Naples Elementary School is located within the proposed assessment district with an assessment of \$122,488. This assessment cannot be enforced and therefore this amount will be collected from other property owners within the assessment district prior to the issuance of any bonds.

There will be no fiscal impact to the City.

SUGGESTED ACTIONS:

Approve recommendation.

Respectfully submitted,

MICHAEL P. CONWAY
DIRECTOR OF PUBLIC WORKS

APPROVED:

for PATRICK H. WEST
CITY MANAGER



CITY OF LONG BEACH

DEPARTMENT OF PUBLIC WORKS

UB-13

333 WEST OCEAN BOULEVARD • LONG BEACH, CA 90802 • (562) 570-6383 • FAX (562) 570-6012

September 23, 2008

HONORABLE MAYOR AND CITY COUNCIL
City of Long Beach
California

RECOMMENDATION:

Adopt resolutions related to the undergrounding of utilities between 5430 and 5544 The Toledo: 1) Resolution of intention to order improvements and to form Assessment District No. 08-01; and 2) Resolution of preliminary approval of engineer's report, calling for a public hearing and election on November 11, 2008. (District 3)

DISCUSSION

Property owners adjoining The Toledo between 5430 to 5544 The Toledo have petitioned the City of Long Beach to underground the aerial utilities along this street portion, with the understanding that such undergrounding must be financed as an assessment district. The utilities proposed to be undergrounded are electrical service, telephone and cable communication lines. The maximum cost of this project is estimated at \$1,335,000, which includes the construction of utility conduit infrastructure, the placement of distribution lines, assessment engineering, city administrative costs, bond issuance, and funded interest for 12 months. Connection of the individual properties to the new underground system is at the expense of each property owner. The petition was signed by owners of over two-thirds of the parcels in the district, weighted by value of the proposed individual assessments. A description of the work is attached as Exhibit A, a map of the proposed assessment district is attached as Exhibit B, and the per-parcel assessment spread is attached as Exhibit C.

If City Council finds that this undergrounding of utilities is in the best interest of the community, that this project would enhance public safety and the overall aesthetics of the area, and that the benefits of this project are of more than local or ordinary public benefit, they may adopt a resolution declaring their intention to order the improvements and form an assessment district pursuant to the Municipal Improvement Act of 1913. By passage of this resolution, Harris & Associates shall be appointed as the Engineer of Work for the assessment district, and Quint & Thimmig LLP shall be designated as bond counsel.

**DIRECTOR'S OFFICE
BUDGET & PERSONNEL**
333 W. Ocean Blvd., 9th Floor
Long Beach, CA 90802
Ph. (562) 570-6383
Fax (562) 570-6012

ENGINEERING
333 W. Ocean Blvd., 9th Floor
Long Beach, CA 90802
Ph. (562) 570-6634
Fax (562) 570-6012

**ENVIRONMENTAL
SERVICES**
2929 E. Willow Street
Long Beach, CA 90806
Ph. (562) 570-2850
Fax (562) 570-2861

FLEET SERVICES
2600 Temple Avenue
Long Beach, CA 90806
Ph. (562) 570-5400
Fax (562) 570-5414

PUBLIC SERVICE
1601 San Francisco Avenue
Long Beach, CA 90813
Ph. (562) 570-2782
Fax (562) 570-2729

City Council is required to consider the engineer's report containing a description of the improvements, a diagram showing the boundaries of the assessment district, an estimate of the total cost of the improvements, and the apportionment of this cost to each parcel within the district. A copy of this report is attached as Exhibit D. If the report is found to be sufficient, City Council may adopt a resolution approving the report, setting a date for a public hearing, and calling for an election of the property owners within the district. The City Clerk shall then be directed to mail notices of the hearing and ballots to all persons owning property in the proposed district. If the property owners of no more than 50 percent of the total cost of improvements file a protest against the proposed improvement, City Council may confirm the assessment.

Chief Assistant City Attorney Heather Mahood prepared the attached resolutions on May 30, 2008. In conformance with the California Environmental Quality Act, Categorical Exemption Number CE-110-08, was filed for this project.

This matter was reviewed by Chief Assistant City Attorney Heather Mahood on July 30, 2008 and Budget Management Officer Victoria Bell on July 30, 2008.

TIMING CONSIDERATIONS

Utility company estimates of project cost are time sensitive. City Council action is requested on September 23, 2008 in order to respond to the property owners' petition without unnecessary delay, as delay could adversely affect project costs.

FISCAL IMPACT

There is no fiscal impact to the City, as the proposed undergrounding of utilities is to be financed by the assessment district. Although the Naples Elementary School property lies within the proposed district, with an estimated assessment of \$122,488, which assessment collection cannot be enforced, this amount will be collected from other beneficiaries prior to the issuance of the bond.

The district will be funded with City issued tax-exempt bonds. In order to reduce costs to the owners of the 36 residential properties in the district, the project proponents propose that the bonds be sold as a direct private placement rather than as a public offering. Certain bond finance costs were therefore deleted from the project total, including disclosure counsel; financial printing, registration and servicing; the underwriter's discount; and an excess bond reserve of 5 percent. If the direct placement of bonds is unsuccessful, the project may be underfunded and therefore infeasible.

HONORABLE MAYOR AND CITY COUNCIL
September 23, 2008
Page 3

SUGGESTED ACTION:

Approve recommendation.

Respectfully submitted,

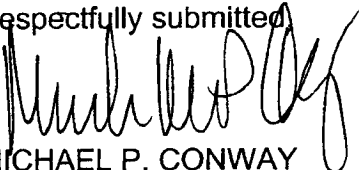

MICHAEL P. CONWAY
DIRECTOR OF PUBLIC WORKS

P:\CL\ROW Toledo 20B UUD Res of Int.doc
MAC:SC:db

Attachments

APPROVED:



PATRICK H. WEST
CITY MANAGER

Assessment District No. 08-01 (The Toledo Utility Undergrounding)
The Work

These improvements are proposed to be constructed and installed in the general location referred to as Assessment District No. 08-01 (The Toledo Utility Undergrounding).

The proposed facilities include the undergrounding of electric, telephone and cable on The Toledo south of Second Street and west of Geneva Walkway.

Improvements:

1. The removal of existing overhead power, telephone and cable wires and poles.
2. Removal of overhead resident service drops.
3. Construction of mainline underground power, telephone and cable conduit, with appurtenant manholes and pullboxes.
4. Construction of service conduit and appurtenances to property line.
5. Installation of new conductor within said conduit and underground structures by the utility companies.
6. Construction of street lighting conversion improvements.

These improvements will be designed by Southern California Edison, Verizon Telephone and Charter Cable. The City of Long Beach will inspect the work to ensure conformance to City standards and specifications where applicable.

Note: The foregoing improvements do not include any individual service connections on private properties. Each owner of property located within the Assessment District will be responsible for arranging for and paying for work on his or her property necessary to connect facilities constructed by the public utilities in the public streets and alleys to the points of connection on the private property.

EXHIBIT A

ASSESSMENT DIAGRAM FOR
 ASSESSMENT DISTRICT No. 08-01
 (THE TOLEDO UTILITY UNDERGROUNDING)
 CITY OF LONG BEACH, COUNTY OF LOS ANGELES
 STATE OF CALIFORNIA

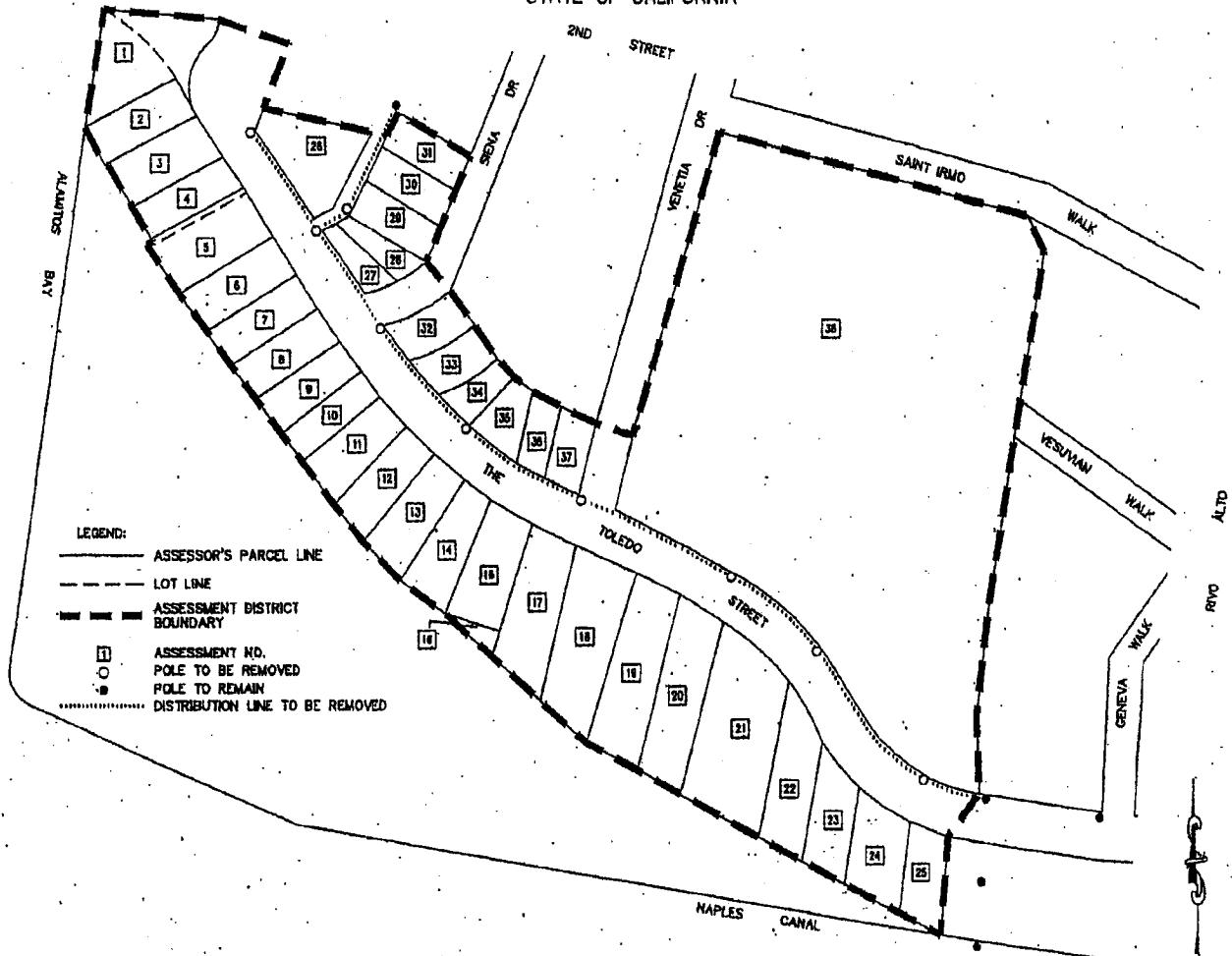

THE BOUNDARY OF THE PROPOSED ASSESSMENT DISTRICT COINCIDES WITH THE ASSESSOR'S PARCELS WITHIN THE BOUNDARY SHOWN ON THIS MAP. FOR PARTICULARS OF LINES AND DIMENSIONS OF ASSESSOR'S PARCELS, REFERENCE IS MADE TO THE MAPS OF THE LOS ANGELES COUNTY ASSESSOR.

SCALE: 1"=75'

EXHIBIT B

City of Long Beach
 Assessment District No. 08-01 (The Toledo Utility Undergrounding)
 Preliminary Engineer's Report

Parcel Address	Asmt No.	APN	Land Use	BENEFIT POINTS				ASSESSMENT CALCULATIONS				Total Assessment
				Aesthetics Benefit Points	Safety Benefit Points	Reliability Benefit Points	Total Benefit Points	Construction Costs	Incidental Costs	Financing Costs	Total	
5430 E THE TOLEDO	1	7244-018-021	SFR	1.0	1.0	1.0	3.00	\$30,033.36	\$2,997.22	\$4,087.12	\$37,117.70	
5436 E THE TOLEDO	2	7244-018-022	SFR	1.0	1.0	1.0	3.00	\$30,033.36	\$2,997.22	\$4,087.12	\$37,117.70	
5438 E THE TOLEDO	3	7244-018-012	SFR	1.0	1.0	1.0	3.00	\$30,033.36	\$2,997.22	\$4,087.12	\$37,117.70	
5446 E THE TOLEDO	4	7244-018-024	SFR	1.0	1.0	1.0	3.00	\$30,033.36	\$2,997.22	\$4,087.12	\$37,117.70	
5450 E THE TOLEDO	5	7244-018-026	SFR	1.0	1.0	1.0	3.00	\$30,033.36	\$2,997.22	\$4,087.12	\$37,117.70	
5456 E THE TOLEDO	6	7244-018-028	SFR	1.0	1.0	1.0	3.00	\$30,033.36	\$2,997.22	\$4,087.12	\$37,117.70	
5460 E THE TOLEDO	7	7244-018-030	SFR	1.0	1.0	1.0	3.00	\$30,033.36	\$2,997.22	\$4,087.12	\$37,117.70	
5464 E THE TOLEDO	8	7244-018-032	SFR	1.0	1.0	1.0	3.00	\$30,033.36	\$2,997.22	\$4,087.12	\$37,117.70	
5468 E THE TOLEDO	9	7244-018-034	SFR	1.0	1.0	1.0	3.00	\$30,033.36	\$2,997.22	\$4,087.12	\$37,117.70	
5472 E THE TOLEDO	10	7244-018-020	SFR	1.0	1.0	1.0	3.00	\$30,033.36	\$2,997.22	\$4,087.12	\$37,117.70	
5474 E THE TOLEDO	11	7244-018-036	SFR	1.0	1.0	1.0	3.00	\$30,033.36	\$2,997.22	\$4,087.12	\$37,117.70	
5480 E THE TOLEDO	12	7244-018-038	SFR	1.0	1.0	1.0	3.00	\$30,033.36	\$2,997.22	\$4,087.12	\$37,117.70	
5484 E THE TOLEDO	13	7244-018-018	SFR	1.0	1.0	1.0	3.00	\$30,033.36	\$2,997.22	\$4,087.12	\$37,117.70	
5488 E THE TOLEDO	14	7244-018-040	SFR	1.0	1.0	1.0	3.00	\$30,033.36	\$2,997.22	\$4,087.12	\$37,117.70	
5490 E THE TOLEDO	15	7244-018-018	SFR	1.0	1.0	1.0	3.00	\$30,033.36	\$2,997.22	\$4,087.12	\$37,117.70	
5490 E THE TOLEDO	16	7244-019-030	SFR	0.0	0.0	0.0	0.00	\$0.00	\$0.00	\$0.00	\$0.00	
5494 E THE TOLEDO	17	7244-019-028	SFR	1.0	1.0	1.0	3.00	\$30,033.36	\$2,997.22	\$4,087.12	\$37,117.70	
5500 E THE TOLEDO	18	7244-019-026	SFR	1.0	1.0	1.0	3.00	\$30,033.36	\$2,997.22	\$4,087.12	\$37,117.70	
5508 E THE TOLEDO	19	7244-019-015	SFR	1.0	1.0	1.0	3.00	\$30,033.36	\$2,997.22	\$4,087.12	\$37,117.70	
5518 E THE TOLEDO	20	7244-019-014	SFR	1.0	1.0	1.0	3.00	\$30,033.36	\$2,997.22	\$4,087.12	\$37,117.70	
5528 E THE TOLEDO	21	7244-019-013	SFR	1.0	1.0	1.0	3.00	\$30,033.36	\$2,997.22	\$4,087.12	\$37,117.70	
5530 E THE TOLEDO	22	7244-019-020	SFR	1.0	1.0	1.0	3.00	\$30,033.36	\$2,997.22	\$4,087.12	\$37,117.70	
5534 E THE TOLEDO	23	7244-019-021	SFR	1.0	1.0	1.0	3.00	\$30,033.36	\$2,997.22	\$4,087.12	\$37,117.70	
5538 E THE TOLEDO	24	7244-019-022	SFR	1.0	1.0	1.0	3.00	\$30,033.36	\$2,997.22	\$4,087.12	\$37,117.70	
5544 E THE TOLEDO	25	7244-019-012	SFR	1.0	1.0	1.0	3.00	\$30,033.36	\$2,997.22	\$4,087.12	\$37,117.70	
5437 E THE TOLEDO	26	7244-015-010	2DU	1.0	2.0	1.0	4.00	\$40,044.49	\$3,966.29	\$5,649.49	\$49,660.27	
105 SIENA DR	27	7244-015-011	SFR	0.5	1.0	1.0	2.50	\$25,027.80	\$2,497.68	\$3,405.93	\$30,931.41	
115 SIENA DR	28	7244-015-012	SFR	0.0	1.0	1.0	2.00	\$20,022.24	\$1,998.15	\$2,724.74	\$24,745.13	
117 SIENA DR	29	7244-015-013	SFR	0.0	1.0	1.0	2.00	\$20,022.24	\$1,998.15	\$2,724.74	\$24,745.13	
123 SIENA DR	30	7244-015-014	SFR	0.0	1.0	1.0	2.00	\$20,022.24	\$1,998.15	\$2,724.74	\$24,745.13	
125 SIENA DR	31	7244-015-015	SFR	0.0	0.5	0.0	0.50	\$5,005.56	\$499.54	\$681.19	\$6,186.29	
5467 E THE TOLEDO	32	7244-014-039	SFR	0.5	1.0	1.0	2.50	\$25,027.80	\$2,497.68	\$3,405.93	\$30,931.41	
5471 E THE TOLEDO	33	7244-014-018	SFR	1.0	1.0	0.33	2.33	\$23,359.28	\$2,331.17	\$3,178.87	\$28,869.32	
5475 E THE TOLEDO	34	7244-014-019	SFR	1.0	1.0	0.0	2.00	\$20,022.24	\$1,998.15	\$2,724.74	\$24,745.13	
5481 E THE TOLEDO	35	7244-014-020	SFR	1.0	1.0	0.0	2.00	\$20,022.24	\$1,998.15	\$2,724.74	\$24,745.13	
5485 E THE TOLEDO	36	7244-014-021	SFR	1.0	1.0	0.87	2.87	\$28,686.32	\$2,868.19	\$3,652.99	\$32,988.50	
101 VENETIA DR	37	7244-014-022	SFR	0.5	1.0	0.0	1.50	\$15,016.68	\$1,498.61	\$2,043.56	\$18,558.85	
Naples Elem. School	38	7244-017-900	SCHOOL	0.0	9.4	0.50	9.90	\$99,110.23	\$9,890.81	\$13,457.46	\$122,458.50	
							Totals:	107.90	\$1,080,206.00	\$107,800.00	\$147,000.00	\$1,335,006.00

EXHIBIT C

**Preliminary Engineer's Report for
Assessment District No. 08-01**

The Toledo Utility Undergrounding

**EXHIBIT D
(26 Pages)**

DRAFT

Preliminary Engineer's Report

for

**Assessment District No. 08-01
(The Toledo Utility Undergrounding)**

**Prepared under the provisions of the
Long Beach Assessment District
Procedural Ordinance
and, where applicable, the
Municipal Improvement Act of 1913**

For the

**City Engineer of the
City of Long Beach**
Los Angeles County, California

Prepared by:



Harris & Associates

July 30, 2008

TABLE OF CONTENTS

	Page
Introduction and Certifications	1
PART I Plans and Specifications	4
PART II Cost Estimates	5
PART III Assessment Roll and Method of Assessment Spread	6
Table 1 – Assessment Roll.....	8
Debt Limit Valuation	9
Exhibit 1 – Method of Assessment	10
PART IV Annual Administrative Assessment	16
PART V Boundary Map and Diagram of Assessment District	17
PART VI Description of Facilities	20
Right-of-Way Certificate	21
Certification of Completion of Environmental Proceedings.....	22

AGENCY: CITY OF LONG BEACH

PROJECT: ASSESSMENT DISTRICT NO. 08-01

TO: CITY COUNCIL

**ENGINEER'S "REPORT" PURSUANT TO THE
PROVISIONS OF SECTION 3.52.426
OF THE LONG BEACH MUNICIPAL CODE**

Pursuant to the provisions of Division IV of Chapter 3.52 of the Long Beach Municipal Code, Article XIID of the State Constitution, and, where applicable, Part 7.5 of the "Special Assessment Investigation, Limitation and Majority Protest Act of 1931", being Division 4 of the Streets and Highways Code of the State of California, and the "Municipal Improvement Act of 1913", being Division 12 of said Code, and the Resolution of Intention, adopted by the City Council of the CITY OF LONG BEACH, State of California, on August 19, 2008, in connection with the proceedings for Assessment District No. 08-01 (The Toledo Utility Undergrounding) (hereinafter referred to as the "Assessment District"), I, Mark Christoffels, P.E., City Engineer of the City of Long Beach, the duly appointed Engineer of Work, in conjunction with Joan E. Cox, P.E., a Registered Professional Engineer and authorized representative of Harris & Associates, herewith submits the "Report" for the Assessment District, consisting of six (6) parts as stated below.

PART I

This part contains the plans and specifications which describe the general nature, location and extent for the proposed improvements to be constructed, and are filed herewith and made a part hereof. Said plans and specifications are on file in the Office of the City Engineer.

PART II

This part contains an estimate of the cost of the proposed improvements, including capitalized interest, if any, incidental costs and expenses in connection therewith as set forth herein and attached hereto.

PART III

This part consists of the following information:

- A. A proposed assessment of the total amount of the costs and expenses of the proposed improvements upon the several subdivisions of land within the Assessment District, in proportion to the special benefits to be received by such subdivisions from said improvements, which is set forth upon the assessment roll filed herewith and made a part hereof.
- B. The total amount, as near as may be determined, of the total principal sum of all unpaid special assessments and special assessments required or proposed to be levied under any completed or pending assessment proceedings, other than that contemplated for the Assessment District, which would require an investigation and report under the "Special Assessment Investigation, Limitation and Majority Protest Act of 1931" against the total area proposed to be assessed.

- C. The total true value, determined from the latest Assessor's roll, of the parcels of land and improvements which are proposed to be assessed.

PART IV

This part contains the proposed maximum annual administrative assessment to be levied upon each subdivision or parcel of land within the Assessment District to pay the costs incurred by the CITY OF LONG BEACH, and not otherwise reimbursed, resulting from the administration and collection of assessments, from the administration and registration of any associated bonds and reserve or other related funds, or both.

PART V

This part contains a map showing the boundaries of the Assessment District, and a diagram showing the Assessment District, the boundaries and the dimensions of the subdivisions of land within said Assessment District, as the same existed at the time of the passage of the Resolution of Intention. The Boundary Map and Assessment Diagram are filed herewith and made a part hereof, and part of the assessment.

PART VI

This part shall consist of the following information:

- A. Description of Facilities
- B. Right-of-Way Certificate
- C. Environmental Certificate

This report is submitted on July 30, 2008.

HARRIS & ASSOCIATES

JOAN E. COX, P.E.
R.C.E. No. 41965

MARK CHRISTOFFELS, P.E.
CITY ENGINEER
CITY OF LONG BEACH
STATE OF CALIFORNIA

Preliminary approval by the CITY COUNCIL of the CITY OF LONG BEACH, CALIFORNIA, on the ____ day of _____, 2008.

CITY CLERK
CITY OF LONG BEACH
STATE OF CALIFORNIA

Final approval by the CITY COUNCIL of the CITY OF LONG BEACH, CALIFORNIA, on the ____ day of _____, 2008.

CITY CLERK
CITY OF LONG BEACH
STATE OF CALIFORNIA

Part I
Plans and Specifications

The plans and specifications to construct the utility undergrounding improvements, and any ancillary improvements thereof, for the area generally described as Assessment District No. 08-01, (The Toledo Utility Undergrounding), specifically The Toledo from south of Second Street to west of Geneva Walkway, describe the general nature, location and extent of the improvements for this Assessment District and are referenced herein and incorporated as if attached and a part of this Report.

Said Plans and Specifications for the improvements are on file in the office of the City Engineer.

**Part II
 Cost Estimate**

	<u>Estimated Costs</u>	
	Preliminary	Confirmed
CONSTRUCTION COSTS		
Infrastructure (includes de-watering, inspection, etc.)	\$600,000	
Southern California Edison	\$297,250	
City Light & Power (Street Light Improvements)	\$6,500	
Verizon Telephone	\$95,000	
Charter Cable	\$30,500	
Estimated Utility Contribution for Equivalent Overhead System	(\$47,250)	
Contingency (10%)	\$98,200	
Subtotal Costs:	<u>\$1,080,200</u>	
Total Construction Costs:	\$1,080,200	
INCIDENTAL EXPENSES (assuming direct placement of bonds with an investor)		
Assessment Engineering	\$30,000	
City Administration	\$3,000	
Financial Advisor	\$25,000	
Bond Counsel	\$33,000	
Disclosure Counsel	\$0	
Filing Fees	\$2,500	
Paying Agent	\$3,000	
Financial Printing, Registration and Servicing	\$0	
Incidental Contingencies	\$11,300	
Total Incidental Expenses:	<u>\$107,800</u>	
Total Construction and Incidental Expenses:	\$1,188,000	
FINANCING COSTS (assuming direct placement of bonds with an investor)		
Underwriter's Discount	0.00%	\$0
Bond Reserve	5.00%	\$67,000
Funded Interest @ 12 months @ 6.00%		\$80,000
Total Financial Costs:		<u>\$147,000</u>
DISTRICT FORMATION AMOUNT TO ASSESSMENT:		\$1,335,000

**Part III
Assessment Roll and
Method of Assessment Spread**

WHEREAS, on August 19, 2008 the City Council of the CITY OF LONG BEACH, State of California, did, pursuant to the provisions of the Long Beach Assessment District Procedural Ordinance, being Division IV of Chapter 3.52 of the Long Beach Municipal Code and, where applicable, the 1913 Act "Municipal Improvement Act of 1913", being Division 12 of the Streets and Highways Code, of the State of California, adopt its Resolution of Intention No. _____, for the installation and construction of certain public improvements, together with appurtenances and appurtenant work in connection therewith, in a special assessment district known and designated as ASSESSMENT DISTRICT NO. 08-01 (The Toledo Utility Undergrounding) (hereinafter referred to as the "Assessment District"); and

WHEREAS, said Resolution of Intention, as required by law, did direct the Engineer of Work to make and file a "Report", consisting of the following as required by Section 3.52.426 of the Long Beach Municipal Code:

- a. Description of improvements to be financed;
- b. An estimate of the total cost of the improvements and the amount to be assessed against the benefited lands within the Assessment District;
- c. Assessment Diagram showing the boundaries of the Assessment District, and reference to the County of Los Angeles Assessor's parcel numbers or other identification of parcels;
- d. A proposed assessment of the costs and expenses of the works of improvement levied upon the parcels within the boundaries of the Assessment District;
- e. The proposed maximum annual assessment to be levied upon each subdivision or parcel of land within the Assessment District to pay the costs incurred by the City and not otherwise reimbursed resulting from the administration and collection of assessments or from the administration and registration of any associated bonds and reserve or other related funds.

For particulars, reference is made to the Resolution of Intention as previously adopted.

NOW, THEREFORE, I, Mark Christoffels, P.E., City Engineer and Engineer of Work for the Assessment District, in conjunction with Joan E. Cox, P.E., the authorized representative of HARRIS & ASSOCIATES, do hereby submit the following:

1. Pursuant to the provisions of law and the Resolution of Intention, I have assessed the costs and expenses of the works of improvement to be performed in the Assessment District upon the parcels of land in the Assessment District specially benefited thereby in direct proportion and relation to the special benefits to be received by each of said parcels. For particulars as to the identification of said parcels, reference is made to the Assessment Diagram, a copy of which is attached hereto and incorporated herein.
2. As required by law, a Diagram is hereto attached, showing the Assessment District, as well as the boundaries and dimensions of the respective parcels and subdivisions of land within

said Assessment District as the same existed at the time of the passage of said Resolution of Intention, each of which subdivisions of land or parcels or lots respectively have been given a separate number upon said Diagram and in said Assessment Roll.

3. The subdivisions and parcels of land the numbers therein as shown on the respective Assessment Diagram as attached hereto correspond with the numbers as appearing on the Assessment Roll as contained herein.
4. NOTICE IS HEREBY GIVEN that bonds will be issued in accordance with Division IV of Chapter 3.52 of the Long Beach Municipal Code (the "Law") and, where applicable, Division 10 of the Streets and Highways Code of the State of California (the "Improvement Bond Act of 1915"), to represent all unpaid assessments, which bonds shall be issued not to exceed the legal maximum term as authorized by law, THIRTY (30) YEARS from the 2nd day of September next succeeding twelve (12) months from their date. Said bonds shall bear interest at a rate not to exceed the current legal maximum rate of 12% per annum.
5. By virtue of the authority contained in the Law and, where applicable, the "Municipal Improvement Act of 1913", and by further direction and order of the legislative body, I hereby recommend the following Assessment to cover the costs and expenses of the works of improvement for the Assessment District based on the costs and expenses as set forth below:

	As Preliminarily Approved	As Confirmed
Estimated Cost of Construction:	\$1,080,200	
Estimated Incidental Expenses:	\$107,800	
Estimated Financial Costs:	\$147,000	
Estimated Total to Assessment:	\$1,335,000	

For particulars as to the individual assessments and their descriptions, reference is made to Table 1 (Assessment Roll) attached hereto.

6. The Method of Assessment Spread is as set forth in the exhibit identified as Part III (Exhibit 1), which is attached hereto, referenced and so incorporated.

Table 1
Assessment Roll

Asmt No.	Assessor's Parcel Number	Total True Value	Existing Liens	Asmts As Preliminarily Approved	Asmts As Finally Confirmed & Recorded	Value to Lien Ratio
1	7244-016-021	\$2,677,766	\$0	\$37,117.70		72
2	7244-016-022	\$1,835,496	\$0	\$37,117.70		49
3	7244-016-012	\$670,830	\$0	\$37,117.70		18
4	7244-016-024	\$1,228,632	\$0	\$37,117.70		33
5	7244-016-026	\$2,494,596	\$0	\$37,117.70		67
6	7244-016-028	\$2,910,477	\$0	\$37,117.70		78
7	7244-016-030	\$1,781,857	\$0	\$37,117.70		48
8	7244-016-032	\$1,449,494	\$0	\$37,117.70		39
9	7244-016-034	\$1,769,351	\$0	\$37,117.70		48
10	7244-016-020	\$3,191,886	\$0	\$37,117.70		86
11	7244-016-036	\$2,557,126	\$0	\$37,117.70		69
12	7244-016-038	\$1,287,139	\$0	\$37,117.70		35
13	7244-016-018	\$1,242,340	\$0	\$37,117.70		33
14	7244-016-040	\$1,138,276	\$0	\$37,117.70		31
15	7244-019-018	\$2,866,520	\$0	\$37,117.70		77
16	7244-019-030	\$0	\$0	\$0.00		N/A
17	7244-019-028	\$2,106,231	\$0	\$37,117.70		57
18	7244-019-026	\$3,204,754	\$0	\$37,117.70		86
19	7244-019-015	\$270,350	\$0	\$37,117.70		7
20	7244-019-014	\$535,556	\$0	\$37,117.70		14
21	7244-019-013	\$4,993,920	\$0	\$37,117.70		135
22	7244-019-020	\$4,852,955	\$0	\$37,117.70		131
23	7244-019-021	\$296,199	\$0	\$37,117.70		8
24	7244-019-022	\$270,808	\$0	\$37,117.70		7
25	7244-019-012	\$1,372,556	\$0	\$37,117.70		37
26	7244-015-010	\$498,369	\$0	\$49,490.27		10
27	7244-015-011	\$171,807	\$0	\$30,931.41		6
28	7244-015-012	\$352,526	\$0	\$24,745.13		14
29	7244-015-013	\$369,987	\$0	\$24,745.13		15
30	7244-015-014	\$428,952	\$0	\$24,745.13		17
31	7244-015-015	\$773,100	\$0	\$6,186.29		125
32	7244-014-039	\$596,759	\$0	\$30,931.41		19
33	7244-014-018	\$770,961	\$0	\$28,869.32		27
34	7244-014-019	\$826,979	\$0	\$24,745.13		33
35	7244-014-020	\$1,085,000	\$0	\$24,745.13		44
36	7244-014-021	\$83,957	\$0	\$32,993.50		3
37	7244-014-022	\$83,742	\$0	\$18,558.85		5
38	7244-017-900	\$1,398,752	\$0	\$122,488.50		11
		\$54,446,006		\$1,335,000.00		41

Table 2
Debt Limit Valuation

A. ESTIMATED BALANCE TO ASSESSMENT	\$1,335,000
B. UNPAID SPECIAL ASSESSMENTS	\$0 *
TOTAL A & B	\$1,335,000
C. TRUE VALUE OF PARCELS	\$54,473,910 **
AVERAGE VALUE TO LIEN RATIO	41 :1

* Unpaid Special Assessments shall consist of the total principal sum of all unpaid special assessments previously levied or proposed to be levied other than in the instant proceedings.

** True Value of Parcels means the total value of the land and improvements as estimated and shown on the last equalized roll of the County.

This report does not represent a recommendation of parcel value, economic viability or financial feasibility, as that is not the responsibility of the Assessment Engineer.

CERTIFICATION

I, the undersigned City Engineer, do hereby certify that the total amount of the principal sum of the special assessments proposed to be levied, together with the principal amount of previously levied special assessments, as set forth above, do not exceed one-half (1/2) the total true value of the parcels proposed to be assessed.

EXECUTED on July 30, 2008.

HARRIS & ASSOCIATES

JOAN E. COX, P.E.
R.C.E. No. 41965

MARK CHRISTOFFELS, P.E.
CITY ENGINEER
CITY OF LONG BEACH
STATE OF CALIFORNIA

Exhibit 1 Method of Assessment

BACKGROUND

The Assessment District is formed under the authority of the Law and Article XIID of the California State Constitution, which require that local agencies levy assessments according to special benefit. In addition, Article XIID, Section 4, of the State Constitution requires that a parcel's assessment may not exceed the reasonable cost of the proportional special benefit conferred on that parcel. Section 4 provides that only special benefits are assessable and the local agency levying the assessment must separate the general benefits from the special benefits. It also requires that publicly owned property that benefits from the improvements be assessed. Neither the Law nor the State Constitution specifies the method or formula that should be used to apportion the costs to properties in any special assessment district proceedings. The responsibility for recommending an apportionment of the costs to properties which specially benefit from the improvements rests with the Assessment Engineer, who is appointed for the purpose of making an analysis of the facts and determining the correct apportionment of the assessment obligation. Therefore, costs and expenses of proposed improvement(s) will be apportioned against the properties by a formula or method that distributes the costs in direct proportion to the estimated special benefits these parcels receive from the improvements.

The approval of the assessments rests with the City Council. The Council renders its decision after hearing testimony and evidence presented at a public hearing and tabulating the assessment ballots, which are mailed to all record owners of property within the Assessment District. Only ballots delivered to the City prior to the close of the public hearing are tabulated. The Council's findings must include whether or not the assessment spread has been made in direct proportion to the estimated special benefits received by each parcel.

Apportionment of Special Benefit

The purpose of this Assessment District is to provide the financing to underground existing overhead electrical, telephone and cable facilities. These facilities are the direct source of service to the properties within the Assessment District.

The proposed replacement of existing overhead utility facilities (power, telephone and cable facilities) with underground facilities will provide a special benefit to the parcels who will be served by the new distribution facilities as a result of enhanced service, reliability and capacity, as well as improved safety. All new wires and equipment will be installed underground, which eliminates the threat of interrupted service by downed power lines due to wind and rain. Removal of the existing wood poles and the overhead wires will also aesthetically enhance all parcels that are directly adjacent to these facilities. By virtue of such benefits, the proposed improvements will increase the desirability and will specifically enhance the values of the properties within the Assessment District. Therefore, 100% of the proposed improvements are of direct and special benefit to the properties within the boundaries of this Assessment District.

All general benefits, if any, to the surrounding community and public in general from undergrounding of these local overhead utilities are intangible and are not quantifiable and are more

than adequately offset by the contribution to the project financing from sources other than the assessments.

Methodology

To establish the benefit to the individual parcels within the Assessment District, a Benefit Point system is used. Each parcel of land is assigned Benefit Points in proportion to the estimated special benefit the parcel receives relative to the other parcels within the Assessment District from the Utility Undergrounding Improvements. The highest and best use of each property is the basis on which the Benefit Points are assigned. For example, a vacant property is considered developed to its highest potential and connected to the system.

The special benefits from undergrounding the overhead utilities are segregated into three (3) categories, which are discussed below:

- **Improved Property Aesthetics Benefit.** This benefit relates to the improved aesthetics of the streetscape due to the removal of overhead wires and utility poles. The aesthetic benefit of removing poles and overhead lines adjacent to residential properties is deemed to be the same for all adjacent properties because the increase in property desirability from the construction of the improvements is considered the same. Residential parcels that are directly adjacent to streets with facilities being underground are considered to receive special benefit from the undergrounding project. Therefore, these properties are assigned one (1) Aesthetic Benefit Point (ABP) per parcel for Improved Property Aesthetics.

Poles and overhead lines being underground in alleys are not considered to provide significant aesthetic benefit, as the alleys are in the rear of the properties.

- Parcels that are adjacent to two streets, where only one street is part of the undergrounding project, are assigned half the benefit, or 0.5 ABP. (This applies to Asmt Nos. 27, 32, 37 and 38.)
- Parcels that are adjacent to only one street, where that street is not part of the undergrounding project, are deemed to receive no aesthetic benefit and are assigned 0 ABP. (This applies to Asmt Nos. 28, 29, 30 and 31.)
- Asmt No. 38, Naples Elementary School, is deemed to receive no aesthetic benefit from the undergrounding project, as improved aesthetics does not impact the desirability of a school property. Therefore, this property is assigned 0 ABP.
- **Improved Safety Benefit.** This benefit relates to the improved safety of having the overhead wires placed underground and having the power poles removed, which eliminates the threat of downed power lines and poles due to wind, rain and other unforeseeable events. All residential parcels that are directly adjacent to a street or alley with facilities being underground are considered to receive the same special benefit from the undergrounding project. Therefore, these residential properties are assigned one (1) Safety Benefit Point (SBP) for Improved Safety.
- Residential parcels that are adjacent to two streets or alleys that are part of the undergrounding project, are assigned twice the benefit, or 2 SBP. (This applies to Asmt No. 26.)

- Asmt No. 31 is adjacent to an alley that is part of the undergrounding project, but the pole directly adjacent to this property will remain, which reduces the safety benefit to this property. Therefore, this property is assigned half the benefit, or 0.5 SBP.
- Asmt No. 38, Naples Elementary School, receives benefit from improved safety from the undergrounding project, and this benefit is related to the benefit to residential property by comparing the length of frontage along the undergrounding project. The average frontage of the residential properties on The Toledo in this Assessment District is 53 feet and The Toledo frontage of the school is 497.94 feet, which is 9.4 times as long as the average residential property frontage. Therefore, Asmt No. 38 is assigned 9.4 SBP's.
- **Improved Service Reliability Benefit.** This benefit relates to the enhanced reliability of service from the utilities being underground, due to having all new wires and equipment and having that equipment underground, which reduces the threat of service interruption from downed power lines. All properties that are connected to poles and wires that are to be underground are considered to receive this benefit and are assigned one (1) Reliability Benefit Point (RBP) for Improved Service Reliability.
- Parcels that take no service from the wires or poles being underground receive no service reliability benefits and are therefore assigned 0 RBP. (This applies to Asmt Nos. 31, 35 and 37.)
- Properties that receive service from only one or two of the three utilities are assigned RBP's based on their proportion of utilities they receive service from. Therefore, properties that receive only Cable service from the utilities being underground are assigned 1/3 RBP (this applies to Asmt No. 33), and properties that receive only Cable and Telephone service from the utilities being underground are assigned 2/3 RBP (the applies to Asmt No. 36).
- Asmt No. 38, Naples Elementary School, receives benefit from improved service reliability, but has a back-up generator on the premises in case there are service interruptions. This reduces the benefit received by the school. Therefore, the benefit to the school from improved service reliability is considered to be half of what other parcels receive, so Asmt No. 38 is assigned 0.5 RBP's.

The three categories of Benefit Points are added together for each property to calculate the Total Benefit Points assigned to each property, as follows:

$$\begin{matrix} \text{Aesthetics} & & \text{Safety} & & \text{Reliability} & & \text{Total} \\ \text{Benefit Points} & + & \text{Benefit Points} & + & \text{Benefit Points} & = & \text{Benefit Points} \end{matrix}$$

The following table provides an example of how the Benefit Points are calculated for the various land uses.

Sample Typical Benefit Point Calculation Table

Land Use	Aesthetics Benefit Points	+	Safety Benefit Points	+	Reliability Benefit Points	=	Total Benefit Points
SFR	1	+	1	+	1	=	3
SCHOOL	0	+	9.4	+	0.5	=	9.9

Exemptions:

The following types of parcels are considered to be exempt from the assessment due to their having no benefit from the improvements because they have virtually no potential for development:

- Parcels that are unbuildable because they are too small.
- Parcels that are too small for a dwelling unit but may have ancillary uses to other residential properties, such as Asmt. No. 16.

These properties are assigned 0 Benefit Points.

Exceptions:

- 5548 E The Toledo Street (the parcel directly east of Asmt No. 25) has overhead utility lines directly adjacent to its property, along the easterly side, and takes service from these lines. These lines are not proposed to be underground; therefore, this property is not deemed to receive any benefit from the proposed undergrounding project.
- 5429 E The Toledo Street (the parcel directly north of Asmt No. 26) takes its service from the pole in the alley that will remain after this underground project is constructed. Because this pole is located in the middle of this property, this parcel is not considered to receive either an enhanced safety benefit or an enhanced reliability benefit from the undergrounding project.

Assessment Apportionment

Based on the findings above, it is our conclusion that the improvements specially benefit all developable properties in the Assessment District in proportion to the number of Benefit Points calculated for each property, such that:

$$\begin{array}{ccccccc} \text{Aesthetics} & & \text{Safety} & & \text{Reliability} & & \text{Total} \\ \text{Benefit Points} & + & \text{Benefit Points} & + & \text{Benefit Points} & = & \text{Benefit Points} \end{array}$$

Incidental Expenses and Financing Costs have been assessed to the entire Assessment District on a prorata basis relative to the total construction cost allocations.

Complete calculations for each assessment, providing the Benefit Points, the construction portion of the assessment, and incidental and financial components of the assessment are included in the Appendix.

DATED: July 30, 2008

HARRIS & ASSOCIATES

JOAN E. COX, P.E.
R.C.E. No. 41965

MARK CHRISTOFFELS, P.E.
CITY ENGINEER
CITY OF LONG BEACH
STATE OF CALIFORNIA

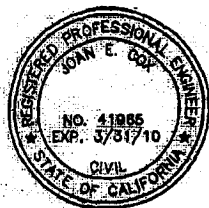

I, _____, as CITY CLERK of the CITY OF LONG BEACH, CALIFORNIA do hereby certify that the foregoing Assessment, together with the Diagram attached thereto, was filed in my office on the ____ day of _____, 2008.

CITY CLERK
CITY OF LONG BEACH
STATE OF CALIFORNIA

I, _____, as CITY CLERK of the CITY OF LONG BEACH, CALIFORNIA do hereby certify that the foregoing Assessment, together with the Diagram attached thereto, was preliminarily approved by the City Council of the CITY OF LONG BEACH, CALIFORNIA, on the ____ day of _____, 2008.

CITY CLERK
CITY OF LONG BEACH
STATE OF CALIFORNIA

I, _____, as CITY CLERK of the CITY OF LONG BEACH, CALIFORNIA do hereby certify that the foregoing Assessment, together with the Diagram attached thereto, was approved and confirmed by the City Council of said City on the ____ day of _____, 2008.

CITY CLERK
CITY OF LONG BEACH
STATE OF CALIFORNIA

I, _____, as SUPERINTENDENT OF STREETS of the CITY OF LONG BEACH, CALIFORNIA do hereby certify that the foregoing Assessment, together with the Diagram attached thereto, was recorded in my office on the ____ day of _____, 2008.

SUPERINTENDENT OF STREETS
CITY OF LONG BEACH
STATE OF CALIFORNIA

Part IV Annual Administrative Assessment

A proposed maximum annual administrative assessment shall be levied on each parcel of land and subdivision of land within the Assessment District to pay for necessary costs and expenses incurred by the CITY OF LONG BEACH, and not otherwise reimbursed, resulting from the administration and collection of assessments, from the administration or registration of any bonds and reserve or other related funds, or both. The maximum assessment is authorized pursuant to the provisions of Section 10204(f) of the Streets and Highways Code and shall not exceed five hundred dollars (\$500) per parcel, subject to an annual increase based on the annual change in the Consumer Price Index (CPI), during the preceding year ending in January, for all Urban Consumers in the Los Angeles, Riverside, and Orange County areas. The exact amount of the administration charge will be established each year by the Superintendent of Streets.

The annual administrative assessment will be collected in the same manner and in the same installments as the assessment levied to pay for the cost of the works of improvement.

Part V
Boundary Map and Diagram of Assessment

A reduced copy of the Boundary Map and Assessment Diagram are attached hereto. Full-sized copies of the Boundary Map and Assessment Diagram are on file in the Office of the City Clerk, of the City of Long Beach.

As required by the Act, the Assessment Diagram shows the exterior boundaries of the assessment district and the assessment number assigned to each parcel of land corresponding to its number as it appears in the Assessment Roll contained in Part III Table 1. Reference is hereby made to the Assessor's Parcel Maps of the County of Los Angeles for the boundaries and dimensions of each parcel of land.

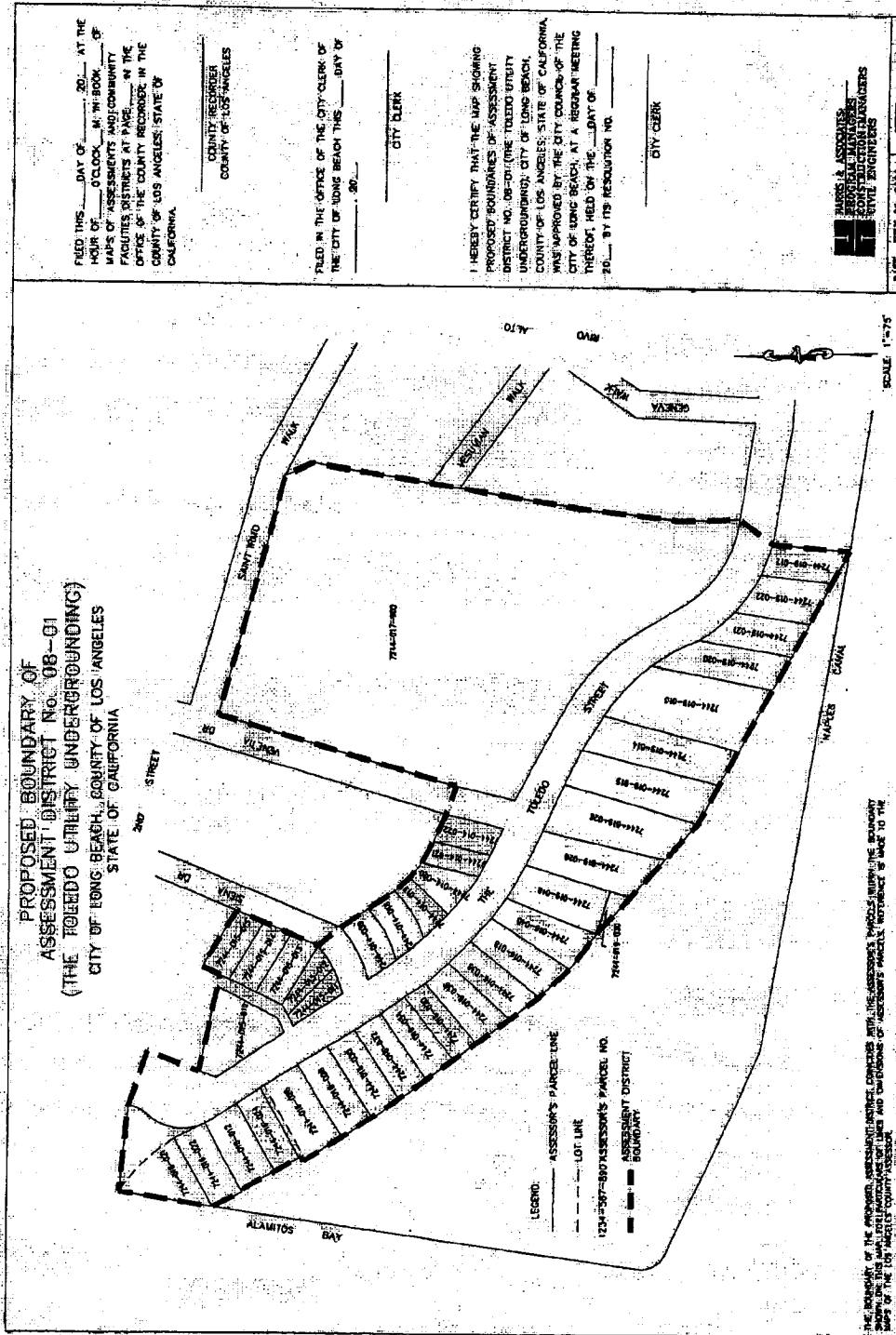

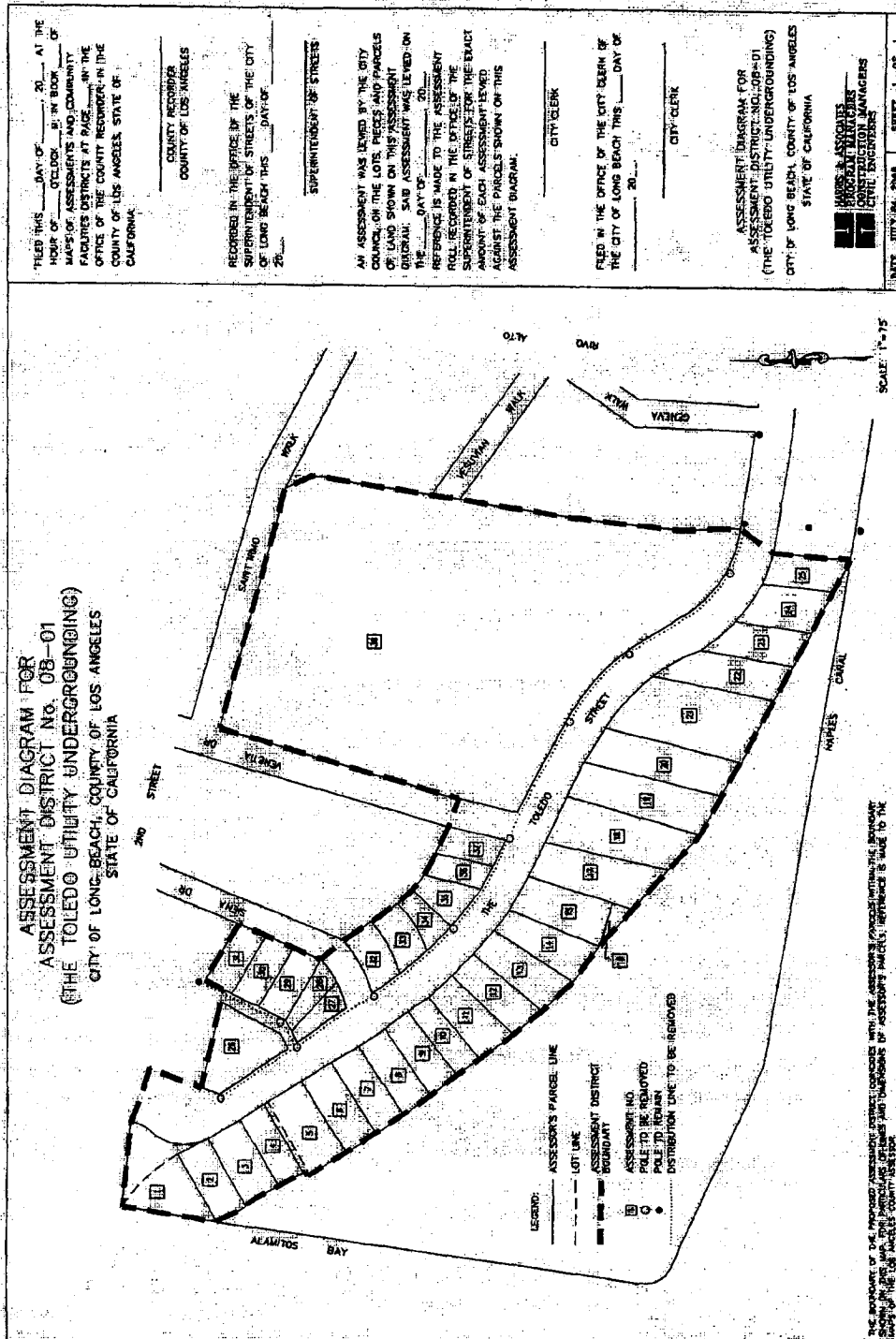

Part VI Description of Facilities

Below is a list of proposed improvements as allowed under the Law to be installed, or improved under the provisions of the Law, including the acquisition of required right-of-way and/or property. For the general location of the improvements to be constructed referenced is hereby made to the Plans and Specifications described in Part I of this report.

These improvements are proposed to be constructed and installed in the general location referred to as Assessment District No. 08-01 (The Toledo Utility Undergrounding).

The proposed facilities include the undergrounding of electric, telephone and cable on The Toledo south of Second Street and west of Geneva Walkway.

Improvements:

1. The removal of existing overhead power, telephone and cable wires and poles.
2. Removal of overhead resident service drops.
3. Construction of mainline underground power, telephone and cable conduit, with appurtenant manholes and pullboxes.
4. Construction of service conduit and appurtenances to property line.
5. Installation of new conductor within said conduit and underground structures by the utility companies.
6. Construction of street lighting conversion improvements.

These improvements will be designed by Southern California Edison, Verizon Telephone and Charter Cable. The City of Long Beach will inspect the work to ensure conformance to City standards and specifications where applicable.

Note: The foregoing improvements do not include any individual service connections on private properties. Each owner of property located within the Assessment District will be responsible for arranging for and paying for work on his or her property necessary to connect facilities constructed by the public utilities in the public streets and alleys to the points of connection on the private property.

Right-of-Way Certificate

**STATE OF CALIFORNIA
COUNTY OF LOS ANGELES
CITY OF LONG BEACH**

The undersigned hereby CERTIFIES UNDER PENALTY OF PERJURY that the following is all true and correct.

That at all time herein mentioned, the undersigned was, and now is, the authorized representative of the duly appointed SUPERINTENDENT OF STREETS of the CITY OF LONG BEACH, CALIFORNIA.

That there have now been instituted proceedings under the provisions of Article XIID of the California Constitution, and the "Municipal Improvements Act of 1913," being Division 12 of the Streets and Highways Code of the State of California, for the construction of certain public improvements in a special assessment district known and designated as ASSESSMENT DISTRICT NO. 08-01 (The Toledo Utility Undergrounding) (hereinafter referred to as the "Assessment District").

THE UNDERSIGNED STATES AND CERTIFIES AS FOLLOWS:

It is acknowledged that the proposed Works of Improvement must be located within public rights-of-way, land, or easements owned by or licensed to the CITY OF LONG BEACH, County of Los Angeles, State of California, at the time of the construction of the Works of Improvement, and the undersigned hereby further certifies that all rights-of-way necessary for the Works of Improvements will be obtained and in possession of the City, County, or State prior to construction by the CITY OF LONG BEACH.

EXECUTED this _____ day of _____, 2008, at CITY OF LONG BEACH, California.

SUPERINDENT OF STREETS
CITY OF LONG BEACH
State of California

By: _____
Mark Christoffels

Certificate of Completion of Environmental Proceedings

**STATE OF CALIFORNIA
COUNTY OF LOS ANGELES
CITY OF LONG BEACH**

The undersigned, under penalty of perjury, CERTIFIES as follows:

1. That I am the person who authorized to prepare and process all environmental documentation as needed as it relates to the formation of the special assessment district being formed pursuant to the provisions of the Long Beach Assessment District Procedural Ordinance, being Division IV of Chapter 3.52 of the Long Beach Municipal Code and, where applicable, the "Municipal Improvement Act of 1913" being Division 12 of the Streets and Highways Code of the State of California, said special Assessment district known and designated as ASSESSMENT DISTRICT NO. 08-01 (The Toledo Utility Undergrounding) (hereinafter referred to as the "Assessment District").
2. The specific environmental proceedings relating to this Assessment District that have been completed are as follows:

[CITY: PLEASE CONFIRM]

CEQA compliance review:

The proposed project is Categorically Exempt (Class 2) from the provisions of CEQA (replacement or reconstructions).

3. I do hereby certify that all environmental evaluation proceedings necessary for the formation of the Assessment District have been completed to my satisfaction, and that no further environmental proceedings are necessary.

EXECUTED this _____ day of _____, 2008, at CITY OF LONG BEACH, California.

By: _____
Mark Christoffels
CITY OF LONG BEACH
STATE OF CALIFORNIA

APPENDIX
Assessment Calculations

Parcel Address	Asmt No.	APN	Land Use	BENEFIT POINTS				ASSESSMENT CALCULATIONS							
				Aesthetics Benefit Points	+ Safety Benefit Points	+ Reliability Benefit Points	= Total Benefit Points	Construction Costs	Incidental Costs	Financing Costs	Total Assessment				
5430 E THE TOLEDO	1	7244-016-021	SFR	1.0	+	1.0	+	1.00	=	3.00	\$30,033.36	\$2,997.22	\$4,087.12	\$37,117.70	
5436 E THE TOLEDO	2	7244-016-022	SFR	1.0	+	1.0	+	1.00	=	3.00	\$30,033.36	\$2,997.22	\$4,087.12	\$37,117.70	
5438 E THE TOLEDO	3	7244-016-012	SFR	1.0	+	1.0	+	1.00	=	3.00	\$30,033.36	\$2,997.22	\$4,087.12	\$37,117.70	
5448 E THE TOLEDO	4	7244-016-024	SFR	1.0	+	1.0	+	1.00	=	3.00	\$30,033.36	\$2,997.22	\$4,087.12	\$37,117.70	
5450 E THE TOLEDO	5	7244-016-026	SFR	1.0	+	1.0	+	1.00	=	3.00	\$30,033.36	\$2,997.22	\$4,087.12	\$37,117.70	
5458 E THE TOLEDO	6	7244-016-028	SFR	1.0	+	1.0	+	1.00	=	3.00	\$30,033.36	\$2,997.22	\$4,087.12	\$37,117.70	
5460 E THE TOLEDO	7	7244-016-030	SFR	1.0	+	1.0	+	1.00	=	3.00	\$30,033.36	\$2,997.22	\$4,087.12	\$37,117.70	
5464 E THE TOLEDO	8	7244-016-032	SFR	1.0	+	1.0	+	1.00	=	3.00	\$30,033.36	\$2,997.22	\$4,087.12	\$37,117.70	
5468 E THE TOLEDO	9	7244-016-034	SFR	1.0	+	1.0	+	1.00	=	3.00	\$30,033.36	\$2,997.22	\$4,087.12	\$37,117.70	
5472 E THE TOLEDO	10	7244-016-020	SFR	1.0	+	1.0	+	1.00	=	3.00	\$30,033.36	\$2,997.22	\$4,087.12	\$37,117.70	
5474 E THE TOLEDO	11	7244-016-036	SFR	1.0	+	1.0	+	1.00	=	3.00	\$30,033.36	\$2,997.22	\$4,087.12	\$37,117.70	
5480 E THE TOLEDO	12	7244-016-038	SFR	1.0	+	1.0	+	1.00	=	3.00	\$30,033.36	\$2,997.22	\$4,087.12	\$37,117.70	
5484 E THE TOLEDO	13	7244-016-018	SFR	1.0	+	1.0	+	1.00	=	3.00	\$30,033.36	\$2,997.22	\$4,087.12	\$37,117.70	
5488 E THE TOLEDO	14	7244-016-040	SFR	1.0	+	1.0	+	1.00	=	3.00	\$30,033.36	\$2,997.22	\$4,087.12	\$37,117.70	
5490 E THE TOLEDO	15	7244-019-018	SFR	1.0	+	1.0	+	1.00	=	3.00	\$30,033.36	\$2,997.22	\$4,087.12	\$37,117.70	
5490 E THE TOLEDO	16	7244-019-030	SFR	0.0	+	0.0	+	0.00	=	0.00	\$0.00	\$0.00	\$0.00	\$0.00	
5494 E THE TOLEDO	17	7244-019-028	SFR	1.0	+	1.0	+	1.00	=	3.00	\$30,033.36	\$2,997.22	\$4,087.12	\$37,117.70	
5500 E THE TOLEDO	18	7244-019-026	SFR	1.0	+	1.0	+	1.00	=	3.00	\$30,033.36	\$2,997.22	\$4,087.12	\$37,117.70	
5508 E THE TOLEDO	19	7244-019-015	SFR	1.0	+	1.0	+	1.00	=	3.00	\$30,033.36	\$2,997.22	\$4,087.12	\$37,117.70	
5518 E THE TOLEDO	20	7244-019-014	SFR	1.0	+	1.0	+	1.00	=	3.00	\$30,033.36	\$2,997.22	\$4,087.12	\$37,117.70	
5528 E THE TOLEDO	21	7244-019-013	SFR	1.0	+	1.0	+	1.00	=	3.00	\$30,033.36	\$2,997.22	\$4,087.12	\$37,117.70	
5530 E THE TOLEDO	22	7244-019-020	SFR	1.0	+	1.0	+	1.00	=	3.00	\$30,033.36	\$2,997.22	\$4,087.12	\$37,117.70	
5534 E THE TOLEDO	23	7244-019-021	SFR	1.0	+	1.0	+	1.00	=	3.00	\$30,033.36	\$2,997.22	\$4,087.12	\$37,117.70	
5538 E THE TOLEDO	24	7244-019-022	SFR	1.0	+	1.0	+	1.00	=	3.00	\$30,033.36	\$2,997.22	\$4,087.12	\$37,117.70	
5544 E THE TOLEDO	25	7244-019-012	SFR	1.0	+	1.0	+	1.00	=	3.00	\$30,033.36	\$2,997.22	\$4,087.12	\$37,117.70	
5437 E THE TOLEDO	26	7244-015-010	2DU	1.0	+	2.0	+	1.00	=	4.00	\$40,044.49	\$3,996.29	\$5,449.49	\$49,490.27	
105 SIENA DR	27	7244-015-011	SFR	0.5	+	1.0	+	1.00	=	2.50	\$25,027.80	\$2,497.68	\$3,405.93	\$30,931.41	
115 SIENA DR	28	7244-015-012	SFR	0.0	+	1.0	+	1.00	=	2.00	\$20,022.24	\$1,998.15	\$2,724.74	\$24,745.13	
117 SIENA DR	29	7244-015-013	SFR	0.0	+	1.0	+	1.00	=	2.00	\$20,022.24	\$1,998.15	\$2,724.74	\$24,745.13	
123 SIENA DR	30	7244-015-014	SFR	0.0	+	1.0	+	1.00	=	2.00	\$20,022.24	\$1,998.15	\$2,724.74	\$24,745.13	
125 SIENA DR	31	7244-015-015	SFR	0.0	+	0.5	+	0.00	=	0.50	\$5,005.56	\$499.54	\$681.19	\$6,186.29	
5467 E THE TOLEDO	32	7244-014-039	SFR	0.5	+	1.0	+	1.00	=	2.50	\$25,027.80	\$2,497.68	\$3,405.93	\$30,931.41	
5471 E THE TOLEDO	33	7244-014-018	SFR	1.0	+	1.0	+	0.33	=	2.33	\$23,359.28	\$2,331.17	\$3,178.87	\$28,869.32	
5475 E THE TOLEDO	34	7244-014-019	SFR	1.0	+	1.0	+	0.00	=	2.00	\$20,022.24	\$1,998.15	\$2,724.74	\$24,745.13	
5481 E THE TOLEDO	35	7244-014-020	SFR	1.0	+	1.0	+	0.00	=	2.00	\$20,022.24	\$1,998.15	\$2,724.74	\$24,745.13	
5485 E THE TOLEDO	36	7244-014-021	SFR	1.0	+	1.0	+	0.67	=	2.67	\$26,896.32	\$2,664.19	\$3,632.99	\$32,993.50	
101 VENETIA DR	37	7244-014-022	SFR	0.5	+	1.0	+	0.00	=	1.50	\$15,016.68	\$1,498.61	\$2,043.66	\$18,558.85	
Naples Elem. School	38	7244-017-900	SCHOOL	0.0	+	9.4	+	0.50	=	9.90	\$99,110.23	\$9,890.81	\$13,487.46	\$122,488.50	
Totals:											107.90	\$1,080,200.00	\$107,800.00	\$147,000.00	\$1,335,000.00

OFFICE OF THE CITY ATTORNEY
ROBERT E. SHANNON, City Attorney
333 West Ocean Boulevard, 11th Floor
Long Beach, CA 90802-4664

1
2
3
4
5
6
7
8
9
10
11
12
13
14
15
16
17
18
19
20
21
22
23
24
25
26
27
28

RESOLUTION NO.

A RESOLUTION OF THE CITY COUNCIL OF THE
CITY OF LONG BEACH ADOPTING ENGINEER'S
REPORT, CONFIRMING THE ASSESSMENTS AND
ORDERING IMPROVEMENTS – ASSESSMENT DISTRICT
NO. 08-01 (THE TOLEDO UTILITY UNDERGROUNDING)

WHEREAS, on September 23, 2008 the City Council (the "Council") of the
City of Long Beach (the "City") adopted Resolution No. RES-08-0116 (the "Resolution of
Intention") expressing its intention to order improvements and to form the proposed City
of Long Beach Assessment District No. 08-01 (The Toledo Utility Undergrounding) (the
"Assessment District"), and referred the proposed improvements to the City Engineer,
acting as the Engineer of Work for the Assessment District; and

WHEREAS, the Council thereby directed the Engineer of Work to make and
file with the City Clerk a report (the "Report") in writing in accordance with and pursuant
to the Long Beach Assessment District Procedural Ordinance, being Division IV of
Chapter 3.52 of the Long Beach Municipal Code and, where applicable, the Municipal
Improvement Act of 1913, being Division 12 of the California Streets and Highways Code
(collectively, the "Act"); and

WHEREAS, the Report was duly made and filed with the City Clerk,
whereupon said City Clerk presented it to the Council for consideration; and

WHEREAS, on September 23, 2008 the Council thereupon duly considered
the Report and adopted Resolution No. RES-08-0117 preliminarily approving the
description of the improvements, the estimate of the total cost of the improvements, the
amounts to be assessed and the diagram of the Assessment District in the Report; and

WHEREAS, in Resolution No. RES-08-0117, the Council found that the
Report should stand as the Report for all subsequent proceedings under the Resolution

1 of Intention related to the Assessment District, whereupon the Council appointed a time
2 and place for a public hearing on the Assessment District at which time and place all
3 protests in relation to the Assessment District were heard; and

4 WHEREAS, notice of the public hearing was provided to each owner of
5 property in the Assessment District as required by applicable law, and the public hearing
6 was duly and regularly held on November 11, 2008; and

7 WHEREAS, all persons interested desiring to be heard at the public hearing
8 were given an opportunity to be heard, and all matters and things pertaining to the
9 Assessment District were fully heard and considered by the Council, and the Council has
10 acquired jurisdiction to order the improvements and to confirm the diagram of the
11 Assessment District and the assessment to be levied therein to pay the costs and
12 expenses thereof; and

13 WHEREAS, following the public hearing, the ballots in the election
14 regarding the Assessment District were tabulated, and this Council adopted a Resolution
15 overruling any protests and declaring the results of the election to be more than a
16 majority of the ballots cast in the election (weighted according to the proposed financial
17 obligation of each property voting) in favor of the Assessment District and the levy of the
18 assessments therein; and

19 WHEREAS, it is in the best interest of the Assessment District for the
20 Council to retain jurisdiction to order the improvements, levy the assessments and issue
21 bonds secured by the assessments.

22 NOW, THEREFORE, the City Council of the City of Long Beach resolves as
23 follows:

24 Section 1. That the foregoing recitals are true and correct.

25 Section 2. Based upon the Report and the testimony and other evidence
26 received at the public hearing, it is hereby determined that: (a) all properties within the
27 boundaries of the Assessment District receive a special benefit from the improvements
28 identified in the Report; (b) the proportionate special benefit derived by each parcel

1 proposed to be assessed has been determined in relationship to the cost of the
2 improvements; (c) no assessment is proposed to be imposed on any parcel which
3 exceeds the reasonable cost of the proportional special benefit to be conferred on such
4 parcel from the improvements; and (d) only special benefits have been assessed.

5 Section 3. The Council hereby confirms the proposed assessment in the
6 amount set forth in the Report and declares that the final Report, including the plans,
7 specifications, description of the improvements, estimate of the cost of the improvements,
8 assessments, boundary map and diagram described therein, in the form on file with the
9 City Clerk, is hereby finally adopted, accepted, confirmed and approved.

10 Section 4. The Council hereby orders the work and improvements
11 described in the Resolution of Intention and in the Report to be done and made.

12 Section 5. That the City Clerk shall deliver, or cause to be delivered, to
13 the City Engineer, in his capacity as Superintendent of Streets for the City, the
14 assessment (in the form of the final Report), together with said diagram thereto attached
15 and made a part thereof, as confirmed by this Council with the City Clerk's certificate of
16 such confirmation thereto attached and of the date thereof. The City Clerk shall also
17 record, or cause to be recorded, a certified copy of the assessment diagram in the Office
18 of the Los Angeles County Recorder.

19 Section 6. That the City Engineer shall record said assessment diagram
20 and assessment in his office in a suitable book to be kept for that purpose, and append
21 thereto his certificate for the date of such recording, and such recordation shall be and
22 constitute the assessment roll for the Assessment District.

23 Section 7. The City Clerk shall execute and record, or cause to be
24 recorded, a Notice of Assessment in the office of the City Engineer and in the office of the
25 County Recorder of the County of Los Angeles, such notice to be in a form provided by
26 Harris & Associates, the firm designated in City Council Resolution No. RES-08-0117, to
27 assist the City Clerk in connection with the Assessment District. From the date of such
28 recording with the City Engineer and with the County Recorder of the County of Los

1 Angeles, all persons shall be deemed to have notice of the contents of such assessment,
2 and each of such assessments shall thereupon be a lien upon the property against which
3 it is made, and unless sooner discharged such liens shall so continue for the period of ten
4 (10) years from the date of such recordation, or in the event bonds are issued to
5 represent said assessments, then such liens shall continue until the expiration of four (4)
6 years after the due date of the last installment upon said bonds.

7 Section 8. Upon recordation of the diagram and assessment, the City
8 Engineer shall cause to be mailed a notice to each owner of real property within the
9 Assessment District at the owner's last known address, as such address appears on the
10 most recent equalized tax roll of Los Angeles County, such notice to set forth a statement
11 containing a designation of the property assessed, as well as the amount of the final
12 confirmed assessment, and further indicating that bonds will be issued pursuant to the
13 Act.

14 Section 9. Notice shall also be given by or on behalf of the City Clerk by
15 publication in a newspaper of general circulation, such notice setting forth the amount of
16 the final assessment and indicating that such assessment is now due and payable, and
17 further indicating that if such assessment is not paid within the allowed thirty (30) day
18 cash collection period, bonds shall be issued as authorized by law.

19 Section 10. The City Treasurer is hereby designated to collect and receive
20 the money paid pursuant to the assessment during the cash collection period for the
21 Assessment District, in the manner prescribed by law.

22 Section 11. The County Auditor is hereby authorized and directed, in
23 accordance with the provisions of Section 8682 of the Streets and Highways Code of the
24 State of California, to enter into his assessment roll on which property taxes will next
25 become due, opposite each lot or parcel of land affected, in a space marked "public
26 improvement assessment" or by other suitable designation, the next and several
27 installments of such assessment coming due during the ensuing fiscal year covered by
28 the assessment roll and that such entry then shall be made each year during the life of

1 the bonds for the proceedings for the above-referenced Assessment District. This
2 authorization is continual until all assessment obligations have been discharged and the
3 bonds terminated.

4 As an alternate, and when determined to be in the best interests for
5 bondholders of the Assessment District, this Council may, by Resolution, designate an
6 official other than the County Auditor and/or other agent, to collect and maintain records
7 of the collection of the assessments, including a procedure other than the normal
8 property tax collection procedure.

9 In accordance with the provisions of Section 8685 of the Streets and
10 Highways Code, if any lot or parcel of land affected by any assessment is not separately
11 assessed on the tax roll so that the installment of the assessment to be collected can be
12 conveniently entered thereon, then the County Auditor shall enter on the roll a description
13 of the lot or parcel affected, with the name of the owners, if known, but otherwise the
14 owners may be described as "unknown owners", and extend the proper installment
15 opposite the same.

16 Section 12. The County Auditor shall, within 90 days after any special
17 assessment installment becomes delinquent, render and submit a detailed report
18 showing the amounts of the installments, interest, penalties and percentages so
19 collected, for the preceding term and installment date, and from what property collected,
20 and further identify any properties which are delinquent and the amount and length of
21 time for such delinquency, and further set forth a statement of percentages retained for
22 the expenses of making such collections. This request is specifically made pursuant to
23 the authorization of Section 8683 of the Streets and Highways Code of the State of
24 California.

25 Section 13. The appropriate officer or officers of the City are hereby
26 authorized to pay any and all fees required by law in connection with the above.

27 Section 14. This Resolution shall take effect immediately upon its
28 adoption by the Council, and the City Clerk shall certify the vote adopting this Resolution.

OFFICE OF THE CITY ATTORNEY
ROBERT E. SHANNON, City Attorney
333 West Ocean Boulevard, 11th Floor
Long Beach, CA 90802-4664

1
2
3
4
5
6
7
8
9
10
11
12
13
14
15
16
17
18
19
20
21
22
23
24
25
26
27
28

I hereby certify that the foregoing Resolution was adopted by the City Council of the City of Long Beach at its meeting of _____, 20__ by the following vote:

Ayes: Councilmembers: _____

Noes: Councilmembers: _____

Absent: Councilmembers: _____

City Clerk