

Proposed Speed Limit
Change — Appian Way between
Park Ave. and Bay Shore Ave.
(35mph to 30mph)

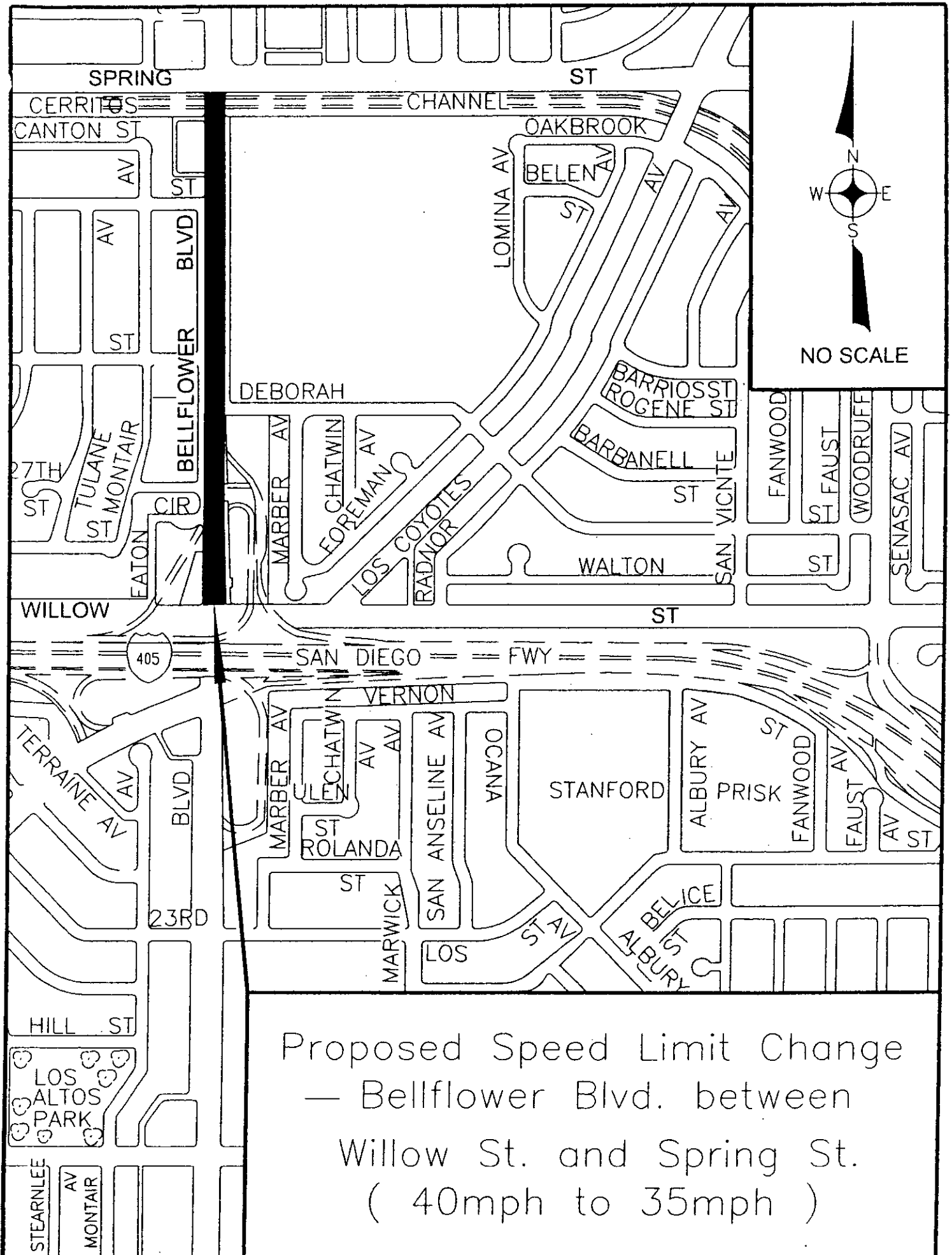

Proposed Speed Limit Change
— Bellflower Blvd. between
Willow St. and Spring St.
(40mph to 35mph)

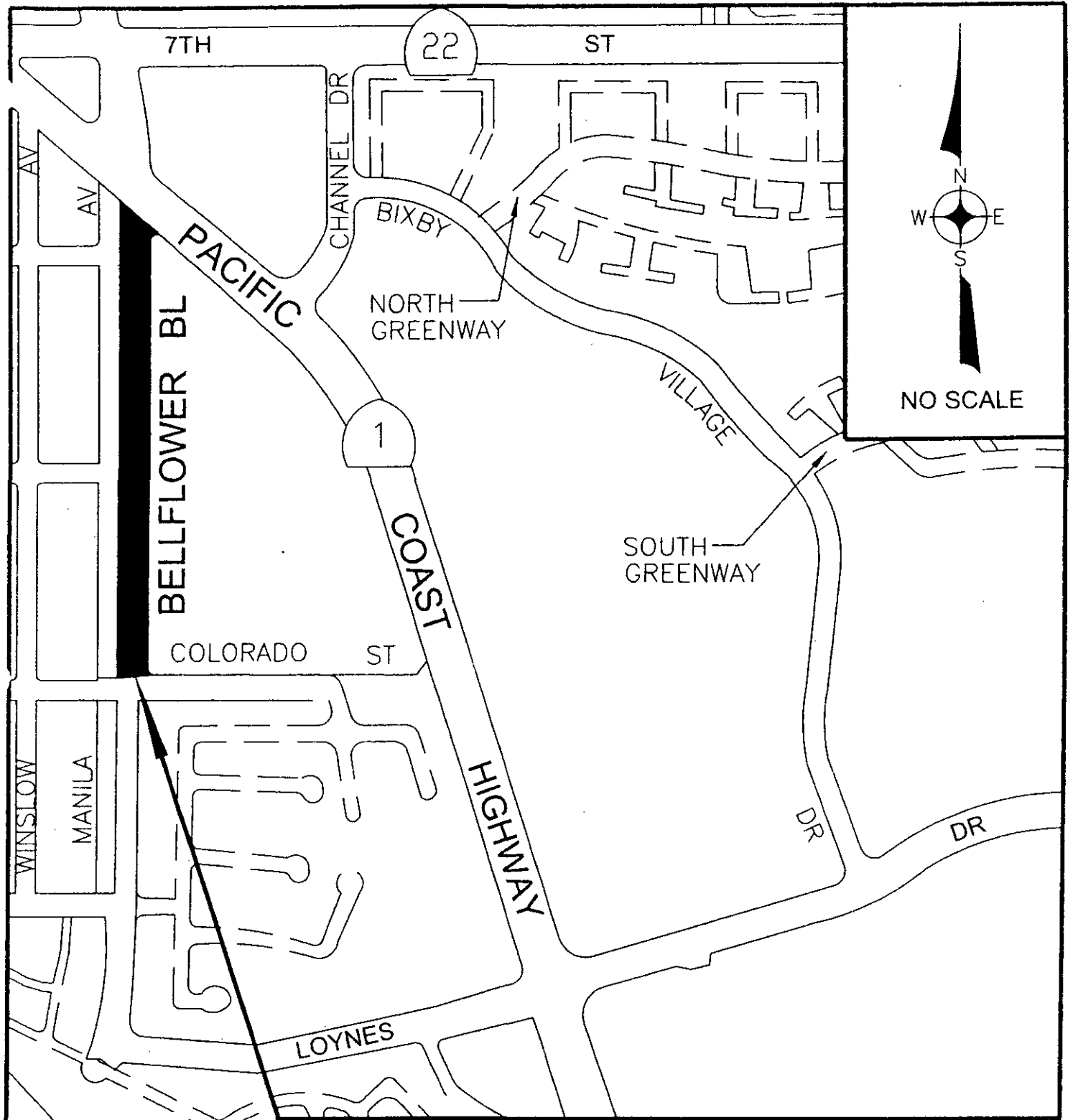

Proposed Speed Limit Change
— Bellflower Blvd. between
Pacific Coast Hwy. and Colorado St.
(40 mph to 35 mph)

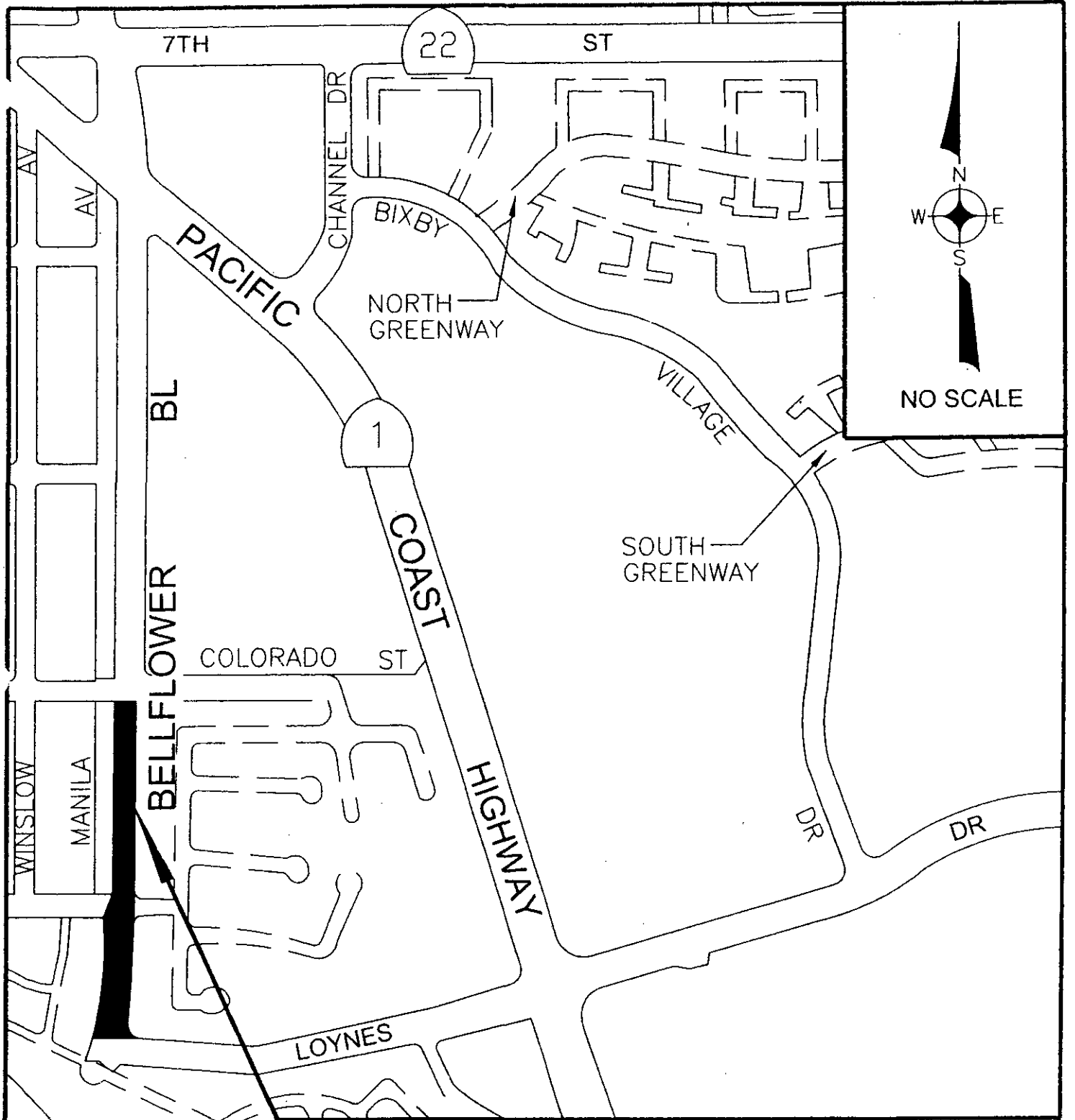

Proposed Speed Limit Change
— Bellflower Blvd. between
Colorado St. and Loynes Dr.
(30 mph to 35 mph)

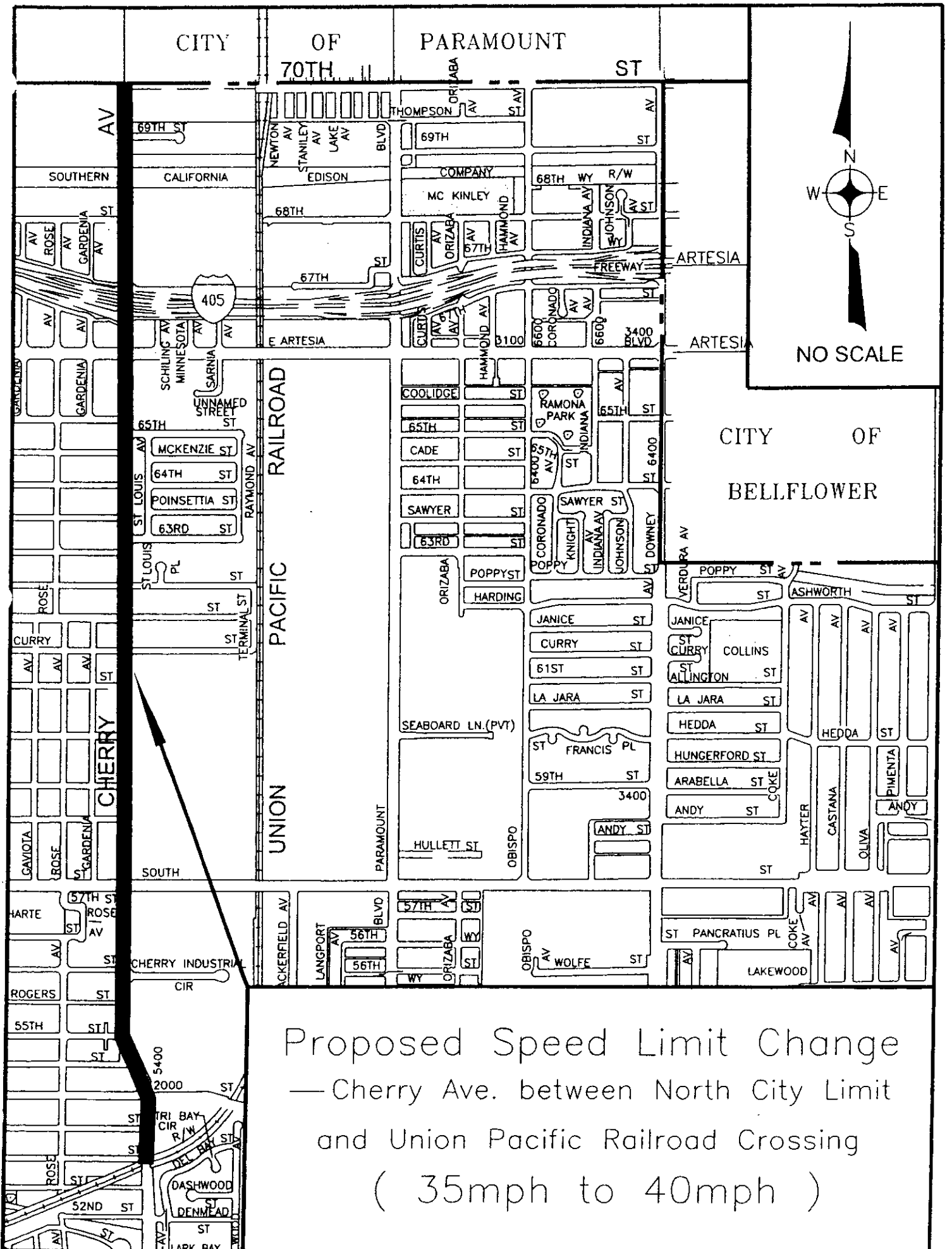

Proposed Speed Limit Change
 — Cherry Ave. between North City Limit
 and Union Pacific Railroad Crossing
 (35mph to 40mph)

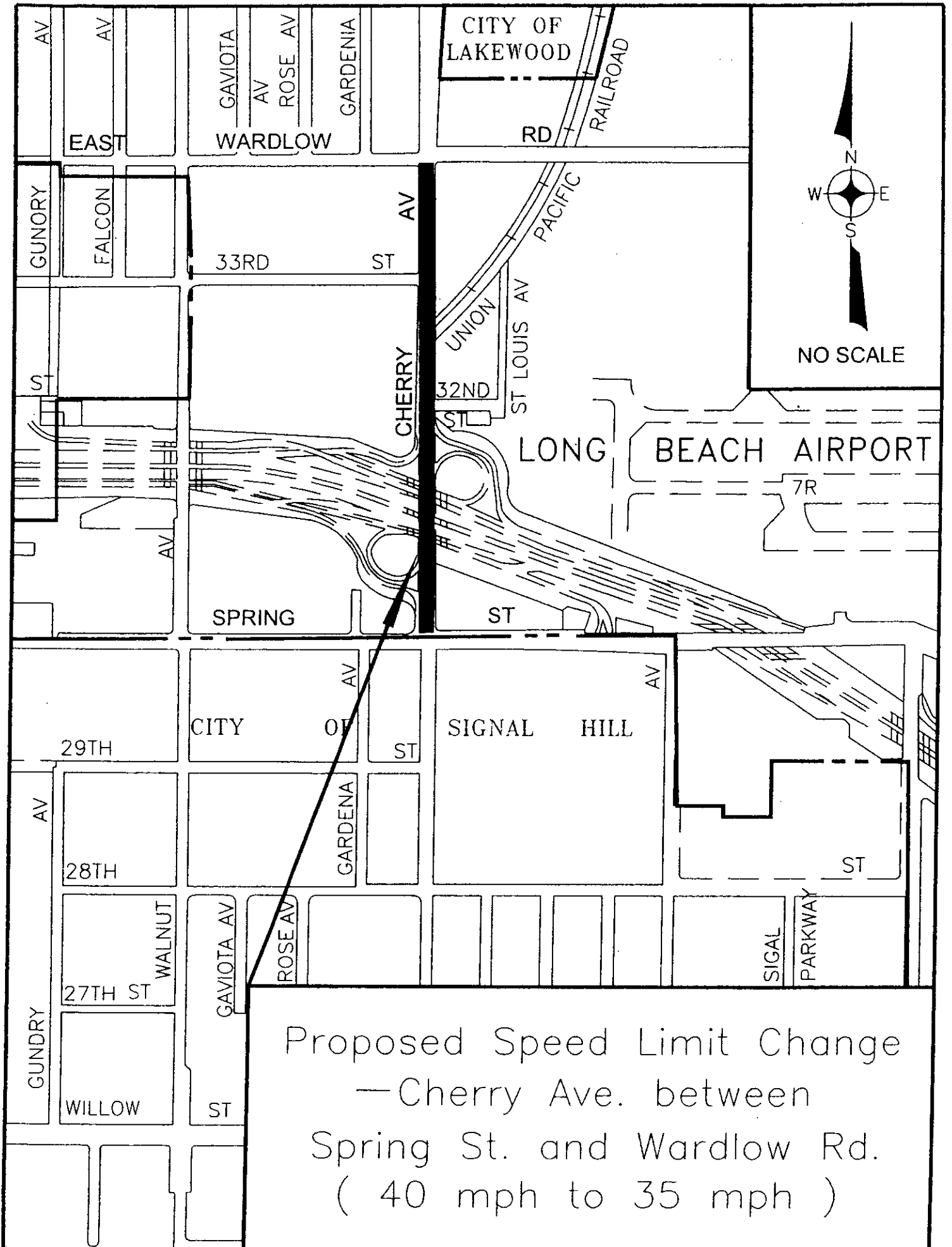

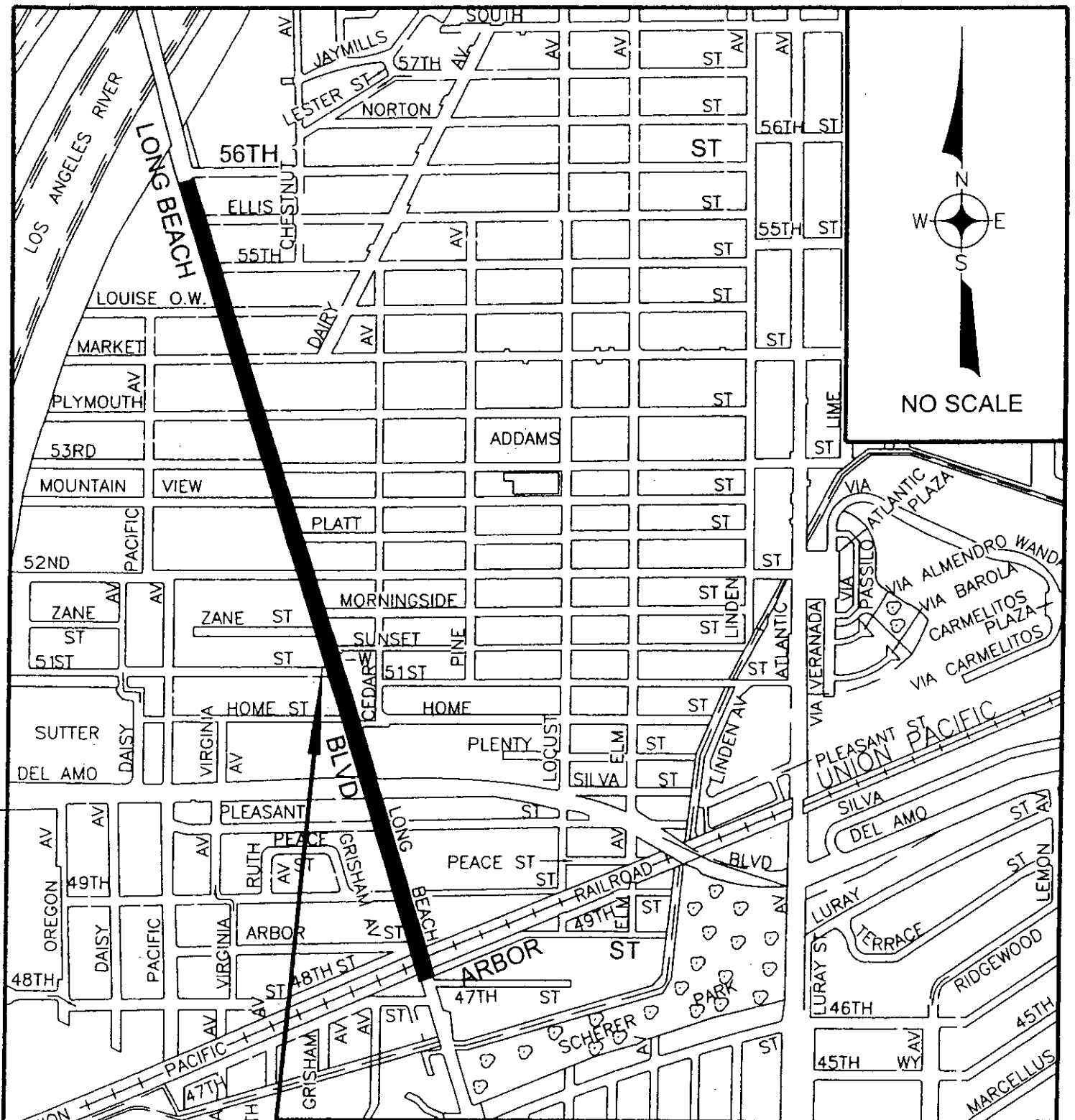

Proposed Speed Limit Change
 — Long Beach Blvd. between
 Arbor St. and 56th St.
 (30mph to 35mph)

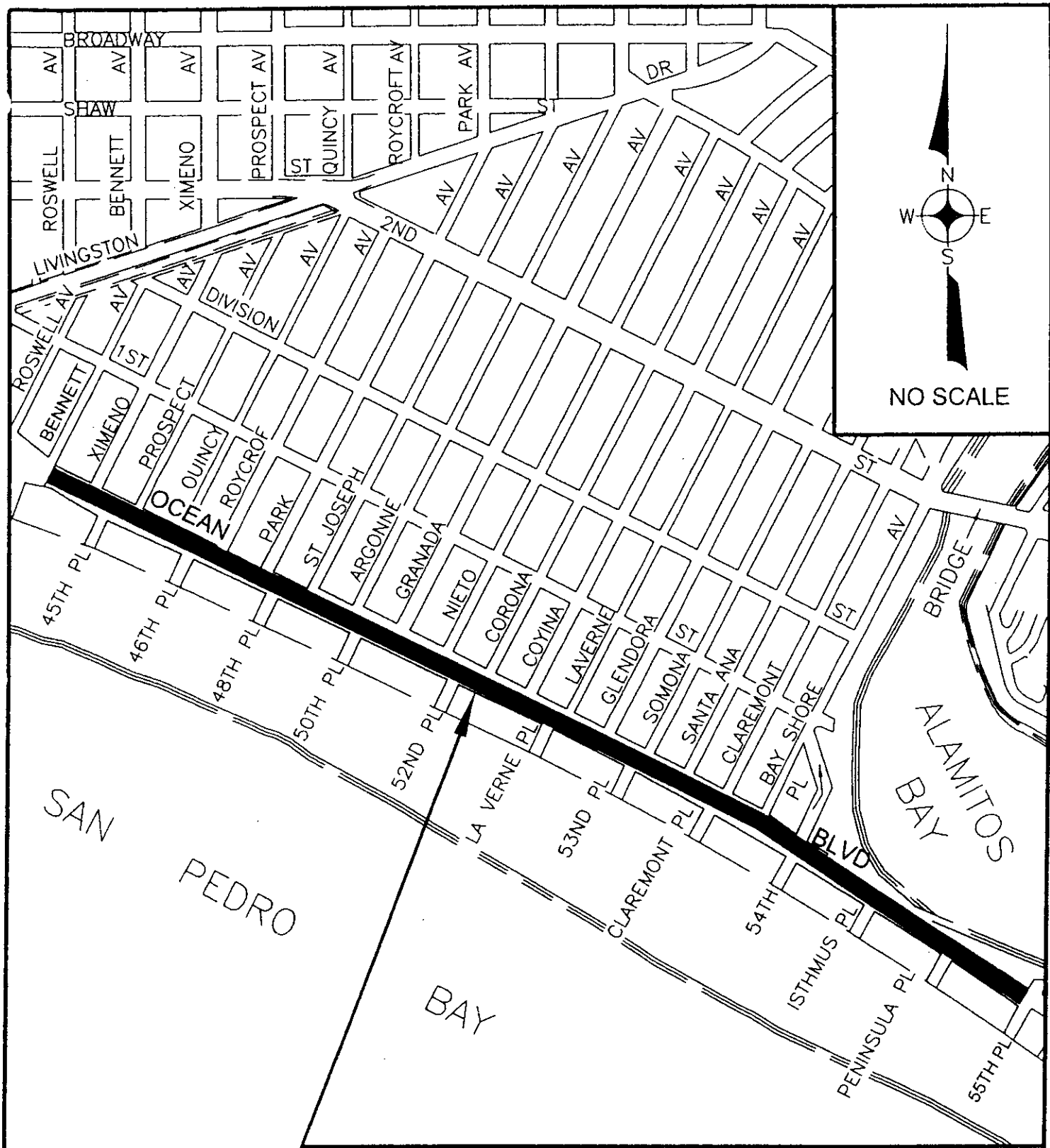

Proposed Speed Limit Change
 — Ocean Blvd. between
 55th Pl. and Bennett Ave.
 (35mph to 30 mph)

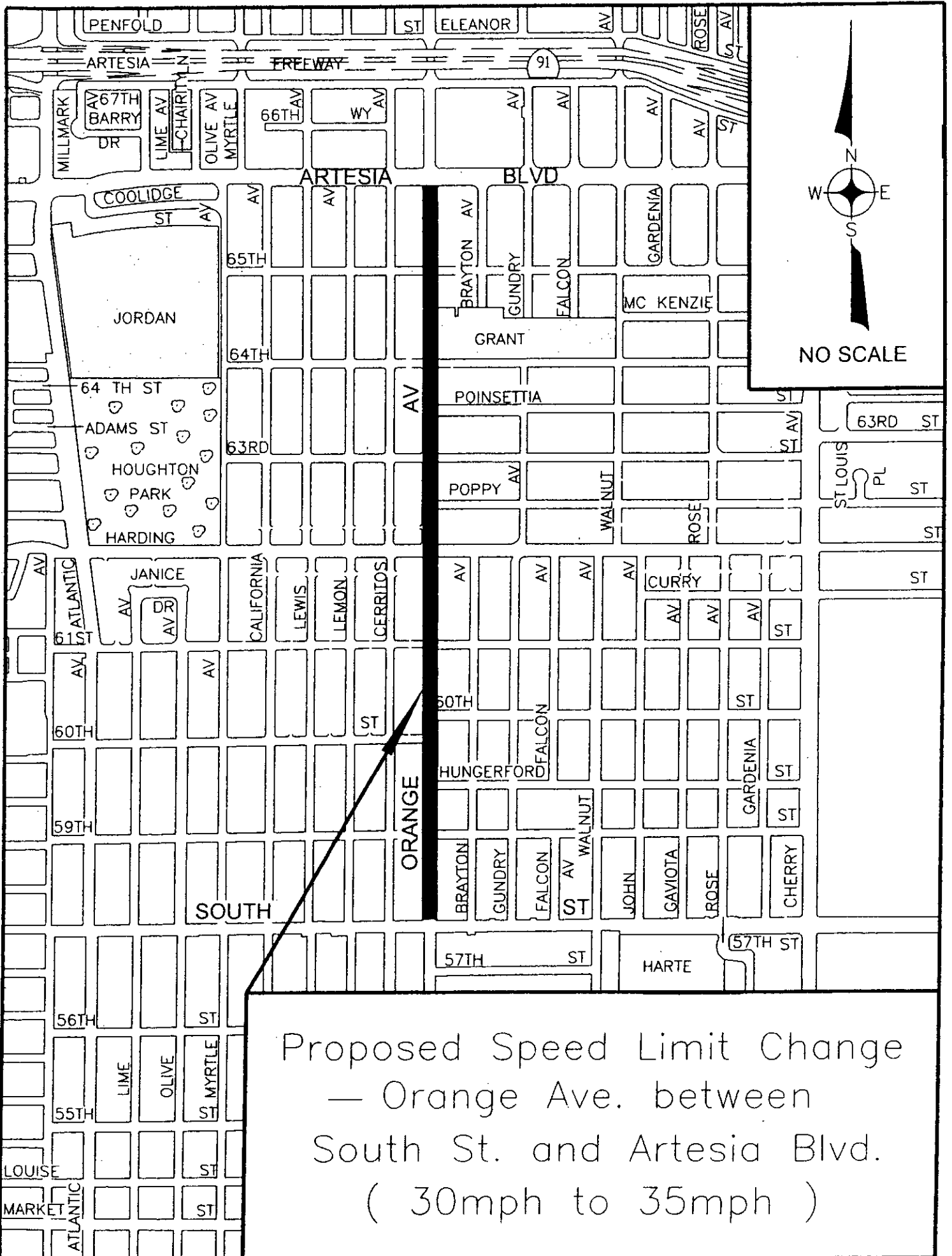

Proposed Speed Limit Change
— Orange Ave. between
South St. and Artesia Blvd.
(30mph to 35mph)

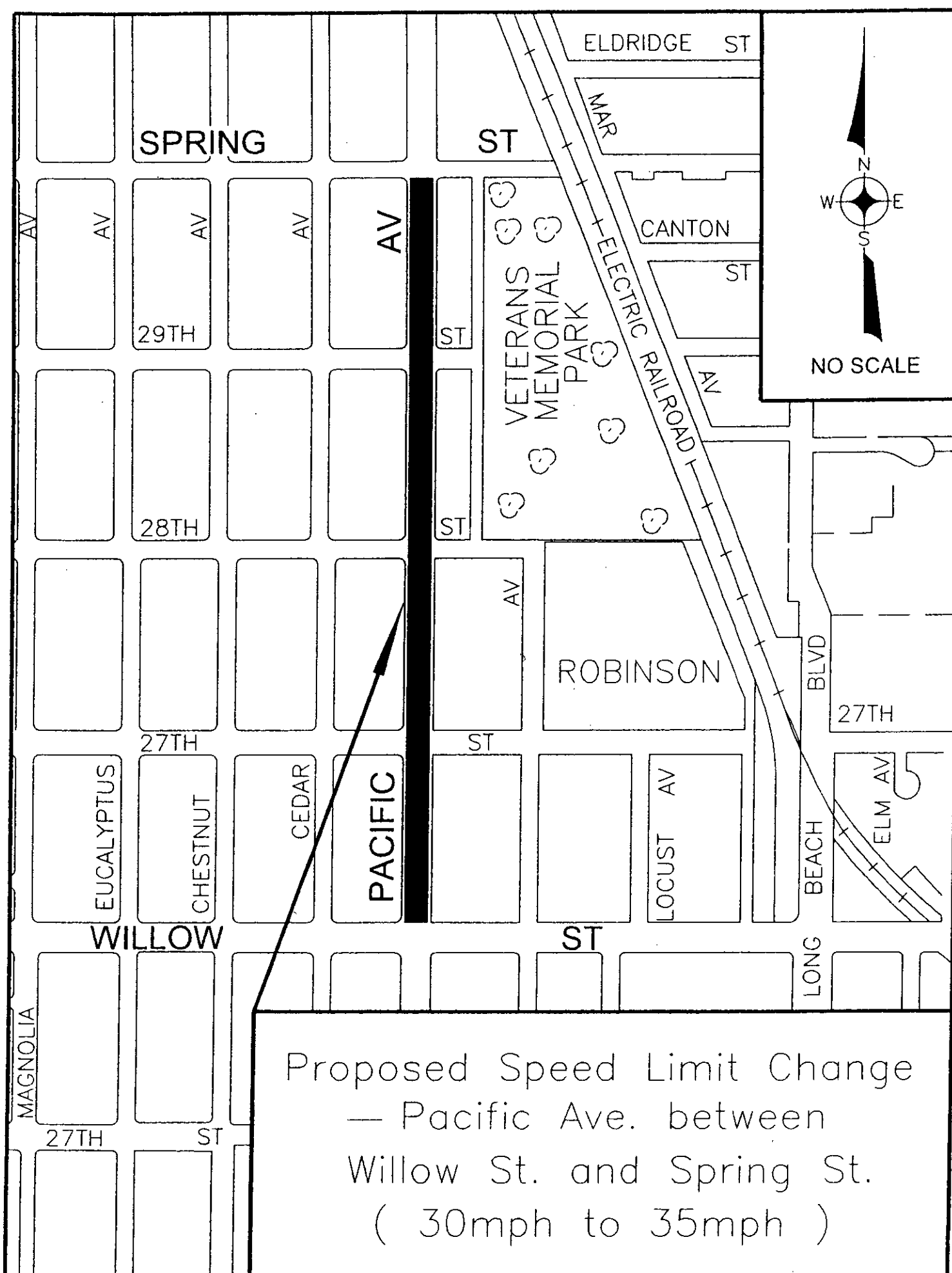

Proposed Speed Limit Change
— Pacific Ave. between
Willow St. and Spring St.
(30mph to 35mph)

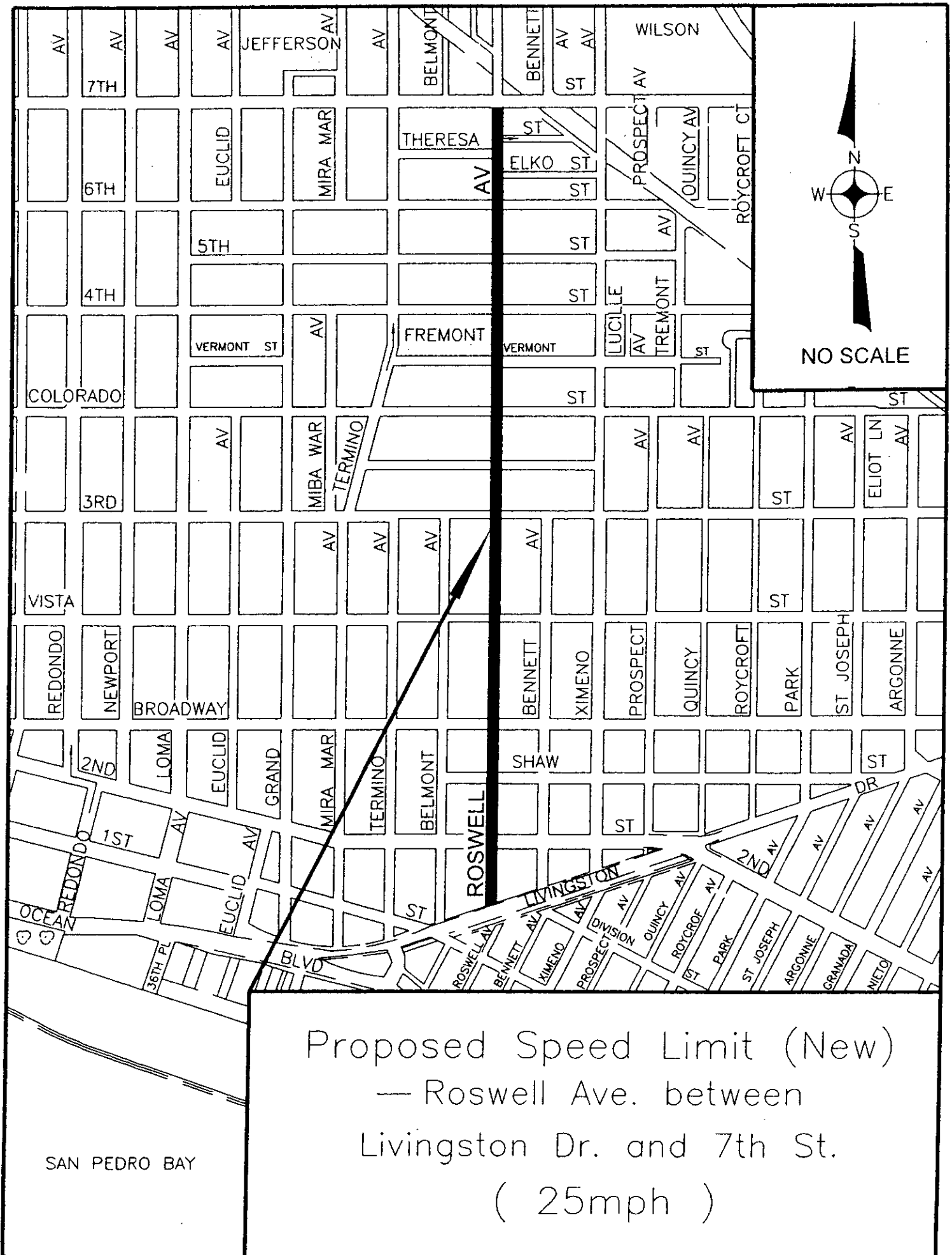

NO SCALE

Proposed Speed Limit (New)
— Roswell Ave. between
Livingston Dr. and 7th St.
(25mph)

SAN PEDRO BAY

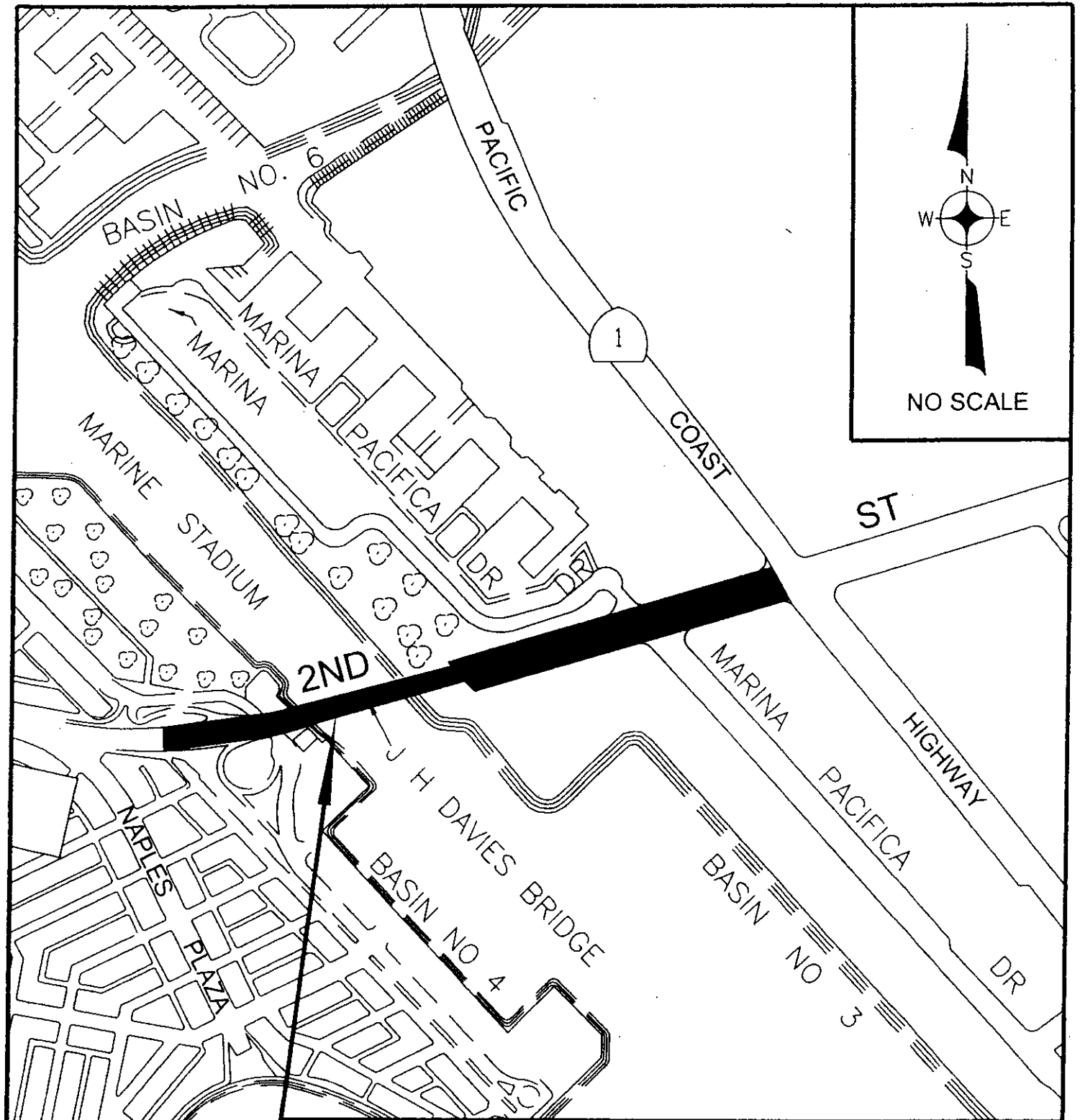

Proposed Speed Limit Change
— 2nd St. between 100 ft. East of
Naples Plaza and Pacific Coast Hwy.
(35mph to 40mph)