



Building A Better Long Beach

June 21, 2010

REDEVELOPMENT AGENCY BOARD MEMBERS

City of Long Beach
California

RECOMMENDATION:

Approve and authorize the Executive Director to enter into a contract with Construct 1 One Corporation in an amount not to exceed \$3,583,464 for the construction of the McBride Park Teen Center. (Central – District 6)

DISCUSSION

The Redevelopment Agency (Agency), in collaboration with the Departments of Parks, Recreation and Marine and Public Works, has identified the need to create and improve open space amenities and infrastructure throughout the Central Long Beach Redevelopment Project Area (Project Area). To that end, McBride Park (Park) located at 16th Street and Martin Luther King Jr. Avenue (Exhibit A – Site Map) is one of six open space projects targeted for public improvements utilizing the 2006 Open Space Bond proceeds.

Improvements to the Park will assist in the removal of blight by enhancing open space in a densely populated neighborhood currently underserved by recreational amenities. The scope of work for the project consists of the construction of an approximately 5,000-square-foot teen center that will allow senior and teenage oriented recreational activities to be housed in separate buildings. In addition, the Park will also benefit from a new playground and parking lot, appurtenant hardscape and landscaping improvements and a new skate park (Exhibit B – Conceptual Design).

The Plans and Specifications for the construction of the project were advertised for bid on April 20, 2010, and the bid opening was held on June 1, 2010. Of the five firms submitting bids, Construct 1 One Corporation was identified as the lowest responsible bidder. The proposed contract amount of \$3,583,464 includes a 25-percent contingency clause to cover any additional work that may become necessary during the course of construction. In the event that additional work is necessary, the contract will provide the Executive Director the ability to approve change orders for additional work not to exceed the 25-percent contingency. Although not anticipated, any contract change orders that would exceed the 25-percent contingency will be brought before the Agency for further consideration.

REDEVELOPMENT AGENCY BOARD MEMBERS

June 21, 2010

Page 2 of 2

Although the Agency will be administering the entire contract, Open Space Bond proceeds will only pay for a portion of the project and the remaining balance will be funded by a State grant awarded by the California Office of State Parks and allocated from the Proposition 40, Resources Bond Act of 2002.

The Agency and City Council made the necessary findings of benefit, as required by California Redevelopment Law, on September 12, 2005, and November 1, 2005, respectively.

SUGGESTED ACTION:

Approve recommendation.

Respectfully submitted,



AMY J. BODEK
EXECUTIVE DIRECTOR

AJB:LAF:DSW:EM

Attachments: Exhibit A – Site Plan
Exhibit B – Conceptual Design



CITY OF LONG BEACH
 CITY OF LONG BEACH
 1550 MARTIN BLVD.
 LONG BEACH, CA 90801

PROJECT: THE MICRORIDE PARK IMPROVEMENTS PROJECT
 LOCATION: 1550 MARTIN BLVD., AVE. LONG BEACH, CA 90801
 SHEET TITLE: SITE PLAN
 DATE: 10/20/2009
 DRAWN BY: [Name]
 CHECKED BY: [Name]
 SCALE: 1/8" = 1'-0"

PROJECT DATA PERTAINING TO PARKING		NO. OF PARKING SPACES
SITE DATA		
1. EXISTING FACILITY:		
2. NEW CONSTRUCTION AREAS:		
AREA	NO. OF SPACES	
A	4 PER 1000 SF OF AREA (1 PER 250 SF)	3
B	20 PER 1000 SF OF AREA (1 PER 50 SF)	14
C	4 PER 1000 SF OF AREA (1 PER 250 SF)	3
D	5 PER 1000 SF OF AREA (1 PER 200 SF)	3
E	4 PER 1000 SF OF AREA (1 PER 250 SF)	3
F	4 PER 1000 SF OF AREA (1 PER 250 SF)	1
NEW CONSTRUCTION AREAS TOTAL NO. OF SPACES REQUIRED		27

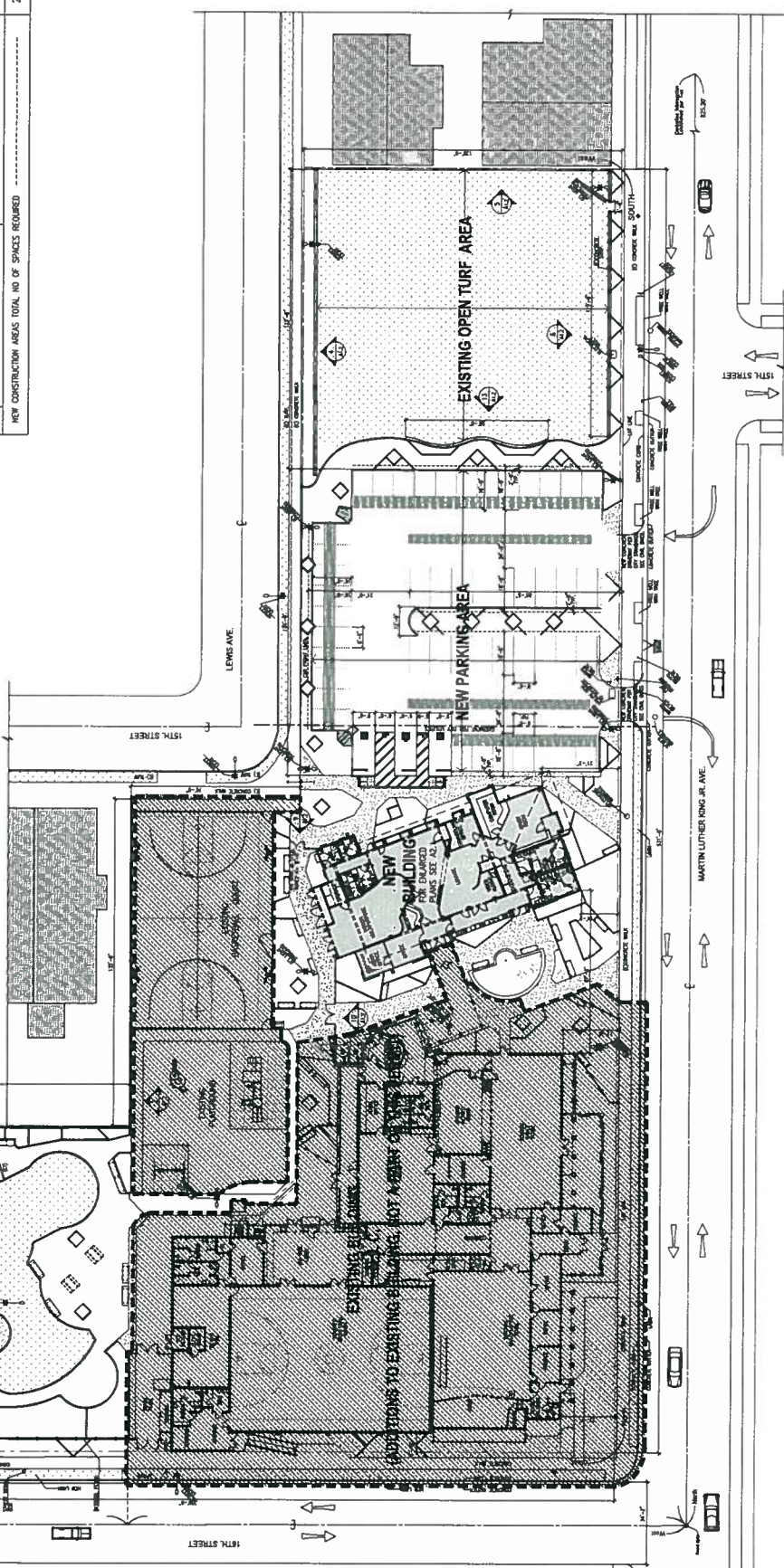
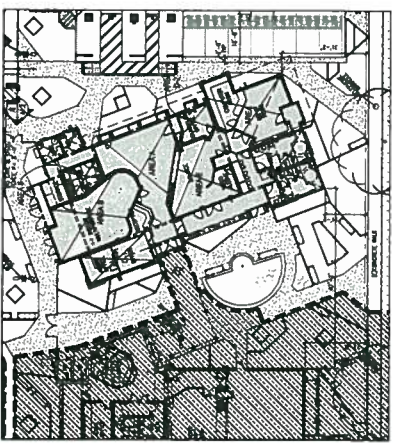

GENERAL NOTES

- FOR NEW PARK AREAS, DETAIL PER THE AREA PLANNING, SEATING, FLOOR FINISHES, DETAILS, PLANTING, BENCHES, SCHEDULES & DETAILS SEE LANDSCAPE ARCHITECTURE DRAWINGS.
- FOR EXISTING BUILDING & ADDITION SEE A2.0.
- FOR NEW BUILDING SEE A2.1.
- FOR GATES AND FENCES & REBUILT CHAIN LINK FENCES SEE A1.0.

GENERAL BUILDING AREAS IN SQ. FT. - GROSS

INCLUDES ALL SPACE WITH EXTERIOR WALLS INCLUDING PARTITIONS

- EXISTING ONE STORY BUILDING..... 18453 SQ.FT.
- FUTURE EXPANSION..... 1310 SQ.FT.
- NEW ONE STORY BUILDING..... 5016 SQ.FT.
- NEW PARK..... 20250 SQ.FT.
- NEW PARKING LOT..... 15243 SQ.FT.

LEGEND

- WORK TO EXISTING BUILDING AND SURROUNDING LANDSCAPE N.C.
- NEW CONSTRUCTION
- EXIST/NEW TURF AREA
- NON-IRREVERSIBLE SURFLOUT
- SYNTHETIC SURFACE
- NEW TRAFFIC BEARING
- OPEN CELLS
- NEW STONES & BENCH SEE STONE SCHEDULE
- WALL/CL/FENCES ELEV.
- EXISTING TREE
- RIVER ROCKS FINISH
- LANDSCAPE TREES/SHRUBS
- NEW CHAIN WALL
- BRICK WALL

SITE PLAN
 SCALE: 1/8" = 1'-0"

Conceptual Design

McBride Park Teen Center and Park Improvements

