



LONG BEACH REDEVELOPMENT AGENCY

333 WEST OCEAN BOULEVARD, THIRD FLOOR • LONG BEACH, CA 90802 • (562) 570-6615 • FAX (562) 570-6215

August 7, 2006

REDEVELOPMENT AGENCY BOARD MEMBERS

City of Long Beach
California

RECOMMENDATION:

Recommendation to approve and authorize the Executive Director to execute a revocable permit for the use of Agency-owned Parking Lot B by SambaLá Samba School for the 11th Annual Brazilian Street Carnival. (Downtown – District 1)

DISCUSSION

The SambaLá Samba School will be using The Promenade between Broadway and Third Street for the 11th Annual Brazilian Street Carnival on Sunday, September 17, 2006. They are requesting the use of Agency-owned Parking Lot B for the event (Exhibit A). The parking lot will be closed for a 24-hour period beginning at 6:00 A.M. Sunday, September 17, 2006 and will re-open at 6:00 A.M. Monday, September 18, 2006. A portion of the lot will be used for staff parking with the remainder used for a staging area.

The applicant has requested the Downtown Long Beach Associates and AMC Theatre management to endorse the parking lot closure. Receipt of written endorsements by Redevelopment staff is required prior to the event.

In May 1999, the Agency Board adopted a fee schedule for the exclusive use of Agency-owned parking lots. In accordance with that policy, the fee for use of the requested parking lot is \$150 (Exhibit B).

The City Attorney has prepared a Revocable Permit to allow the use of the parking lot for the time set forth and requiring the permittee to provide the Agency with insurance coverage throughout the event.

REDEVELOPMENT AGENCY BOARD MEMBERS

August 7, 2006

Page 2

SUGGESTED ACTION:

Approve recommendation.

Respectfully submitted,



PHW PATRICK H. WEST
EXECUTIVE DIRECTOR

PHW:CAB:rsw

APPROVED:



GERALD R. MILLER
CITY MANAGER

Attachments: Exhibit A - Parking Lot Map
Exhibit B - Fees for Agency-owned Parking Lots

CITY OF LONG BEACH REDEVELOPMENT AGENCY

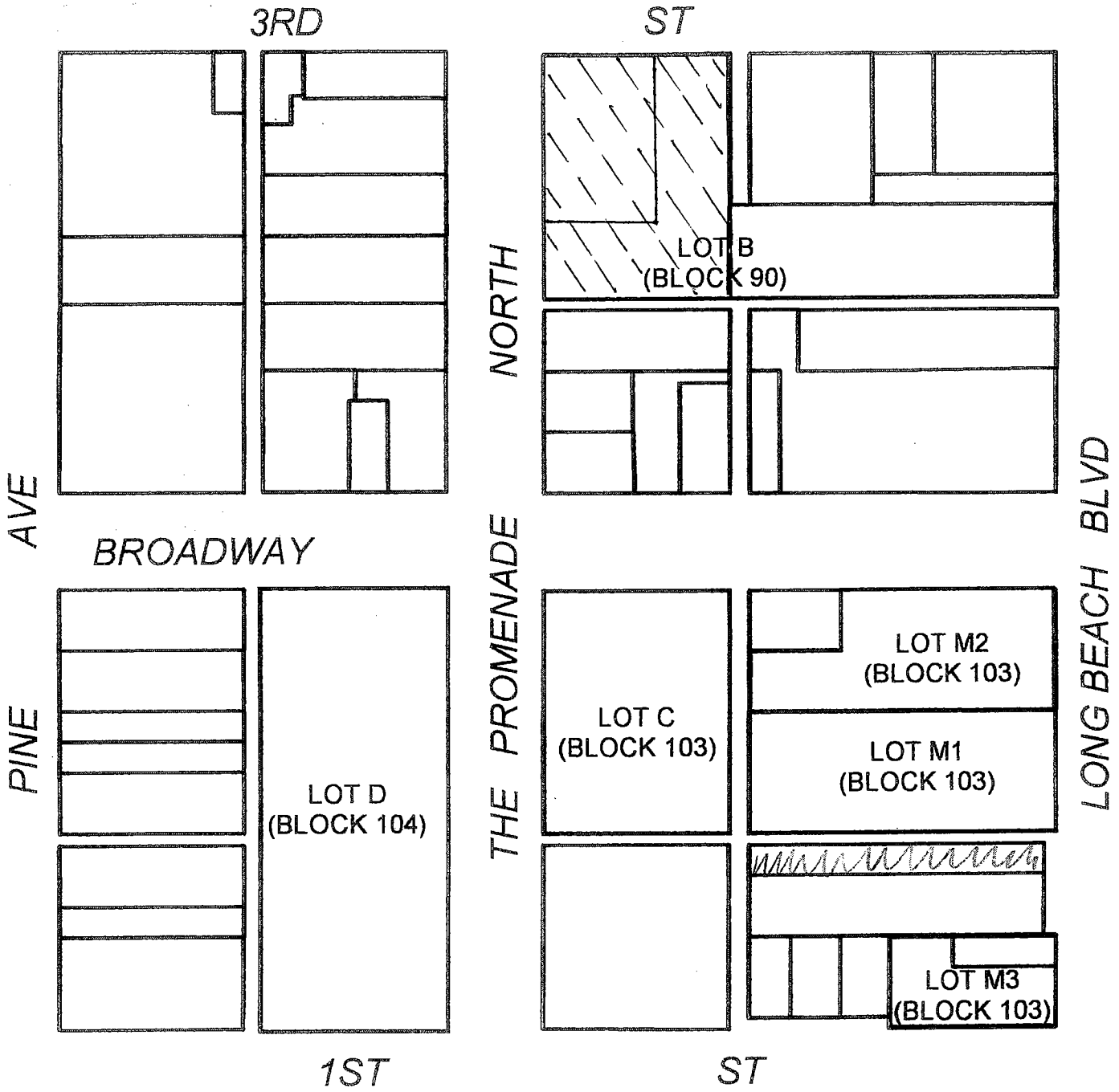

REDEVELOPMENT AGENCY OWNED
PARKING LOTS - PROMENADE AREA



TECHNOLOGY SERVICES/GIS
DWTN.APR
JULY 27, 2001
Revised 11/9/01

EXHIBIT B

LONG BEACH REDEVELOPMENT AGENCY

333 WEST OCEAN BOULEVARD, THIRD FLOOR • LONG BEACH, CA 90802 • (562) 570-6615 • FAX (562) 570-6215



Fees for Agency-owned Parking Lots in Revocable Permit Program

Lot Name and Use	Lot Location	Daily Rental Fee
Lot B General Parking	Block 90 Farmer's Market Lot	\$150.00
Lot C General Parking	Block 103 Promenade Amphitheater	\$350.00
Lot D General Parking	Block 104 Behind Mum's Restaurant	Not available for rent, except for large-scale events. In that case, fee is \$675.00
Lot M1 Monthly Parking	Block 103 Long Beach Boulevard	\$250.00 Not available on weekdays

Please note: These fees were approved by the Redevelopment Agency Board on May 10, 1999. These rates may be waived or certain lots may be made available for rent upon review by the Redevelopment Agency's Downtown Subcommittee and approval of the Redevelopment Agency Board.

The mission of the Redevelopment Agency of the City of Long Beach is to improve blighted areas of Long Beach, revitalize neighborhoods, promote economic development and the creation of jobs, provide affordable housing and encourage citizen participation.