



CITY OF LONG BEACH

C-7

DEPARTMENT OF PUBLIC WORKS

333 West Ocean Boulevard 9th Floor • Long Beach, CA 90802 • (562) 570-6383 • Fax (562) 570-6012

November 5, 2013

HONORABLE MAYOR AND CITY COUNCIL
City of Long Beach
California

RECOMMENDATION:

Authorize the City Manager to execute a Public Walkways Occupancy Permit for sidewalk dining at Starbucks located at 5251 East Second Street. (District 3)

DISCUSSION

Starbucks Corporation, the operator of Starbucks, located at 5251 East Second Street requests a permit to temporarily occupy part of the adjoining sidewalk for the purpose of sidewalk dining. The proposed permit area is shown on the attachment. Approval of this permit is based on the conditions and standards of Chapter 14.14 of the Long Beach Municipal Code, which describes temporary uses of public right-of-way. The width of the sidewalk is thirteen feet and six inches. A minimum width of five feet will be maintained between the sidewalk-dining area and other sidewalk obstructions. If approved, the use of the permit area will be restricted to the hours between 10:00 a.m. and 10:00 p.m.

This permit was reviewed by the Long Beach Fire Department on April 17, 2013. This matter was reviewed and approved by Deputy City Attorney Linda Vu on September 13, 2013 and by Budget Management Officer Victoria Bell on October 10, 2013.

TIMING CONSIDERATIONS

City Council action on this matter is not time critical.

FISCAL IMPACT

A security deposit of \$575 and a permit-processing fee of \$575 were collected and deposited into the General Fund (GP) in the Department of Public Works (PW). Approval of this matter could potentially have a positive impact on the local job market.

1300132 04/3/12

FOR APPROVAL BY
CITY COUNCIL
11/05/13

HONORABLE MAYOR AND CITY COUNCIL
November 5, 2013
Page 2

SUGGESTED ACTION:

Approve recommendation.

Respectfully submitted,

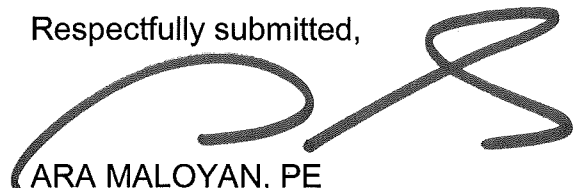

ARA MALOYAN, PE
ACTING DIRECTOR OF PUBLIC WORKS

APPROVED:



PATRICK H. WEST
CITY MANAGER

P:\CL\ROW Starbucks CL.doc
AM:GMM:SDJ:db

Attachment

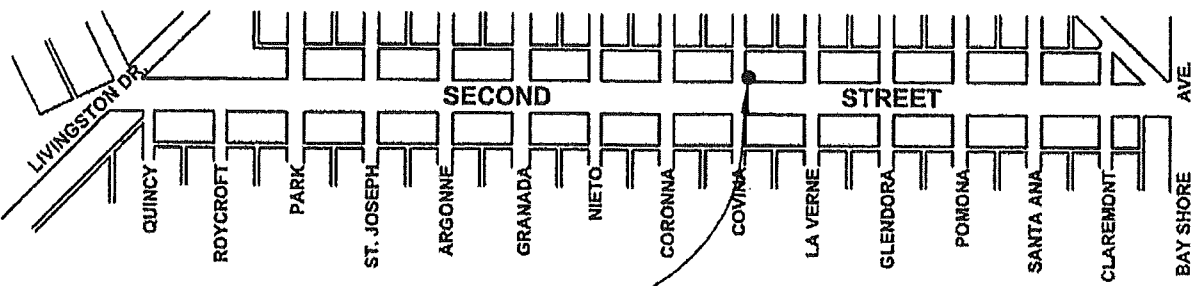

STARBUCKS COFFEE COMPANY

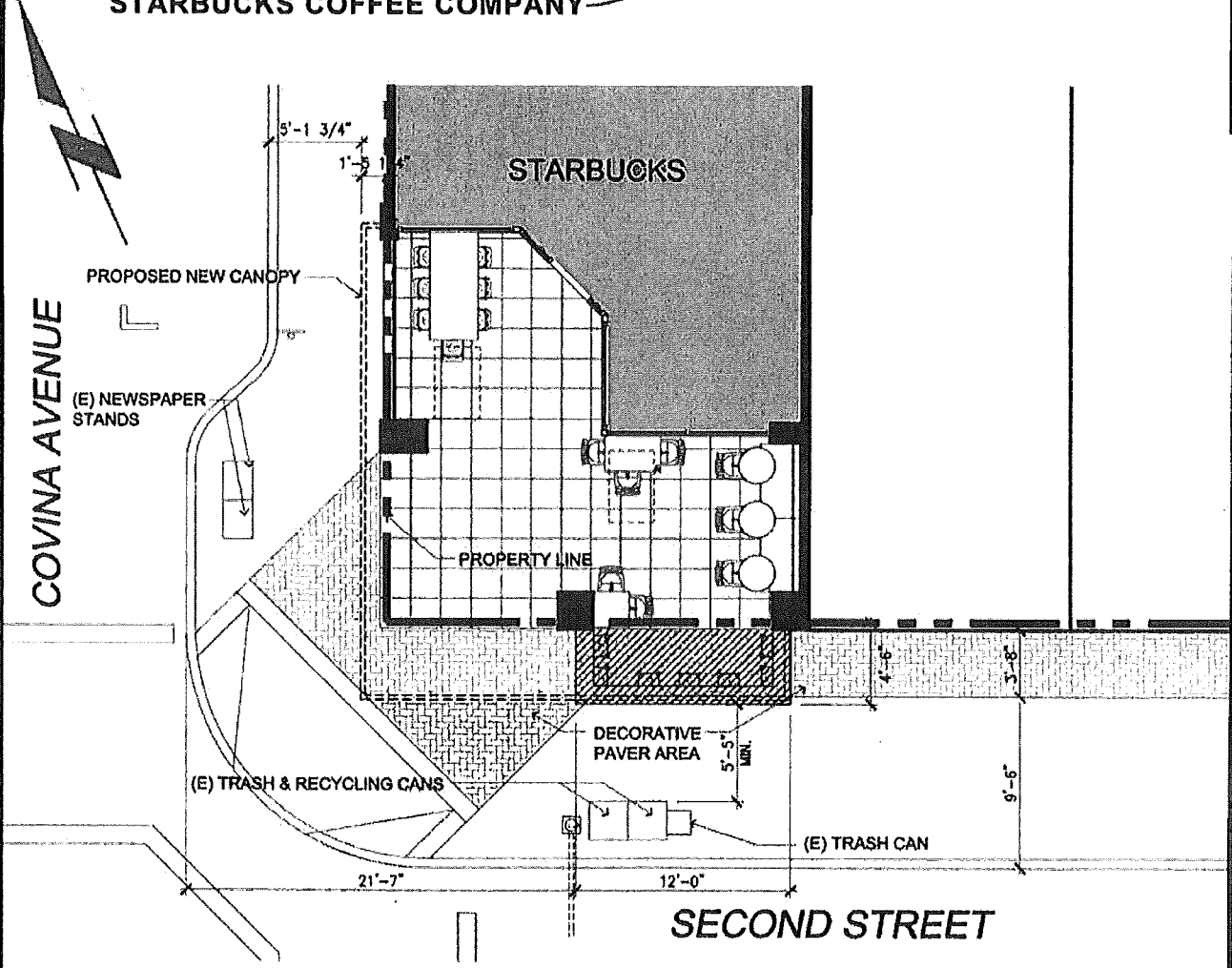

 SHOWS PERMIT AREA

CITY OF LONG BEACH - CALIFORNIA
DEPARTMENT OF PUBLIC WORKS, ENGINEERING BUREAU

**PUBLIC WALKWAYS OCCUPANCY
PERMIT**

STARBUCKS COFFEE COMPANY
5251 E. SECOND STREET