

CITY OF LONG BEACH

DEPARTMENT OF PUBLIC WORKS

333 WEST OCEAN BOULEVARD., 9th Floor LONG BEACH, CA 90802 562.570.6383 FAX 562.570.6012

April 1, 2014

HONORABLE MAYOR AND CITY COUNCIL
City of Long Beach
California

RECOMMENDATION:

Request the City Manager or designee to accept an easement deed for alley widening along Waite Court, adjacent to 1081 Long Beach Boulevard. (District 1)

DISCUSSION

It is the goal of the Department of Public Works to widen streets and alleys to the standards established in the City's General Plan. When significant new development is proposed, the public rights-of-way adjacent to the site are reviewed for sufficiency to accommodate the new development. For the construction of a 5-story 129-unit condominium building at 1081 Long Beach Boulevard, the dedication of additional alley width along Waite Court, adjacent to the project site, is recommended. In particular, the dedications recommended are shown on the attachment and described below.

The existing 15-foot wide alley should be widened on the east side by 2.5 feet, to a total width of 17.5 feet. The standard alley width of 20 feet will be achieved when property on the west side of the alley is improved and a public alley dedication of 2.5 feet is recorded.

Amcal Urban Village, LLC, the developer of the subject property, agreed to the development conditions that include the above-described dedications.

In conformance with the California Environmental Quality Act, Mitigated Negative Declaration No. 02-11 was issued for this project.

This matter was reviewed by Deputy City Attorney Linda Vu on February 3, 2014 and by Budget Management Officer Victoria Bell on March 11, 2014.

TIMING CONSIDERATIONS

City Council action on this matter is not time critical.

FISCAL IMPACT

A document processing fee of \$1,215 was paid by the developer and deposited in the General Fund (GP) in the Public Works Department (PW). No local jobs are impacted by this action.

HONORABLE MAYOR AND CITY COUNCIL

April 1, 2014

Page 2

SUGGESTED ACTION:

Approve recommendation.

Respectfully submitted,

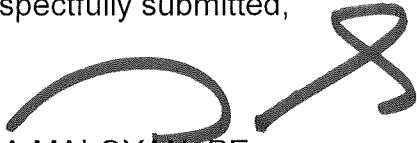

ARA MALOYAN, PE
DIRECTOR OF PUBLIC WORKS

PCL\ ROW Easement at 1081 Long Beach BI CL.doc
AM:GMM:BP:db

Attachment

APPROVED:



PATRICK H. WEST
CITY MANAGER

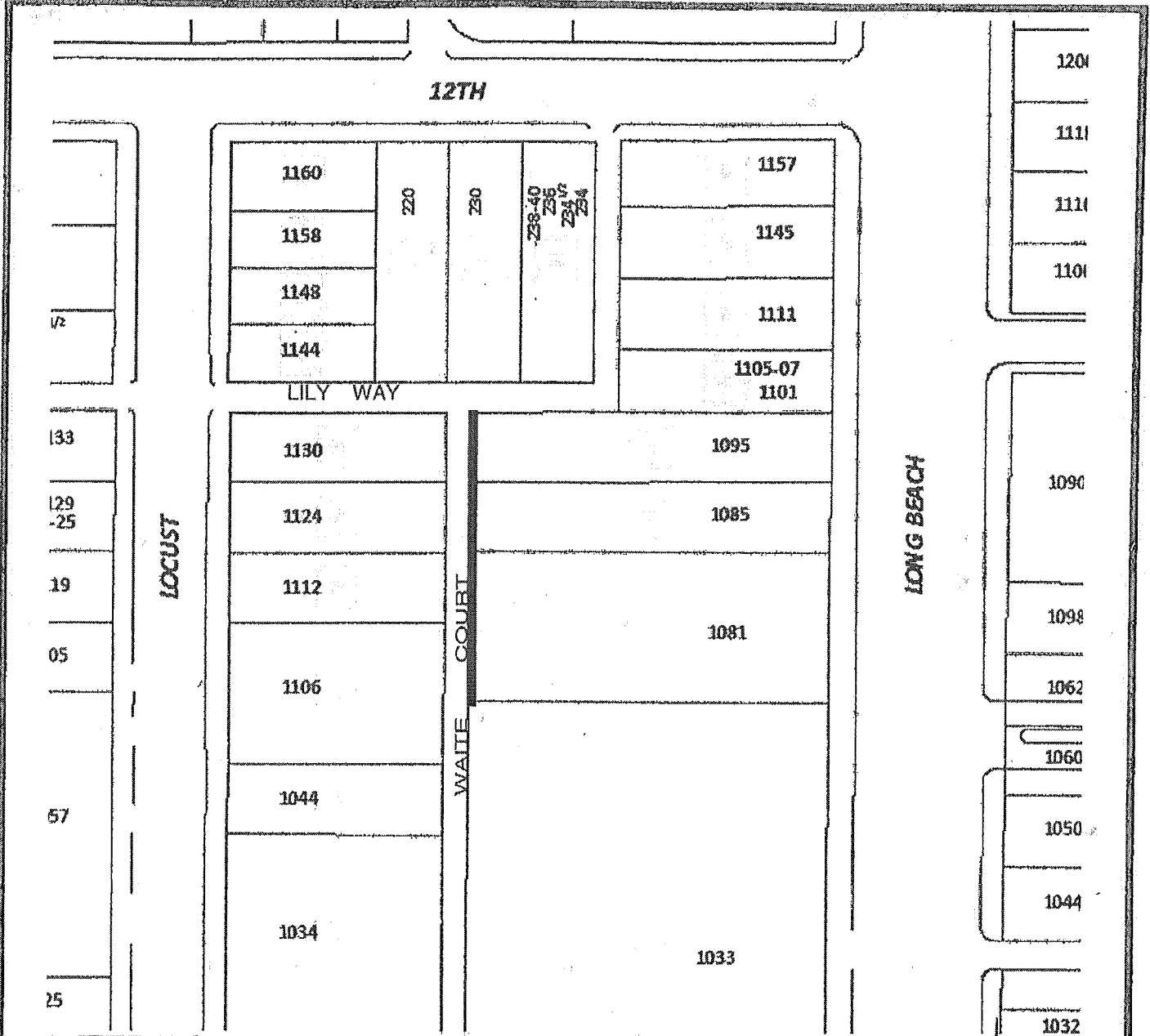

 Shows area of dedication

VICINITY MAP

NO SCALE

CITY OF LONG BEACH - CALIFORNIA
 DEPARTMENT OF PUBLIC WORKS, ENGINEERING BUREAU

**1081 LONG BEACH BOULEVARD
 WEST OF LONG BEACH BOULEVARD
 AND SOUTH OF TWELFTH STREET**