



# CITY OF LONG BEACH

**C-9**

OFFICE OF THE CITY MANAGER

333 West Ocean Boulevard • Long Beach, CA 90802 • (562) 570-6711 FAX (562) 570-7650

January 22, 2013

HONORABLE MAYOR AND CITY COUNCIL  
City of Long Beach  
California

## RECOMMENDATION:

Authorize the City Manager to execute a Revocable Permit granting the Grand Prix Association of Long Beach permission to occupy and use certain areas for parking and hospitality during the staging of the 2013 Toyota Grand Prix of Long Beach. (District 2)

## DISCUSSION

On April 19 through 21, 2013, the 39th Annual Toyota Grand Prix of Long Beach will take place on the streets of Long Beach. The Grand Prix Association of Long Beach (Association) has requested the use of certain areas adjacent to the race circuit for general and recreational vehicle parking (Exhibit A) and hospitality areas (Exhibit B) for approximately 250,000 race fans who will come to watch this year's event. The proposed Revocable Permit grants permission to occupy these areas and it establishes the conditions and fees for their use. This request is consistent with previous requests from the Association, which has conducted the race in Long Beach for 38 years.

This year's Revocable Permit will allow the Association to use the Alamitos Beach parking lot, the northern section of the Shoreline Marina parking lot, and the western end of Shoreline Drive, including center median areas for general motor vehicle parking and storage. Hospitality areas will be established at the Rainbow Lagoon and Marina Green area. These are the same areas granted under the permit last year.

Health and Human Services and Fire Department personnel will be present during all days of the Long Beach Grand Prix and will perform continual inspections of the permitted areas.

This matter was reviewed by Deputy City Attorney Richard Anthony on December 5, 2012, and Budget Management Officer Victoria Bell on December 5, 2012.

HONORABLE MAYOR AND CITY COUNCIL

January 22, 2013

Page 2 of 2

TIMING CONSIDERATIONS

City Council action is requested on January 22, 2013, in order to expedite the issuance of the Revocable Permit. Construction for the 2013 Toyota Grand Prix of Long Beach begins on February 18, 2013.

FISCAL IMPACT

Parking charges of \$15,074 will be assessed for use of parking areas (Exhibit C) under the Revocable Permit and will be deposited into the Tidelands Operations Fund (TF 401) in the City Manager Department (CM). The City shall be reimbursed for all City expenses associated with this event. There is no local job impact associated with the recommended action.

SUGGESTED ACTION:

Approve recommendation.

Respectfully submitted,



PATRICK H. WEST  
CITY MANAGER

TD:js

Attachments: Exhibits A-C

# EXHIBIT A - PARKING PERMIT ACCESS

## 2013 TOYOTA GRAND PRIX OF LONG BEACH CIRCUIT MAP

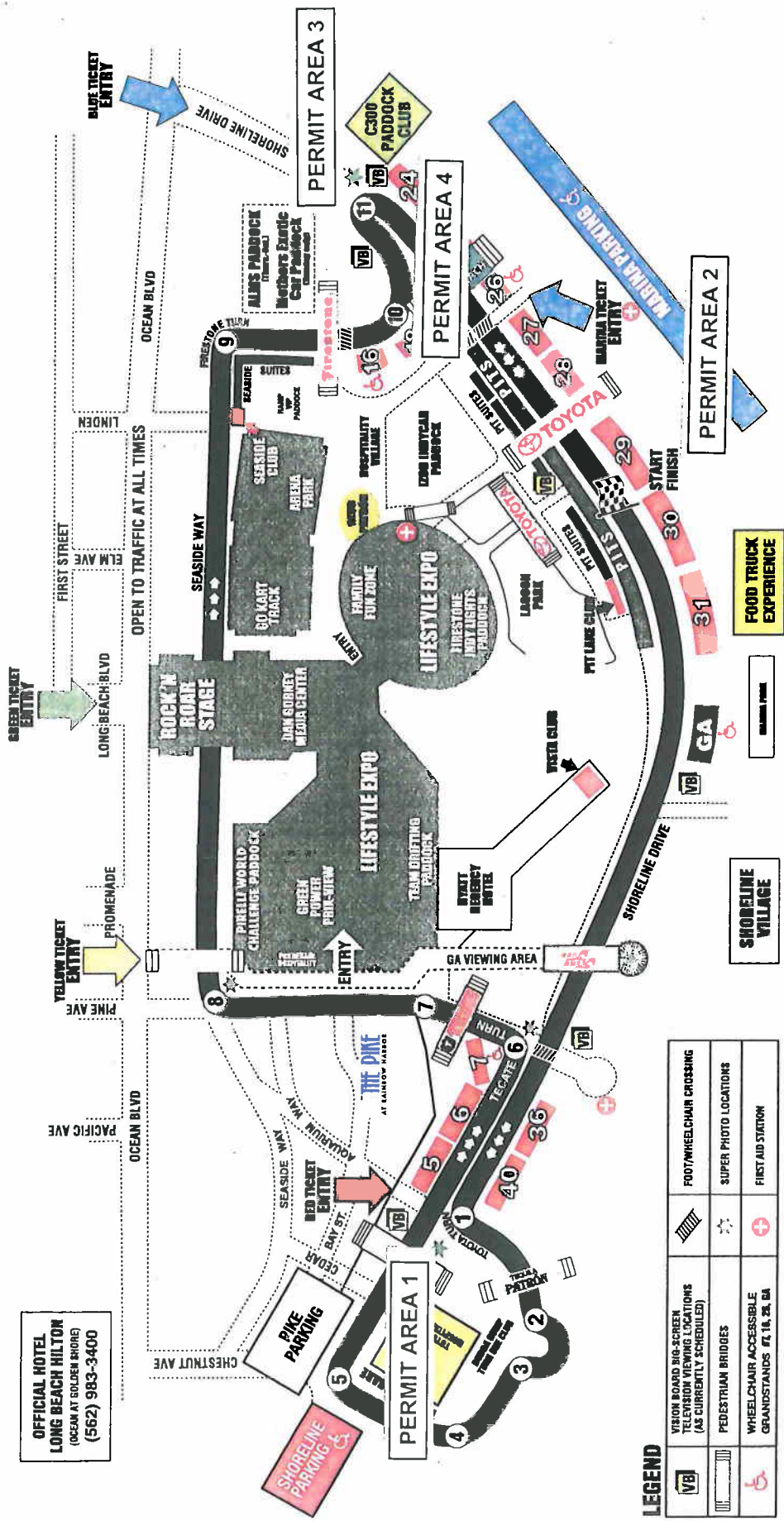

OFFICIAL HOTEL  
LONG BEACH HILTON  
(OCEAN AT GOLDEN SHORE)  
(562) 983-3400

**LEGEND**

	VISION BOARD BIG-SCREEN TELEVISION VIEWING LOCATIONS (AS CURRENTLY SCHEDULED)		FOOT/WHEELCHAIR CROSSING
	PEDESTRIAN BRIDGES		SUPER PHOTO LOCATIONS
	WHEELCHAIR ACCESSIBLE GRANDSTANDS #1, 18, 28, GA		FIRST AID STATION

# EXHIBIT B - HOSPITALITY AREAS

## 2013 TOYOTA GRAND PRIX OF LONG BEACH CIRCUIT MAP

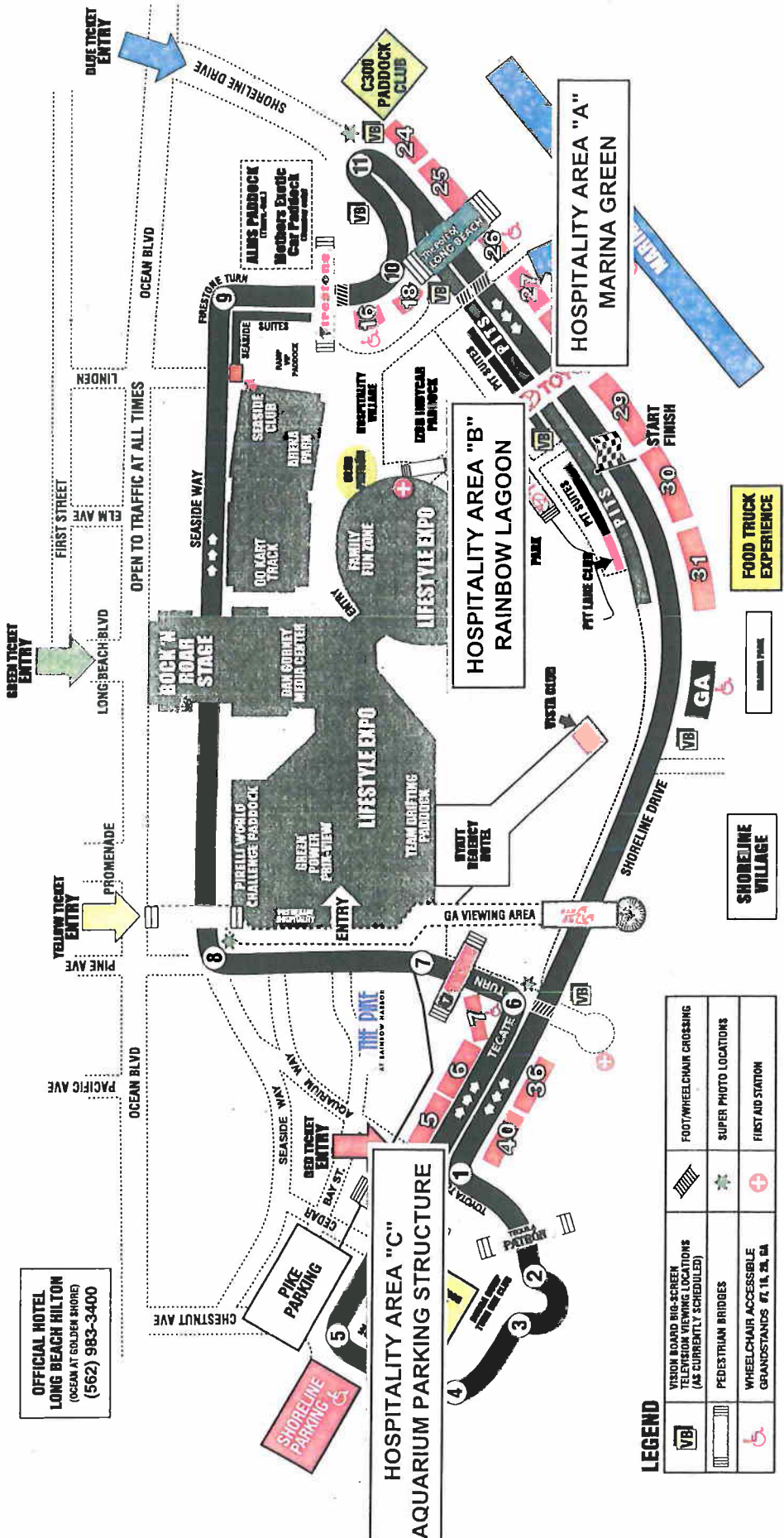

**OFFICIAL HOTEL**  
**LONG BEACH HILTON**  
 (OCEAN AT GOLDEN SHORES)  
 (562) 983-3400

**HOSPITALITY AREA "C"**  
**AQUARIUM PARKING STRUCTURE**

**HOSPITALITY AREA "B"**  
**RAINBOW LAGOON**

**HOSPITALITY AREA "A"**  
**MARINA GREEN**

**LEGEND**

	VISION BOARD BIG-SCREEN EXTRA VIEWING LOCATIONS (AS CURRENTLY SCHEDULED)		FOOT/WHEEL CHAIR CROSSING
	PEDESTRIAN BRIDGES		SUPER PHOTO LOCATIONS
	WHEELCHAIR ACCESSIBLE GRANDSTANDS #1, 18, 28, 34		FIRST AID STATION

## EXHIBIT C

### 2013 Grand Prix Revocable Permit

#### PARKING CHARGES

Beach Parking	\$ 4,500.00
Alamitos Lot Parking	\$ 2,628.00
Access Road Parking	\$ 5,994.00
Boat Owner Parking	<u>\$ 1,952.00</u>
<b>TOTAL:</b>	<b>\$15,074.00 *</b>

\* Per Grand Prix Association of Long Beach, LLC Amended and Restated Agreement Friday-Sunday Expense Cap (Exhibit B).