

HONORABLE MAYOR AND CITY COUNCIL
December 13, 2005

Council District: 7

Applicant: Douglas Kim and Soon Aei Kim
DBA: La Mexicana Market
Address: 2090 Santa Fe Avenue

Type of Application: A person-to-person transfer of an Off-Sale Beer and Wine license.

Basis for possible protest: None.

PUBLIC CONVENIENCE DETERMINATION: A determination by the City of public convenience and necessity **is not** required for this application.

Census Tract: 5729.00

Boundaries: Hill Street to the North
Pacific Coast Highway to the South
Los Angeles River to the East
Santa Fe Avenue/19th Street/Cota Avenue to the West

Number of licenses allowed: 4

Number of licenses existing: 3

Police Reporting District: 051

Boundaries: Hill Street to the North
20th Street to the South
Long Beach Freeway to the East
Santa Fe Avenue to the West

Reported crimes in this district for ABC purposes are 96. Crime in a reporting district must be at least 194 to qualify for a high crime protest. A protest may not be filed on a person-to-person transfer application.

Type of business: A neighborhood market.

Last day to request conditions: December 16, 2005

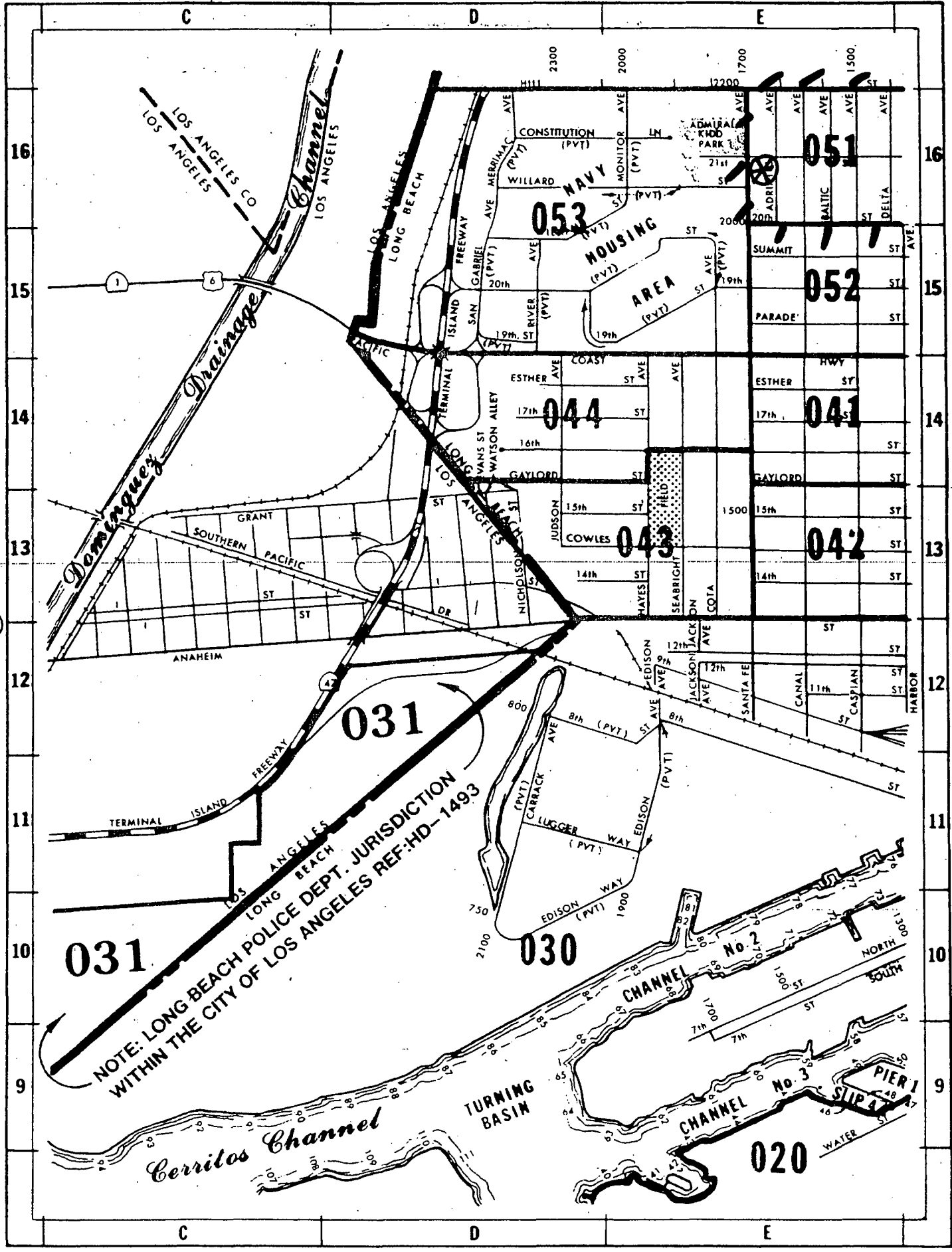

031

NOTE: LONG BEACH POLICE DEPT. JURISDICTION WITHIN THE CITY OF LOS ANGELES REF: HD-1493

030

CHANNEL

020

CHANNEL No. 3

053

NAVY HOUSING AREA

051

052

044

041

043

042

9

7

2

