



# CITY OF LONG BEACH

# C-12

DEPARTMENT OF PARKS, RECREATION & MARINE

2760 N. Studebaker Road, Long Beach, CA 90815-1697

(562) 570-3100 • FAX (562) 570-3109

www.lbparks.org

November 20, 2007

HONORABLE MAYOR AND CITY COUNCIL  
City of Long Beach  
California

## RECOMMENDATION:

Authorize the City Manager to execute a lease with Long Beach Organic for use of City-owned property located at Plymouth Street and Elm Avenue, for the development and management of a community garden, for a term of three years, with two, two-year renewal options at the discretion of the City Manager.  
(District 8)

## DISCUSSION

Long Beach Organic (LBO) is a nonprofit organization "dedicated to promoting sustainable organic gardening practices and local food consumption" in urban areas. LBO was founded in 1994, with the vision of turning vacant urban lots into viable organic gardens. LBO plans, develops, and manages community gardens and provides instruction on organic gardening methods to gardeners of all ages.

LBO proposes to lease the southeast portion of Grace Park, located at Plymouth Street and Elm Avenue, for the development and management of a community garden (Attachment A).

The proposed lease contains the following major provisions:

- Premises: The southeast portion of Grace Park (.18 acres), located at 325 East Plymouth Street.
- Rent: \$1 per year, paid in advance.
- Lease Term: The term of the lease shall be for three years, with two, two-year options for renewal.
- Authorized Use: The site shall be used only as a community garden and for educational programs related to gardening.
- Hours of Operation: Monday through Friday: 7:00 a.m. to dusk. Saturday and Sunday: 9:00 a.m. to dusk.

- Maintenance: LBO shall be responsible for ensuring that the site is maintained in a safe, clean, and sanitary condition. Trash removal shall be the sole responsibility of LBO.
- Utilities: LBO shall pay for water services. Electricity for security lighting shall be provided by the Department of Parks, Recreation and Marine.
- Insurance: LBO shall provide evidence of liability insurance as defined by the City's Risk Manager. The City will be fully indemnified of liability for activity on the requested property.

This matter was reviewed by Deputy City Attorney Gary J. Anderson on November 7, 2007, and Budget Management Officer Victoria Bell on November 8, 2007.

TIMING CONSIDERATIONS

City Council action is requested on November 20, 2007, to enable the execution of the lease.

FISCAL IMPACT

Revenue in the amount of \$1 will be deposited in the General Fund (GF) in the Department of Parks, Recreation and Marine (PR).

SUGGESTED ACTION:

Approve Recommendation.

Respectfully submitted,



PHIL T. HESTER  
DIRECTOR OF PARKS, RECREATION AND MARINE

PTH:AMM:hem

Attachment

APPROVED:



PATRICK H. WEST  
CITY MANAGER

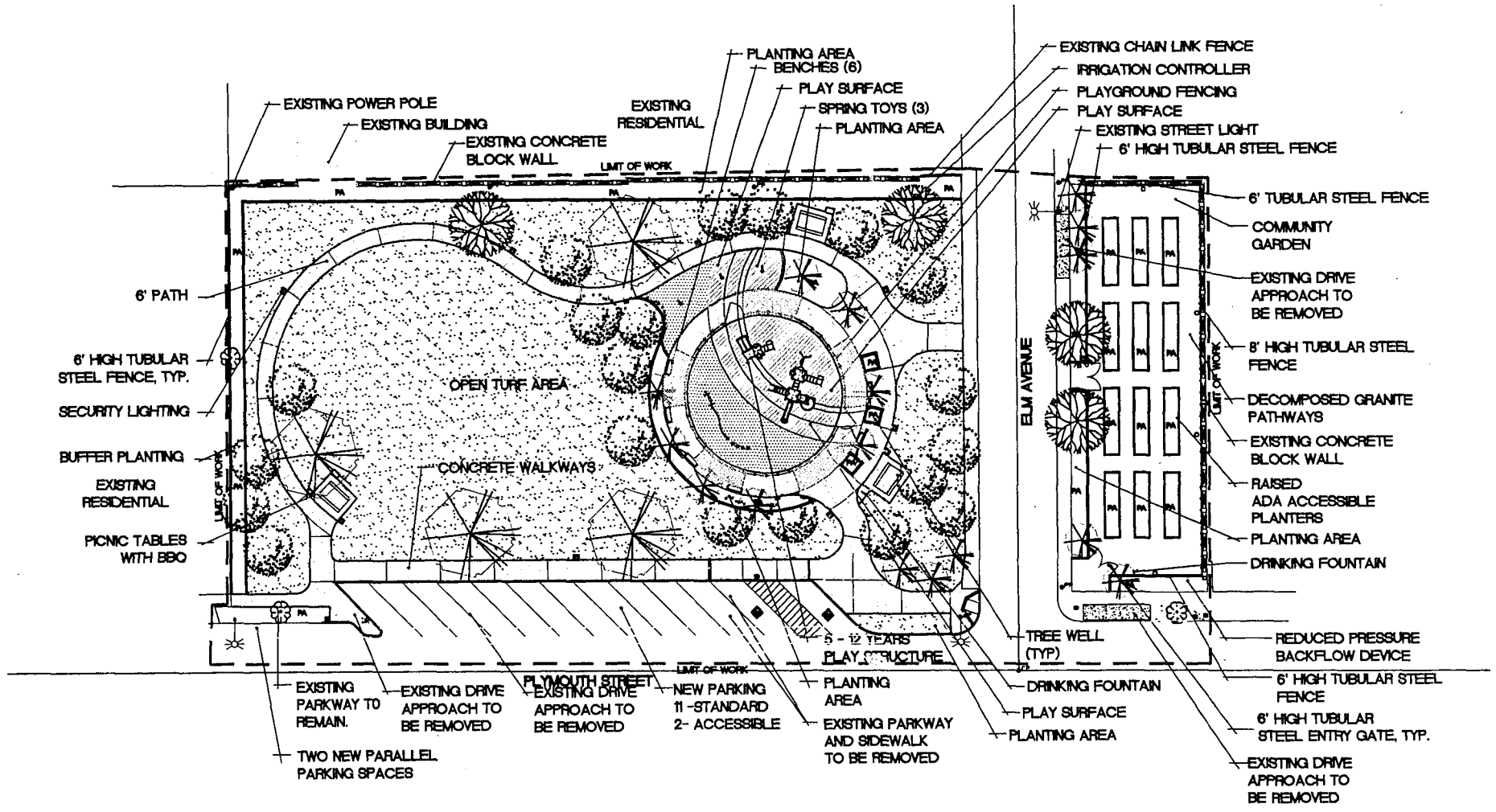

City of Long Beach  
**PLYMOUTH & ELM MINI PARK**  
 Site Plan - Phase 1

10-6-04

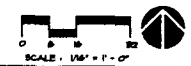

**purkiss-rose-rsi**  
 Landscape Architecture  
 Recreation and Park Planning  
 200 South Harbor Boulevard  
 Torrance, California 90501  
 708/409-4222  
 708/409-4222