

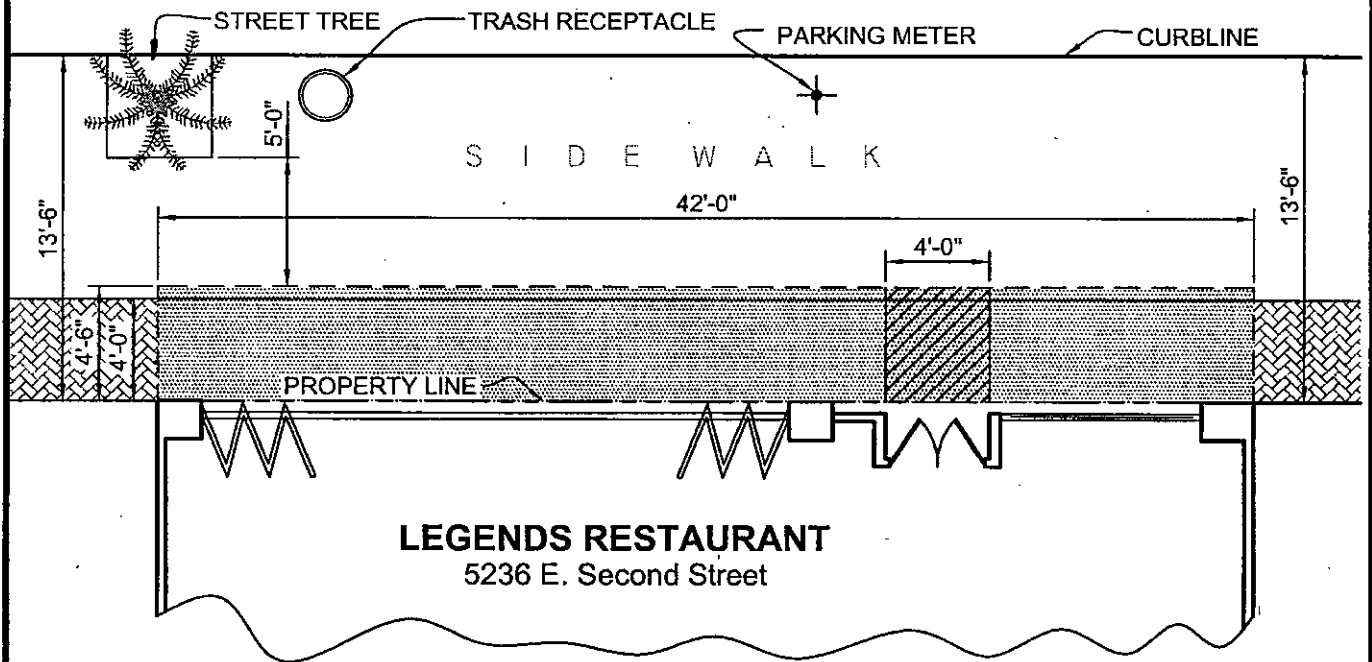

SECOND STREET

SECOND STREET



-  SHOWS AREA OF PERMIT
-  SHOWS AREA FOR PASSAGE

CITY OF LONG BEACH - CALIFORNIA
 DEPARTMENT OF PUBLIC WORKS, ENGINEERING BUREAU

PUBLIC WALKWAYS OCCUPANCY

PERMIT

**LEGENDS RESTAURANT
 5236 East Second Street**

List of Approved Furnishings and Accessories
(Attachment to Public Walkways Occupancy Permit for Sidewalk Dining Purposes)

Restaurant: LEGENDS Permittee: Sports LEGENDS Inc

Address: 5236 E. 2nd ST Telephone: 562-433-5743

Tables
number: 3

Chairs
number: 9

Umbrella(s)
height & number: _____

Heater(s)
height & number: _____

Menu board
note: maximum height of 5 ft 6 in, maximum width of 2 ft
& none permitted in the coastal zone

Waiter station
size: _____

Planters for trees or other greenscaping
describe: _____

Other: Bench, BUTT CAN

We intend to make occasional use of the permit area for live or recorded entertainment
(Note: A separate entertainment permit is required).

- The following are prohibited:**
- canopies (ground supported)
 - television monitors

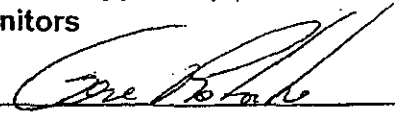
Permittee signature: 

Date: 11/26/04

Print name here: Gase Rotondo

This list of furnishings and accessories is effective only when attached to a completed Public Walkways Occupancy Permit.