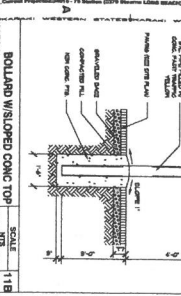
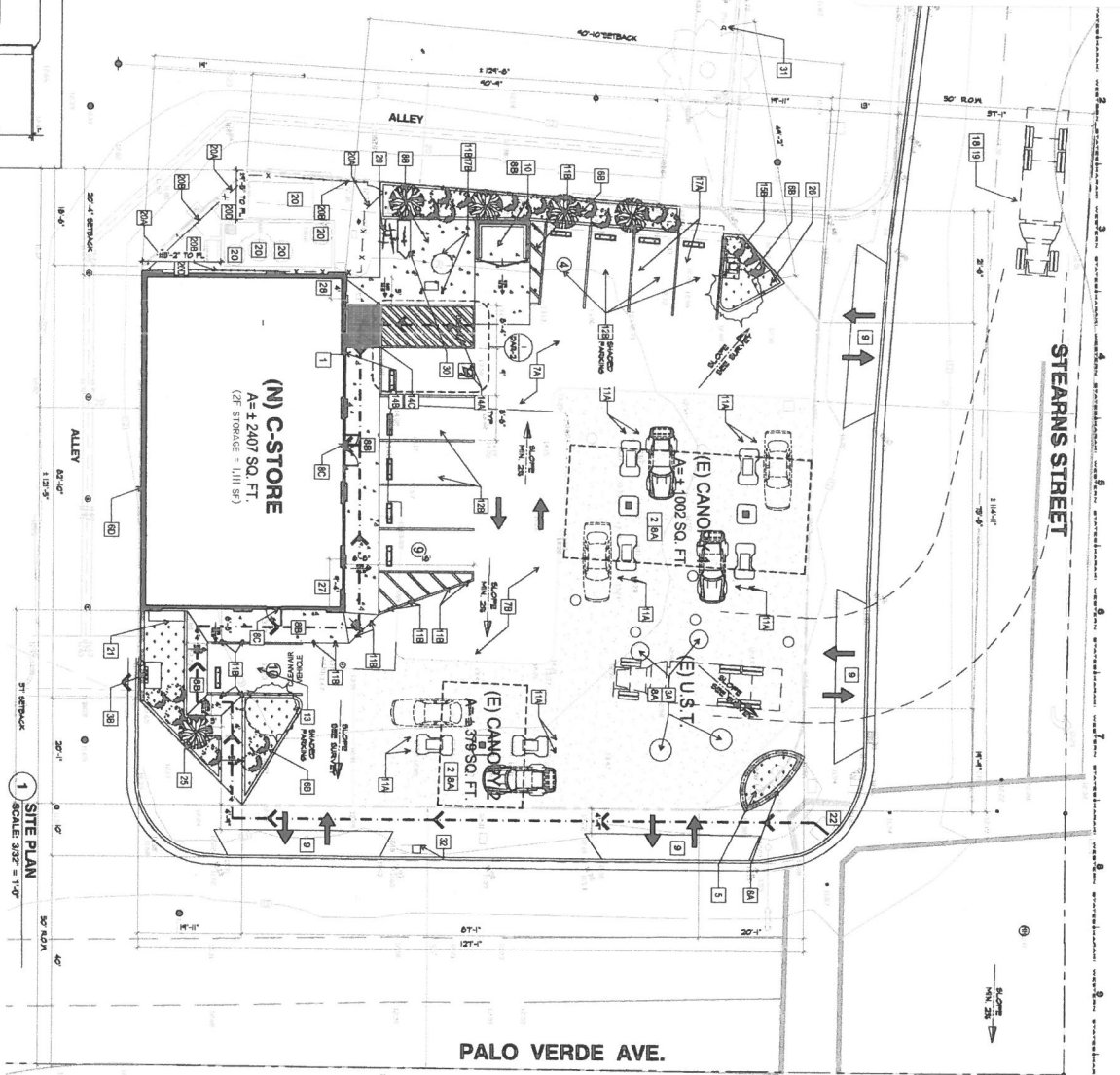

EXHIBIT B



LEGEND

- 1 NO OF PARKING SPACES
- 2 ACCESSIBLE PARKING
- 3 PROPERTY LINE
- 4 ACCESSIBLE PATH OF TRAVEL, MAIN BUILDING
- 5 ACCESSIBLE PATH OF TRAVEL, MAIN BUILDING
- 6 LANDSCAPE AREA
- 7 DIRECTIONAL ARROW
- 8 AREA LIGHTS
- 9 WALL MOUNTED AREA LIGHTS
- 10 FINE IMPACT

SITE KEY NOTES

- 1 Proposed by contractor store with 20' from structure front
- 2 2' ADA 5' FROM CURBWAY AND 10' FROM DRIVEWAY TO DRIVEWAY
- 3 10' FROM DRIVEWAY TO DRIVEWAY
- 4 10' FROM DRIVEWAY TO DRIVEWAY
- 5 10' FROM DRIVEWAY TO DRIVEWAY
- 6 10' FROM DRIVEWAY TO DRIVEWAY
- 7 10' FROM DRIVEWAY TO DRIVEWAY
- 8 10' FROM DRIVEWAY TO DRIVEWAY
- 9 10' FROM DRIVEWAY TO DRIVEWAY
- 10 10' FROM DRIVEWAY TO DRIVEWAY
- 11 10' FROM DRIVEWAY TO DRIVEWAY
- 12 10' FROM DRIVEWAY TO DRIVEWAY
- 13 10' FROM DRIVEWAY TO DRIVEWAY
- 14 10' FROM DRIVEWAY TO DRIVEWAY
- 15 10' FROM DRIVEWAY TO DRIVEWAY
- 16 10' FROM DRIVEWAY TO DRIVEWAY
- 17 10' FROM DRIVEWAY TO DRIVEWAY
- 18 10' FROM DRIVEWAY TO DRIVEWAY
- 19 10' FROM DRIVEWAY TO DRIVEWAY
- 20 10' FROM DRIVEWAY TO DRIVEWAY
- 21 10' FROM DRIVEWAY TO DRIVEWAY
- 22 10' FROM DRIVEWAY TO DRIVEWAY
- 23 10' FROM DRIVEWAY TO DRIVEWAY
- 24 10' FROM DRIVEWAY TO DRIVEWAY
- 25 10' FROM DRIVEWAY TO DRIVEWAY
- 26 10' FROM DRIVEWAY TO DRIVEWAY
- 27 10' FROM DRIVEWAY TO DRIVEWAY
- 28 10' FROM DRIVEWAY TO DRIVEWAY
- 29 10' FROM DRIVEWAY TO DRIVEWAY
- 30 10' FROM DRIVEWAY TO DRIVEWAY
- 31 10' FROM DRIVEWAY TO DRIVEWAY
- 32 10' FROM DRIVEWAY TO DRIVEWAY



KARAK WS
WESTERN STATES ENGINEERING
A DESIGN/BUILD COMPANY
4887 E. LA PALMA STE. 707
PALM BEACH, FL 33410
TEL: (561) 840-1111
WWW.KARAKWS.COM

AS-1.0
SHEET NUMBER
E39016
1806-18

SITE PLAN

OWNER NAME & ADDRESS
MR. MARK
TORNOW

DATE
NO DESCRIPTION BY DATE
11 22

CONTRACTOR NAME & ADDRESS
78 SERVICE STATION
PROPOSED C-STORE

DATE
NO DESCRIPTION BY DATE
11 22

CONSULTANT NAME & ADDRESS
KARAK WS
4887 E. LA PALMA STE. 707
PALM BEACH, FL 33410
TEL: (561) 840-1111
WWW.KARAKWS.COM

