

CITY OF LONG BEACH

DEPARTMENT OF PUBLIC WORKS

C-10

333 WEST OCEAN BOULEVARD, 9th Floor LONG BEACH, CA 90802 562.570.6383 FAX 562.570.6012

August 5, 2014

HONORABLE MAYOR AND CITY COUNCIL
City of Long Beach
California

RECOMMENDATION:

Authorize the City Manager to execute a Public Walkways Occupancy Permit for sidewalk dining at the Tavern On 2 restaurant located at 5110 East Second Street. (District 3)

DISCUSSION

The operator of the Tavern On 2 restaurant, located at 5110 East Second Street, requests a permit to temporarily occupy part of the adjoining sidewalk for the purpose of sidewalk dining. The proposed permit area and a list of furnishings and accessories to be placed in the permit area are shown on the attachment. Approval of this permit is based on the conditions and standards of Chapter 14.14 of the Long Beach Municipal Code, which describes temporary uses of public right-of-way. The width of the sidewalk is 13.5 feet. A minimum clearance of 5 feet will be maintained between the permit area and sidewalk obstructions. Usage of the sidewalk dining area is restricted to the hours between 10:00 a.m. and 10:00 p.m.

This permit request was reviewed and approved by the Long Beach Fire Department on August 22, 2013. This matter was reviewed by Deputy City Attorney Linda Vu on December 3, 2013 and by Budget Analysis Officer Grace Yoon on July 14, 2014.

TIMING CONSIDERATIONS

City Council action on this matter is not time critical.

FISCAL IMPACT

A security deposit of \$562 and a permit processing fee of \$562 were deposited into the General Fund (GP) in the Public Works Department (PW). Approval of this recommendation will provide continued support to the local economy.

SUGGESTED ACTION:

Approve recommendation.

Respectfully submitted,



ARA MALOYAN, PE
DIRECTOR OF PUBLIC WORKS

AM:GMM:BP:st
P\CL\ ROW Tavern on 2 CL.doc

Attachment - Sketch & List of Furnishings

APPROVED:



PATRICK H. WEST
CITY MANAGER

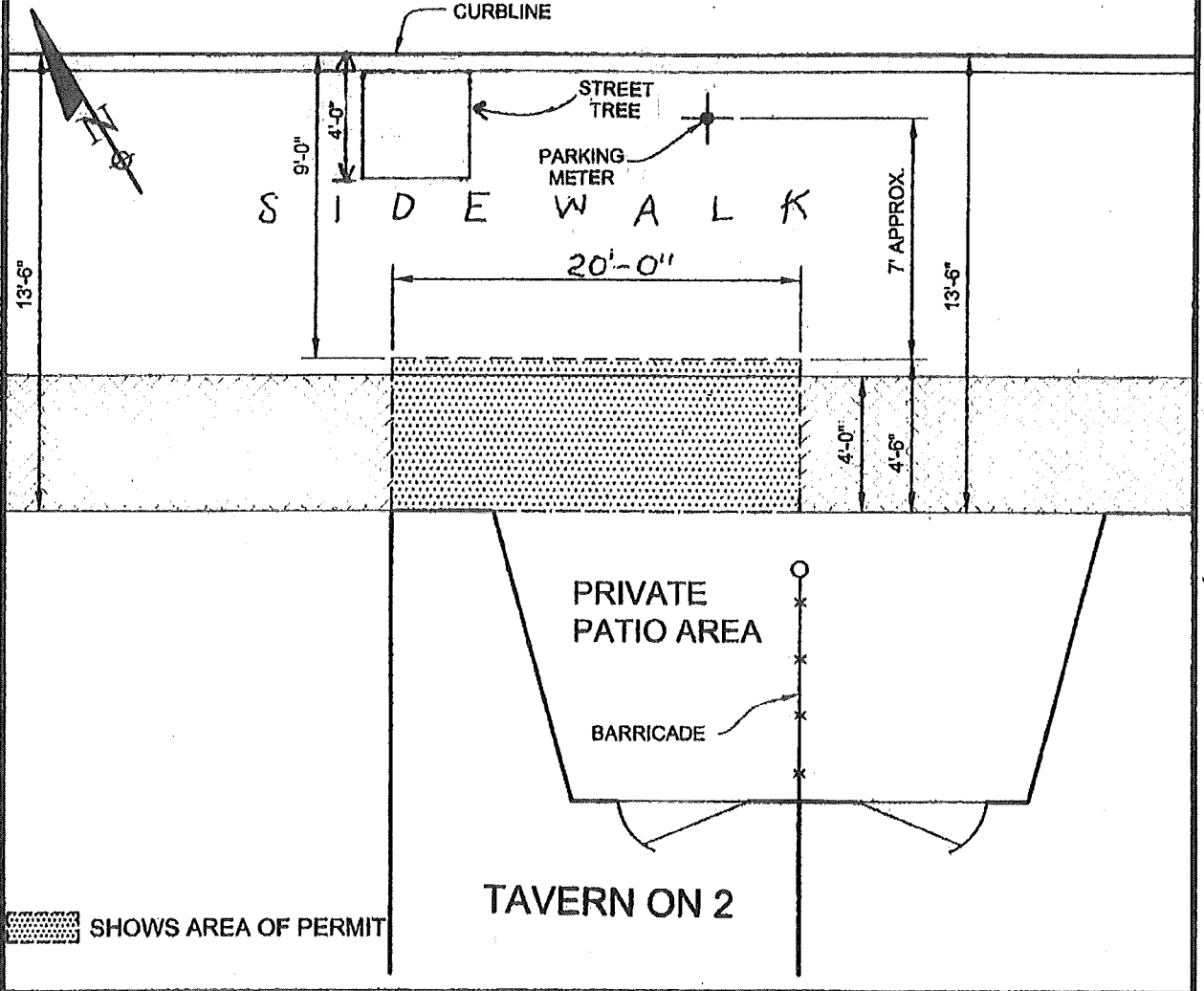
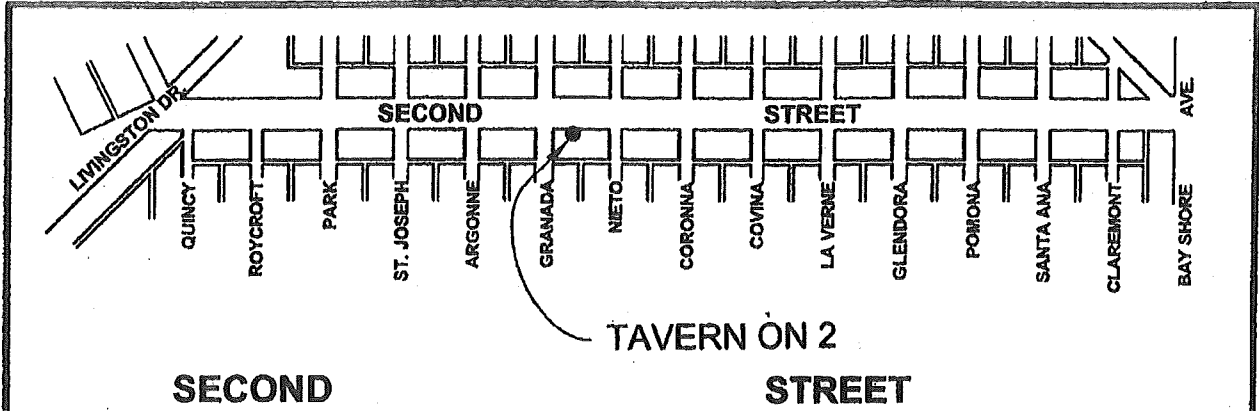

CITY OF LONG BEACH - CALIFORNIA
 DEPARTMENT OF PUBLIC WORKS, ENGINEERING BUREAU
PUBLIC WALKWAYS OCCUPANCY
PERMIT
TAVERN ON 2
5110 East Second Street

List of Approved Furnishings and Accessories
(Attachment to Public Walkways Occupancy Permit for Sidewalk Dining Purpose)

Restaurant: Tavern on 2 Permittee: Southern California Entertainment Group, LLC
Address: 5110 E. 2nd St Telephone: 562-856-4000

Tables number: 3

Chairs number: 6

Umbrella(s) height & number: _____

Heater(s) height & number: _____

Menu board
note: maximum height of 5 ft 6 in, maximum width of 2 ft & none permitted in the coastal zone

Waiter station size: _____

Planters for trees or other greening describe: _____

Other: _____

We intend to make occasional use of the permit area for live or recorded entertainment (Note: A separate entertainment permit is required).

The following are prohibited:

- canopies (ground supported)
- television monitors

Permittee signature:  Date: 5-28-12

Print name here: KYLE MICHOW

This list of furnishings and accessories is effective only when attached to a completed Public Walkways Occupancy Permit.