



# LONG BEACH REDEVELOPMENT AGENCY

333 WEST OCEAN BOULEVARD, THIRD FLOOR • LONG BEACH, CA 90802 • (562) 570-6615 • FAX (562) 570-6215

December 4, 2006

## REDEVELOPMENT AGENCY BOARD MEMBERS

City of Long Beach  
California

### RECOMMENDATION:

Recommendation to approve and authorize the Executive Director to lease 1500 through 1546 East Anaheim Street to the Long Beach Rescue Mission to support the operation of winter shelter programs between the dates of December 1, 2006 and March 15, 2007. (Central – District 4)

### DISCUSSION

In the late 1980's, four homeless persons died on the streets of Los Angeles County due to inclement weather during the winter months. In response to the deaths, Mayor Bradley started the first Los Angeles City and County Winter Shelter Programs. The City of Los Angeles and Los Angeles County operated two separate Winter Shelter Programs. The Los Angeles County Emergency Food and Shelter Program Local Board also assisted with planning and funding the Winter Shelter Program.

One of the main milestones of the Winter Shelter Program was the creation of the Los Angeles Homeless Services Authority, (LAHSA), in 1994. LAHSA is a joint power agreement between the City of Los Angeles and Los Angeles County to oversee homeless services Countywide.

With the creation of LAHSA, the Winter Shelter Program has become a coordinated effort to increase the number of beds available in Los Angeles County. The County of Los Angeles, the City of Los Angeles and the Los Angeles County Emergency Food and Shelter Program Local Board provide funds to LAHSA to operate the Winter Shelter Program.

The main goal of the Winter Shelter Program is to increase the number of high tolerance and low demand emergency shelter beds available throughout Los Angeles County during the winter months (December 1 - March 15) each year.

REDEVELOPMENT AGENCY BOARD MEMBERS

December 4, 2006

Page 2

The winter shelter provider is required to provide the following services: nightly shelter, two daily meals, restrooms and showers. When additional funds are available case management services are also provided. As the administrative authority, LAHSA is responsible for selecting the Winter Shelter operators through a competitive application process, contracting with providers and overseeing the winter shelter operations.

For the 2006-07 fiscal year, LAHSA has selected the Long Beach Rescue Mission (LBRM) to provide the Winter Shelter Program for District 4. The Los Angeles County Supervisorial District 4, has identified the properties located at 1500 through 1546 East Anaheim Street (Exhibit A – Site Map), the former Community Rehabilitation Industries building as an ideal location for a winter shelter for the homeless. Winter Shelter clients will be able to access supportive services including case management, job training, life skills assistance, mail services, and so forth.

Staff proposes to lease 1500 through 1546 East Anaheim Street to the LBRM from December 1, 2006 to March 15, 2007, at no cost. The LBRM in return, will be required to reimburse the Agency for all costs incurred in the operation such as utilities, property maintenance and management.

SUGGESTED ACTION:

Approve recommendation.

Respectfully submitted,



PATRICK H. WEST  
EXECUTIVE DIRECTOR

PHW:CB:DW:jr

APPROVED:



GERALD R. MILLER  
CITY MANAGER

Attachments: Exhibit A – Site Map

R:\RDA Board\RDA Board Meetings\2006\December 4\Shelter Programs Staff Report.doc

R:\RDA Board\RDA Board Meetings\2006\December 4\Shelter Programs Staff Report.doc

**County of Los Angeles: Rick Auerbach, Assessor**

12-19-64  
90228  
\* 18061803006001-10  
180717  
03052704001201-26  
2403443047040001-1426  
2006030410201003-26

All 900-series parcels on this page are assessed to Redevelopment Agency of the City of Long Beach, unless otherwise noted.

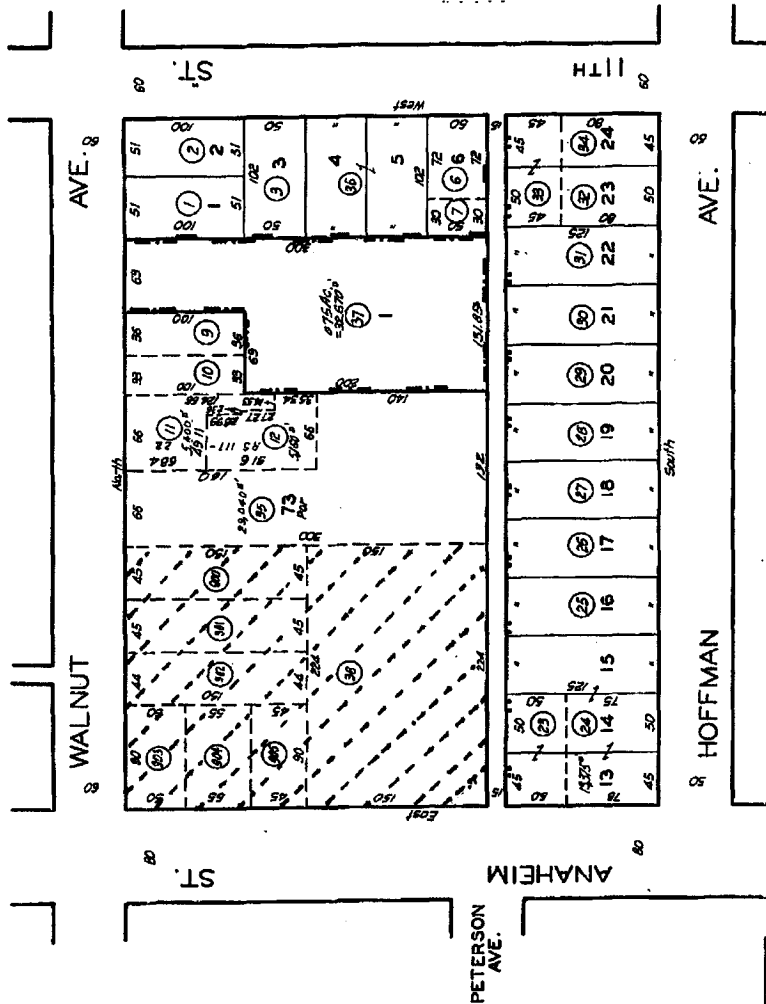

ALAMITOS TRACT FRANK E. STRONGS TRACT NO. 4  
M.S. 36-37-44 M.B. 11 - 159

TRACT NO. 28208  
M.B. 733 - 29

TRACT. NO. 4496  
M.B. 45-36

FOR PREV. ASSMT. SEE: 134-35,36 & 37

ASSESSOR'S MAP  
COUNTY OF LOS ANGELES, CALIF.

7267

CALL 1" = 80'

2006